

NO. OF COPIES RECEIVED	
DISTRIBUTION	
SANTA FE	
FILE	
U.S.G.S.	
LAND OFFICE	
OPERATOR	

NEW MEXICO OIL CONSERVATION COMMISSION

Form C-101
Revised 1-1-65

5A. Indicate Type of Lease	
STATE <input type="checkbox"/>	FEE <input checked="" type="checkbox"/>
5. State Oil & Gas Lease No.	

APPLICATION FOR PERMIT TO DRILL, DEEPEN, OR PLUG BACK

1a. Type of Work		7. Unit Agreement Name	
b. Type of Well OIL WELL <input checked="" type="checkbox"/> GAS WELL <input type="checkbox"/> OTHER <input type="checkbox"/>		8. Farm or Lease Name Arco-Lanehart	
2. Name of Operator Burleson & Huff		9. Well No. 2-Y	
3. Address of Operator P. O. Box 935, Midland, Texas 79701		10. Field and Pool, or Wildcat Langlie-Mattix	
4. Location of Well UNIT LETTER <u>H</u> LOCATED <u>530660</u> FEET FROM THE <u>East</u> LINE AND <u>1770</u> FEET FROM THE <u>North</u> LINE OF SEC. <u>21</u> TWP. <u>25-S</u> RGE. <u>37-E</u> NMPM		12. County Lea	
19. Proposed Depth 3500'		19A. Formation Queen	
20. Rotary or C.T. Rotary		21. Elevations (Show whether DF, RT, etc.) 3075.6	
21A. Kind & Status Plug. Bond State-Wide		21B. Drilling Contractor MGF	
22. Approx. Date Work will start 11-18-75			

PROPOSED CASING AND CEMENT PROGRAM

SIZE OF HOLE	SIZE OF CASING	WEIGHT PER FOOT	SETTING DEPTH	SACKS OF CEMENT	EST. TOP
13-3/4	8-5/8	30#	500	300	circulated
7-7/8	4-1/2	10.5#	3500'	250	top of salt

Will drill this well as a replacement for # 2. If we lose circulation again in the cavity we will alter our casing program and you will be notified so you can approve this change before it is done. Surface pipe will be circulated. Will drill to 3500'. Set 4-1/2" through Queen section and will be perforated and fraced for completion. A Shaffer, 900 series, Type B, 5000# working pressure Blow Out Preventer will be used in drilling this well.

PROCESS COMMENCED,
EXPIRES Feb. 18, 1976

IN ABOVE SPACE DESCRIBE PROPOSED PROGRAM; IF PROPOSAL IS TO DEEPEN OR PLUG BACK, GIVE DATA ON PRESENT PRODUCTIVE ZONE AND PROPOSED NEW PRODUCTIVE ZONE. GIVE BLOWOUT PREVENTER PROGRAM, IF ANY.

I hereby certify that the information above is true and complete to the best of my knowledge and belief.

Signed John W. Runyan Title Co-Owner Date 11-14-75

(This space for State Use)

APPROVED BY John W. Runyan TITLE Geologist DATE Nov. 16, 1975

CONDITIONS OF APPROVAL, IF ANY:

NEW MEXICO OIL CONSERVATION COMMISSION
WELL LOCATION AND ACREAGE DEDICATION PLAT

Form C-102
Supersedes C-12H
Effective 1-1-65

All distances must be from the outer boundaries of the Section.

Operator Burleson & Huff		Lease Arco Lanehart		Well No. 2-Y
Unit Letter H	Section 21	Township 25 South	Range 37 East	County Lea
Actual Well Location of Well:				
1770 feet from the North line and		660 feet from the East line		
Ground Level Elev. 3075.6	Producing Formation Queen	Pool Langlie-Mattix	Estimated Acreage 40	

1. Outline the acreage dedicated to the subject well by colored pencil or hatchure marks on the plat below
2. If more than one lease is dedicated to the well, outline each and identify the ownership thereof (both as to working interest and royalty)
3. If more than one lease of different ownership is dedicated to the well, have the interests of all owners been consolidated by communization, unitization, force-pooling, etc?

☐ Yes ☐ No If answer is "yes," type of consolidation _____

If answer is "no," list the owners and tract descriptions which have actually been consolidated (Use reverse side of this form if necessary.) _____

No allowable will be assigned to the well until all interests have been consolidated (by communization, unitization, forced-pooling, or otherwise) or until a non-standard unit, eliminating such interests, has been approved by the Commission.

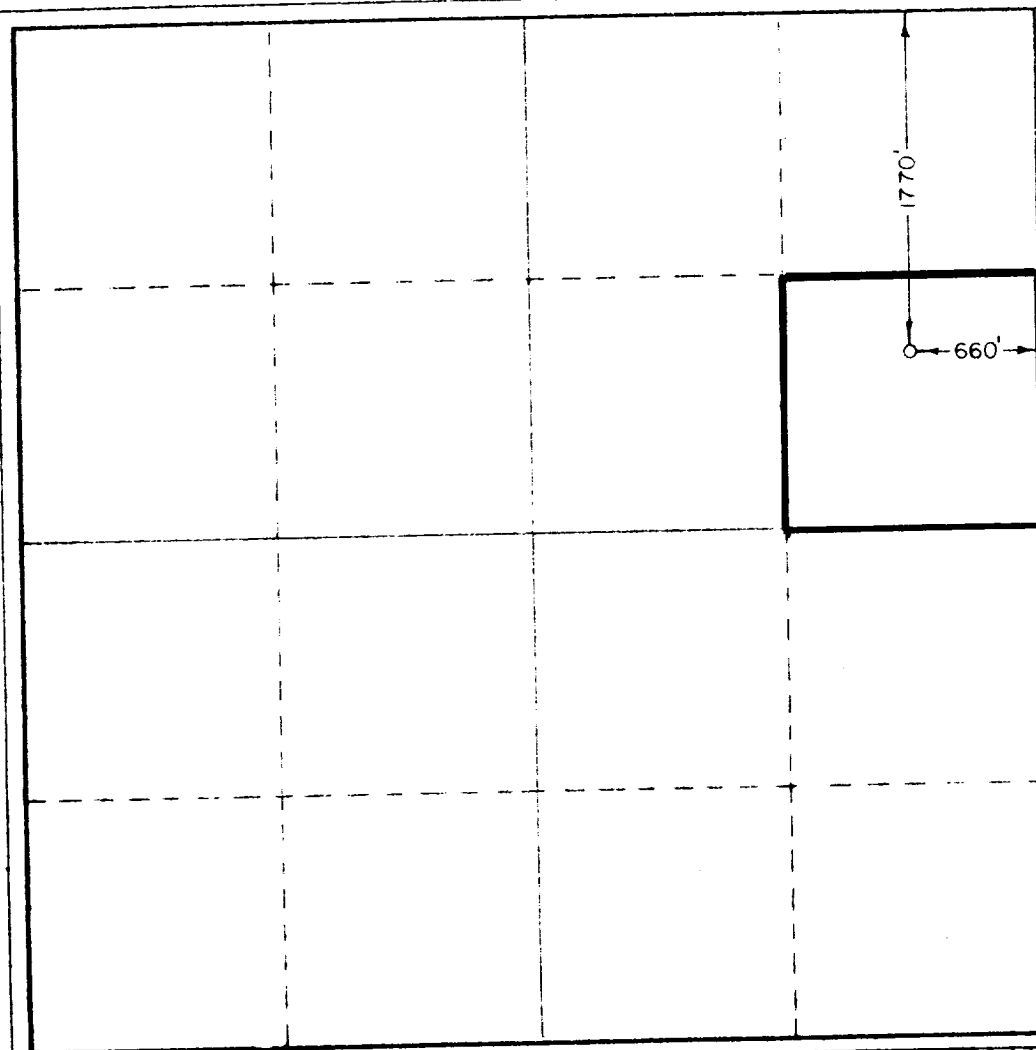

CERTIFICATION

I hereby certify that the information contained herein is true and complete to the best of my knowledge and belief.

Name *H. B. Burleson*

Position

Co-Owner

Company

Burleson & Huff

Date

11-14-75

I hereby certify that the well location shown on this plat was plotted from field notes of actual surveys made by me or under my supervision, and that the same is true and correct to the best of my knowledge and belief.

Date Signed

November 13, 1975

Registered Professional Engineer and Land Surveyor

876

Certification *W. Webb*

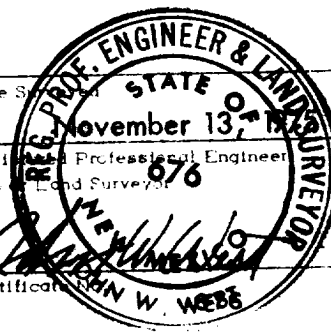

0 330 660 990 1320 1650 1980 2310 2640 2000 1500 1000 500