

NO. OF COPIES RECEIVED	
DISTRIBUTION	
SANTA FE	
FILE	
U.S.G.S.	
LAND OFFICE	
OPERATOR	

NEW MEXICO OIL CONSERVATION COMMISSION

Form C-101
Revised 1-1-65

5A. Indicate Type of Lease STATE <input checked="" type="checkbox"/> FEE <input type="checkbox"/>
5. State Oil & Gas Lease No. B-9519
7. Unit Agreement Name -- -- --
8. Farm or Lease Name Mexico "K"
9. Well No. 16
10. Field and Popl. or Wildcat Drinkard
12. County Lea
19. Proposed Depth 7000'
19A. Formation Drinkard
20. Rotary or C.T. Rotary
21. Elevations (Show whether DF, RT, etc.) 3214.9' GR
21A. Kind & Status Plug. Bond Blanket Bond #1253688
21B. Drilling Contractor \$100,000 w/Fed. Ins. Co.
22. Approx. Date Work will start ASAP

APPLICATION FOR PERMIT TO DRILL, DEEPEN, OR PLUG BACK

1a. Type of Work DRILL <input checked="" type="checkbox"/> DEEPEN <input type="checkbox"/> PLUG BACK <input type="checkbox"/>
b. Type of Well OIL WELL <input checked="" type="checkbox"/> GAS WELL <input type="checkbox"/> OTHER <input type="checkbox"/>
2. Name of Operator Skelly Oil Company
3. Address of Operator P. O. Box 1351, Midland, Texas 79701
4. Location of Well UNIT LETTER C LOCATED 660 FEET FROM THE North LINE AND 1980 FEET FROM THE West LINE OF SEC. 29 TWP. 24S RGE. 38E NMPM
19. Proposed Depth 7000'
19A. Formation Drinkard
20. Rotary or C.T. Rotary
21. Elevations (Show whether DF, RT, etc.) 3214.9' GR
21A. Kind & Status Plug. Bond Blanket Bond #1253688
21B. Drilling Contractor \$100,000 w/Fed. Ins. Co.
22. Approx. Date Work will start ASAP

SIZE OF HOLE	SIZE OF CASING	WEIGHT PER FOOT	SETTING DEPTH	SACKS OF CEMENT	EST. TOP
11"	8-5/8" OD	24#	1150'	250 sacks	Surface
7-7/8"	5-1/2" OD	15.5#	7000'	400 sacks	Surface

It is proposed to drill subject well from the surface to a total depth of approximately 7000' with rotary tools to test the Drinkard formation for oil. The pump and plug process will be used for cementing all strings of casing and cement will be circulated to the surface on the 8-5/8" OD and 5-1/2" OD casing. The 5-1/2" OD casing will be perforated as indicated by electric logs opposite the Drinkard formation.

The drilling fluid will be brine water and mud of sufficient weight to condition hole for logging and running casing to 7000'. Blow out preventors will be installed and tested to 5000# pressure. (This is not a high pressure gas area.)

IN ABOVE SPACE DESCRIBE PROPOSED PROGRAM; IF PROPOSAL IS TO DEEPEN OR PLUG BACK, GIVE DATA ON PRESENT PRODUCTIVE ZONE AND PROPOSED NEW PRODUCTIVE ZONE. GIVE BLOWOUT PREVENTER PROGRAM, IF ANY.

I hereby certify that the information above is true and complete to the best of my knowledge and belief.

(SIGNED) **LELAND FRANZ** Leland Franz Title **District Production Manager** Date **9-29-76**

(This space for State Use)

APPROVED BY **[Signature]** SUPERVISOR DISTRICT 1 DATE **OCT 1 1976**
CONDITIONS OF APPROVAL, IF ANY:

RECEIVED

1976

CH. CONSERVATION COMM.
UTRS, N. H.

**NEW MEXICO OIL CONSERVATION COMMISSION
WELL LOCATION AND ACREAGE DEDICATION PLAT**

Form O-12
Supersedes O-128
Effective 1-1-65

All distances must be from the outer boundaries of the Section

SKELLY OIL COMPANY			Lease Mexico K		Well # 16
Section C	Township 29	Range 24 South	County 38 East	Lea	
Location of Well: 1980 feet from the west line and 660 feet from the north line					
Section Elev. 3214.9	Producing Formation Drinkard	Pool Dollarhide Tubb-Drinkard		Section Acreage 40	

1. Outline the acreage dedicated to the subject well by colored pencil or hatchure marks on the plat below.
2. If more than one lease is dedicated to the well, outline each and identify the ownership thereof (both as to working interest and royalty).
3. If more than one lease of different ownership is dedicated to the well, have the interests of all owners been consolidated by communitization, unitization, force-pooling, etc?

☐ Yes ☐ No If answer is "yes," type of consolidation _____

If answer is "no" list the owners and tract descriptions which have actually been consolidated (use reverse side of this form if necessary): _____

No allowable will be assigned to the well until all interests have been consolidated (by communitization, unitization, forced-pooling, or otherwise) or until a non-standard unit, eliminating such interests, has been approved by the Commission.

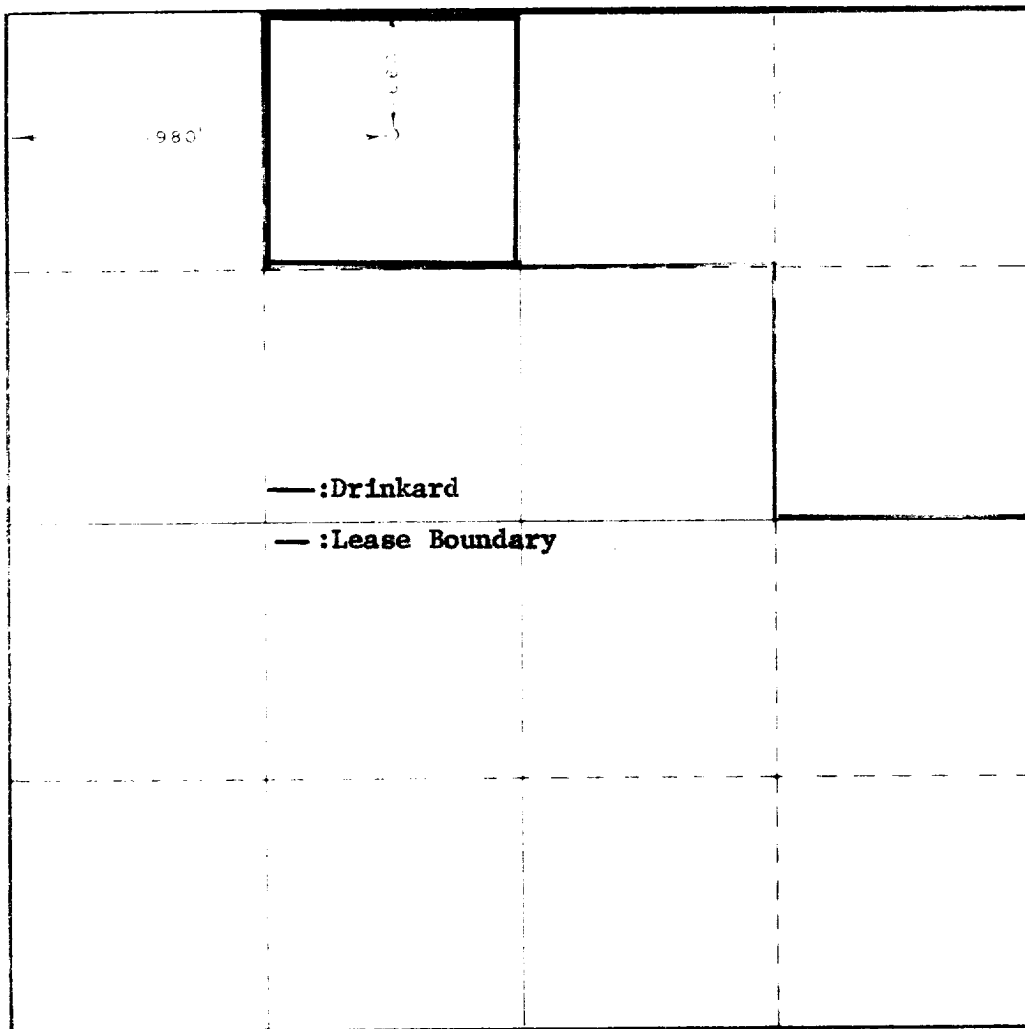

CERTIFICATION

I hereby certify that the information contained herein is true and complete to the best of my knowledge and belief.

(signed) D. R. Crow

D. R. Crow

Lead Clerk

Skelly Oil Company

September 30, 1976

I hereby certify that the well location shown on this plat was plotted from field notes of actual surveys made by me or under my supervision and that the same is true and correct to the best of my knowledge and belief.

Sept. 25, 1976

Registered Professional
Land Surveyor

John W. West
676

540 660 900 1320 1650 1980 2310 2640 2000 1500 1000 500

RECEIVED

1976

OL. CONSERVATION COM. 10/15/76

SKELLY OIL COMPANY
MEXICO "K" WELL NO. 16
5000 PSI WORKING PRESSURE
DRILLING CONTROL HOOK-UP

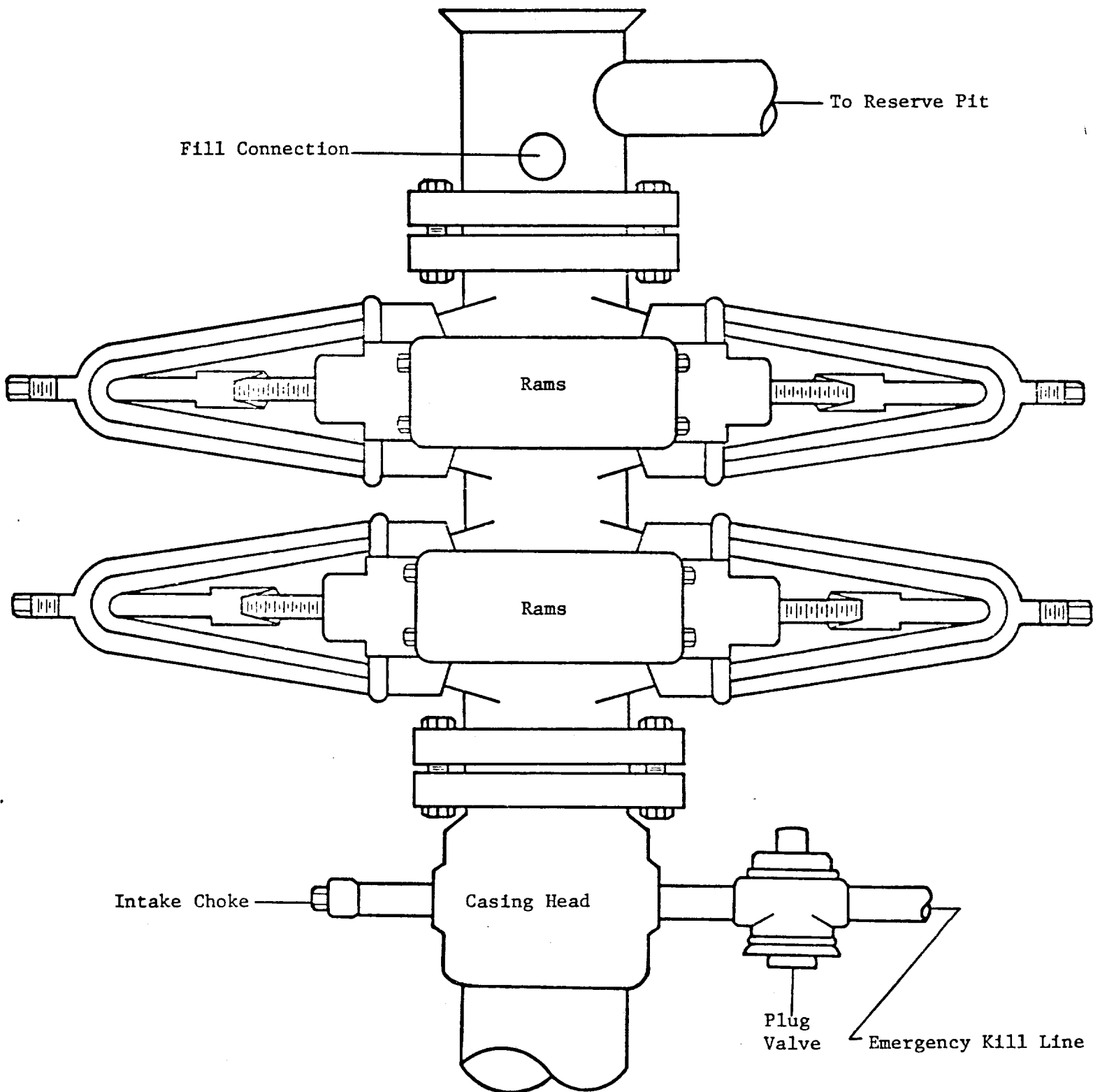

RECEIVED

1976

OIL CONSERVATION COMM.
HOERS, Q. M.

