

NO. OF COPIES RECEIVED	
DISTRIBUTION	
SANTA FE	
FILE	
U.S.G.S.	
LAND OFFICE	
OPERATOR	

NEW MEXICO OIL CONSERVATION COMMISSION

Form C-101
Revised 1-1-65

5A. Indicate Type of Lease STATE <input checked="" type="checkbox"/> FEE <input type="checkbox"/>
5. State Oil & Gas Lease No. B-9311
7. Unit Agreement Name -----
8. Farm or Lease Name Mexico "J" NC 25
9. Well No. 1
10. Field and Pool, or Wildcat Dollarhide Devonian
12. County Lea
19. Proposed Depth 8000'
19A. Formation Devonian
20. Rotary or C.T. Rotary
21. Elevations (Show whether DF, RT, etc.) 3173.0' GR
21A. Kind & Status Plug. Bond Blanket Bond #1253638
21B. Drilling Contractor
22. Approx. Date Work will start ASAP

APPLICATION FOR PERMIT TO DRILL, DEEPEN, OR PLUG BACK

1a. Type of Work b. Type of Well OIL WELL <input checked="" type="checkbox"/> GAS WELL <input type="checkbox"/> OTHER <input type="checkbox"/> DRILL <input checked="" type="checkbox"/> DEEPEN <input type="checkbox"/> PLUG BACK <input type="checkbox"/> SINGLE ZONE <input checked="" type="checkbox"/> MULTIPLE ZONE <input type="checkbox"/>	2. Name of Operator Skelly Oil Company	3. Address of Operator P. O. Box 1351, Midland, Texas 79701
4. Location of Well UNIT LETTER J LOCATED 1650 FEET FROM THE South LINE AND 2310 FEET FROM THE East LINE OF SEC. 32 TWP. 24 RGE. 38E NMPM		
21. Elevations (Show whether DF, RT, etc.) 3173.0' GR	21A. Kind & Status Plug. Bond Blanket Bond #1253638	21B. Drilling Contractor

23. \$100,000 w/Fed. Ins. Co.
PROPOSED CASING AND CEMENT PROGRAM

SIZE OF HOLE	SIZE OF CASING	WEIGHT PER FOOT	SETTING DEPTH	SACKS OF CEMENT	EST. TOP
17-1/2"	13-3/8" OD	43#	1200'	250 sacks	surface
11"	8-5/8" OD	24-32#	3800'	1,000 sacks	surface
7-7/8"	5-1/2" OD	15.5-17#	8000'	1,500 sacks	surface

It is proposed to drill subject well from the surface to a total depth of approximately 8000' with rotary tools to test the Devonian formation for oil. The pump and plug process will be used for cementing all strings of casing and cement will be circulated to the surface on the 13-3/8" OD, 8-5/8" OD and 5-1/2" OD casing. The 5-1/2" OD casing will be perforated as indicated by electric logs opposite the Devonian formation.

The drilling fluid will be brine water and mud of sufficient weight to condition hole for logging and running casing to 8000'. Blow out preventors will be installed and tested to 5000# pressure. (This is not a high pressure gas area.)

NOTE: A DV tool will be set at 5500' in 5-1/2" OD casing.

APPROVAL VALID
FOR 90 DAYS UNLESS
DRILLING COMMENCED,

EXPIRES March 24, 1977

IN ABOVE SPACE DESCRIBE PROPOSED PROGRAM: IF PROPOSAL IS TO DEEPEN OR PLUG BACK, GIVE DATA ON PRESENT PRODUCTIVE ZONE AND PROPOSED NEW PRODUCTIVE ZONE. GIVE BLOWOUT PREVENTER PROGRAM, IF ANY.

I hereby certify that the information above is true and complete to the best of my knowledge and belief.

(SIGNED) LELAND FRANZ
Signed Leland Franz Title District Production Manager Date 12-20-76

(This space for State Use)

APPROVED BY John W. Runyan TITLE _____ DATE 12-20-76
CONDITIONS OF APPROVAL, IF ANY:

**NEW MEXICO OIL CONSERVATION COMMISSION
WELL LOCATION AND ACREAGE DEDICATION PL.**

Form C-102
Supersedes C-128
Effective 1-1-65

All distances must be from the outer boundaries of the Section

Operator SKELLY OIL COMPANY			Lease Mexico J NC# 25		Well No. 1
Unit Letter J	Section 32	Township 24 South	Range 38 East	County Lea	
Actual Portage Location of Well: 1650 feet from the south line and 2310 feet from the east line					
Ground Level Elev. 3173.0	Producing Formation Devonian		Pool Dollarhide Devonian	Dedicated Acreage: 40 Acres	

1. Outline the acreage dedicated to the subject well by colored pencil or hachure marks on the plat below.
2. If more than one lease is dedicated to the well, outline each and identify the ownership thereof (both as to working interest and royalty).
3. If more than one lease of different ownership is dedicated to the well, have the interests of all owners been consolidated by communitization, unitization, force-pooling, etc?

☐ Yes ☐ No If answer is "yes," type of consolidation _____

If answer is "no," list the owners and tract descriptions which have actually been consolidated. (Use reverse side of this form if necessary.) _____

No allowable will be assigned to the well until all interests have been consolidated (by communitization, unitization, forced-pooling, or otherwise) or until a non-standard unit, eliminating such interests, has been approved by the Commission.

: Devonian

: Lease

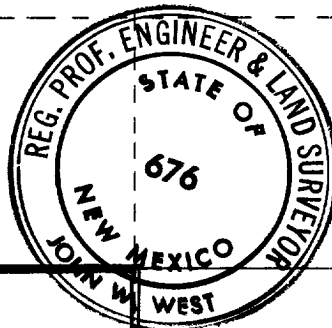

CERTIFICATION

I hereby certify that the information contained herein is true and complete to the best of my knowledge and belief.

Name
(signed) **D. R. Crow** D. R. Crow

Position
Lead Clerk

Company
Skelly Oil Company

Date
12-21-76

I hereby certify that the well location shown on this plat was plotted from field notes of actual surveys made by me or under my supervision, and that the same is true and correct to the best of my knowledge and belief.

Date Surveyed
Nov, 10, 1976

Registered Professional Engineer
and/or Land Surveyor

John W. West

Certificate No. **676**



SKELLY OIL COMPANY
WICO "J" NC 25 WELL NO. 1
5000 PSI WORKING PRESSURE
DRILLING CONTROL HOOK-UP

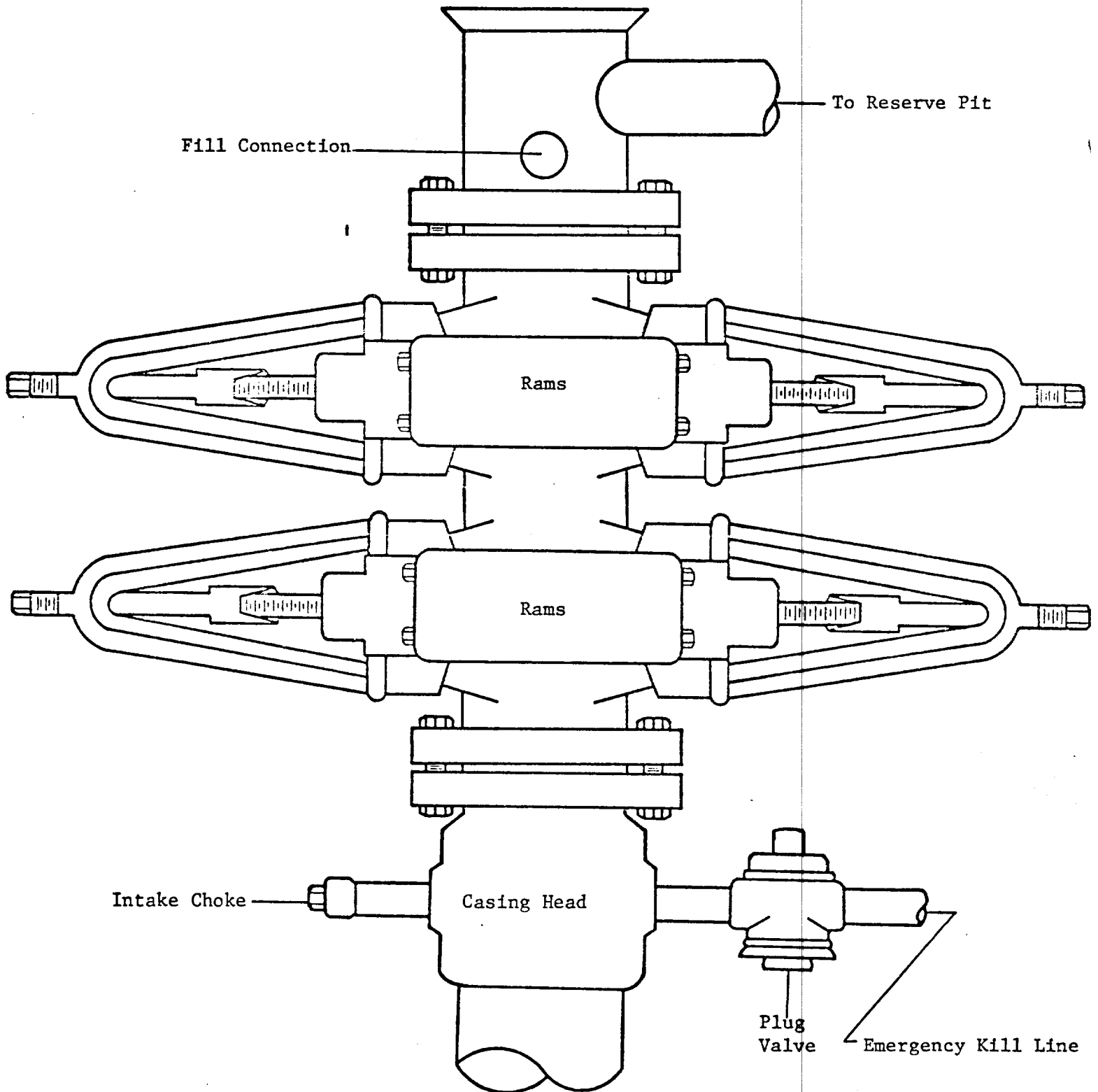

1942-1943

ON COMMISSIONER'S ORDER.
HARRIS, R. M.