

COUNTY LEA FIELD Jalmat STATE NM
 OPR BURLESON & HUFF API 30-025-23429
 NO 2 LEASE Woolworth MAP 6-2-20 NM
 Sec 33, T24S, R37E COORD
 1980' FSL, 1650' FWL Of Sec
 4 mi NE/Jal SPD 2-18-77 CMP 5-13-77

CSC 8 5/8" at 1180' w/375 SX 5 1/2" at 2974' w/100 S	WELL CLASS		INIT		FIN	
	FORMATION		DATUM		FORMATION	
TD 3218' (YTES)				PBD		

LP (Yates) OH 2974-3218' F 404 MCFGPD. Pot based on 24 hr test thru 32/64" chk. CP 140#; TP 65#

CONTR Paul's Drlg. OPRSELEV 3257' GL PD 3250' RT

F.R. 1-10-77
 (Yates)
 2-22-77 TD 1180'; WOC
 3-1-77 TD 2978'; Prep Deepen
 3-8-77 TD 2978'; WOCU
 3-15-77 TD 2978'; WOCU
 3-22-77 TD 2978'; Prep Drill
 4-5-77 TD 3218'; Prep Acid
 4-26-77 TD 3218'; Prep Frac
 Acid (2974-3218') 500 gals
 5-18-77 TD 3218'; Tstg
 Frac (2974-3218') 10,000 gals + 57,000# sd
 5-24-77 TD 3218'; WOSP
 Flwd 404 MCFGPD thru 1/2" chk, CP 140#, TP 65#
 (2974-3218')

6-2-20 NM

LEA
BURLESON & HUFF

Jalmat
2 Woolworth
Sec 33, T24S, R37E

NG
Page #2

6-6-77

TD 3218'; Complete

6-11-77

LOG TOPS: Rustler Anhydrite 1165', Yates 810'
COMPLETION ISSUED

6-2-20 NM
IC 30-025-70004-77

NEW MEXICO OIL CONSERVATION COMMISSION
WELL LOCATION AND ACREAGE DEDICATION PLAT

Form C-102
Supersedes C-128
Effective 1-1-65

All distances must be from the outer boundaries of the Section

Operator BURLESON & HUFF			Lease Woolworth		Well No. 2
Tract Letter K	Section 33	Township 24 South	Range 37 East	County Lea	
Actual Footage Location of Well:					
1980		feet from the	south	line and	1650
				feet from the	west
Ground Level Elev. 3257.3	Producing Formation Yates		Pool Jalmat	Dedicated Acreage: 80	

1. Outline the acreage dedicated to the subject well by colored pencil or hatchure marks on the plat below.
2. If more than one lease is dedicated to the well, outline each and identify the ownership thereof (both as to working interest and royalty).
3. If more than one lease of different ownership is dedicated to the well, have the interests of all owners been consolidated by communitization, unitization, force-pooling, etc?

☐ Yes ☐ No If answer is "yes," type of consolidation _____

If answer is "no," list the owners and tract descriptions which have actually been consolidated (Use reverse side of this form if necessary.) _____

No allowable will be assigned to the well until all interests have been consolidated (by communitization, unitization, forced-pooling, or otherwise) or until a non-standard unit, eliminating such interests, has been approved by the Commission.

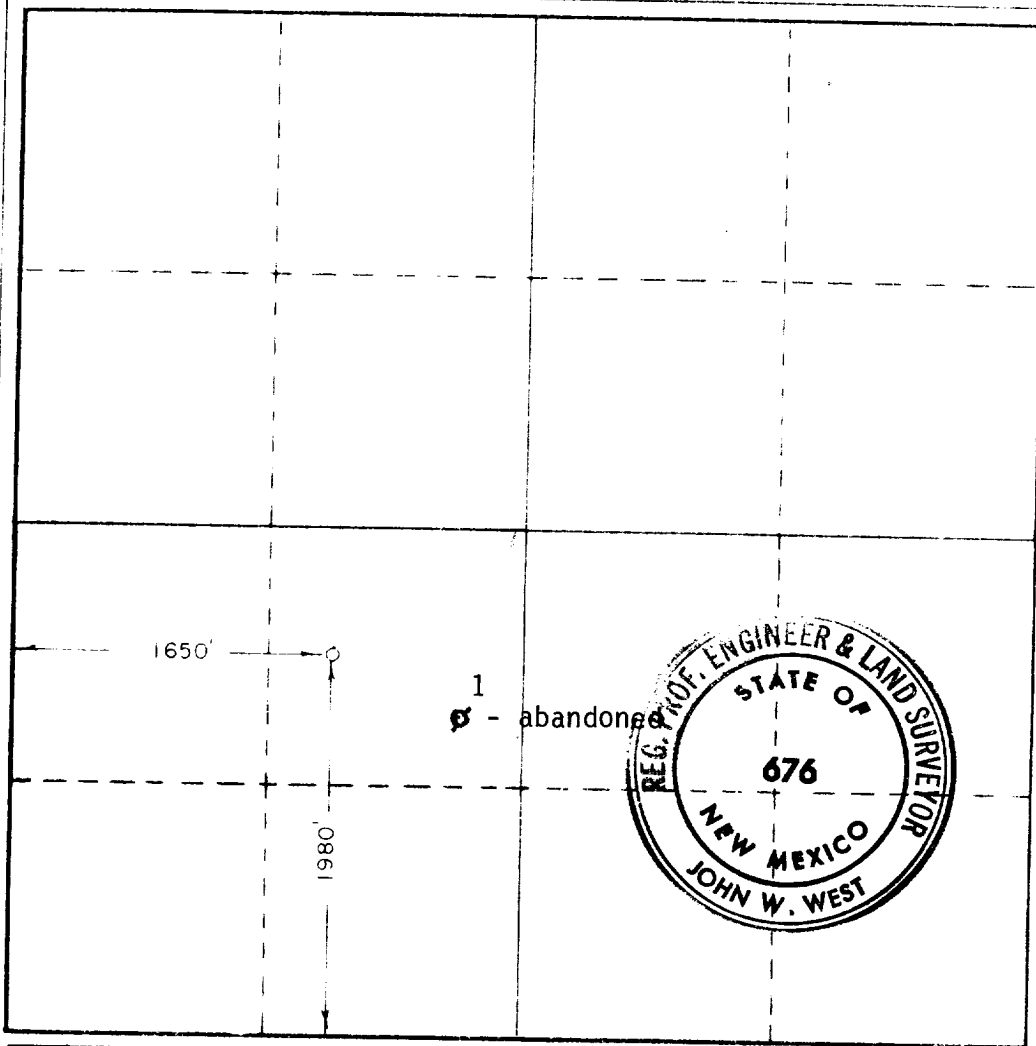

CERTIFICATION

I hereby certify that the information contained herein is true and complete to the best of my knowledge and belief.

John W. West

Register

Co-Owner

Burleson & Huff

Date
Dec. 27, 1976

I hereby certify that the well location shown on this plat was plotted from notes of actual surveys made by under my supervision, and that it is true and correct to the best of my knowledge and belief.

Date Surveyed
Dec. 17, 1976
Registered Professional Engineer and/or Land Surveyor

John W. West

Certificate No. 676

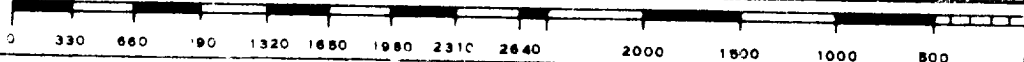

RECEIVED

JAN 3 1977

OIL CONSERVATION COMM.
HOBBS, N. M.