

North American Producing Division  
Permian Dist  
Post Office Box 1610  
Midland, Texas 79701  
Telephone 915 682 8631

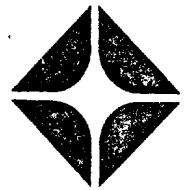

OK JS

August 30, 1977

Mr. Joe Ramey  
New Mexico Oil Conservation Commission  
P. O. Box 2088  
Santa Fe, New Mexico 87501

Re: Wimberly WN No. 11  
Unorthodox Location  
Justis Montoya Pool  
990' FNL and 1490' FWL  
Section 24, T-25S, R-37E  
Lea County, New Mexico

Dear Mr. Ramey:

Atlantic Richfield Company respectfully requests administrative approval of an unorthodox location for a Justis Montoya development oil well located 990' FNL and 1490' FWL of Section 24, Township 25 South, Range 37 East, Lea County, New Mexico. This well was spudded 6/21/77 and reached total depth of 7375 feet on 7/18/77. It is currently undergoing testing. The subject well was designated as a Justis Fusselman well and approval for an unorthodox location in the Justis Fusselman pool was given by New Mexico Oil Conservation Commission Order No. R-5430 on May 24, 1977.

Testing of several zones within the Fusselman and Montoya formations has indicated that the Fusselman is not as good as we had anticipated and it appears that the Montoya is a better producer. Our plans are to complete this well in the Montoya as a single oil well. To produce the Montoya from a standard location would necessitate the drilling of another well which we believe would be an unnecessary waste of money.

Statewide Rule 104 specifies that a standard development oil well location be located not closer than 330 feet to the boundary of the 40-acre tract in which it is located. There are no other Montoya producers on our Wimberly WN lease. We, therefore, believe that approval of this application will enable Atlantic Richfield Company to more efficiently recover Montoya reserves under this tract. Furthermore, Atlantic Richfield Company believes that approval of this application will be in the interest of conservation, prevention of waste, and the protection of correlative rights.

Mr. Joe Ramey  
New Mexico Oil Conservation Commission  
August 30, 1977  
Page 2

Attached are a well location and acreage dedication plat,  
a map showing offset operators, and a list of the offset  
operators who are being notified by registered mail with  
a copy of this application.

Thank you for your consideration.

Very truly yours,

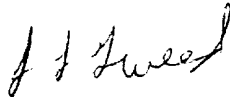
A handwritten signature in cursive script, appearing to read "J. L. Tweed".

J. L. Tweed

CGR/agp

cc: Area Supervisor  
New Mexico Oil Conservation Commission  
Box 1980  
Hobbs, New Mexico

OFFSET OPERATORS  
Wimberly WN No. 11

Amerada Hess Corporation  
Drawer 817  
Seminole, Texas 79360

Amoco Production Company  
Drawer A  
Levelland, Texas 79336

Cities Service Oil Company  
Box 1919  
Midland, Texas 79702

El Paso Natural Gas Company  
600 Bldg. of the Southwest  
Midland, Texas 79701

Getty Oil Company  
Box 1231  
Midland, Texas 79702

Gulf Energy & Minerals Company - US  
Box 1150  
Midland, Texas 79702

Mobil Oil Corporation  
Box 633  
Midland, Texas 79702

Terra Resources, Inc.  
Box 2329  
Tulsa, Oklahoma 74101

Texas Pacific Oil Company, Inc.  
Box 4067  
Midland, Texas 79702

Union Texas Petroleum  
1300 Wilco Bldg.  
Midland, Texas 79701

Westates Petroleum Company  
Box "SS"  
Jal, New Mexico 88252

**NEW MEXICO OIL CONSERVATION COMMISSION  
WELL LOCATION AND ACREAGE DEDICATION PLAT**

Form C-102  
Supersedes C-128  
Effective 1-1-65

All distances must be from the outer boundaries of the Section.

Operator <b>Atlantic Richfield Company</b>			Lease <b>Wimberly WN</b>		Well No. <b>11</b>
Unit Letter <b>C</b>	Section <b>24</b>	Township <b>25 South</b>	Range <b>37 East</b>	County <b>Lea</b>	
Actual Footage Location of Well: <b>990</b> feet from the <b>north</b> line and <b>1490</b> feet from the <b>west</b> line					
Ground Level Elev: <b>3067.9'</b>	Producing Formation <b>Montoya</b>		Pool <b>Justis Montoya</b>		Dedicated Acreage: <b>40</b> Acres

1. Outline the acreage dedicated to the subject well by colored pencil or hachure marks on the plat below.
2. If more than one lease is dedicated to the well, outline each and identify the ownership thereof (both as to working interest and royalty).
3. If more than one lease of different ownership is dedicated to the well, have the interests of all owners been consolidated by communitization, unitization, force-pooling, etc?  
  
☐ Yes    ☐ No    If answer is "yes," type of consolidation \_\_\_\_\_

If answer is "no," list the owners and tract descriptions which have actually been consolidated. (Use reverse side of this form if necessary.) \_\_\_\_\_

No allowable will be assigned to the well until all interests have been consolidated (by communitization, unitization, forced-pooling, or otherwise) or until a non-standard unit, eliminating such interests, has been approved by the Commission.

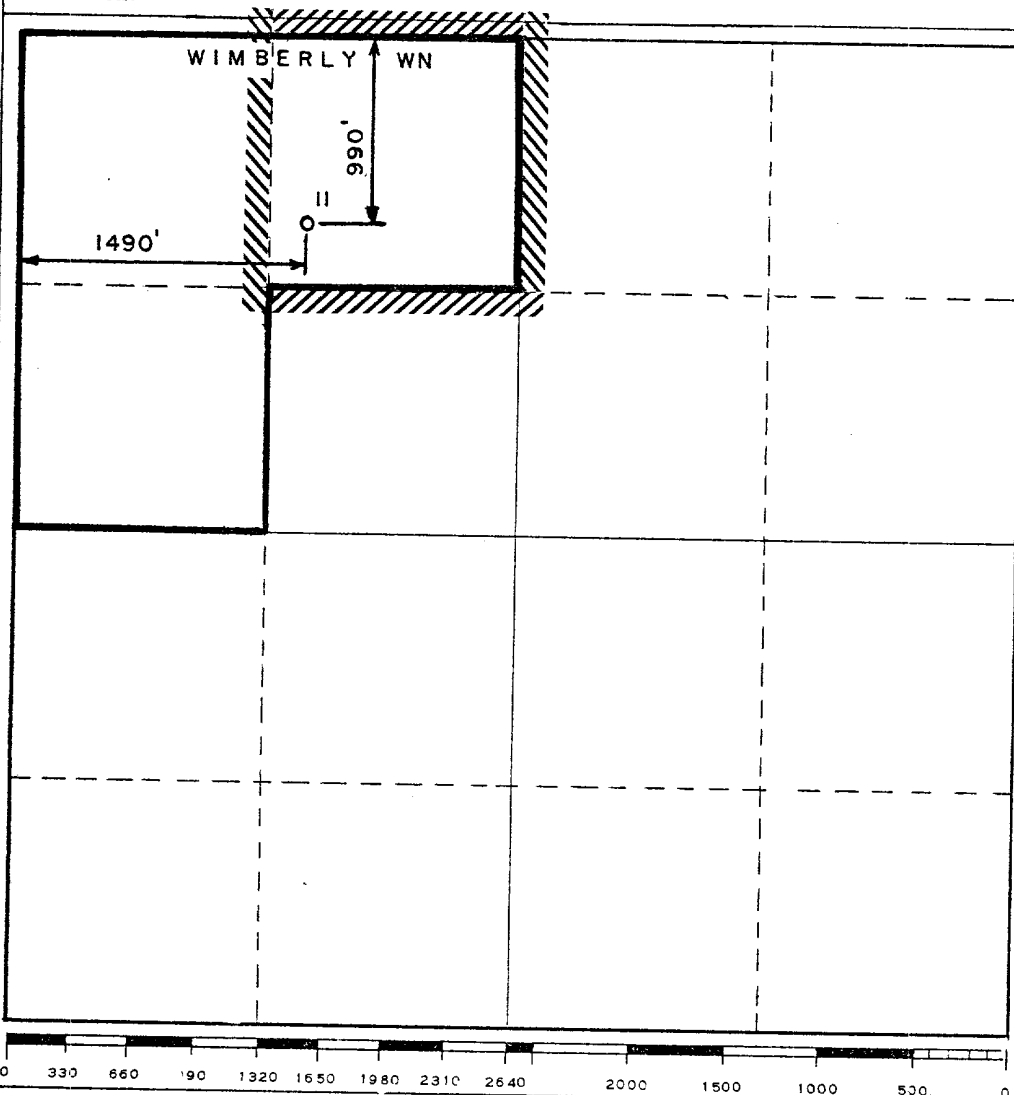

**CERTIFICATION**

*I hereby certify that the information contained herein is true and complete to the best of my knowledge and belief.*

*Cris G. Rhodes*

Name  
**Cris G. Rhodes**  
Position  
**Operations Engineer**  
Company  
**Atlantic Richfield Company**  
Date  
**August 30, 1977**

*I hereby certify that the well location shown on this plat was plotted from field notes of actual surveys made by me or under my supervision, and that the same is true and correct to the best of my knowledge and belief.*

Date Surveyed  
  
Registered Professional Engineer and/or Land Surveyor  
  
Certificate No.

R 37 E

R 38 E

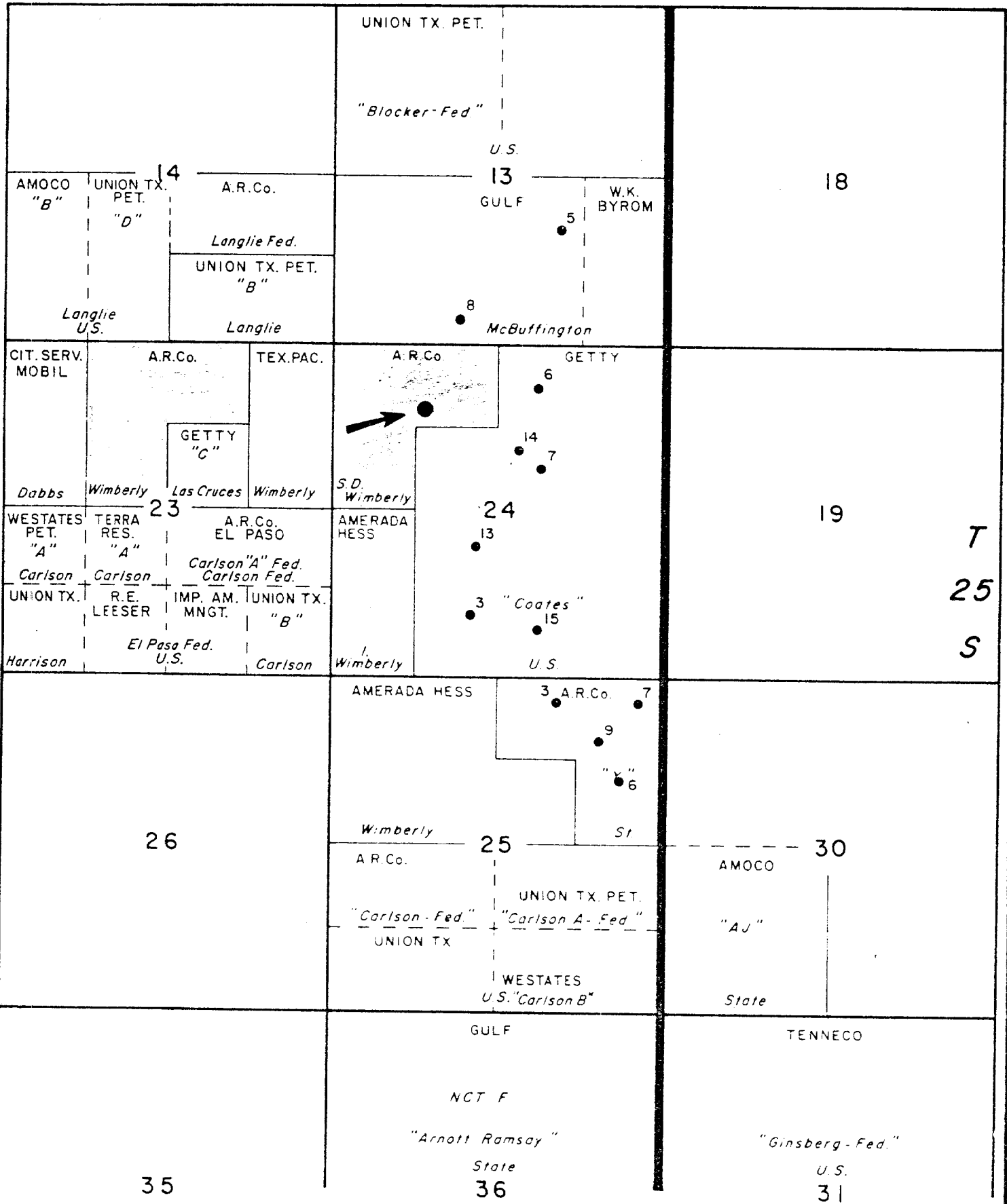

Atlantic Richfield Company

North American Producing Division  
 Permian District, Mid and Texas

JUSTIS  
 MONTOYA POOL  
 LEA COUNTY, NEW MEXICO

CURRENT MONTOYA  
 PRODUCERS

SCALE 1" = 2000'

C. G. RHODES  
 8-77  
 WEST AREA ENGR.

8-77