

NEW MEXICO OIL CONSERVATION COMMISSION
WELL LOCATION AND ACREAGE DEDICATION PLAT

Form O-128
Supersedes O-128
Effective 1-1-65

All distances must be from the outer boundaries of the Section

Operator Continental Oil Co.		Lease Jack B-17		Well No. 6	
Tract Number F	Section 17	Range 24 South	Meridian 37 East	County Lea	
Actual Well Location of Head					
1980		feet from the North		1980	
		line and		feet from the West	
Ground Survey File 3280.1	Producing Form # PENROSE	Owner LANGLIE MATTIX		Estimated Acreage 40	

1. Outline the acreage dedicated to the subject well by colored pencil or hatchure marks on the plat below.
2. If more than one lease is dedicated to the well, outline each and identify the ownership thereof (both as to working interest and royalty).
3. If more than one lease of different ownership is dedicated to the well, have the interests of all owners been consolidated by communitization, unitization, force-pooling, etc?

☐ Yes ☐ No If answer is "yes," type of consolidation _____

If answer is "no," list the owners and tract descriptions which have actually been consolidated. (Use reverse side of this form if necessary.) _____

No allowable will be assigned to the well until all interests have been consolidated (by communitization, unitization, forced-pooling, or otherwise) or until a non-standard unit, eliminating such interests, has been approved by the Commission.

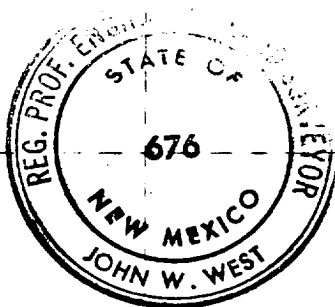
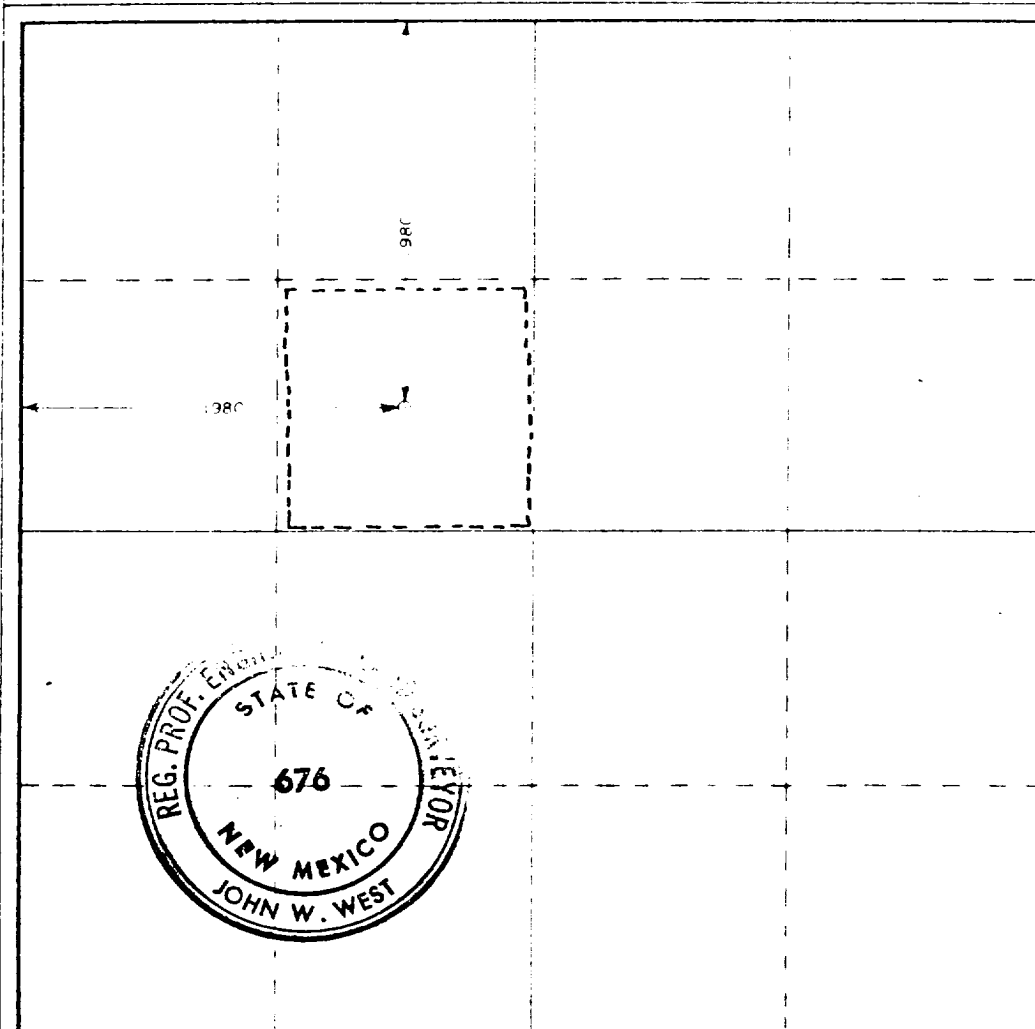

CERTIFICATION

I hereby certify that the information contained herein is true and complete to the best of my knowledge and belief.

By Bern A. Lee
Administrative Supervisor
Continental Oil Co

4-20-79

I hereby certify that the well location shown on this plat was plotted from field notes of actual surveys made by me or under my supervision, and that the same is true and correct to the best of my knowledge and belief.

March 24, 1979

Registered Professional Engineer
No. 676

John W. West
Certificate No. John W. West 676
Ronald J. Eidson 7079

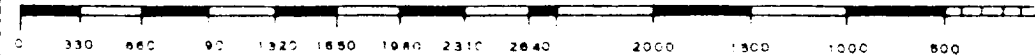

RECEIVED
MAY - 1 1979
OIL CONSTRUCTION COMM.
HONOLULU, HI.