

NEW MEXICO OIL CONSERVATION COMMISSION
WELL LOCATION AND ACREAGE DEDICATION PLAT

Form C-142
Supersedes C-128
Effective 1-1-65

All distances must be from the outer boundaries of the Section.

Operator GETTY OIL COMPANY			Lease Mexico 'J'		Well No. 26
Map Letter "H"	Section 32	Township 24 South	Range 38 East	County Lea	
A. Well Location of Well:					
990 feet from the South line and		990 feet from the West line		Bore	
Ground Elevation 3138.7	Producing Formation Fusselman		Pool Dollarhide Fusselman		Estimated Acreage 40

1. Outline the acreage dedicated to the subject well by colored pencil or hatchure marks on the plat below.
2. If more than one lease is dedicated to the well, outline each and identify the ownership thereof (both as to working interest and royalty).
3. If more than one lease of different ownership is dedicated to the well, have the interests of all owners been consolidated by communitization, unitization, force-pooling, etc?

☒ Yes ☐ No If answer is "yes," type of consolidation _____

If answer is "no," list the owners and tract descriptions which have actually been consolidated. (Use reverse side of this form if necessary.) _____

No allowable will be assigned to the well until all interests have been consolidated (by communitization, unitization, force-pooling, or otherwise) or until a non-standard unit, eliminating such interests, has been approved by the Commission.

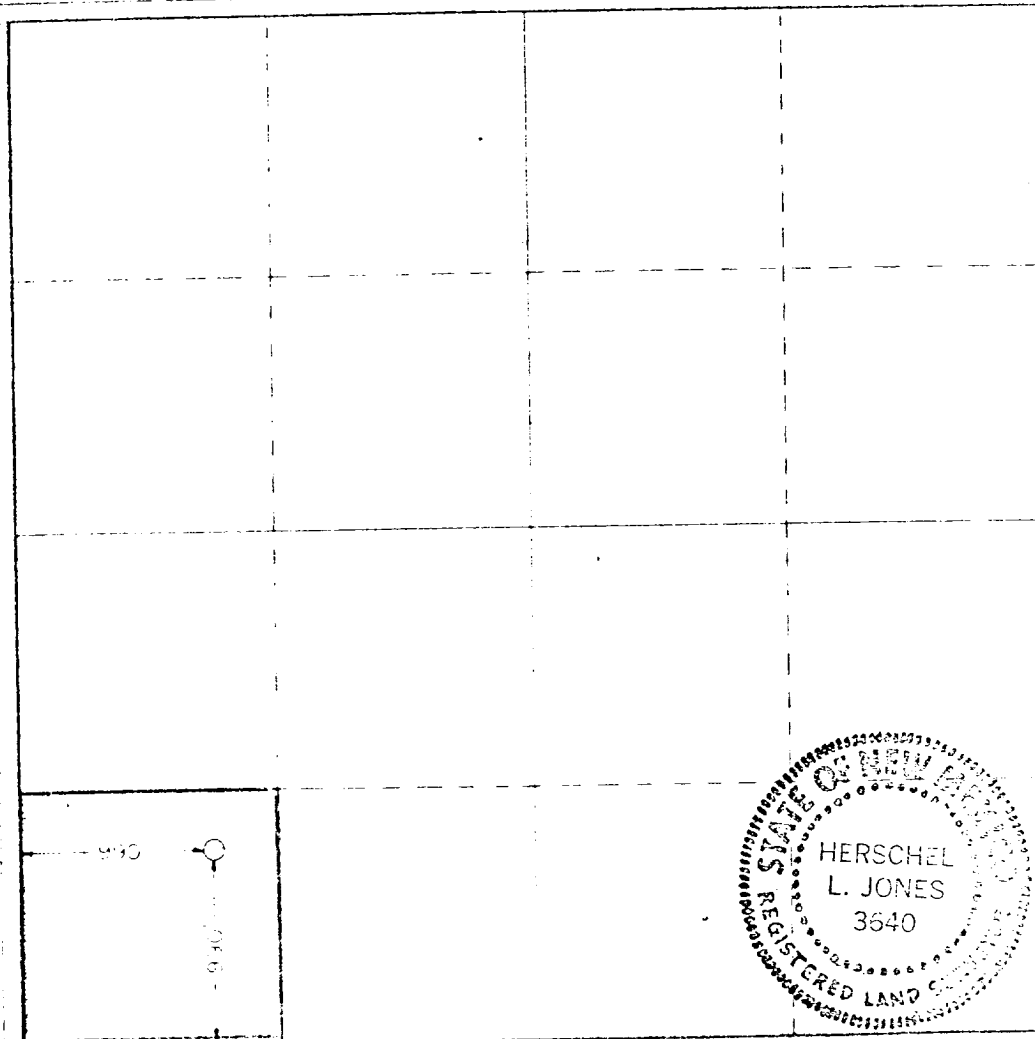

CERTIFICATION

I hereby certify that the information contained herein is true and complete to the best of my knowledge and belief.

Nathaniel Barker

Area Superintendent

Getty Oil Company

October 24, 1979

I hereby certify that the well location shown on this plat was plotted from field notes of actual surveys made by me or under my supervision, and that the same is true and correct to the best of my knowledge and belief.

Date Surveyed
October 17, 1979
Registered Professional Engineer
No. 10,000 License No. 1

[Signature]
Herschel L. Jones

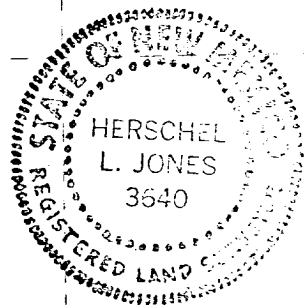

RECEIVED
OCT 2 1957
O.C.D. HOBBS, OFFICE

1047