

**NEW MEXICO OIL CONSERVATION COMMISSION
WELL LOCATION AND ACREAGE DEDICATION PLAT**

N.C. 102
Revised 6-1-78
Effective 1-1-79

All distances must be from the outer boundaries of the Section

Operator CONOCO, Inc.			Lease Wells B1		Well No. 5
Tract Letter H	Section 1	Township 25 South	Range 36 East	County Lea	
Actual Well Location of Well:					
1650		feet from the North	line and	660	feet from the East
Ground Level Elev. 3232.3	Producing Formation Devonian / Ellenburger		Pool Custer Devonian / Custer Ellenburger		Dedicated Acreage 320

1. Outline the acreage dedicated to the subject well by colored pencil or hatchure mark on the plat below.
2. If more than one lease is dedicated to the well, outline each and identify the ownership thereof (both as to working interest and royalty).
3. If more than one lease of different ownership is dedicated to the well, have the interests of all owners been consolidated by communitization, unitization, force-pooling, etc?

☐ Yes ☐ No If answer is "yes," type of consolidation _____

If answer is "no," list the owners and tract descriptions which have actually been consolidated. (Use reverse side of this form if necessary.) _____

No allowable will be assigned to the well until all interests have been consolidated (by communitization, unitization, forced-pooling, or otherwise) or until a non-standard unit, eliminating such interests, has been approved by the Commission.

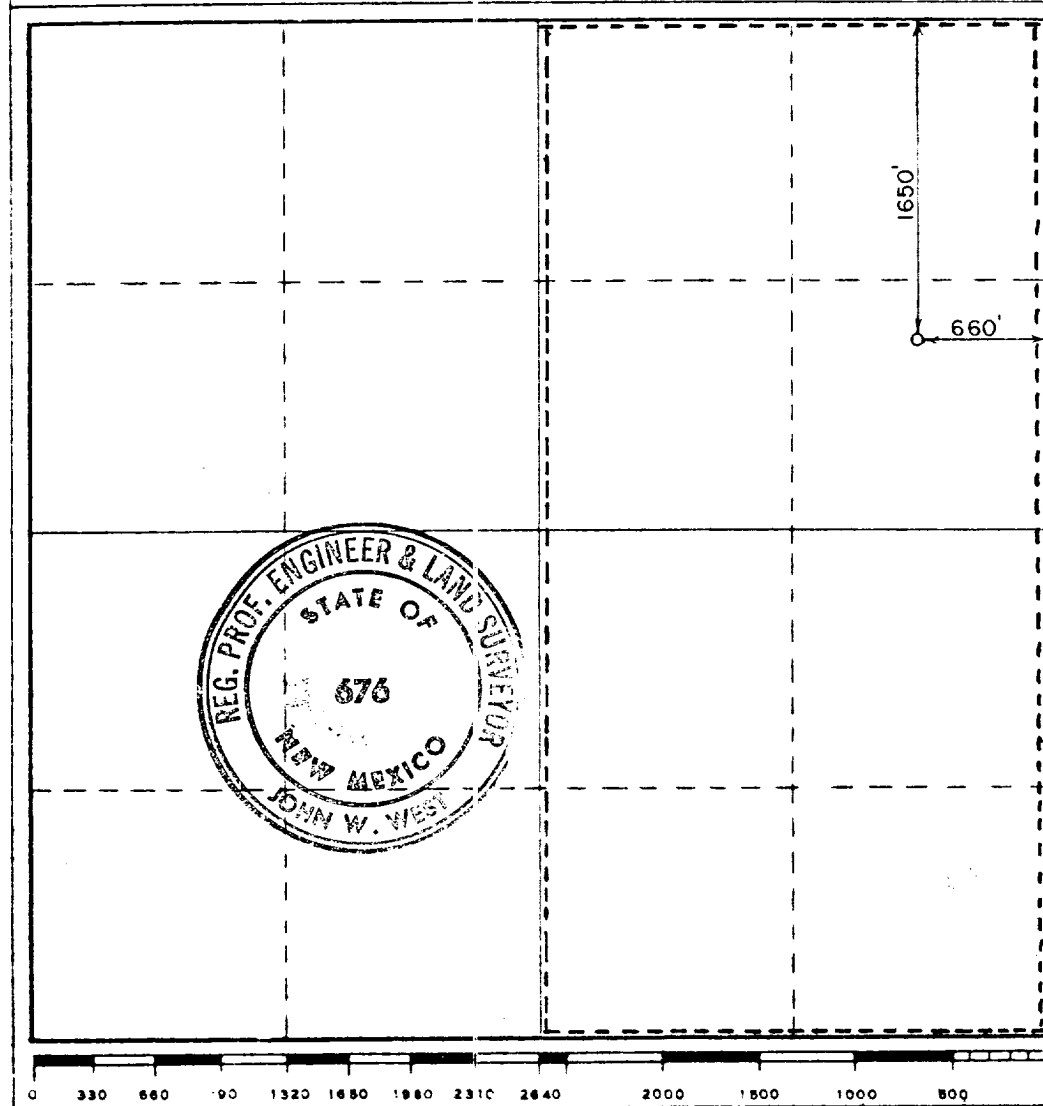

CERTIFICATION

I hereby certify that the information contained herein is true and complete to the best of my knowledge and belief.

John A. Butterfield

Administrative Supervisor

Company
Conoco Inc.

Date
11/1/79

I hereby certify that the well location shown on this plat was plotted from field notes of actual surveys made by me or under my supervision, and that the same is true and correct to the best of my knowledge and belief.

Date Surveyed

October 1, 1979

Registered Professional Engineer and/or Land Surveyor

John W. West

Certificate No. **John W. West 676**

Ronald J. Eidson 3235