

**NEW MEXICO OIL CONSERVATION COMMISSION
WELL LOCATION AND ACREAGE DEDICATION PLAT**

Form C-107
Supersedes C-128
Effective 1-1-65

All distances must be from the outer boundaries of the Section

Operator ALPHA TWENTY-ONE PRODUCTION COMPANY			Lease EL PASO RUBY FID.		Well No. 1
Unit Letter O	Section 8	Township 27 SOUTH	Range 37 EAST	County LEA	
Actual Footage Location of Well: <div style="display: flex; justify-content: space-between;"> 1880 feet from the EAST line and 660 feet from the SOUTH line </div>					
Ground Level Elev 3132.3	Producing Formation Yates		Pool Jalmat (Gas)		Dedicated Acreage: 120 Acres

1. Outline the acreage dedicated to the subject well by colored pencil or hatchure marks on the plat below.
2. If more than one lease is dedicated to the well, outline each and identify the ownership thereof (both as to working interest and royalty).
3. If more than one lease of different ownership is dedicated to the well, have the interests of all owners been consolidated by communitization, unitization, force-pooling, etc?

☐ Yes ☐ No If answer is "yes," type of consolidation _____

If answer is "no," list the owners and tract descriptions which have actually been consolidated. (Use reverse side of this form if necessary.) _____

No allowable will be assigned to the well until all interests have been consolidated (by communitization, unitization, forced-pooling, or otherwise) or until a non-standard unit, eliminating such interests, has been approved by the Commission.

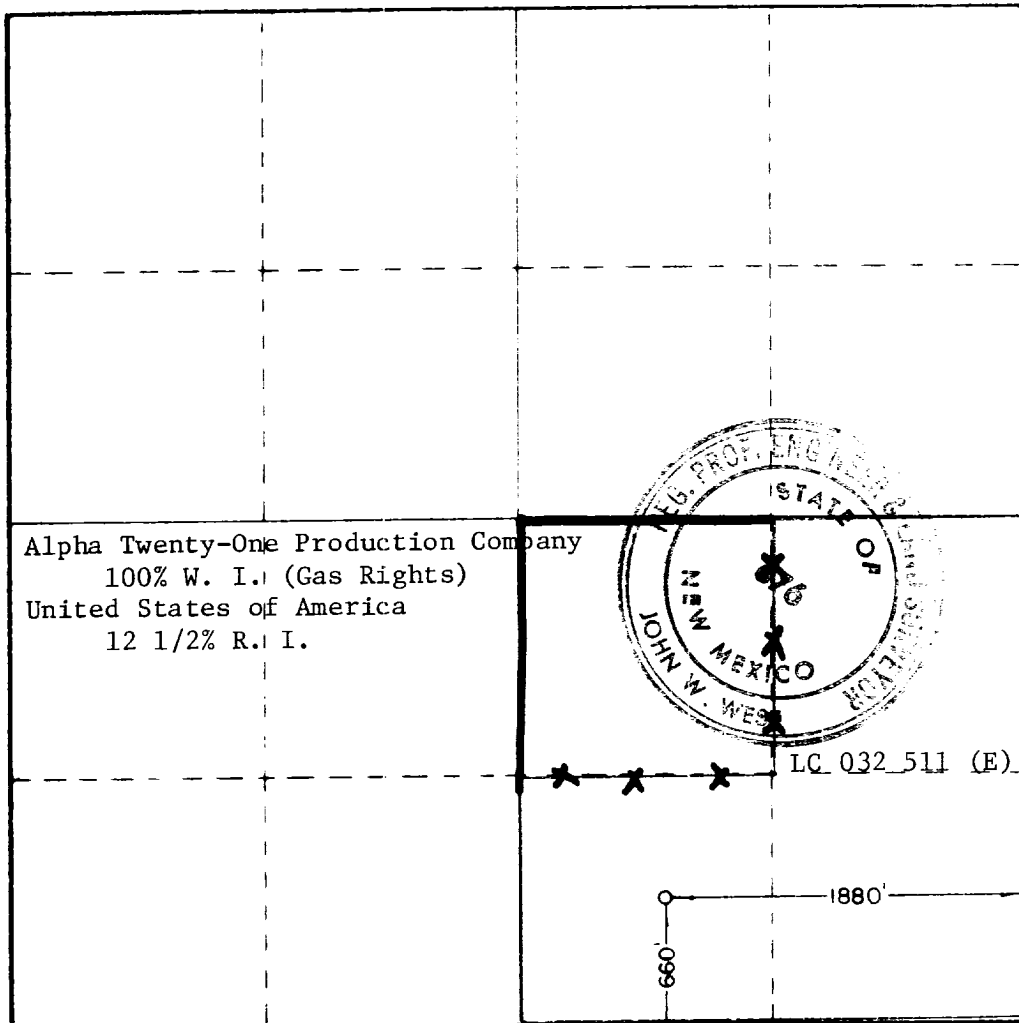

Alpha Twenty-One Production Company
100% W. I. (Gas Rights)
United States of America
12 1/2% R. I.

CERTIFICATION

I hereby certify that the information contained herein is true and complete to the best of my knowledge and belief.

Tommy Phipps
Name

Tommy Phipps

Position

Executive Vice President

Company

Alpha Twenty-One Production Co.

Date

8-30-79

I hereby certify that the well location shown on this plat was plotted from field notes of actual surveys made by me or under my supervision, and that the same is true and correct to the best of my knowledge and belief.

Date Surveyed

JULY 10TH, 1979

Registered Professional Engineer
and Professional Surveyor

John W. West

Certificate No. **John W. West**

676

Ronald J. Eidson

3239