

NEW MEXICO OIL CONSERVATION COMMISSION
WELL LOCATION AND ACREAGE DEDICATION PLAT

Form O-12
Sup. Order 1-78
Rev. 1-1-65

All distances must be from the outer boundaries of the Section

Doyle Hartman			Lease El Paso Wells Federal El Paso Federal		Well No. 1
Unit Letter E	Section 4	Township 25 South	Range 37 East	County Lea	
Actual Forfeiture Location of Well: 1980 feet from the North line and 660 feet from the West line					
Ground Level Elev. 3220	Producing Formation Yates - Seven Rivers		Pool Jalmat	Dedicated Acreage: 160.45	

1. Outline the acreage dedicated to the subject well by colored pencil or hatchure marks on the plat below.
2. If more than one lease is dedicated to the well, outline each and identify the ownership thereof (both as to working interest and royalty).
3. If more than one lease of different ownership is dedicated to the well, have the interests of all owners been consolidated by communitization, unitization, force-pooling, etc?

☐ Yes ☐ No If answer is "yes," type of consolidation Over

If answer is "no," list the owners and tract descriptions which have actually been consolidated. (Use reverse side of this form if necessary.)

No allowable will be assigned to the well until all interests have been consolidated (by communitization, unitization, forced-pooling, or otherwise) or until a non-standard unit, eliminating such interests, has been approved by the Commission.

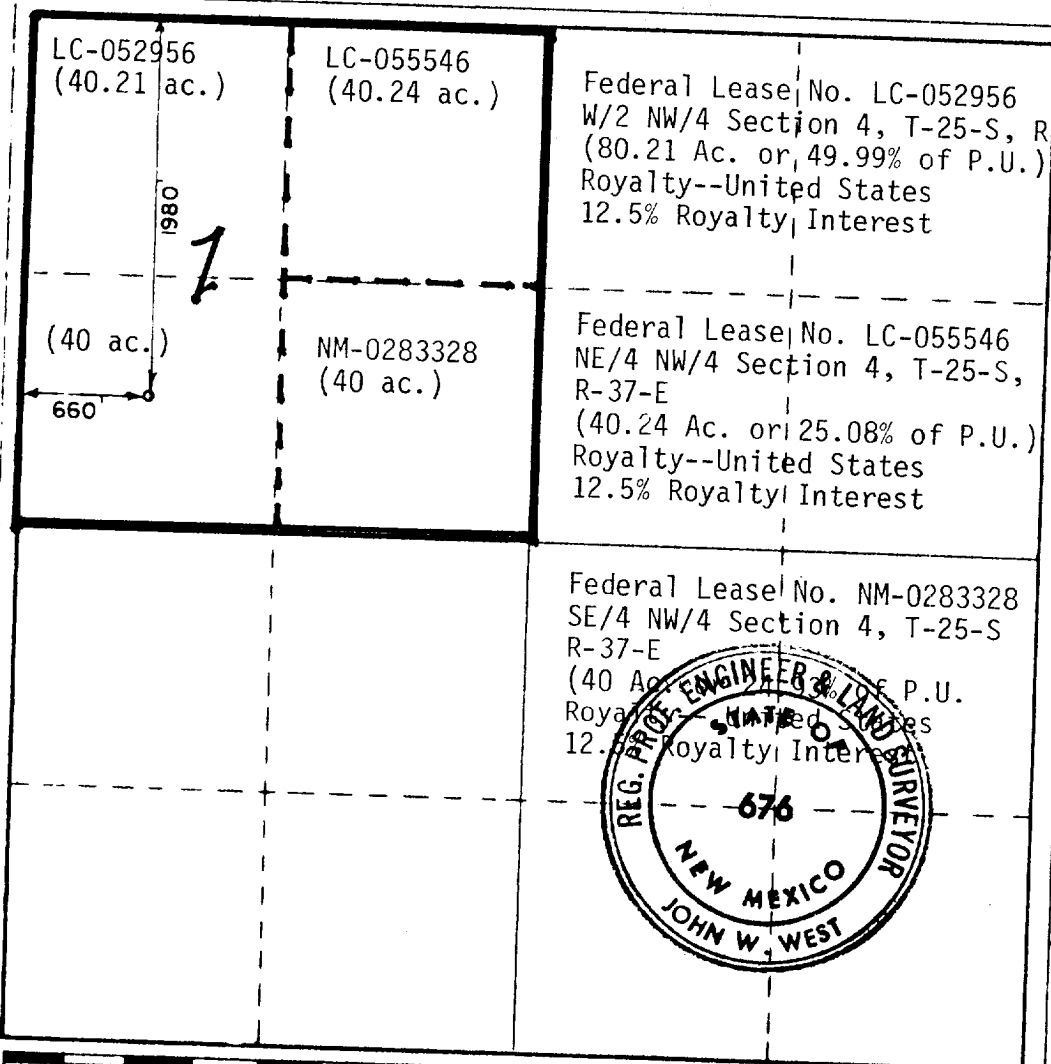

CERTIFICATION

I hereby certify that the information contained herein is true and complete to the best of my knowledge and belief

Larry A. Nermyr

Name
Larry A. Nermyr

Position
Engineer

Company
Doyle Hartman, Oil Operat

Date

May

I hereby certify that the well location shown on this plat was plotted from notes of actual surveys made by me under my supervision, and that the same is true and correct to the best of my knowledge and belief.

Date Surveyed

5-13-1980

Registered Professional Engineer and/or Land Surveyor

John W. West
Certificate No. JOHN W. WEST
PATRICK A. ROM
Ronald J. Eids

0 330 660 990 1320 1650 1980 2310 2640 2970 3300 3630 3960 4290 4620 4950 5280 5610 5940 6270 6600 6930 7260 7590 7920 8250 8580 8910 9240 9570 9900