

UNITED STATES
DEPARTMENT OF THE INTERIOR
GEOLOGICAL SURVEY30-025-27079
5. LEASE DESIGNATION AND SERIAL NO.
NM 13834

APPLICATION FOR PERMIT TO DRILL, DEEPEN, OR PLUG BACK

1a. TYPE OF WORK

DRILL ☒DEEPEN ☐PLUG BACK ☐

b. TYPE OF WELL

OIL
WELL ☒GAS
WELL ☐

OTHER

SINGLE
ZONE ☒MULTIPLE
ZONE ☐

2. NAME OF OPERATOR

DISCOVERY OPERATING, INC.

3. ADDRESS OF OPERATOR

800 WEST WALL, MIDLAND, TEXAS 79701

4. LOCATION OF WELL (Report location clearly and in accordance with any State requirements.)

At surface

467' FSL AND 330' FWL OF SECTION 34

At proposed prod. zone

14. DISTANCE IN MILES AND DIRECTION FROM NEAREST TOWN OR POST OFFICE*

28 MILES WEST OF JAL, NEW MEXICO

15. DISTANCE FROM PROPOSED*

LOCATION TO NEAREST
PROPERTY OR LEASE LINE, FT.
(Also to nearest drlg. unit line, if any)

330'

18. DISTANCE FROM PROPOSED LOCATION*
TO NEAREST WELL, DRILLING COMPLETED,
OR APPLIED FOR, ON THIS LEASE, FT.

--

16. NO. OF ACRES IN LEASE

120

17. NO. OF ACRES ASSIGNED
TO THIS WELL

40

19. PROPOSED DEPTH

5000

20. ROTARY OR CABLE TOOLS

ROTARY

21. ELEVATIONS (Show whether DF, RT, GR, etc.)

3315.3 GR

22. APPROX. DATE WORK WILL START*

AUGUST 20, 1980

23.

PROPOSED CASING AND CEMENTING PROGRAM

SIZE OF HOLE	SIZE OF CASING	WEIGHT PER FOOT	SETTING DEPTH	QUANTITY OF CEMENT
12-1/4"	8-5/8"	24# J-55	900	SUFFICIENT TO CIRCULATE
7-7/8"	4-1/2"	9.5# H-40, J-55	5000	150 SACKS

SEE ATTACHED FOR: SUPPLEMENTAL DRILLING DATA
BOP SKETCH
SURFACE USE AND OPERATIONS PLAN

IN ABOVE SPACE DESCRIBE PROPOSED PROGRAM: If proposal is to deepen or plug back, give data on present productive zone and proposed new productive zone. If proposal is to drill or deepen directionally, give pertinent data on subsurface locations and measured and true vertical depths. Give blowout preventer program, if any.

24.

SIGNED

Arthur R. Brown

Agent for

DISCOVERY OPERATING, INC.

DATE JULY 31, 1980

(This space for Federal or State office use)

PERMIT NO.

APPROVAL DATE

APPROVED BY

(Orig. Ind.) PETER W. CHESTER

TITLE

ACTING DISTRICT ENGINEER

DATE

SEP 26 1980

CONDITIONS OF APPROVAL, IF ANY:

NE EXICO OIL CONSERVATION COMMISSIC
WELL LOCATION AND ACREAGE DEDICATION PLAT

Form C-101
Supersedes C-128
Effective 1-1-65

All distances must be from the outer boundaries of the Section

Operator Discovery Operating Inc.,			Lease DOI Federal		Well No. 1
Section M	Section 34	Township 25 South	Range 32 East	County Lea	
Actual Footage Location of Well: 467 feet from the South line and 330 feet from the West line					
Ground Level Elev. 3315.3	Producing Formation DELAWARE	Pool: UNDESIGNATED JENNINGS DELAWARE ASSOCIATED		Dedicated Acreage: 40	

1. Outline the acreage dedicated to the subject well by colored pencil or hachure marks on the plat below.
2. If more than one lease is dedicated to the well, outline each and identify the ownership thereof (both as to working interest and royalty).
3. If more than one lease of different ownership is dedicated to the well, have the interests of all owners been consolidated by communitization, unitization, force-pooling, etc?

☐ Yes ☐ No If answer is "yes," type of consolidation _____

If answer is "no," list the owners and tract descriptions which have actually been consolidated. (Use reverse side of this form if necessary.) _____

No allowable will be assigned to the well until all interests have been consolidated (by communitization, unitization, forced-pooling, or otherwise) or until a non-standard unit, eliminating such interests, has been approved by the Commission.

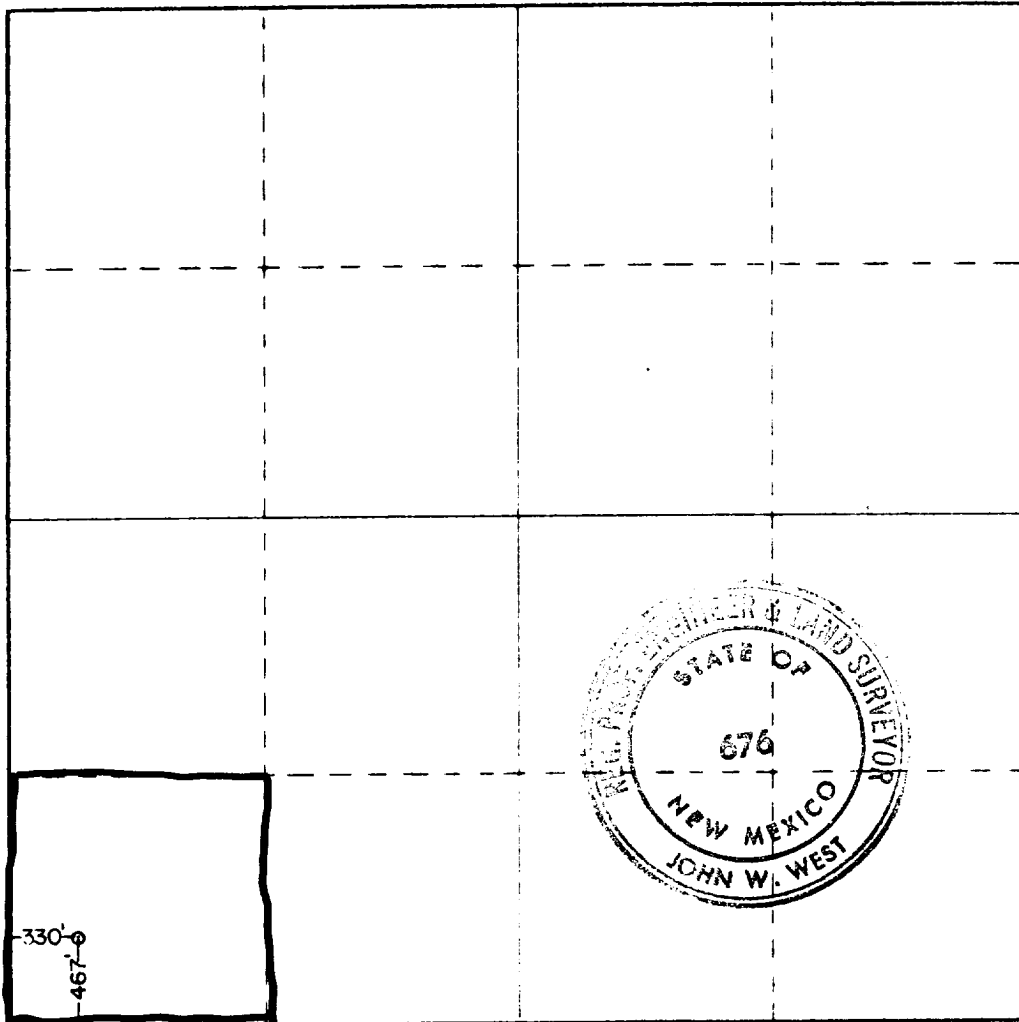

CERTIFICATION

I hereby certify that the information contained herein is true and complete to the best of my knowledge and belief.

Arthur R. Brown
Arthur R. Brown

Position
Agent for

Company
DISCOVERY OPERATING, INC.

Date
JULY 31, 1980

I hereby certify that the well location shown on this plat was plotted from field notes of actual surveys made by me or under my supervision, and that the same is true and correct to the best of my knowledge and belief.

Date Surveyed
July 23, 1980

Registered Professional Engineer and Land Surveyor

John W. West
Certificate No. **JOHN W. WEST 676**
PATRICK A. ROMERO 6663
Ronald J. Eidson 3239

SUPPLEMENTAL DRILLING DATA

DISCOVERY OPERATING, INC.
WELL NO.1 DOI FEDERAL

1. SURFACE FORMATION: Quaternary.

2. ESTIMATED TOPS OF GEOLOGIC MARKERS:

Rustler	850
Base Castile	4400
Delaware Lime	4550
Delaware Sand	4590

3. ANTICIPATED POSSIBLE WATER AND HYDROCARBON BEARING ZONES:

Fresh Water	Above 500 feet
Oil	Delaware Sand

4. PROPOSED CASING AND CEMENTING PROGRAM:

CASING SIZE	SETTING DEPTH		WEIGHT	GRADE	JOINT
	FROM	TO			
8-5/8"	0	900	24#	J-55	STC
4-1/2"	0	4400	9.5#	H-40	STC
"	4400	5000	9.5#	J-55	STC

8-5/8" casing will be cemented with sufficient cement to circulate.

4-1/2" casing will be cemented with 150 sacks of cement.

5. PRESSURE CONTROL EQUIPMENT:

Blowout preventer equipment will consist of a double ram, Series 600 preventer with pipe and blind rams.

A sketch of the BOP stack is attached.

6. CIRCULATING MEDIUM:

Surface to 900 feet; Fresh water with gel or lime as needed for viscosity control.

900 feet to Total Depth: Brine fluid treated as necessary for control of viscosity and water-loss, and for well control.

7. AUXILIARY EQUIPMENT:

Drill string safety valves will be maintained on the rig floor in the open position while drilling operations are in progress.

8. TESTING, LOGGING AND CORING PROGRAMS:

Drill stem tests will be made if sample data and drilling rate are sufficient to indicate a test is warranted.

It is planned that electric logs will include a CNL-FDC with Gamma Ray.

No coring is planned.

9. ABNORMAL PRESSURES, TEMPERATURES OR HYDROGEN SULFIDE GAS:

No abnormal pressures or temperatures are anticipated.

10. ANTICIPATED STARTING DATE:

It is planned that drilling operations will commence about August 20, 1980, subject to rig availability, with drilling and completion operations lasting about 30 days.