

UNITED STATES
DEPARTMENT OF THE INTERIOR
GEOLOGICAL SURVEY

30-025-27281

APPLICATION FOR PERMIT TO DRILL, DEEPEN, OR PLUG BACK

1a. TYPE OF WORK DRILL <input checked="" type="checkbox"/> DEEPEN <input type="checkbox"/> PLUG BACK <input type="checkbox"/>			5. LEASE DESIGNATION AND SERIAL NO. NM-28061
b. TYPE OF WELL OIL WELL <input checked="" type="checkbox"/> GAS WELL <input type="checkbox"/> OTHER <input type="checkbox"/> MINING <input checked="" type="checkbox"/> MULTIPLE ZONE <input type="checkbox"/>			6. IF INDIAN, ALLOTTED OR TRIBE NAME
2. NAME OF OPERATOR Lewis B. Burleson, Inc.			7. UNIT AGREEMENT NAME
3. ADDRESS OF OPERATOR Box 2479, Midland, Texas 79702			8. FARM OR LEASE NAME Sue Federal
4. LOCATION OF WELL (Report location clearly and in accordance with any State requirements.) At surface Unit M, Section 31, T-25-S, R-37-E At proposed prod. zone same (Lot 4) 990/s 660/w			9. WELL NO. 1
14. DISTANCE IN MILES AND DIRECTION FROM NEAREST TOWN OR POST OFFICE* 3 miles southwest of Jal, New Mexico			10. FIELD AND POOL, OR WILDCAT Jalmat
15. DISTANCE FROM PROPOSED* LOCATION TO NEAREST PROPERTY OR LEASE LINE, FT. (Also to nearest drlg. unit line, if any) 660'			11. SEC., T., R., M., OR BLK. AND SURVEY OR AREA Sec. 31, T-25-S, R-37-E
16. NO. OF ACRES IN LEASE 160			12. COUNTY OR PARISH Lea
17. NO. OF ACRES ASSIGNED TO THIS WELL 40			13. STATE NM
18. DISTANCE FROM PROPOSED* LOCATION TO NEAREST WELL, DRILLING, COMPLETED, OR APPLIED FOR, ON THIS LEASE, FT. first well			20. ROTARY OR CABLE TOOLS rotary
19. PROPOSED DEPTH 3200'			22. APPROX. DATE WORK WILL START* March 1, 1981
21. ELEVATIONS (Show whether DF, RT, GR, etc.) 2981 GR			

23. PROPOSED CASING AND CEMENTING PROGRAM				
SIZE OF HOLE	SIZE OF CASING	WEIGHT PER FOOT	SETTING DEPTH	QUANTITY OF CEMENT
12-1/4	8-5/8	24#	980	650 sx CIRCULATE
7-7/8	4-1/2	10.5#	3200	300 sx CIRCULATE

Drill 12-1/4" hole to 3200'. Set 8-5/8" casing. Cement with 650 sx to circulate to surface. Install 10" Shaffer 900 BOP with hydraulic closing unit and test to 800 psi (See attached exhibit "D"). Drill out. (See mud program attached) Run 4-1/2" casing to TD and cement. Perforate & acidize to test well.

IN ABOVE SPACE DESCRIBE PROPOSED PROGRAM: If proposal is to deepen or plug back, give data on present productive zone and proposed new productive zone. If proposal is to drill or deepen directionally, give pertinent data on subsurface locations and measured and true vertical depths. Give blowout preventer program, if any.

24. SIGNED Wayne Jarvis TITLE Superintendent DATE 1-16-81
(This space for Federal or State office use)

PERMIT NO. 10-384 APPROVAL DATE FEB 09 1981
GEORGE H. STEWART TITLE DISTRICT ENGINEER
APPROVED BY GEORGE H. STEWART DATE FEB 09 1981
CONDITIONS OF APPROVAL, IF ANY:

**NEW MEXICO OIL CONSERVATION COMMISSION
WELL LOCATION AND ACREAGE DEDICATION PLAT**

Form C-102
Supersedes C-128
Effective 1-1-65

All distances must be from the outer boundaries of the Section

Operator Lewis B. Burleson, Inc.			Lease Sue Federal			Well No. 1		
Unit Letter M	Section 31	Township 25South	Range 37East	County Lea				
Actual Footage Location of Well: <div style="display: flex; justify-content: space-between;"> 990 feet from the South line and 660 feet from the West line </div>								
Ground Level Elev. 2981'	Producing Formation 7 Rivers		Pool Jalnet			Dedicated Acreage: 40 Acres		

1. Outline the acreage dedicated to the subject well by colored pencil or hachure marks on the plat below.
2. If more than one lease is dedicated to the well, outline each and identify the ownership thereof (both as to working interest and royalty).
3. If more than one lease of different ownership is dedicated to the well, have the interests of all owners been consolidated by communitization, unitization, force-pooling, etc?

☐ Yes ☐ No If answer is "yes," type of consolidation _____

If answer is "no," list the owners and tract descriptions which have actually been consolidated. (Use reverse side of this form if necessary.) _____

No allowable will be assigned to the well until all interests have been consolidated (by communitization, unitization, forced-pooling, or otherwise) or until a non-standard unit, eliminating such interests, has been approved by the Commission.

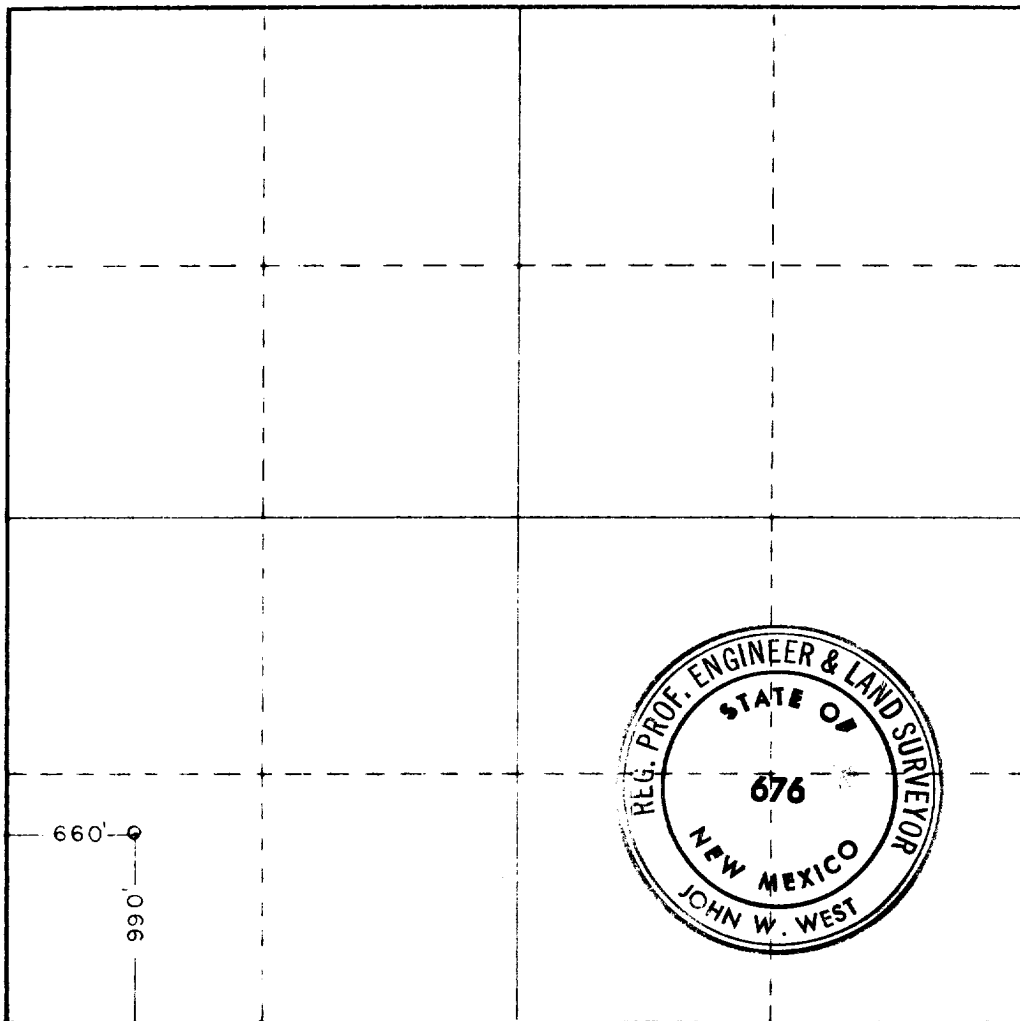

CERTIFICATION

I hereby certify that the information contained herein is true and complete to the best of my knowledge and belief.

Name *Wayne James*
 Position **Superintendent**
 Company **Lewis B. Burleson, Inc.**

Date **January 16, 1981**

I hereby certify that the well location shown on this plat was plotted from field notes of actual surveys made by me or under my supervision, and that the same is true and correct to the best of my knowledge and belief.

Date Surveyed **Dec. 19, 1980**

Registered Professional Engineer and Land Surveyor

John W. West
 Certificate No. **JOHN W. WEST 676**
PATRICK A. ROMERO 6463
Ronald J. Eidson 3239

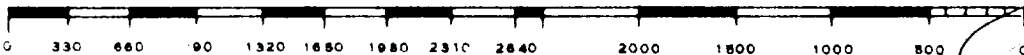

ATTACHMENT FORM 9-331-C

Lewis B. Burleson, Inc.

Sue Federal # 1

Location: 660' FWL & 990' FSL Section 31, T-25-S, R-37-E, Lea County, New Mexico
NM-28061

1. Surface formation: Deep Aeolian deposits

2. Estimated tops of geologic markers:

Anhydrite	950
Top Salt	1060
Base Salt	2610
Yates	2810
7 Rivers	3050

3. Estimated depth of mineral-bearing formation:

Yates	2810 - oil and gas
7 Rivers	3050 - oil and gas

4. Casing Program:

<u>Hole Size</u>	<u>Size of Casing</u>	<u>Weight Per Ft.</u>	<u>Cond.</u>	<u>Grade</u>	<u>Depth</u>	<u>Sacks Cement</u>	<u>Est top Cement</u>
12-1/4	8-5/8	24#	N	K-55	980±	650	circ.
7-7/8	4-1/2	10.5#	N	K-55	3100±	300	2600

5. Blowout Preventer: 10" Shaffer 900 Double hydraulic w/ Payne closing unit.
(See Exhibit D)

6. Mud Program: 0-980 native spud mud, 36 vis. 8.9# wt.; 980-2600 10# brine water; 2600-3100, salt base mud, 35-38 vis., 10.1# wt., 10-12 WL.

7. Auxiliary Equipment: Kelly valve, safety sub with full opening valve, drill pipe float valve.

8. Logging & Testing: No DST or coring anticipated. Logs to be sonic-gamma ray.

9. No abnormal pressures or temperatures are anticipated.

10. Starting date and duration: Date will be determined by date of approval and availability of Kenai Drilling Rig. Operations are expected to be complete in 14 days.

RECEIVED

FEB 17 1981

OIL CONSERVATION DIV.

473