

All distances must be from the outer boundaries of the Section.

Operator ARCO Oil and Gas Company			Lease W. H. Harrison "A" & "D"		Well No. 1, 2, 6
Unit Letter D. L. N	Section 29	Township 24S	Range 37E	County Lea	
Actual Pasture Location of Well:					
1980 feet from the South line and		1980 feet from the West line			
Ground Level Elev. 3251.8	Producing Formation Yates-Seven Rivers		Pool Jalmat Gas	Dedicated Acreage: 320 Acres	

1. Outline the acreage dedicated to the subject well by colored pencil or hatchure marks on the plat below.
2. If more than one lease is dedicated to the well, outline each and identify the ownership thereof (both as to working interest and royalty).
3. If more than one lease of different ownership is dedicated to the well, have the interests of all owners been consolidated by communitization, unitization, force-pooling, etc?

☒ Yes ☐ No If answer is "yes," type of consolidation Communitization

If answer is "no," list the owners and tract descriptions which have actually been consolidated. (Use reverse side of this form if necessary.)

No allowable will be assigned to the well until all interests have been consolidated (by communitization, unitization, forced-pooling, or otherwise) or until a non-standard unit, eliminating such interests, has been approved by the Division.

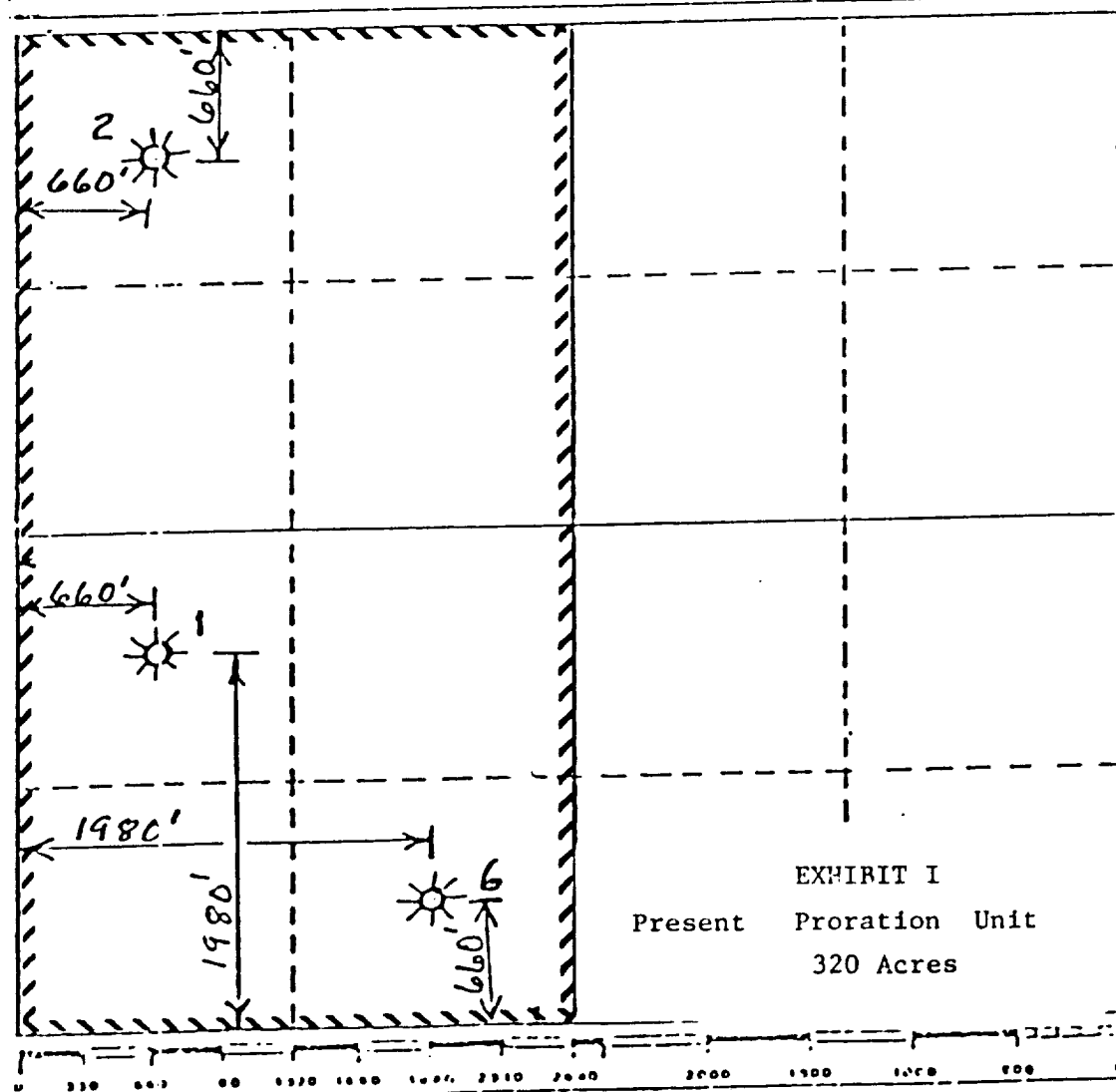

CERTIFICATION

I hereby certify that the information contained herein is true and complete to the best of my knowledge and belief.

B. L. Stokely

Name

B. L. Stokely

Position

Senior Engineer

Company

ARCO Oil and Gas Company

Date

7-13-82

I hereby certify that the well location shown on this plat was plotted from field notes of actual surveys made by me or under my supervision, and that the same is true and correct to the best of my knowledge and belief.

Date Surveyed

Registered Professional Engineer
and/or Land Surveyor

Certificate No.

RECEIVED

JUL 26 1982

Q.C.D.
HOBBS OFFICE