

85-225-27438

NO. OF COPIES RECEIVED	
DISTRIBUTION	
SANTA FE	
FILE	
U.S.G.S.	
LAND OFFICE	
OPERATOR	

NEW MEXICO OIL CONSERVATION COMMISSION

Form C-101
Revised 1-1-65

5A. Indicate Type of Lease	
STATE <input checked="" type="checkbox"/>	FEE <input type="checkbox"/>
5. State Oil & Gas Lease No.	
B-229	

APPLICATION FOR PERMIT TO DRILL, DEEPEN, OR PLUG BACK

1a. Type of Work		7. Unit Agreement Name	
b. Type of Well		8. Farm or Lease Name	
DRILL <input checked="" type="checkbox"/>	DEEPEN <input type="checkbox"/>	Arnott Ramsay (NCT-E)	
OIL WELL <input checked="" type="checkbox"/>	GAS WELL <input type="checkbox"/>	9. Well No.	
OTHER <input type="checkbox"/>	SINGLE ZONE <input type="checkbox"/>	11	
2. Name of Operator		10. Field and Pool, or Wildcat	
Gulf Oil Corporation		Langlie Mattix	
3. Address of Operator		12. County	
P. O. Box 670, Hobbs, NM 88240		Lea	
4. Location of Well		19. Proposed Depth	
UNIT LETTER G	LOCATED 1980 FEET FROM THE North LINE	3750'	
AND 1980 FEET FROM THE East LINE OF SEC. 16 TWP. 25S RGE. 37E NMPM	19A. Formation		20. Rotary or C.T.
		Queen Penrose Rotary	
21. Elevations (Show whether DF, RT, etc.)		21B. Drilling Contractor	
3120' GL		Unknown	
21A. Kind & Status Plug. Bond		22. Approx. Date Work will start	
--		7-1-81	

23.

PROPOSED CASING AND CEMENT PROGRAM

SIZE OF HOLE	SIZE OF CASING	WEIGHT PER FOOT	SETTING DEPTH	SACKS OF CEMENT	EST. TOP
12 1/4"	8-5/8"	24#	400'	350	circ
7-7/8"	4 1/2"	14#	3750'	600	circ

Drilling Mud: 0' - 400' FW spud
400' - 3750' SW

See Attached BOP Drawing #2

IN ABOVE SPACE DESCRIBE PROPOSED PROGRAM: IF PROPOSAL IS TO DEEPEN OR PLUG BACK, GIVE DATA ON PRESENT PRODUCTIVE ZONE AND PROPOSED NEW PRODUCTIVE ZONE. GIVE BLOWOUT PREVENTER PROGRAM, IF ANY.

I hereby certify that the information above is true and complete to the best of my knowledge and belief.

Signed L. C. Leaden Title Area Production Manager Date 5-15-81

(This space for State Use)

APPROVED BY [Signature] TITLE _____ DATE _____

CONDITIONS OF APPROVAL, IF ANY:

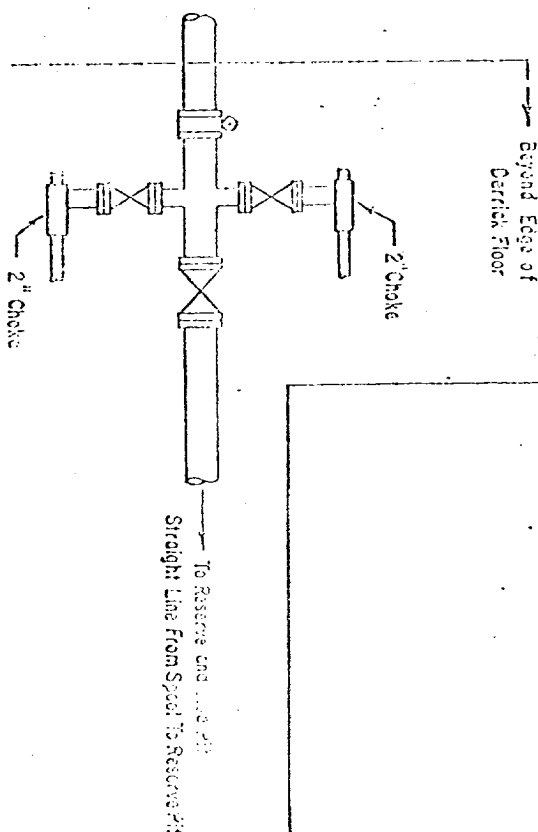
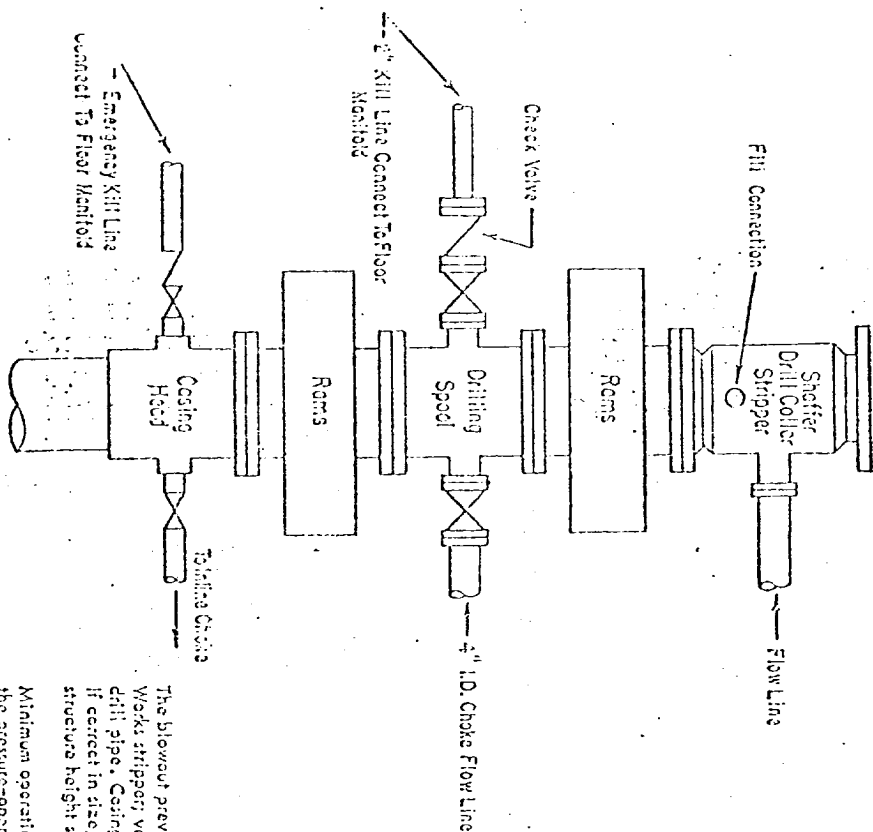

ADDITIONS - DELETIONS - CHANGES
SPECIFY

3000 PSI WORKING PRESSURE BLOWOUT PREVENTER HOOK-UP

The blowout preventer assembly shall consist of one blind ram preventer and one pipe ram preventer, both hydraulically operated by a Sheffer Tool Works stripper valves, chokes and connections, as illustrated. If a tapered drill string is used, a ram preventer must be provided for each size of drill pipe. Casing and tubing rams to fit the preventers are to be available as needed. The ram preventers may be two single or a double type. If correct in size, the flanged outlet of the ram preventer may be used for connecting to the 4-inch I.D. choke flow line and kill line. The sub-structure height shall be sufficient to install a rotating blowout preventer.

Minimum operating equipment for the preventers shall be as follows: (1) Pump (g), driven by a continuous source of power, capable of closing all the pressure-operated devices simultaneously within _____ seconds. The pump (g) is to be connected to a closed type hydraulic operating system. (2) When required, accumulators with a precharge of nitrogen of not less than 750 PSI and connected so as to receive a fluid charge from the above pump (g). With the charging pump (g) shut down, the pressurized fluid volume stored in the accumulators must be sufficient to close all the pressure-operated devices simultaneously within _____ seconds after closure, the remaining accumulator pressure shall be not less than 1000 PSI with the remaining accumulator fluid volume at least _____ percent of the original. (3) When required, an additional source of power, remote and equivalent, is to be available to operate the above pump (g) or there shall be an additional pump (g) operated by separate power and equal in performance capabilities.

The closing manifold shall have a separate control for each pressure-operated device. Controls are to be labeled, with control handles indicating open and closed positions. A pressure reducer and regulator must be provided if a Hydril preventer is used. Gulf Legion No. 39 hydraulic oil, an equivalent or better, is to be used as the fluid to operate the hydraulic equipment.

The choke manifold, choke flow line, and choke lines are to be supported by metal stands and adequately anchored. The choke flow line and choke lines shall be constructed as straight as possible and without sharp bends. Key and safe access is to be maintained to the choke manifold. All valves are to be selected for operation in the pressure of oil, gas and drilling fluids. The choke flow line valve connected to the drilling spool and oil ram type preventers must be equipped with stem extensions, unlabeled, to run if needed, and hand wheels which are to extend beyond the edge of the derrick substructure. All other valves are to be equipped with handles.

NEW MEXICO OIL CONSERVATION COMMISSION
WE LOCATION AND ACREAGE DEDICATION PLAT

Form C-102
Supersedes C-128
Effective 1-1-55

All distances must be from the outer boundaries of the Section.

Operator Gulf Oil Corporation			Lease Arnett Ramsay State NCT-E		Well No. 11
Unit Letter G	Section 16	Township 25 South	Range 37 East	County Lea	
Actual Well Location of Well:					
1980 feet from the North line and		1980 feet from the East line			
Ground Level Elev. 3120.2	Producing Formation Queen Penrose	Pool Langlie Mattix	Dedicated Acreage: 40 Acres		

1. Outline the acreage dedicated to the subject well by colored pencil or hatchure marks on the plat below.
2. If more than one lease is dedicated to the well, outline each and identify the ownership thereof (both as to working interest and royalty).
3. If more than one lease of different ownership is dedicated to the well, have the interests of all owners been consolidated by communitization, unitization, force-pooling, etc?

☐ Yes ☐ No If answer is "yes," type of consolidation _____

If answer is "no," list the owners and tract descriptions which have actually been consolidated. (Use reverse side of this form if necessary.) _____

No allowable will be assigned to the well until all interests have been consolidated (by communitization, unitization, forced-pooling, or otherwise) or until a non-standard unit, eliminating such interests, has been approved by the Commission.

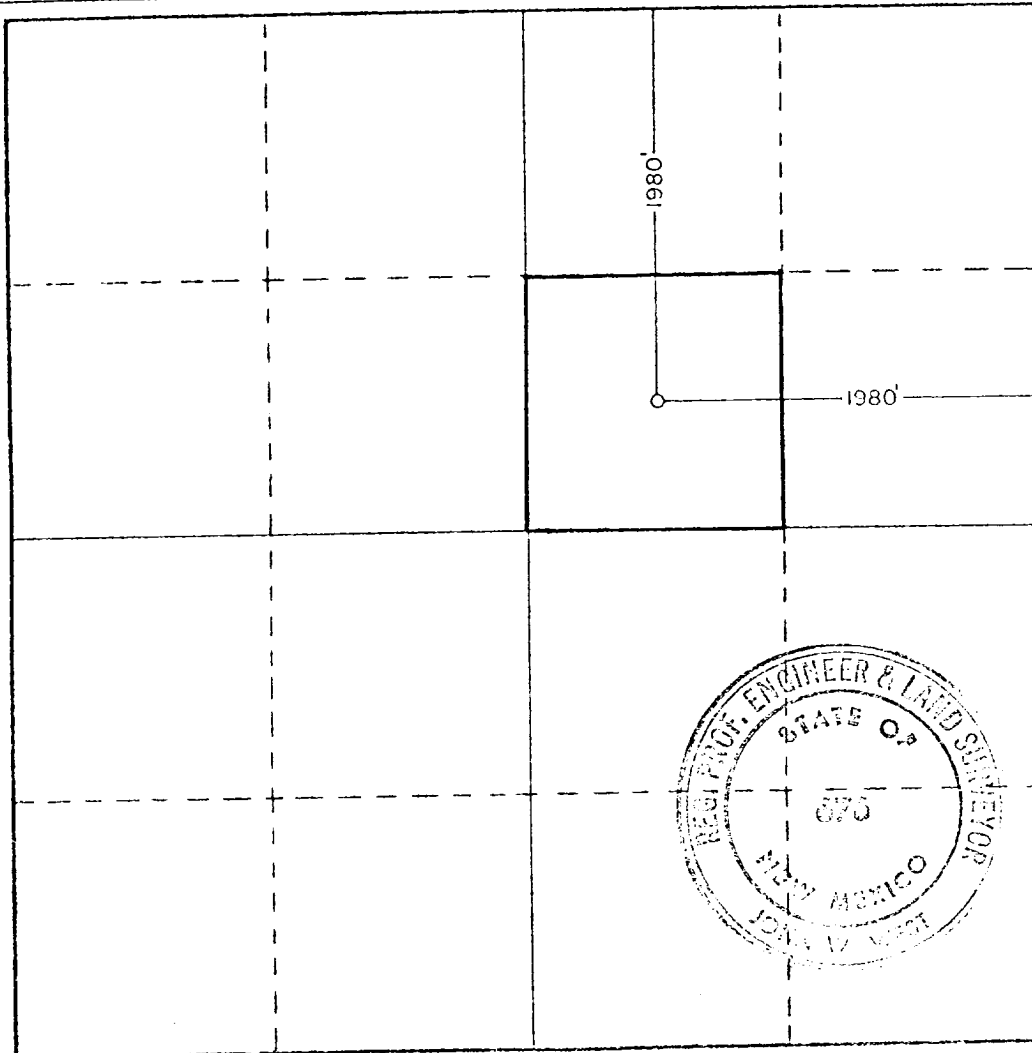

CERTIFICATION

I hereby certify that the information contained herein is true and complete to the best of my knowledge and belief.

R. C. Anderson

Name

R. C. Anderson

Position

Area Production Manager

Company

Gulf Oil Corporation

Date

5-15-81

I hereby certify that the well location shown on this plat was plotted from field notes of actual surveys made by me or under my supervision, and that the same is true and correct to the best of my knowledge and belief.

Date Surveyed

March 6, 1981

Registered Professional Engineer and/or Land Surveyor

Patrick A. Romero

Certificate No. **JOHN W. EAST 878**

PATRICK A. ROMERO C-883

Ronald J. Eidson 3239