

NEW MEXICO OIL CONSERVATION COMMISSION  
WELL LOCATION AND ACREAGE DEDICATION PLAT

Form No. 1  
Supersedes O.C.C. Form No. 1

All distances must be from the outer boundaries of the Section

Operator <b>Morris R. Antweil</b>		Lease <b>Terra Federal</b>		Acres <b>2</b>
Tract Letter <b>N</b>	Section <b>22</b>	Township <b>25S</b>	Range <b>37E</b>	County <b>Lea</b>
Actual Footage Location of Well				
<b>990</b>	feet from the	<b>SOUTH</b>	line and	<b>2310</b>
				feet from the
				<b>WEST</b>
Ground Level Elev. <b>3084.9</b>	Producing Formation <b>QUEEN</b>		Pool <b>LANGLIE MATTIX-7 RVRS, Q, GB</b>	Deed Book & Page <b>40</b>

1. Outline the acreage dedicated to the subject well by colored pencil or hachure marks on the plat below.
2. If more than one lease is dedicated to the well, outline each and identify the ownership thereof (both as to working interest and royalty).
3. If more than one lease of different ownership is dedicated to the well, have the interests of all owners been consolidated by communitization, unitization, force-pooling, etc?

Yes     No    If answer is "yes," type of consolidation \_\_\_\_\_

If answer is "no," list the owners and tract descriptions which have actually been consolidated. (Use reverse side of this form if necessary.) \_\_\_\_\_

No allowable will be assigned to the well until all interests have been consolidated (by communitization, unitization, forced-pooling, or otherwise) or until a non-standard unit, eliminating such interests, has been approved by the Commission.

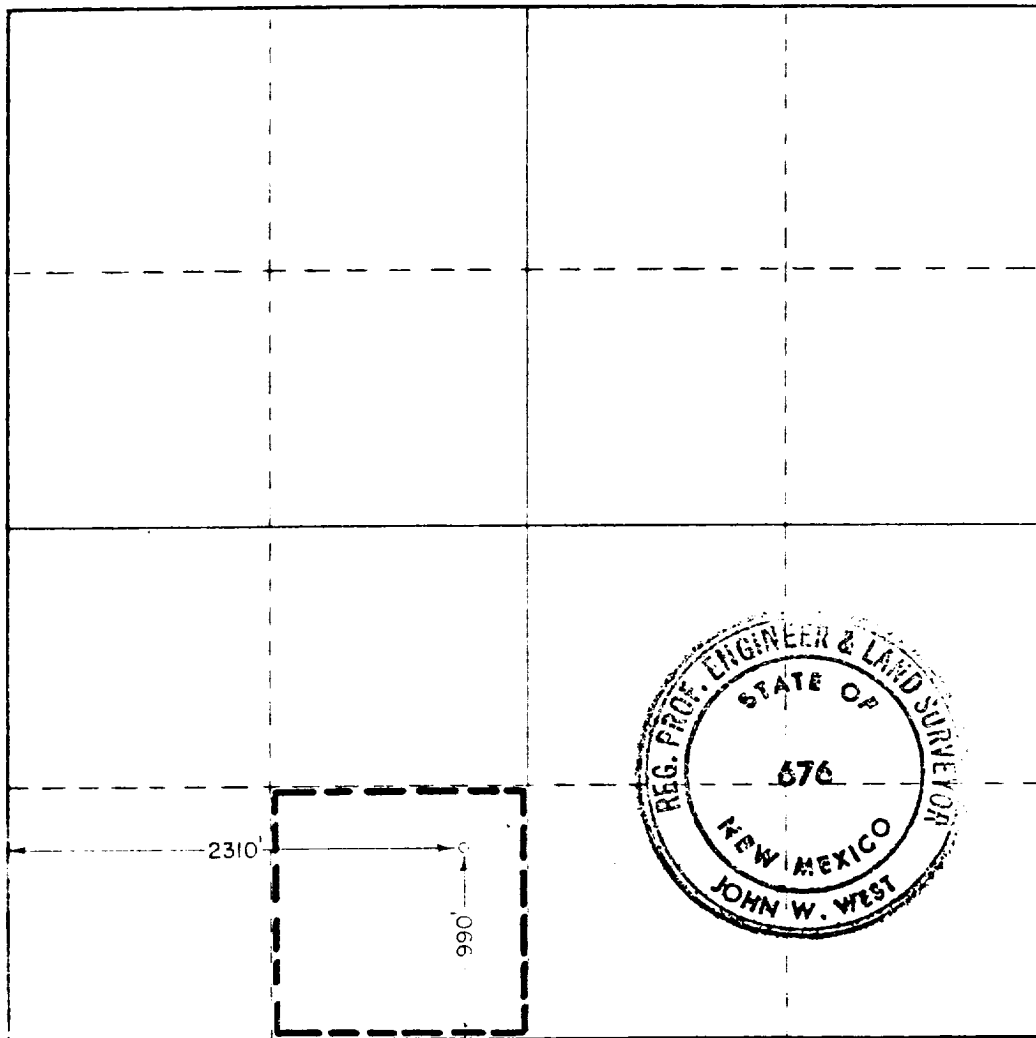

CERTIFICATION

I hereby certify that the information contained herein is true and complete to the best of my knowledge and belief.

*Arthur R. Brown*  
Arthur R. Brown

Position  
**Agent for**

Company  
**MORRIS R. ANTWEIL**

Date  
**MAY 18, 1981**

I hereby certify that the well location shown on this plat was plotted from field notes of actual surveys made by me or under my supervision, and that the same is true and correct to the best of my knowledge and belief.

May 12, 1981

Date Surveyed

Registered Professional Engineer and Land Surveyor

*John W. West*

Certificate No. **JOHN W. WEST 676**  
**PATRICK A. ROMERO 6663**  
**Ronald J. Eidson 3239**

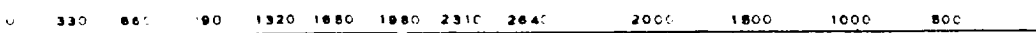

RECEIVED

JUN 9 1981

OIL CONSERVATION DIV