

COUNTY **LEA** FIELD **Jalmat** DATE NM  
 OPR **HARTMAN, DOYLE** API **30-025-27537**  
 NO **3** LEASE **Late Thomas** MAP  
**Sec 17, T24S, R37E** CO-ORD  
**1980 FSL, 2080 FEL of Sec** **11-1-32 NM**  
**8 mi N/Jal** SPD **9-15-81** CMP **10-10-81**

CSC

9 5/8-426-225 sx  
 7-3350-450 sx  
 2 3/8-3195

WELL CLASS: INIT D FIN DG LSE. CODE			
FORMATION	DATUM	FORMATION	DATUM
TD 3350 (SVRV)		PBD 3256	

IP (Yates-Seven Rivers) Perfs 2855-3117 F 146 MCFGPD. Pot based  
 on 24 hr test thru 12/64 chk. GOR Dry; gty (Gas) NR; CP 82;  
 TP Pkr

CONTR **Kenai #18** OPRSELEV **3267 GL** sub-s **13**

F.R. 8-24-81  
 PD 3400 RT (Yates)  
 9-24-81 TD 3350; Rng Logs  
 10-1-81 TD 3350; PBD 3256; Prep Perf  
 10-5-81 TD 3350; PBD 3256; Flwg  
 Perf (Yates-Seven Rivers) 2855-3117 w/20 shots  
 (overall)  
 Acid (2855-3117) 4500 gals  
 10-13-81 TD 3350; PBD 3256; WOSP  
 Flwd 146 MCFGPD + 15 BW in 24 hrs thru 12/64  
 chk, CP 82 (2855-3117)  
 11-2-81 TD 3350; PBD 3256; Complete  
 LOG TOPS: Rustler 1150, Salt 1245, Base Salt  
 2650, Yates 2810, Seven Rivers 3090  
 11-7-81 COMPLETION ISSUED

11-1-32 NM  
 IC 30-025-70451-81

NEW MEXICO OIL CONSERVATION COMMISSION  
WELL LOCATION AND ACREAGE DEDICATION PLAT

Form O-12  
Supersedes O-128  
Effective 1-1-65

All distances must be from the outer boundaries of the Section

Operator <b>DOYLE HARTMAN</b>			Lease <b>THOMAS</b>		Well No. <b>3</b>
Unit Letter <b>J</b>	Section <b>17</b>	Township <b>24 SOUTH</b>	Range <b>37 EAST</b>	County <b>LEA</b>	
Actual Footage Location of Well: <b>2080</b> feet from the <b>EAST</b> line and <b>1980</b> feet from the <b>SOUTH</b> line					
Ground Level Elev. <b>3267.0</b>	Producing Formation <b>Yates</b>	Pool <b>Jalmat (Gas)</b>		Dedicated Acreage: <b>320</b> Acres	

1. Outline the acreage dedicated to the subject well by colored pencil or hachure marks on the plat below.
2. If more than one lease is dedicated to the well, outline each and identify the ownership thereof (both as to working interest and royalty).
3. If more than one lease of different ownership is dedicated to the well, have the interests of all owners been consolidated by communitization, unitization, force-pooling, etc?

☒ Yes ☐ No If answer is "yes," type of consolidation Communitization Agreement

If answer is "no," list the owners and tract descriptions which have actually been consolidated. (Use reverse side of this form if necessary.) \_\_\_\_\_

No allowable will be assigned to the well until all interests have been consolidated (by communitization, unitization, forced-pooling, or otherwise) or until a non-standard unit, eliminating such interests, has been approved by the Commission.

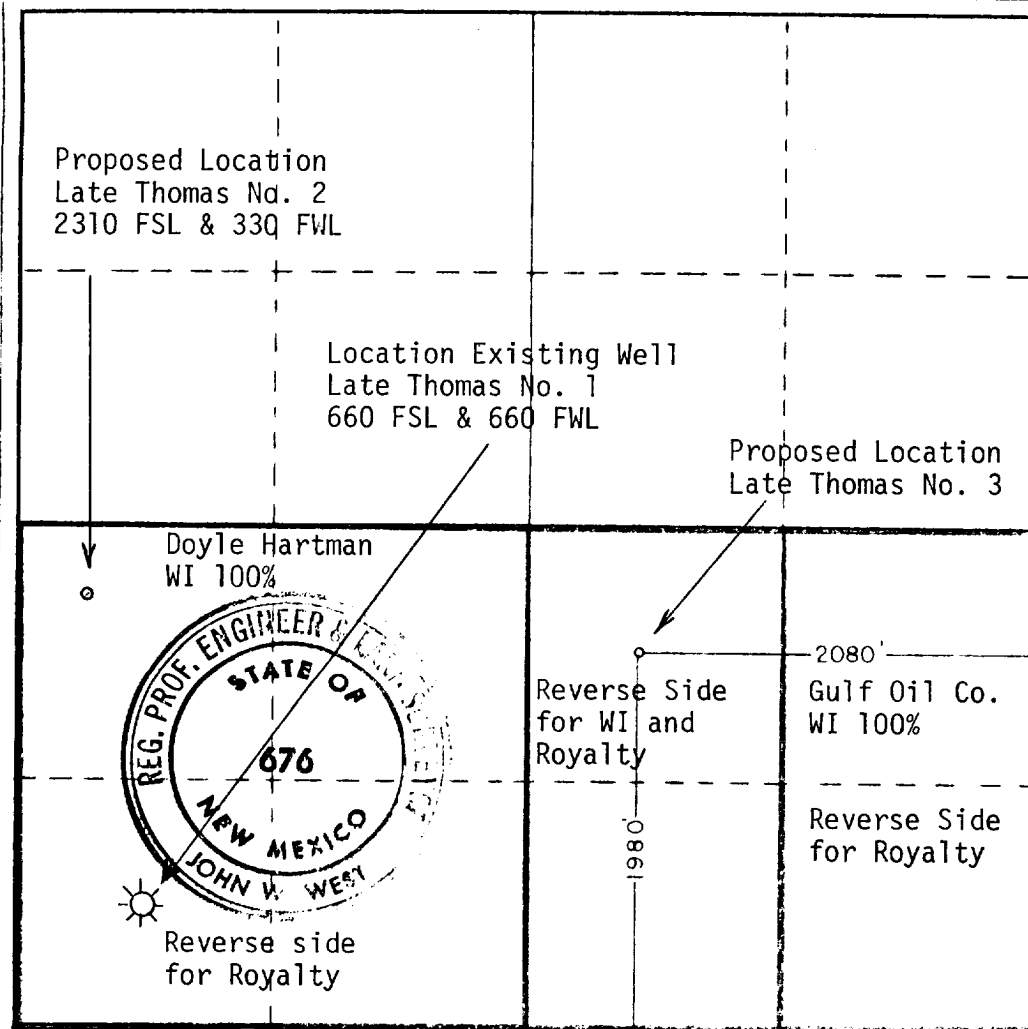

CERTIFICATION

I hereby certify that the information contained herein is true and complete to the best of my knowledge and belief.

Name  
*Larry G. Nunn*

Position  
*Engineer*

Company  
*Doyle Hartman*

Date  
*August 17, 1981*

I hereby certify that the well location shown on this plat was plotted from field notes of actual surveys made by me or under my supervision, and that the same is true and correct to the best of my knowledge and belief.

Date Surveyed  
*8-4-81*

Registered Professional Engineer and/or Land Surveyor

*John W. West*

Certificate No. **JOHN W. WEST 676**  
**PATRICK A. ROMERO 6868**  
**Ronald J. Eidson 323**

Royalty S/2 Section 17, T-24-S, R-37-E

Cities Service Company	5/8
Jeannette E. Clift	5/96
Kathleen Cone	13/96
Douglas Cone	13/480
Clifford Cone	13/480
Thomas R. Cone	13/480
Kenneth G. Cone	13/480
Cathie Auvenshine	13/480
San Angelo National Bank, Trustee	5/192
San Angelo National Bank, Successor Trustee under will of Ralph W. Leftwich, Deceased	5/192

Working Interest W/2 SE/4 Section 17, T-24-S, R-37-E.

Cities Service Company	69.7675%
Kathleen Cone	15.1163%
Douglas Cone	3.0232%
Clifford Cone	3.0232%
Thomas Cone	3.0232%
Kenneth G. Cone	3.0232%
Cathie Auvenshine	3.0232%