

NEW MEXICO OIL CONSERVATION COMMISSION
WELL LOCATION AND ACREAGE DEDICATION PLAT

Form C-
Supersedes C-128
Effective 1-1-65

All distances must be from the outer boundaries of the Section.

Operator Doyle Hartman			Lease B. M. Justis		Well No. 10
Unit Letter E	Section 19 & 20	Township 25 South	Range 37 East	County Lea	
Actual Footage Location of Well: * 1989 feet from the North line and 440 feet from the East line of Sec. 19					
Ground Level Elev.	Producing Formation Yates-Seven Rivers		Pool Jalmat (Gas)		Dedicated Acreage: 80 Acres

1. Outline the acreage dedicated to the subject well by colored pencil or hatchure marks on the plat below.
See attached C-102
2. If more than one lease is dedicated to the well, outline each and identify the ownership thereof (both as to working interest and royalty).
3. If more than one lease of different ownership is dedicated to the well, have the interests of all owners been consolidated by communitization, unitization, force-pooling, etc?

☐ Yes ☐ No If answer is "yes," type of consolidation _____

If answer is "no," list the owners and tract descriptions which have actually been consolidated. (Use reverse side of this form if necessary.) _____

No allowable will be assigned to the well until all interests have been consolidated (by communitization, unitization, forced-pooling, or otherwise) or until a non-standard unit, eliminating such interests, has been approved by the Commission. * Bottom hole location at 3200 feet TVD.

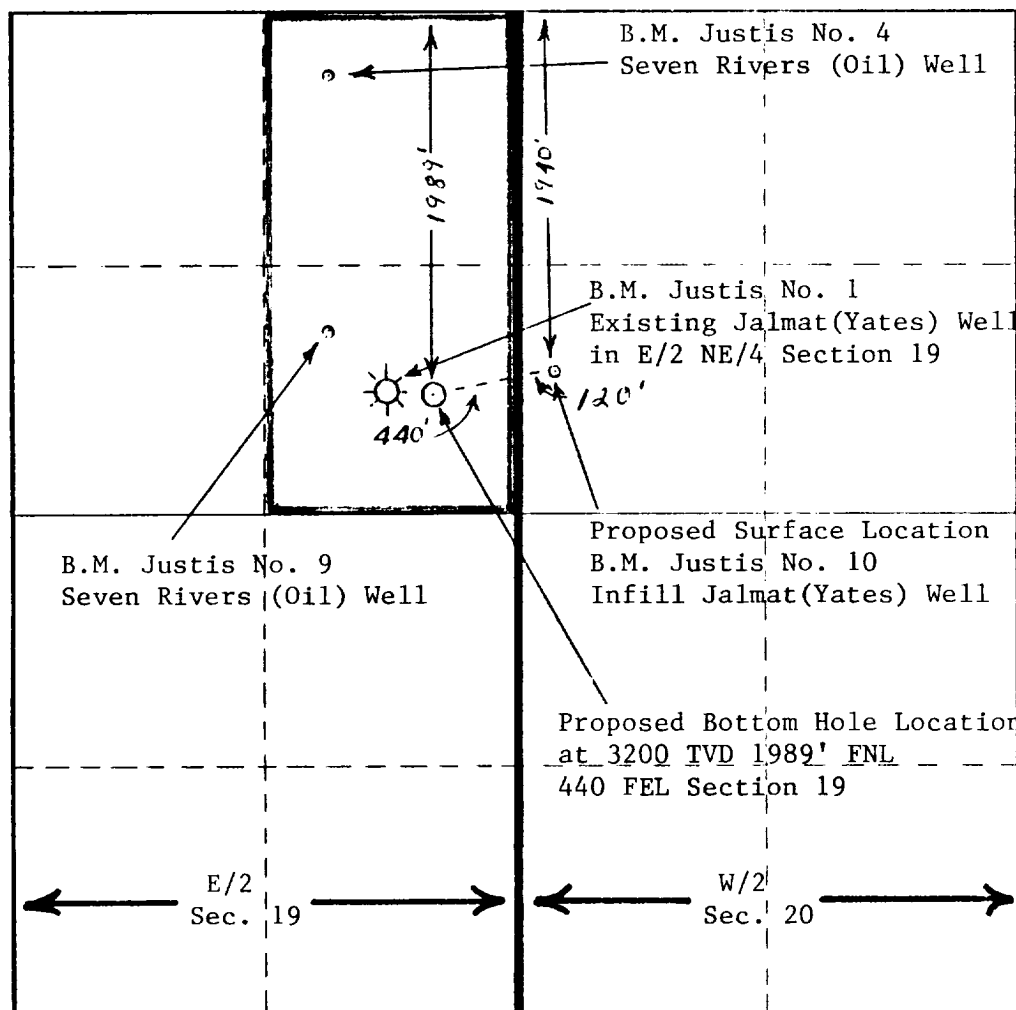

CERTIFICATION

I hereby certify that the information contained herein is true and complete to the best of my knowledge and belief.

Larry P. Henry

Engineer

Doyle Hartman

November 2, 1981

I hereby certify that the well location shown on this plat was plotted from field notes of actual surveys made by me or under my supervision, and that the same is true and correct to the best of my knowledge and belief.

Date Surveyed

Registered Professional Engineer
and/or Land Surveyor

Certificate No.

0 330 660 990 1320 1650 1980 2310 2640 2000 1500 1000 500 0