

CONSERVATION DIVISION
P. O. BOX 2088
SANTA FE, NEW MEXICO 87501

REQUEST FOR ALLOWABLE
AND
AUTHORIZATION TO TRANSPORT OIL AND NATURAL GAS

OPERATOR	
The Stone Petroleum Corporation	
Address	
P.O. Box 52382, Lafayette, LA 70505	
Reason(s) for filing (Check proper box)	
New Well <input type="checkbox"/>	Change in Transporter of: <input type="checkbox"/>
Recompletion <input checked="" type="checkbox"/>	Oil <input type="checkbox"/> Dry Gas <input type="checkbox"/>
Change in Ownership <input type="checkbox"/>	Casinghead Gas <input type="checkbox"/> Condensate <input type="checkbox"/>

If change of ownership give name
and address of previous owner _____

II. DESCRIPTION OF WELL AND LEASE								
Lease Name	Well No.	Pool Name, including Formation	Kind of Lease	Lease No.				
Javalina Basin Unit	1	Pitchfork Ranch, South (Atoka)	State, Federal or Fee Federal	NM-1900				
Location								
Unit Letter	G	: 1,980 Feet From The North	Line and	1,980 Feet From The East				
Line of Section	17	T. Township	25S	Range	34E	NMPM,	Lea	County

III. DESIGNATION OF TRANSPORTER OF OIL AND NATURAL GAS						
Name of Authorized Transporter of Oil <input type="checkbox"/> or Condensate <input checked="" type="checkbox"/>	Address (Give address to which approved copy of this form is to be sent)					
Phillips Petroleum Company-Trucks	4001 Penbrook, Odessa, Texas 79762					
Name of Authorized Transporter of Casinghead Gas <input type="checkbox"/> or Dry Gas <input type="checkbox"/>	Address (Give address to which approved copy of this form is to be sent)					
Transwestern Pipeline Company	P.O. Box 2521, Houston, Texas 77001					
If well produces oil or liquids, give location of tanks.	Unit	Sec.	Twp.	Rge.	Is gas actually connected?	When
	G	17	25S	34E	Yes	July 18, 1985

If this production is commingled with that from any other lease or pool, give commingling order number: _____

IV. COMPLETION DATA								
Designate Type of Completion - (X)	Oil Well	Gas Well	New Well	Workover	Deepen	Plug Back	Same Res'v.	Diff. Res'
		X		X		X		X
Date Spudded	Date Compl. Ready to Prod.	Total Depth	P.B.T.D.					
11-5-82	7-18-85	15,825'	14,942'					
Elevations (DF, RKB, RT, GR, etc.)	Name of Producing Formation	Top Oil/Gas Pay	Tubing Depth					
3,334.9' GR	Atoka	14,591	13,058'					
Perforations	Depth Casing Shoe							
14,594' - 14,604'	15,820							
TUBING, CASING, AND CEMENTING RECORD								
HOLE SIZE	CASING & TUBING SIZE	DEPTH SET	SACKS CEMENT					
17-1/4"	13-3/8"	588'	500					
12-1/4"	10-3/4"	5,172'	2,825					
9-1/2"	7-5/8"	13,600'	795					
6-1/2"	5-1/2"	13,097 - 15,820'	235					

V. TEST DATA AND REQUEST FOR ALLOWABLE OIL WELL			
(Test must be after recovery of total volume of load oil and must be equal to or exceed top allowable for this depth or be for full 24 hours)			
Date First New Oil Run To Tanks	Date of Test	Producing Method (Flow, pump, gas lift, etc.)	
Length of Test	Tubing Pressure	Casing Pressure	Choke Size
Actual Prod. During Test	Oil-Bbls.	Water-Bbls.	Gas-MCF

GAS WELL			
Actual Prod. Test-MCF/D	Length of Test	Bbls. Condensate/MMCF	Gravity of Condensate
101	24	0	-
Testing Method (prior, back pr.)	Tubing Pressure (shut-in)	Casing Pressure (shut-in)	Choke Size
Orifice Meter	7,400	packer	16/64"

VI. CERTIFICATE OF COMPLIANCE	
I hereby certify that the rules and regulations of the Oil Conservation Division have been complied with and that the information given above is true and complete to the best of my knowledge and belief.	
APPROVED _____, 19 _____	
BY _____ ORIGINAL SIGNED BY JERRY SEXTON	
DISTRICT I SUPERVISOR	
TITLE _____	
This form is to be filed in compliance with RULE 1104.	
If this is a request for allowable for a newly drilled or deepened well, this form must be accompanied by a tabulation of the deviate tests taken on the well in accordance with RULE 111.	
All sections of this form must be filled out completely for allowable on new and recompleted wells.	
Fill out only Sections I, II, III, and VI for changes of own- well name or number, or transporter, or other such change of condition.	

Michael E. Masser
(Signature)

Sr. Operations & Reservoir Engineer
(Title)

August 8, 1985
(Date)

RECEIVED

AUG 12 1985

RECEIVED

AUG 22 1985

The Stone Petroleum Corporation
Javelina Basin #1-17
Sec. 17, T25S, R34E
Lea County, New Mexico

DEVIATION SURVEY

<u>DATE</u>	<u>DEVIATION</u>	<u>DEPTH</u>
11/05/82	1/4	116'
11/06/82	1/2	363'
11/06/82	1/2	588'
11/08/82	3/4	790'
11/08/82	1/2	1,261'
11/08/82	3/4	1,759'
11/09/82	3/4	2,363'
11/09/82	1	2,564'
11/10/82	1	2,965'
11/10/82	1 3/4	3,271'
11/10/82	1 3/4	3,362'
11/10/82	20	3,454'
11/10/82	2	3,515'
11/11/82	2	3,576'
11/11/82	2	3,669'
11/12/82	1 3/4	3,791'
11/12/82	2 1/4	3,887'
11/13/82	2 1/4	3,891'
11/13/82	2 1/4	4,046'
11/13/82	2 1/4	4,132'
11/13/82	1 3/4	4,251'
11/14/82	1 3/4	4,375'
11/15/82	1 3/4	4,556'
11/16/82	2	5,172'
11/18/82	1 3/4	5,304'
11/19/82	1	5,425'
11/19/82	1	5,923'
11/20/82	1 1/4	6,429'
11/21/82	3/4	6,971'
11/22/82	1	7,471'
11/22/82	3/4	7,962'
11/24/82	1 1/2	8,510'
11/25/82	1 1/4	9,004'
11/27/82	1 1/4	9,680'
11/28/82	1 1/2	10,174'
11/30/82	2	10,573'
11/30/82	1 1/4	10,826'
12/01/82	1	11,010'
12/03/82	1	11,509'
12/04/82	3/4	12,003'
12/05/82	1/4	12,499'
12/07/82	3/4	12,998'
12/08/82	1	13,600'

<u>DATE</u>	<u>DEVIATION</u>	<u>DEPTH</u>
12/16/82	1	14,007'
12/21/82	3/4	14,394'
12/31/82	no picture	14,833'
01/03/83	1 1/4	15,021'
01/08/83	1 3/4	15,303'
01/12/83	2	15,656'
01/15/83	1	15,825'

Witnessed by: Michael E. Madden
 THE STATE OF LOUISIANA
 PARISH OF LAFAYETTE

Before me, the undersigned authority, on this day personally appeared Michael E. Madden known to me to be the person whose name is subscribed to the foregoing instrument, and acknowledged to me that he executed the same as a free act and deed for the purposes and consideration therein expressed.

MY COMMISSION EXPIRES: with life

Name, Notary Public Cindy C. Tongue

REMOVED

AUG 18 1985

REMOVED

The Stone Petroleum Corporation
Javelina Basin #1-17
Sec. 17, T25S, R34E
Lea County, New Mexico

DEVIATION SURVEY

<u>DATE</u>	<u>DEVIATION</u>	<u>DEPTH</u>
11/05/82	1/4	116'
11/06/82	1/2	363'
11/06/82	1/2	588'
11/08/82	3/4	790'
11/08/82	1/2	1,261'
11/08/82	3/4	1,759'
11/09/82	3/4	2,363'
11/09/82	1	2,564'
11/10/82	1	2,965'
11/10/82	1 3/4	3,271'
11/10/82	1 3/4	3,362'
11/10/82	20	3,454'
11/10/82	2	3,515'
11/11/82	2	3,576'
11/11/82	2	3,669'
11/12/82	1 3/4	3,791'
11/12/82	2 1/4	3,887'
11/13/82	2 1/4	3,891'
11/13/82	2 1/4	4,046'
11/13/82	2 1/4	4,132'
11/13/82	1 3/4	4,251'
11/14/82	1 3/4	4,375'
11/15/82	1 3/4	4,556'
11/16/82	2	5,172'
11/18/82	1 3/4	5,304'
11/19/82	1	5,425'
11/19/82	1	5,923'
11/20/82	1 1/4	6,429'
11/21/82	3/4	6,971'
11/22/82	1	7,471'
11/22/82	3/4	7,962'
11/24/82	1 1/2	8,510'
11/25/82	1 1/4	9,004'
11/27/82	1 1/4	9,680'
11/28/82	1 1/2	10,174'
11/30/82	2	10,573'
11/30/82	1 1/4	10,826'
12/01/82	1	11,010'
12/03/82	1	11,509'
12/04/82	3/4	12,003'
12/05/82	1/4	12,499'
12/07/82	3/4	12,998'
12/08/82	1	13,600'

RECEIVED

AUG 12 1985

U.S. DEPT. OF JUSTICE
FEDERAL BUREAU OF INVESTIGATION

<u>DATE</u>	<u>DEVIATION</u>	<u>DEPTH</u>
12/16/82	1	14,007'
12/21/82	3/4	14,394'
12/31/82	no picture	14,833'
01/03/83	1 1/4	15,021'
01/08/83	1 3/4	15,303'
01/12/83	2	15,656'
01/15/83	1	15,825'

Witnessed by: Michael E. Madden

THE STATE OF LOUISIANA
PARISH OF LAFAYETTE

Before me, the undersigned authority, on this day personally appeared Michael E. Madden known to me to be the person whose name is subscribed to the foregoing instrument, and acknowledged to me that he executed the same as a free act and deed for the purposes and consideration therein expressed.

MY COMMISSION EXPIRES: with life

Name, Notary Public Cindy C. Tongue

RECEIVED

AUG 12 1985

CC
HONORARY

All distances must be from the outer boundaries of the Section.

Operator The Stone Petroleum Corporation		Lease Javalina Basin Unit		Well No. 1
Unit Letter G	Section 17	Township 25 South	Range 34 East	County Lea
Actual Footage Location of Well:				
1980 feet from the North		line and 1980		feet from the East
Ground Level Elev. 3,334.9'	Producing Formation Atoka	Pool South Pitchfork Ranch (Atoka)		Dedicated Acreage: 320 Acres

1. Outline the acreage dedicated to the subject well by colored pencil or hatchure marks on the plat below.
2. If more than one lease is dedicated to the well, outline each and identify the ownership thereof (both as to working interest and royalty).
3. If more than one lease of different ownership is dedicated to the well, have the interests of all owners been consolidated by communitization, unitization, force-pooling, etc?

☐ Yes ☐ No If answer is "yes," type of consolidation _____

If answer is "no," list the owners and tract descriptions which have actually been consolidated. (Use reverse side of this form if necessary.) _____

No allowable will be assigned to the well until all interests have been consolidated (by communitization, unitization, forced-pooling, or otherwise) or until a non-standard unit, eliminating such interests, has been approved by the Division.

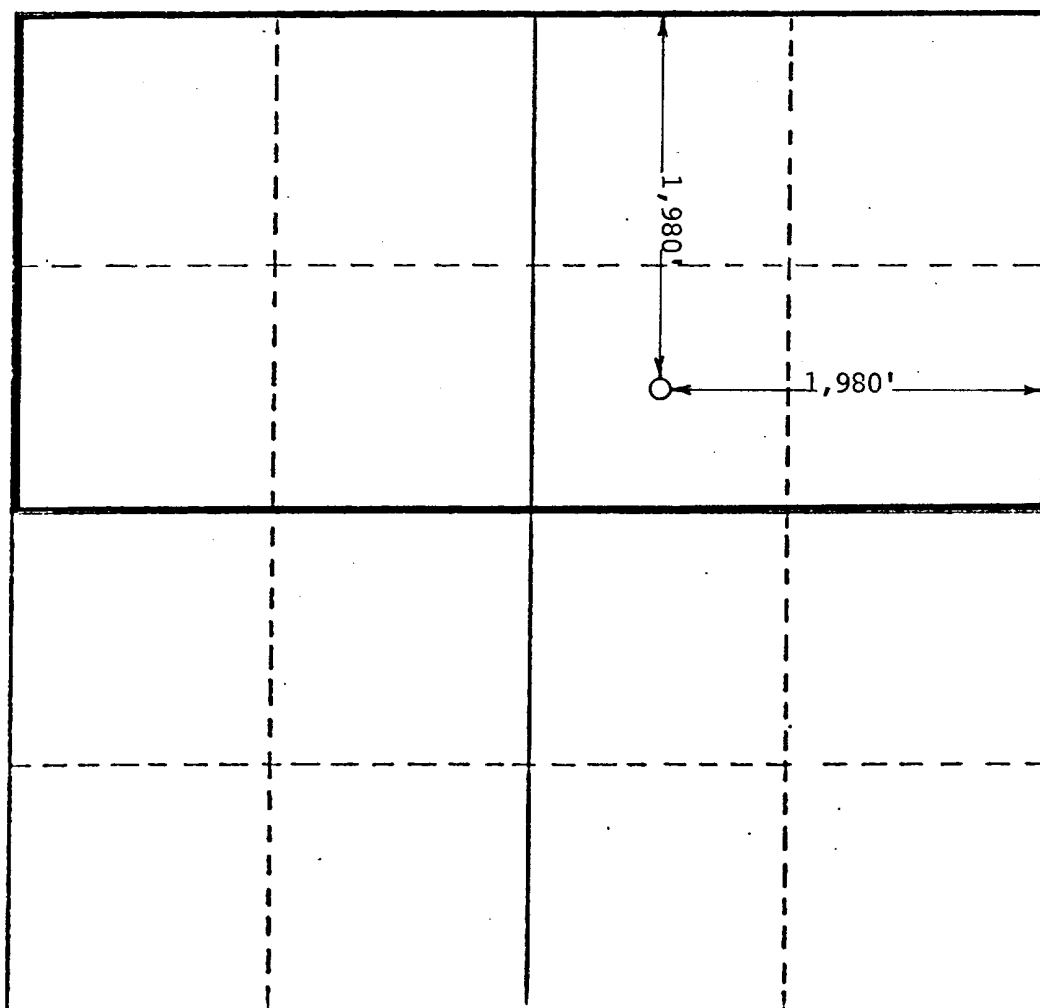

CERTIFICATION

I hereby certify that the information contained herein is true and complete to the best of my knowledge and belief.

Name: Michael T. Mullen

Position: Sr. Operations & Reservoir Eng

Company: The Stone Petroleum Corporation

Date: August 8, 1985

I hereby certify that the well location shown on this plat was plotted from field notes of actual surveys made by me or under my supervision, and that the same is true and correct to the best of my knowledge and belief.

Date Surveyed: _____

Registered Professional Engineer and/or Land Surveyor: _____

Certificate No.: _____

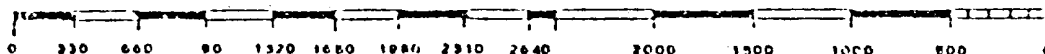

RECEIVED

AUG 12 1985

ALL
HONORARY