

NEW MEXICO OIL CONSERVATION COMMISSION  
WELL LOCATION AND ACREAGE DEDICATION PLAT

Form C-102  
Supersedes C-128  
Effective 1-1-65

All distances must be from the outer boundaries of the Section.

Operator <del>ENR</del> Enron Oil & Gas Company			Lease VACA 13 FEDERAL		Well No. 1
Unit Letter C	Section 13	Township 25 South	Range 33 East	County Lea County	
Actual Footage Location of Well: 660 feet from the North line and 1880 feet from the West line					
Ground Level Elev. 3359.6	Producing Formation Bone Spring		Pool <i>wildcat</i> Red Hills	Dedicated Acreage: 40 Acres	

1. Outline the acreage dedicated to the subject well by colored pencil or hatchure marks on the plat below.
2. If more than one lease is dedicated to the well, outline each and identify the ownership thereof (both as to working interest and royalty).
3. If more than one lease of different ownership is dedicated to the well, have the interests of all owners been consolidated by communitization, unitization, force-pooling, etc?

☐ Yes ☐ No If answer is "yes," type of consolidation \_\_\_\_\_

If answer is "no," list the owners and tract descriptions which have actually been consolidated (Use reverse side of this form if necessary.) \_\_\_\_\_

No allowable will be assigned to the well until all interests have been consolidated (by communitization, unitization, forced-pooling, or otherwise) or until a non-standard unit, eliminating such interests, has been approved by the Commission.

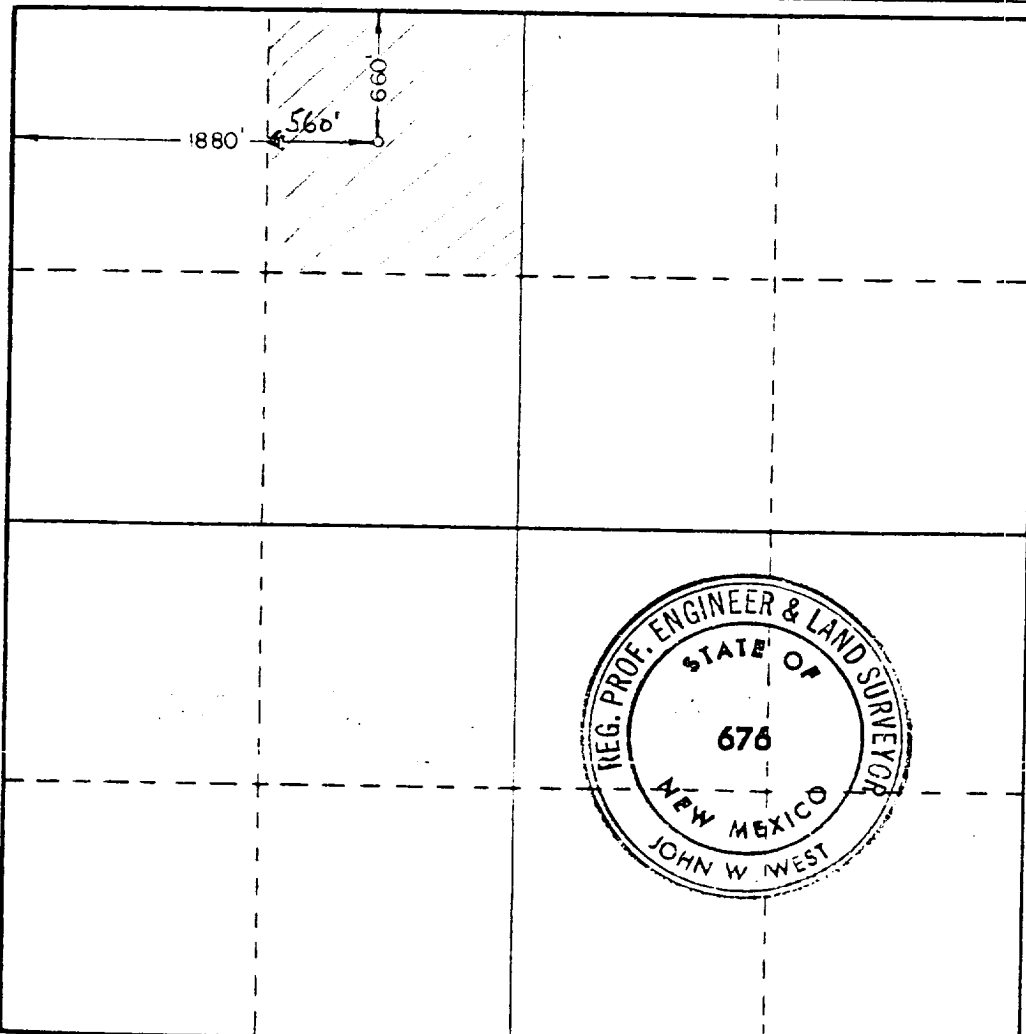

CERTIFICATION

I hereby certify that the information contained herein is true and complete to the best of my knowledge and belief.

*Betty Gildon*  
Name

Betty Gildon

Position

Regulatory Analyst

Company

Enron Oil & Gas Company

Date

~~6/10/92~~ 7/28/92

I hereby certify that the well location shown on this plat was plotted from field notes of actual surveys made by me or under my supervision, and that the same is true and correct to the best of my knowledge and belief.

Date Surveyed

May 12, 1983

Registered Professional Engineer and/or Land Surveyor

*John W. West*

Certificate No

JOHN W. WEST NO. 676

0 330 660 990 1320 1650 1980 2310 2640 2970 3300 3630 3960 4290 4620 4950 5280 5610 5940 6270 6600

RECEIVED

AUG 10 1992

CD HOBBS OFF