

NEW MEXICO OIL CONSERVATION COMMISSION
WELL LOCATION AND ACREAGE DEDICATION PLAT

Form C-102
Supersedes C-128
Effective 1-1-65

All distances must be from the outer boundaries of the Section.

| | | | | | |
|--|---------------------|-----------------------------|---|----------------------|----------------------|
| Operator SOUTHLAND ROYALTY CO. | | | Lease VACA RIDGE "4" FEDERAL COM. | | Well No. 1 |
| Unit Letter C | Section 4 | Township 25 SOUTH | Range 34 EAST | County LEA | |

Actual Footage Location of Well:

660 feet from the **NORTH** line and **1980** feet from the **WEST** line

| | | | |
|-------------------------------------|--------------------------------------|--------------------------------|--|
| Ground Level Elev. 3373.0 | Producing Formation Morrow | Pool Pitchfork Ranch | Dedicated Acreage: 320 Acres |
|-------------------------------------|--------------------------------------|--------------------------------|--|

1. Outline the acreage dedicated to the subject well by colored pencil or hatchure marks on the plat below.
2. If more than one lease is dedicated to the well, outline each and identify the ownership thereof (both as to working interest and royalty).
3. If more than one lease of different ownership is dedicated to the well, have the interests of all owners been consolidated by communitization, unitization, force-pooling, etc?

☒ Yes ☐ No If answer is "yes," type of consolidation Communitized

If answer is "no," list the owners and tract descriptions which have actually been consolidated. (Use reverse side of this form if necessary.)

No allowable will be assigned to the well until all interests have been consolidated (by communitization, unitization, forced-pooling, or otherwise) or until a non-standard unit, eliminating such interests, has been approved by the Commission.

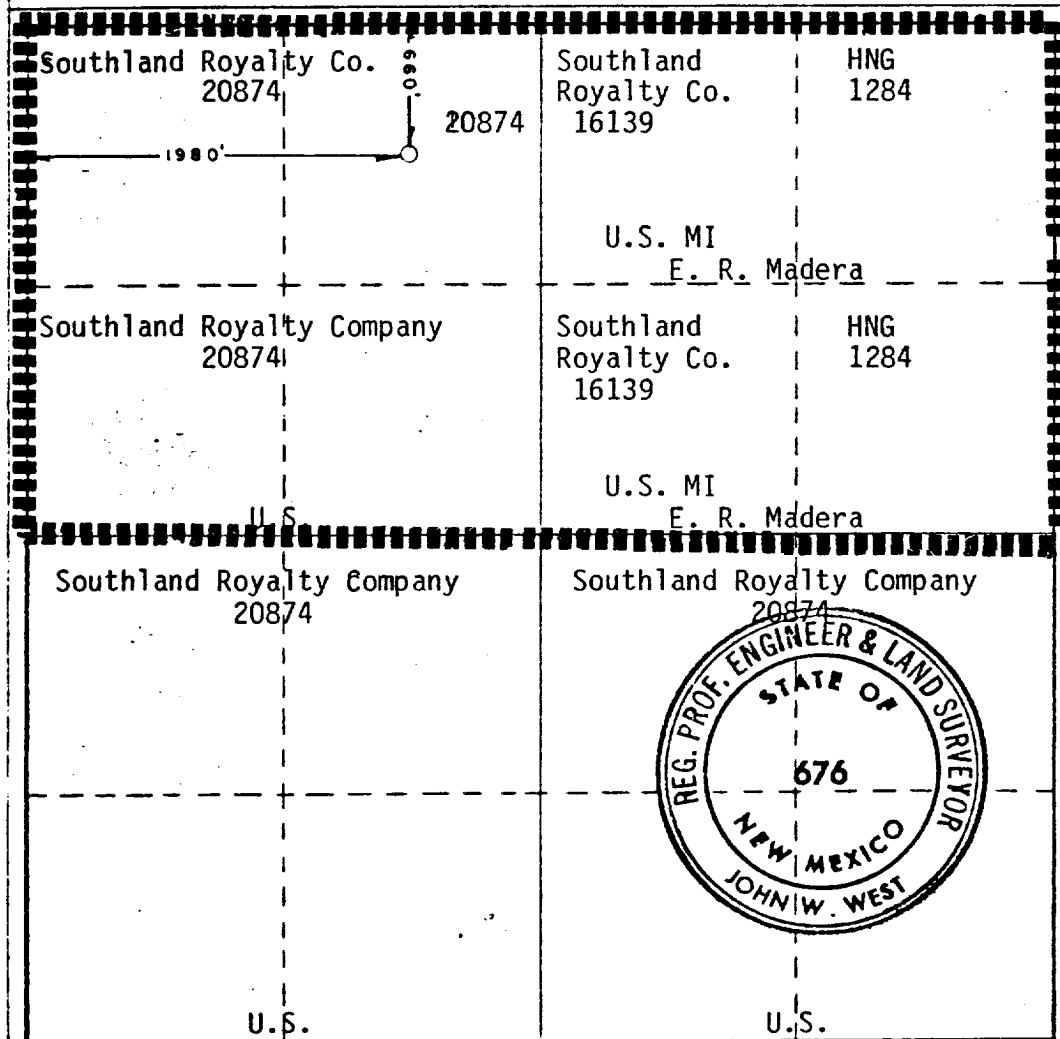

CERTIFICATION

I hereby certify that the information contained herein is true and complete to the best of my knowledge and belief.

Darrell Roberts

Name

Darrell Roberts

Position

Operations Engineer

Company

Southland Royalty Company

Date

11-4-83

I hereby certify that the well location shown on this plat was plotted from field notes of actual surveys made by me or under my supervision, and that the same is true and correct to the best of my knowledge and belief.

Date Surveyed

OCTOBER 22, 1983

Registered Professional Engineer and/or Land Surveyor

John W. West

Certificate No. **JOHN W. WEST,**

676

RONALD J. EIDSON,

3239

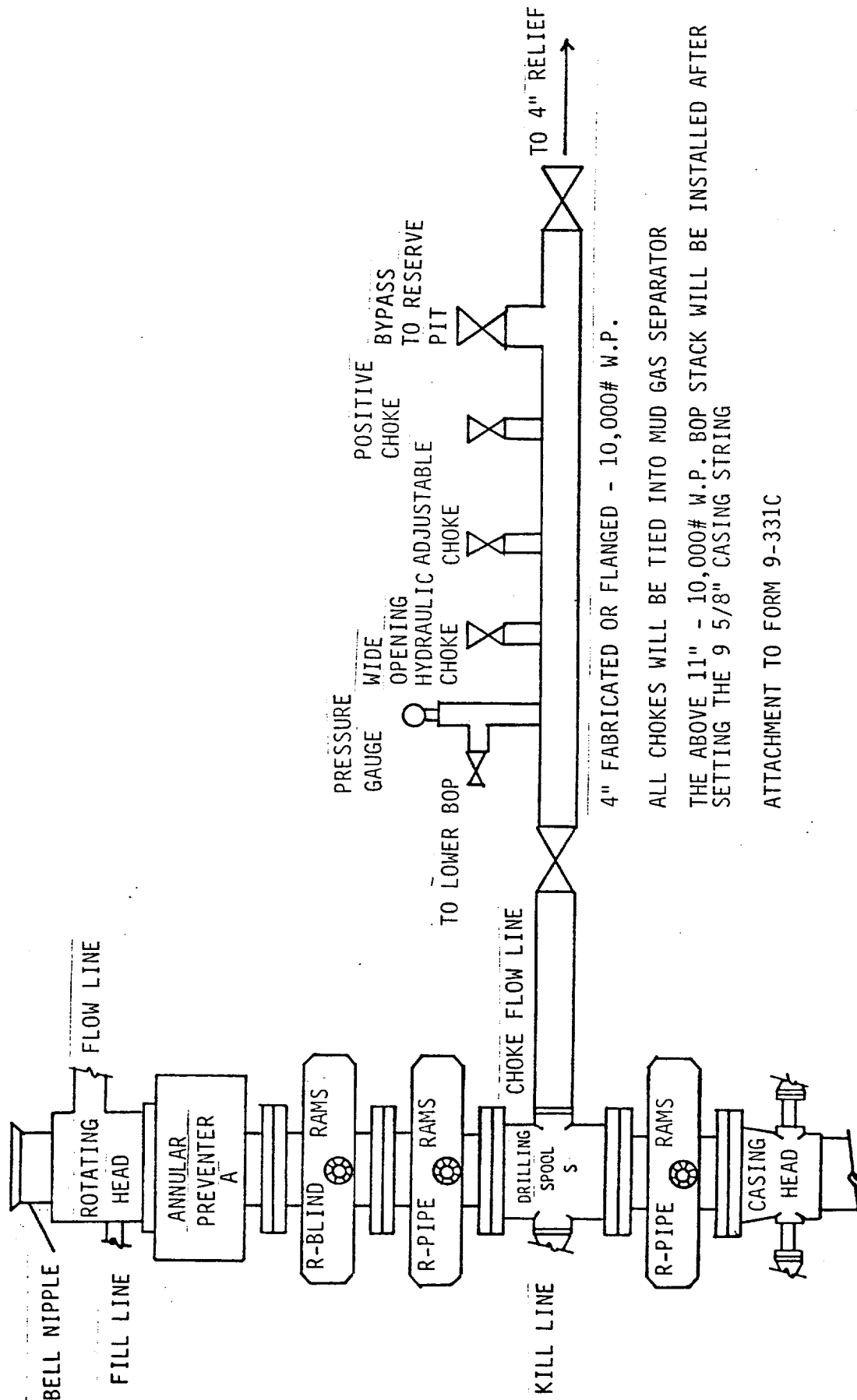

ALL CHOKES WILL BE TIED INTO MUD GAS SEPARATOR

THE ABOVE 11" - 10,000# W.P. BOP STACK WILL BE INSTALLED AFTER SETTING THE 9 5/8" CASING STRING

ATTACHMENT TO FORM 9-331C

RECEIVED
NOV 18 1985
G.C.D.
HOBBS OFFICE