

MEXICO OIL CONSERVATION COMMISSION
WELL LOCATION AND ACREAGE DEDICATION PLAT

Form O-102
 Series C-128
 Effective 1-1-65

All distances must be from the outer boundaries of the Section

Operator DOYLE HARTMAN			Lease WELLS FEDERAL		Well No. 17
Unit Letter 1	Section 5	Township 25S	Range 37E	County LEA	
Actual Endage Location of Well: 1450 feet from the EAST line and 1980 feet from the SOUTH line					
Ground Level Elev. 3229.4	Producing Formation YATES-SEVEN RIVERS		Pool JALMAT (GAS)		Dedicated Acreage: 200 Acres

1. Outline the acreage dedicated to the subject well by colored pencil or hachure marks on the plat below.
2. If more than one lease is dedicated to the well, outline each and identify the ownership thereof (both as to working interest and royalty).
3. If more than one lease of different ownership is dedicated to the well, have the interests of all owners been consolidated by communitization, unitization, force-pooling, etc?

☐ Yes ☐ No If answer is "yes," type of consolidation _____

If answer is "no," list the owners and tract descriptions which have actually been consolidated. (Use reverse side of this form if necessary.) _____

No allowable will be assigned to the well until all interests have been consolidated (by communitization, unitization, forced-pooling, or otherwise) or until a non-standard unit, eliminating such interests, has been approved by the Commission.

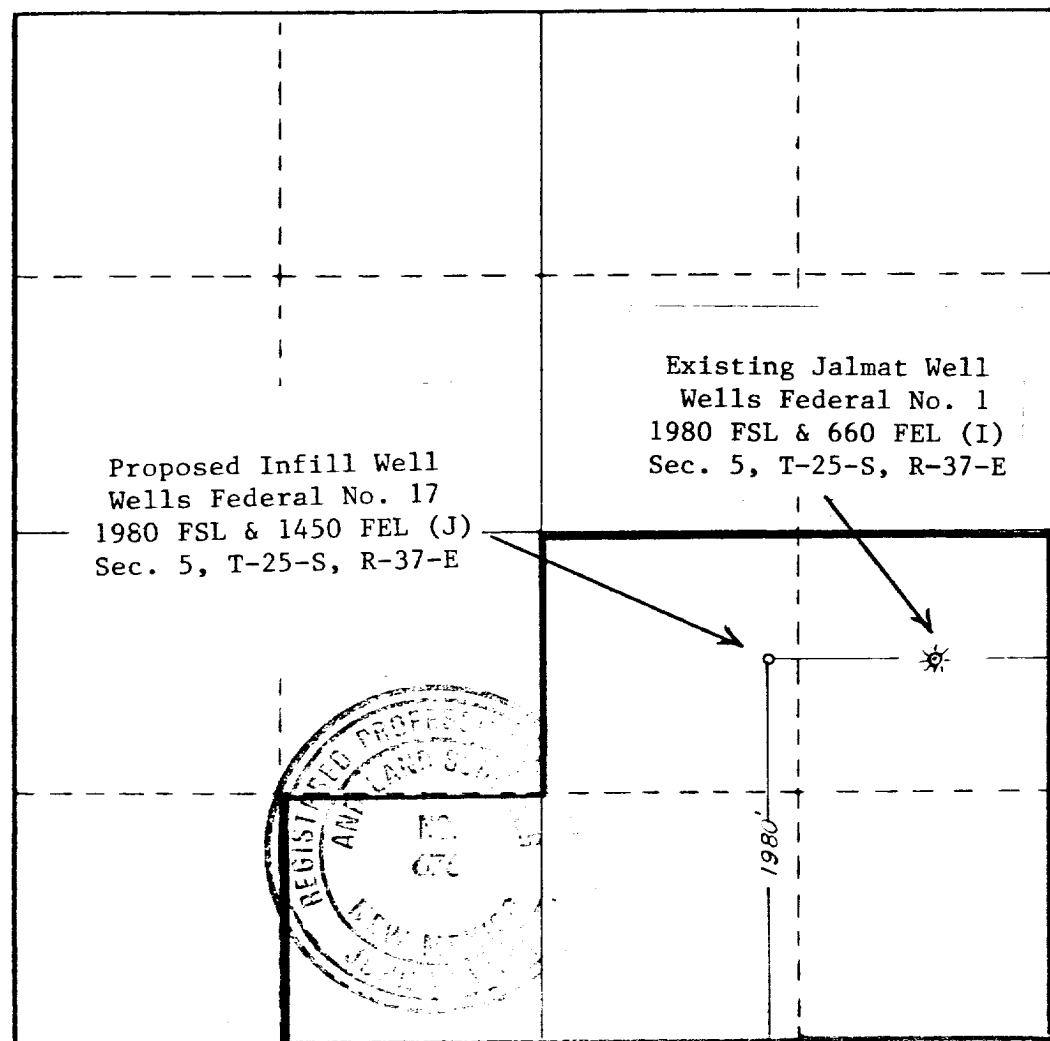

CERTIFICATION

I hereby certify that the information contained herein is true and complete to the best of my knowledge and belief.

Name
Larry A. Nanning

Position
Engineer

Company
Doyle Hartman

Date
JULY 24, 1984

I hereby certify that the well location shown on this plat was plotted from field notes of actual surveys made by me or under my supervision, and that the same is true and correct to the best of my knowledge and belief.

Date Surveyed
4/12/84

Registered Professional Engineer and/or Land Surveyor

John W. West

Certificate No. **JOHN W. WEST, 676**
RONALD J. EIDSON, 3239

RECEIVED

AUG 13 1984

O.C.P.
MOBILE OFFICE