

**WRS COMPLETION REPORT**COMPLETIONS SEC 28 TWP 25S RGE 37E  
PI# 30-T-0048 03/10/86 30-025-29529-0000 PAGE 1

NMEX LEA \* 990FSL 2310FWL SEC SE SW  
STATE COUNTY FOOTAGE SPOT  
BURLESON LEWIS B INC D DG  
OPERATOR WELL CLASS INIT FIN  
1 NANCY FEDERAL  
WELL NO LEASE NAME  
3019KB 3008GR LANGLEIE-MATTIX  
OPER ELEV FIELD POOL AREA  
API 30-025-29529-0000  
LEASE TYPE NO PERMIT OR WELL I.D. NO.  
12/08/1985 01/21/1986 ROTARY GAS  
SPUD DATE COMP. DATE TYPE TOOL STATUS  
3400 QUEEN ROD RIC CORP 11 RIG SUB 10  
PROJ. DEPTH PROJ. FORM CONTRACTOR  
DTD 3400 FM/TD QUEEN  
DRILLERS T.D. LOG T.D. PLUG BACK TO OLD T.D. FORM T.D.

**LOCATION DESCRIPTION**

1 MI SE JAL, NM

**CASING/LINER DATA**

CSG 8 5/8 @ 900 W/ 575 SACKS 01  
CSG 5 1/2 @ 3400 W/ 300 SACKS 02

**TUBING DATA**

TBG 2 3/8 AT 3085

**INITIAL POTENTIAL**

IPP 60.0MCFD 200BW  
SVN R ON PERF W/ 18/IT 2896- 3082 003  
PERF 2896- 3082  
ACID 2896- 3082 1750GALS  
15% NEFE  
P/L CON NONE  
GTY (GAS) NOT RPTD  
GOR (DRY)

TYPE	FORMATION	LTH	TOP DEPTH/SUB	BSE DEPTH/SUB
LOG	RUSTLER		880 2139	
LOG	SALT		990 2029	
LOG	TANSILL		2270 749	
LOG	YATES		2410 609	
LOG	SVN RVRS		2680 339	

CONTINUED IC# 300257060085

Copyrighted  
Reproduction  
ProhibitedPetroleum Information  
CORPORATIONPI-WRS-GET  
Form No 187

COMPLETIONS SEC 28 TWP 25S RGE 37E  
PI# 30-T-0048 03/10/86 30-025-29529-0000 PAGE 2

BURLESON LEWIS B INC D DG  
1 NANCY FEDERAL

TYPE	FORMATION	LTH	TOP	DEPTH/SUB	BSE	DEPTH/SUB
LOG	QUEEN		2840	179		

	LOGS AND SURVEYS /INTERVAL, TYPE/
LOGS	GRL NEUT

DRILLING PROGRESS DETAILS

BURLESON LEWIS B INC  
BOX 2479  
MIDLAND, TX 79702  
915-683-4747  
11/25 LOC/1985/  
12/09 DRLG 1053  
12/20 3400 TD, SI  
03/06 TD REACHED 12/13/85 RIG REL 12/14/85  
3400 TD  
COMP 1/21/86, IPP 60 MCFGPD, 200 BWP, GTY  
(GAS) (NR), GOR (DRY)  
PROD ZONE - 2896-3082  
NO CORES OR DSTS RPTD

# WRS COMPLETION REPORT

COMPLETIONS  
PI# 30-T-0031 06/23/86 SEC 28 TWP 25S RGE 37E  
30-025-29529-0001 PAGE 1

NMEX LEA \* 990FSL 2310FWL SEC SE SW  
STATE COUNTY FOOTAGE SPOT  
BURLESON LEWIS B INC  
OPERATOR D X DG  
1 NANCY FEDERAL WELL CLASS INIT FIN  
3008GR  
OPER ELEV JALMAT

API 30-025-29529-0001  
LEASE TYPE/NO. FIELD/POOL/AREA  
04/04/1986 04/08/1986 PERMIT OR WELL I.D. NO.  
SPUD DATE COMP. DATE TYPE TOOL GAS-WO  
2650 YTS-SVRV NOT RPTD STATUS  
PROJ. DEPTH PROJ. FORM CONTRACTOR  
DTD 3400 PB 2650 OTD 3400 FM/TD QUEEN  
DRILLERS T.D. LOG T.D. PLUG BACK TD OLD T.D. FORM T.D.  
LOCATION DESCRIPTION

1 MI SE JAL, NM

## TUBING DATA

TBG 2 3/8 AT 2547

## INITIAL POTENTIAL

IPP 30.0MCFD 3BW 32/64CK 6HRS  
YTS-SVRV PERF W/ 19/IT 2418- 2501 002  
PERF 2418- 2501  
ACID 2418- 2501 1000GALS  
15%

POT BASED ON 6 HR TEST GOR (DRY)  
GTY (GAS) NR

## PRODUCTION TEST DATA

QUEEN PERF 2896- 3082 001  
SVN RVRS 001  
PERF 2896- 3082  
BRPG 2896- 3082

DEPTH 2650

## DRILLING PROGRESS DETAILS

BURLESON LEWIS B INC  
BOX 2479  
MIDLAND, TX 79702

CONTINUED IC# 300257016686

Copyrighted  
Reproduction  
Prohibited



Petroleum Information  
CORPORATION

PI-WRS-C  
Form No 1

COMPLETIONS SEC 28 TWP 25S RGE 37E  
PI# 30-T-0031 06/23/86 30-025-29529-0001 PAGE 2

BURLESON LEWIS B INC  
1 NANCY FEDERAL

D X DG

DRILLING PROGRESS DETAILS

915-683-4747

OWWO: OLD INFO: FORMERLY BURLESON LEWIS B INC.  
#1 NANCY FEDERAL. ELEV 3008 GR. SPUD 12/8/85.  
8 5/8 @ 900 W/575 SX, 5 1/2 @ 3400 W/300 SX. LOG  
TOPS: YATES 2410, SEVEN RIVERS 2680, QUEEN 2840.  
OTD 3400. COMP 1/21/86. IPP 60 MCFGPD. PROD  
ZONE: QUEEN-SEVEN RIVERS 2896-3082.

06/18  
06/18

LOC/1986/  
3400 TD, PB 2650  
COMP 4/8/86, IPP 30 MCFG, 3 BWPD, GTY  
(GAS) (NR), GOR (DRY),  
CK 32/64  
PROD ZONE - YATES-SEVEN RIVERS 2418-2501  
FIRST REPORT & COMPLETION

**NEW MEXICO OIL CONSERVATION COMMISSION  
WELL LOCATION AND ACREAGE DEDICATION PLAT**

Form C-102  
Supersedes C-128  
Effective 1-

All distances must be from the outer boundaries of the Section.

Operator <b>Lewis B. Burleson, Inc.</b>			Lease <b>Nancy Federal</b>			Well No. <b>1</b>		
Unit Letter <b>N</b>	Section <b>28</b>	Township <b>25-S</b>	Range <b>37-E</b>	County <b>Lea</b>				
Actual Footage Location of Well: <b>2310</b> feet from the <b>West</b> line and <b>990</b> feet from the <b>South</b> line								
Ground Level Elev. <b>3008 GR</b>	Producing Formation <b>Yates</b>		Well <b>Jalmat (YTS-SR)</b>			Dedicated Acreage: <b>200</b> Acres		

1. Outline the acreage dedicated to the subject well by colored pencil or hachure marks on the plat below.
2. If more than one lease is dedicated to the well, outline each and identify the ownership thereof (both as to working interest and royalty).
3. If more than one lease of different ownership is dedicated to the well, have the interests of all owners been consolidated by communitization, unitization, force-pooling, etc?

☒ Yes    ☐ No    If answer is "yes," type of consolidation communitization

If answer is "no," list the owners and tract descriptions which have actually been consolidated. (Use reverse side of this form if necessary.) \_\_\_\_\_

No allowable will be assigned to the well until all interests have been consolidated (by communitization, unitization, forced-pooling, or otherwise) or until a non-standard unit, eliminating such interests, has been approved by the Commission.

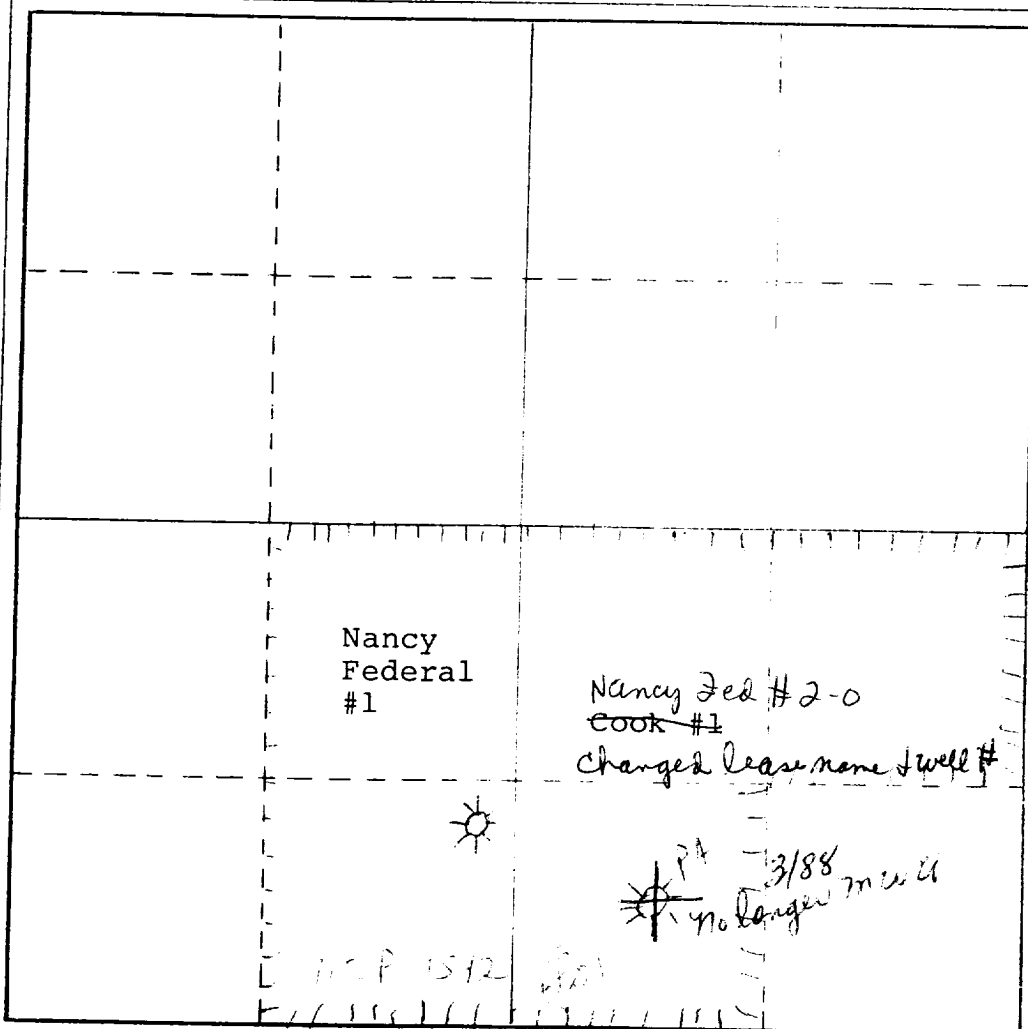

**CERTIFICATION**

I hereby certify that the information contained herein is true and complete to the best of my knowledge and belief.

*Steven Burleson*

**Steven Burleson**

**Vice President**

**LEWIS B. BURLESON, INC**

**8/21/87**

I hereby certify that the well location shown on this plat was plotted from field notes of actual surveys made by me or under my supervision, and that the same is true and correct to the best of my knowledge and belief.

\_\_\_\_\_  
Professional Engineer  
and/or Land Surveyor

Certificate No.

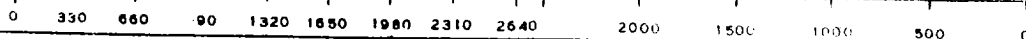

RECEIVED  
AUG 24 1987  
OCD  
MOBBS OFFICE

NEW MEXICO OIL CONSERVATION COMMISSION  
WELL LOCATION AND ACREAGE DEDICATION PLAT

Form C-104  
Supersedes C-128  
Effective 1-1-65

All distances must be from the outer boundaries of the Section

Operator LEWIS BURLESON, INC.			Lease NANCY FED.		Well No. 1
Unit Letter N	Section 28	Township 25 SOUTH	Range 37 EAST	County LEA	
Actual Footage Location of Well: 990 feet from the SOUTH line and 2310 feet from the WEST line					
Ground Level Elev. 3008.4'	Producing Formation Yates		Pool Jalmat	Dedicated Acreage: 80 Acres	

1. Outline the acreage dedicated to the subject well by colored pencil or hachure marks on the plat below.
2. If more than one lease is dedicated to the well, outline each and identify the ownership thereof (both as to working interest and royalty).
3. If more than one lease of different ownership is dedicated to the well, have the interests of all owners been consolidated by communitization, unitization, force-pooling, etc?

☐ Yes ☐ No If answer is "yes," type of consolidation \_\_\_\_\_

If answer is "no," list the owners and tract descriptions which have actually been consolidated. (Use reverse side of this form if necessary.) \_\_\_\_\_

No allowable will be assigned to the well until all interests have been consolidated (by communitization, unitization, forced-pooling, or otherwise) or until a non-standard unit, eliminating such interests, has been approved by the Commission.

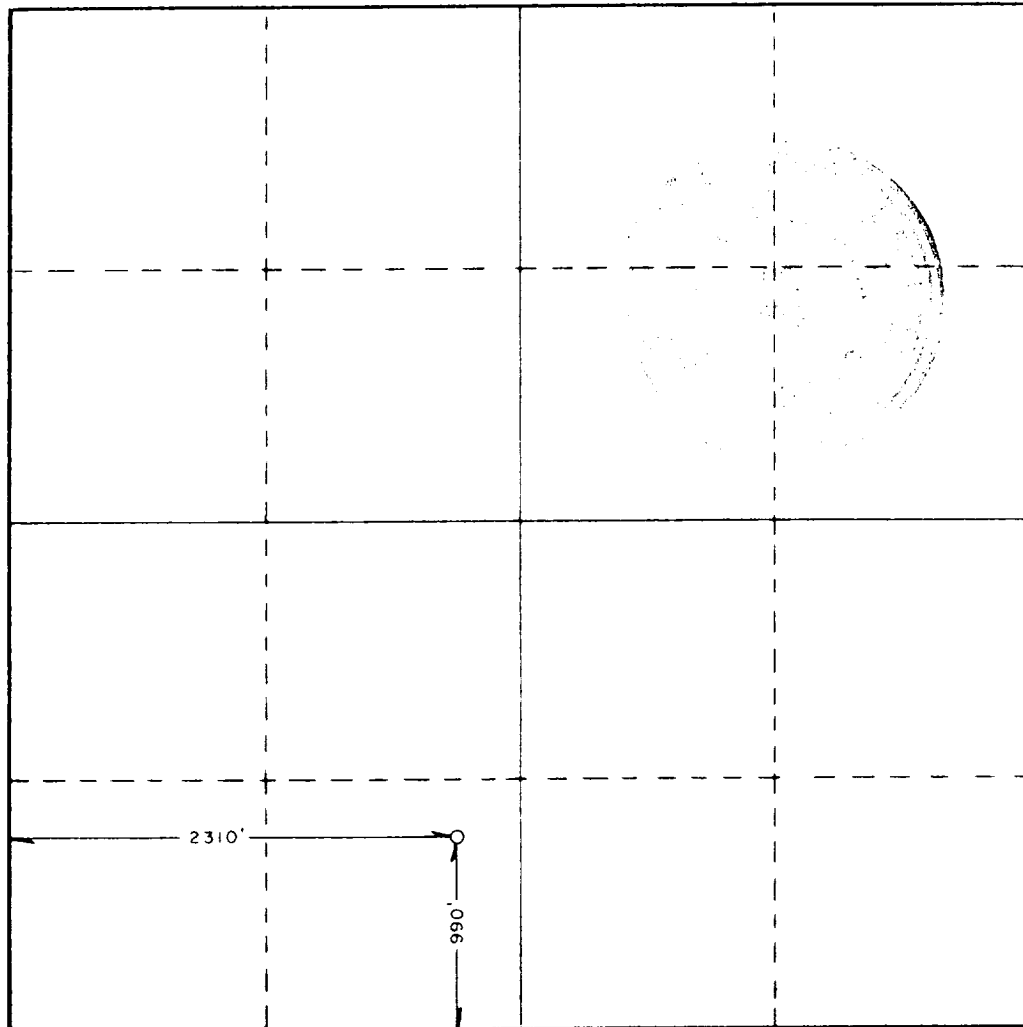

CERTIFICATION

I hereby certify that the information contained herein is true and complete to the best of my knowledge and belief.

Name  
*Steven Burleson*  
Position  
Vice-President-Exploration  
Company  
Lewis B. Burleson, Inc.  
Date  
April 9, 1986

I hereby certify that the well location shown on this plat was plotted from field notes of actual surveys made by me or under my supervision, and that the same is true and correct to the best of my knowledge and belief.

Date Surveyed  
NOVEMBER 11, 1985

Registered Professional Engineer  
and/or Land Surveyor

Certificate No. *John W. West*  
JOHN W. WEST, 676  
RONALD J. EIDSON, 3239