

UNITED STATES
DEPARTMENT OF THE INTERIOR
GEOLOGICAL SURVEY

SUBMIT IN TRIPPLICATE

Other Instructions
(reverse side)

Form approved.
Budget Bureau No. 42-R1425.

30-025-276-19

APPLICATION FOR PERMIT TO DRILL, DEEPEN, OR PLUG BACK

1a. TYPE OF WORK

DRILL ☒

DEEPEN ☐

PLUG BACK ☐

b. TYPE OF WELL

OIL
WELL ☐

GAS
WELL ☒

OTHER

SINGLE
ZONE ☒

MULTIPLE
ZONE ☐

2. NAME OF OPERATOR

Doyle Hartman

3. ADDRESS OF OPERATOR

P. O. Box 10426, Midland, Texas 79702

4. LOCATION OF WELL (Report location clearly and in accordance with any State requirements.)*

At surface

1650' FNL & 660' FWL (E), Section 9

At proposed prod. zone

14. DISTANCE IN MILES AND DIRECTION FROM NEAREST TOWN OR POST OFFICE*

1.7 miles north and .75 miles east of Jal, New Mexico

15. DISTANCE FROM PROPOSED*

LOCATION TO NEAREST
PROPERTY OR LEASE LINE, FT.
(Also to nearest drlg. unit line, if any)

330 feet

16. NO. OF ACRES IN LEASE

160

17. NO. OF ACRES ASSIGNED
TO THIS WELL

200

18. DISTANCE FROM PROPOSED LOCATION*

TO NEAREST WELL, DRILLING, COMPLETED,
OR APPLIED FOR, ON THIS LEASE, FT.

330

19. PROPOSED DEPTH

3550

20. ROTARY OR CABLE TOOLS

Rotary

21. ELEVATIONS (Show whether DF, RT, GR, etc.)

3173.0 GL

22. APPROX. DATE WORK WILL START*

July 1985

23.

PROPOSED CASING AND CEMENTING PROGRAM

SIZE OF HOLE	SIZE OF CASING	WEIGHT PER FOOT	SETTING DEPTH	QUANTITY OF CEMENT
14 3/4	9 5/8	36	400	200 (Circulate)*
8 3/4	7	23	3550	600 (Circulate)*

Before drilling out from under the surface pipe, the well will be equipped with a 3000-psi 10-inch series 900 Double-Ram Hydraulic BOP.

For other necessary BOP data required with this ADP, see attached Drilling Prognosis.

Note: Any gas produced from this well is dedicated to El Paso Natural Gas Company.

IN ABOVE SPACE DESCRIBE PROPOSED PROGRAM: If proposal is to deepen or plug back, give data on present productive zone and proposed new productive zone. If proposal is to drill or deepen directionally, give pertinent data on subsurface locations and measured and true vertical depths. Give blowout preventer program, if any.

24.

SIGNED Larry A. Nemmy

TITLE Engineer

DATE July 15, 1985

(This space for Federal or State office use)

PERMIT NO.

APPROVAL DATE

APPROVED BY

TITLE

DATE

CONDITIONS OF APPROVAL, IF ANY:

APPROVAL SUBJECT TO
GENERAL REQUIREMENTS AND
SPECIAL CONDITIONS
ATTACHED

*See Instructions On Reverse Side

NEW MEXICO OIL CONSERVATION COMMISSION
WE LOCATION AND ACREAGE DEDICATION PLAT

Form C-102
 Supersedes C-126
 Effective 1-1-85

All distances must be from the outer boundaries of the Section

Operator DOYLE HARTMAN			Lease WELLS FED.			Well No. 20		
Unit Letter E	Section 9&4	Township 25 SOUTH	Range 37 EAST	County LEA				
Actual Footage Location of Well: 1650 feet from the NORTH line and 660 feet from the WEST line								
Ground Level Elev. 3173.0	Producing Formation Yates-Seven Rivers		Pool Jalmat Gas			Dedicated Acreage: 200		

1. Outline the acreage dedicated to the subject well by colored pencil or hatchure marks on the plat below.
2. If more than one lease is dedicated to the well, outline each and identify the ownership thereof (both as to working interest and royalty).
3. If more than one lease of different ownership is dedicated to the well, have the interests of all owners been consolidated by communitization, unitization, force-pooling, etc?

☒ Yes ☐ No If answer is "yes," type of consolidation Communitization

If answer is "no," list the owners and tract descriptions which have actually been consolidated. (Use reverse side of this form if necessary.) _____

No allowable will be assigned to the well until all interests have been consolidated (by communitization, unitization, forced-pooling, or otherwise) or until a non-standard unit, eliminating such interests, has been approved by the Commission.

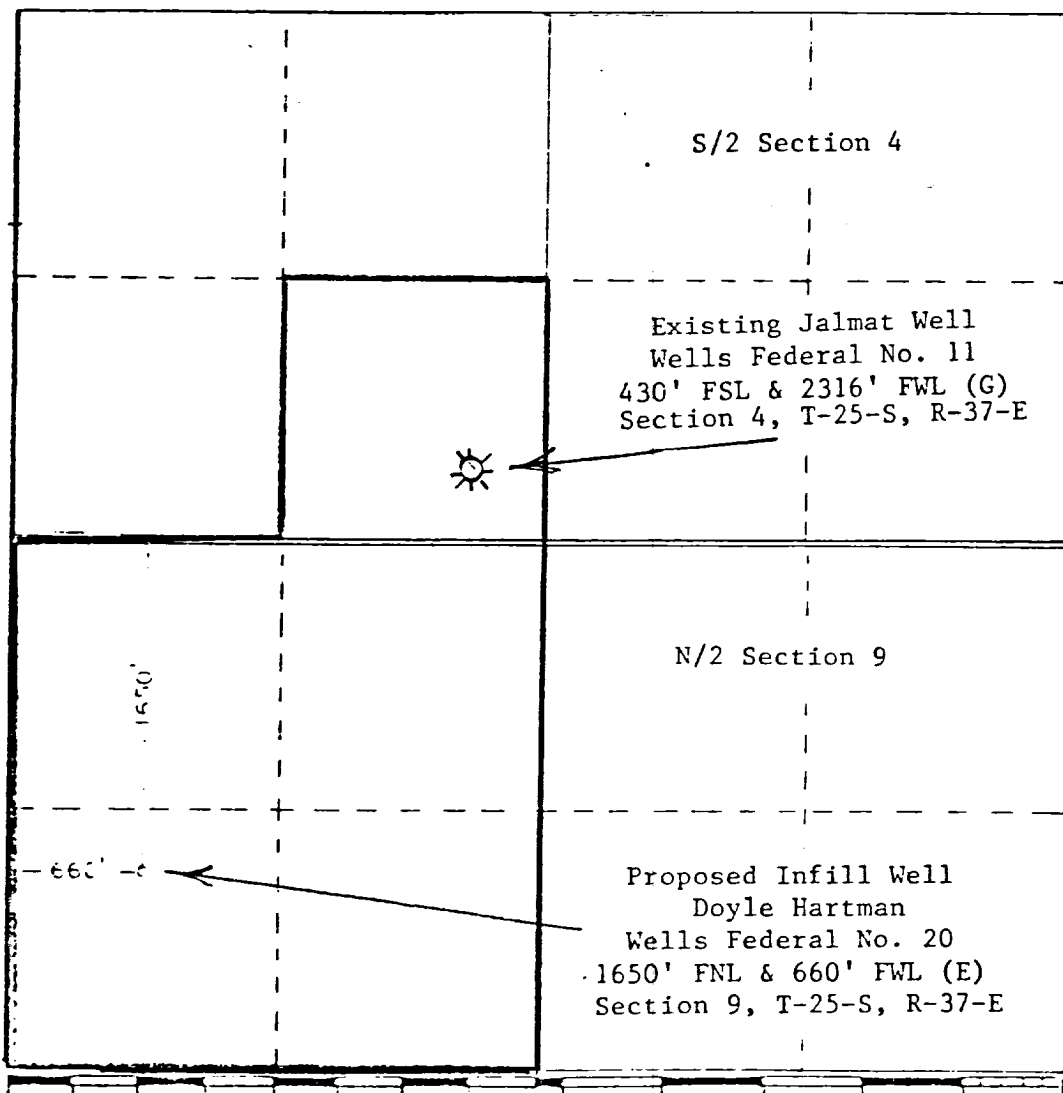

CERTIFICATION

I hereby certify that the information contained herein is true and complete to the best of my knowledge and belief.

Name Larry G. Norman

Position
Engineer

Company
Doyle Hartman, Oil Operator

Date
JULY 12, 1985

I hereby certify that the well location shown on this plat was plotted from field notes of actual surveys made by me or under my supervision, and that the same is true and correct to the best of my knowledge and belief.

Date Surveyed
JUNE 7, 1985

Registered Professional Engineer and/or Land Surveyor

John W. West
 Certificate No. **JOHN W. WEST** **ETC**

RECEIVED
JUN 2 1986
O.C.D.
HOBBS OFFICE

ASE ROTARY TABLE

Flow line will have to be made
to fit UNDER Rotary.

Optional

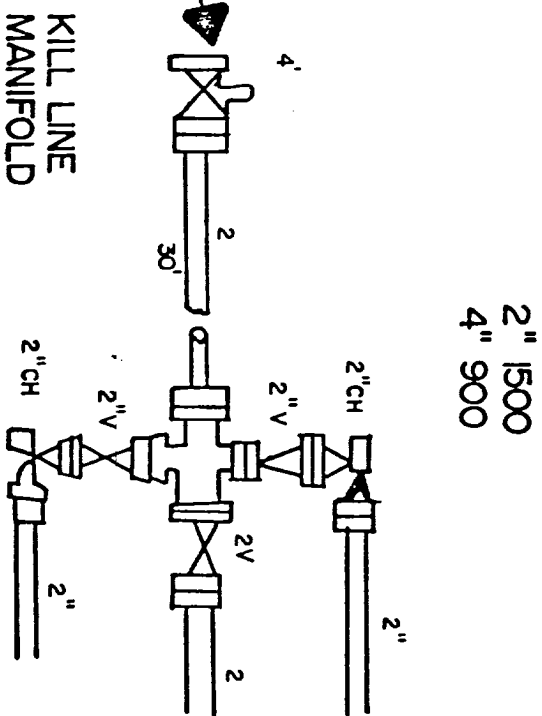
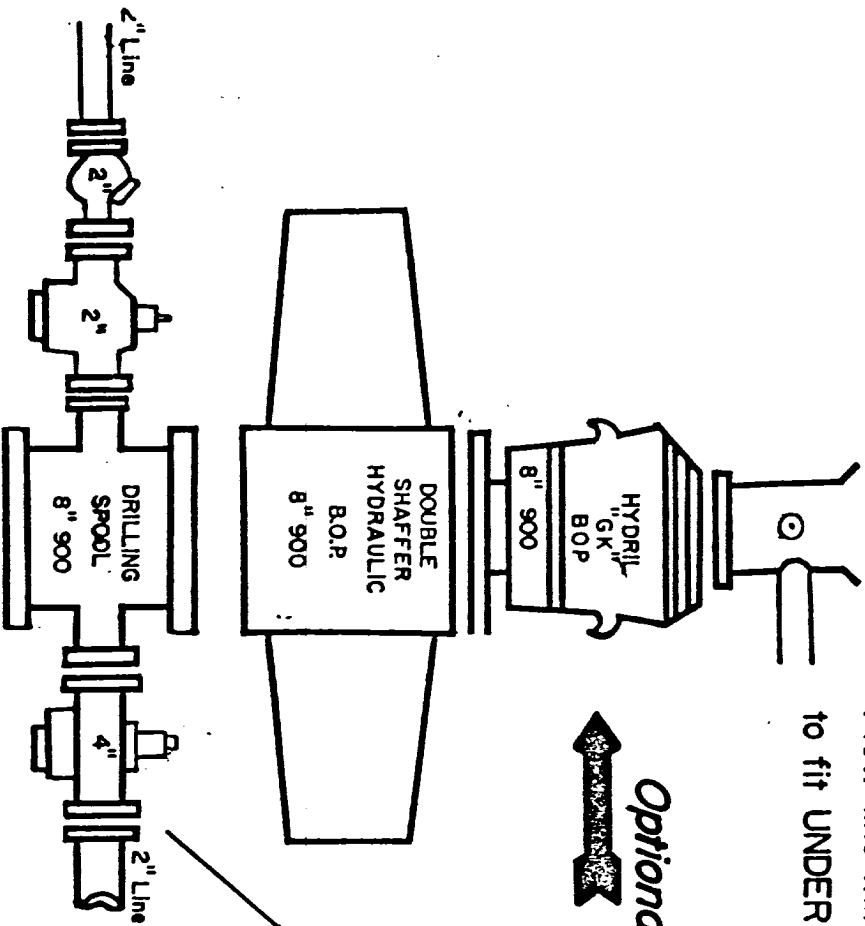

RECEIVED
JUN 2 1986
O.C.D.
HOBBS OFFICE

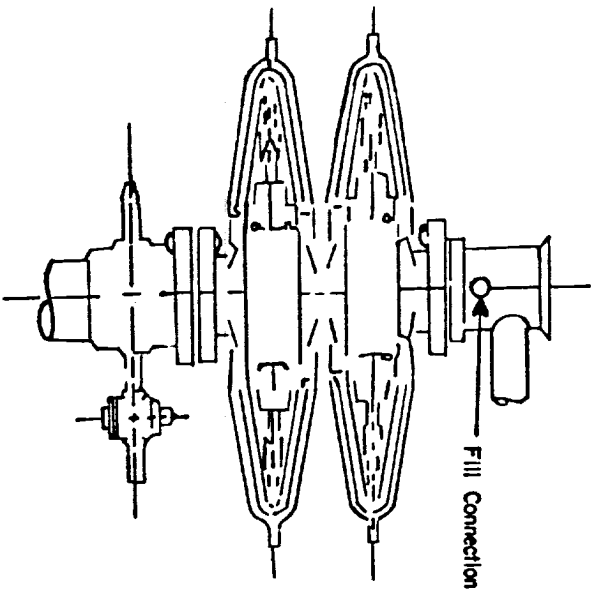

Shafter Type E Series 900 Hydraulic BOP

3000 PSI WORKING PRESSURE
BLOWOUT PREVENTER HOOK-UP

Series 900 Flanges, or Better.

Note: B.O.P. system will meet the conditions of drilling approval
required by the USGS District Office in Hobbs, New Mexico.

RECEIVED
JUN 2 1986
O.C.D.
HOBBS OFFICE

NEW MEXICO OIL CONSERVATION COMMISSION
WELL LOCATION AND ACREAGE DEDICATION PLAT

Form C-122
Supersedes C-128
Effective 1-1-85

All distances must be from the outer boundaries of the Section

Operator DOYLE HARTMAN			Lease WELLS FED.			Well No. 20		
Tract Letter E	Section 9&4	Township 25 SOUTH	Range 37 EAST	County LEA				
Actual Footage Location of Well: 1650 feet from the NORTH line and 660 feet from the WEST line								
Ground Level Elev. 3173.0		Producing Formation Yates-Seven Rivers			Pool Jalmat Gas		Dedicated Acreage 200	
Acres								

1. Outline the acreage dedicated to the subject well by colored pencil or hachure marks on the plat below.
2. If more than one lease is dedicated to the well, outline each and identify the ownership thereof (both as to working interest and royalty).
3. If more than one lease of different ownership is dedicated to the well, have the interests of all owners been consolidated by communitization, unitization, force-pooling, etc?

☒ Yes ☐ No If answer is "yes," type of consolidation Communitization

If answer is "no," list the owners and tract descriptions which have actually been consolidated. (Use reverse side of this form if necessary.)

No allowable will be assigned to the well until all interests have been consolidated (by communitization, unitization, forced-pooling, or otherwise) or until a non-standard unit, eliminating such interests, has been approved by the Commission.

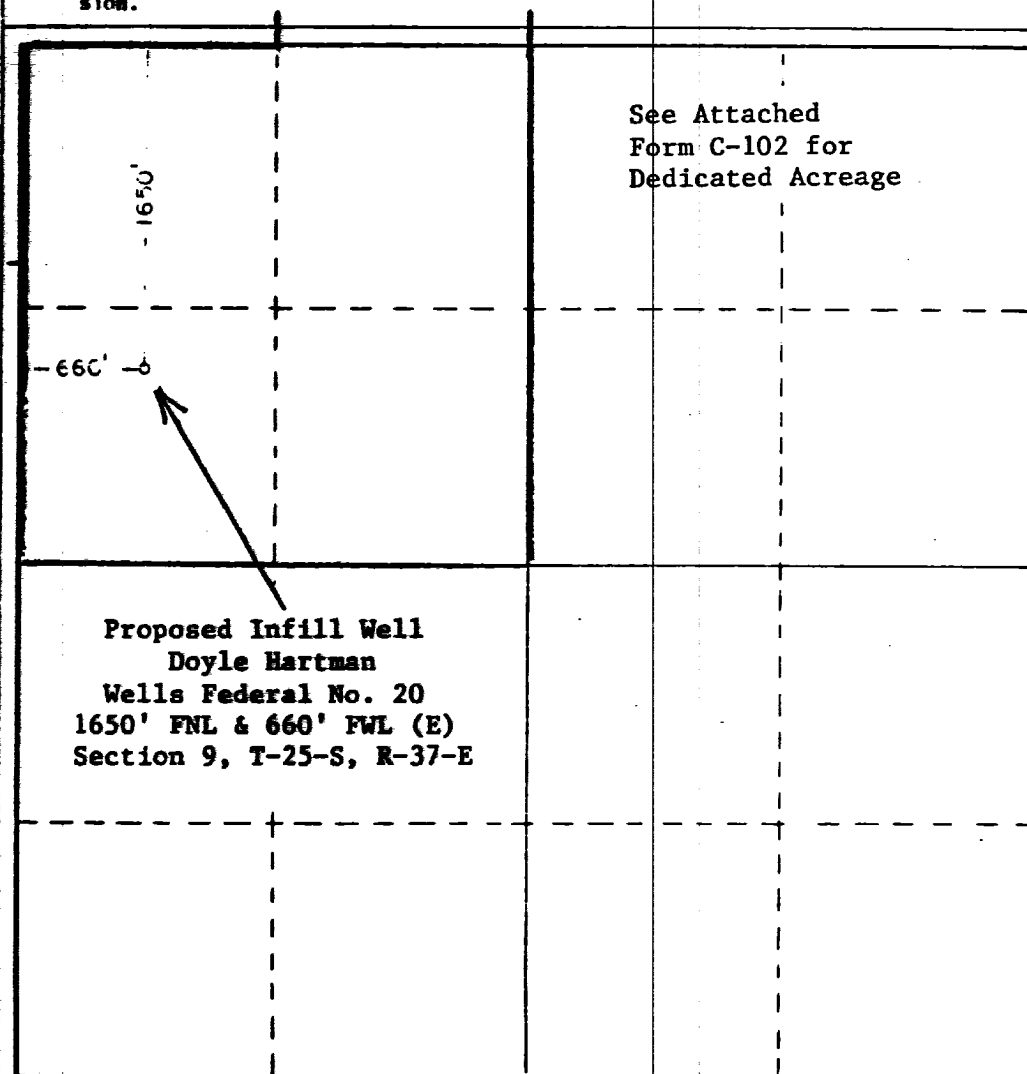

CERTIFICATION

I hereby certify that the information contained herein is true and complete to the best of my knowledge and belief.

Name Larry A. Nemy
Position Engineer
Company Doyle Hartman, Oil Operator
Date July 17, 1985

I hereby certify that the well location shown on this plat was plotted from field notes of actual surveys made by me or under my supervision, and that the same is true and correct to the best of my knowledge and belief.

Date Surveyed JUNE 1985
Registered Professional Engineer and/or Land Surveyor

[Signature]
Certificate No. JOHN W. WEST, 676
RONALD J. EIDSON, 3239

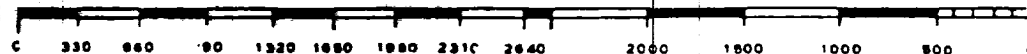

RECEIVED
JUN 2 1986
HOBBS