

NO. OF COPIES RECEIVED	
DISTRIBUTION	
SANTA FE	
FILE	
U.S.G.S.	
LAND OFFICE	
OPERATOR	

NEW MEXICO OIL CONSERVATION COMMISSION

30-025-29884

Form C-101
Revised 1-1-65

5A. Indicate Type of Lease
STATE ☐ FEE ☒
5. State Oil & Gas Lease No.

APPLICATION FOR PERMIT TO DRILL, DEEPEN, OR PLUG BACK

1a. Type of Work		7. Unit Agreement Name	
b. Type of Well OIL WELL <input type="checkbox"/> GAS WELL <input checked="" type="checkbox"/> OTHER <input type="checkbox"/>		8. Farm or Lease Name Page 3 Com.	
2. Name of Operator Enron Oil & Gas Company		9. Well No. 2	
3. Address of Operator P. O. Box 2267, Midland, Texas 79702		10. Field and Pool, or Wildcat Pitchfork Ranch Atoka	
4. Location of Well UNIT LETTER C LOCATED 660 FEET FROM THE north LINE AND 2080 FEET FROM THE west LINE OF SEC. 3 TWP. 25S RGE. 34E NMPM		12. County Lea	
21. Elevations (Show whether DF, RT, etc.) 3366.3' GR		19. Proposed Depth 14,300'	19A. Formation Atoka
21A. Kind & Status Plug. Bond Blanket-Active		21B. Drilling Contractor Parker Drilling Company	20. Rotary or C.T. Rotary
23.		22. Approx. Date Work will start When permitted	

PROPOSED CASING AND CEMENT PROGRAM

SIZE OF HOLE	SIZE OF CASING	WEIGHT PER FOOT	SETTING DEPTH	SACKS OF CEMENT	EST. TOP
15-1/4"	11-3/4	42#	625'	500	Circulated
10-5/8"	8-5/8	24#	5200'	2500	Circulated
7-7/8"	5-1/2	17#	13250	1200	
4-3/4"	Liner 3-1/2	10.5#	14300	325	

TOL: 11800 est.

BOP - Install at 5200 feet with 3000# cap. and 2450# annular preventor. At 13,250' increase to 10,000# cap. with 5000# annular preventor. Will use standard surface controlled BOP installation.

Gas is dedicated.

Permit Expires 6 Months From Approval
Date Unless Drilling Underway.

IN ABOVE SPACE DESCRIBE PROPOSED PROGRAM: IF PROPOSAL IS TO DEEPEN OR PLUG BACK, GIVE DATA ON PRESENT PRODUCTIVE ZONE AND PROPOSED NEW PRODUCTIVE ZONE. GIVE BLOWOUT PREVENTER PROGRAM, IF ANY.

I hereby certify that the information above is true and complete to the best of my knowledge and belief.

Signature Betty Gildon Title Regulatory Analyst

Date 3/31/87

(This space for State Use)

ORIGINAL SIGNED BY JERRY SEXTON

DISTRICT I SUPERVISOR

APPROVED BY _____ TITLE _____

CONDITIONS OF APPROVAL, IF ANY:

APR 3 1987

RECEIVED
APR 2 1987
OCB
HARRIS OFFICE

N. EXICO OIL CONSERVATION COMMISS.
WELL LOCATION AND ACREAGE DEDICATION PLAT

Form C-102
Supersedes C-128
Effective 1-1-65

All distances must be from the outer boundaries of the Section.

Operator ENRON OIL & GAS CO.		Lease PAGE 3 COM		Well No. 2
Unit Letter C	Section 3	Township 25S	Range 34E	County LEA
Actual Footage Location of Well: 660 feet from the NORTH line and 2080 feet from the WEST line				
Ground Level Elev. 3366.3	Producing Formation Atoka	Pool Pitchfork Ranch	Dedicated Acreage: 320 N/2 Acres	

1. Outline the acreage dedicated to the subject well by colored pencil or hatchure marks on the plat below.
2. If more than one lease is dedicated to the well, outline each and identify the ownership thereof (both as to working interest and royalty).
3. If more than one lease of different ownership is dedicated to the well, have the interests of all owners been consolidated by communitization, unitization, force-pooling, etc?

☒ Yes ☐ No If answer is "yes," type of consolidation Communitization

If answer is "no," list the owners and tract descriptions which have actually been consolidated. (Use reverse side of this form if necessary.)

No allowable will be assigned to the well until all interests have been consolidated (by communitization, unitization, forced-pooling, or otherwise) or until a non-standard unit, eliminating such interests, has been approved by the Commission.

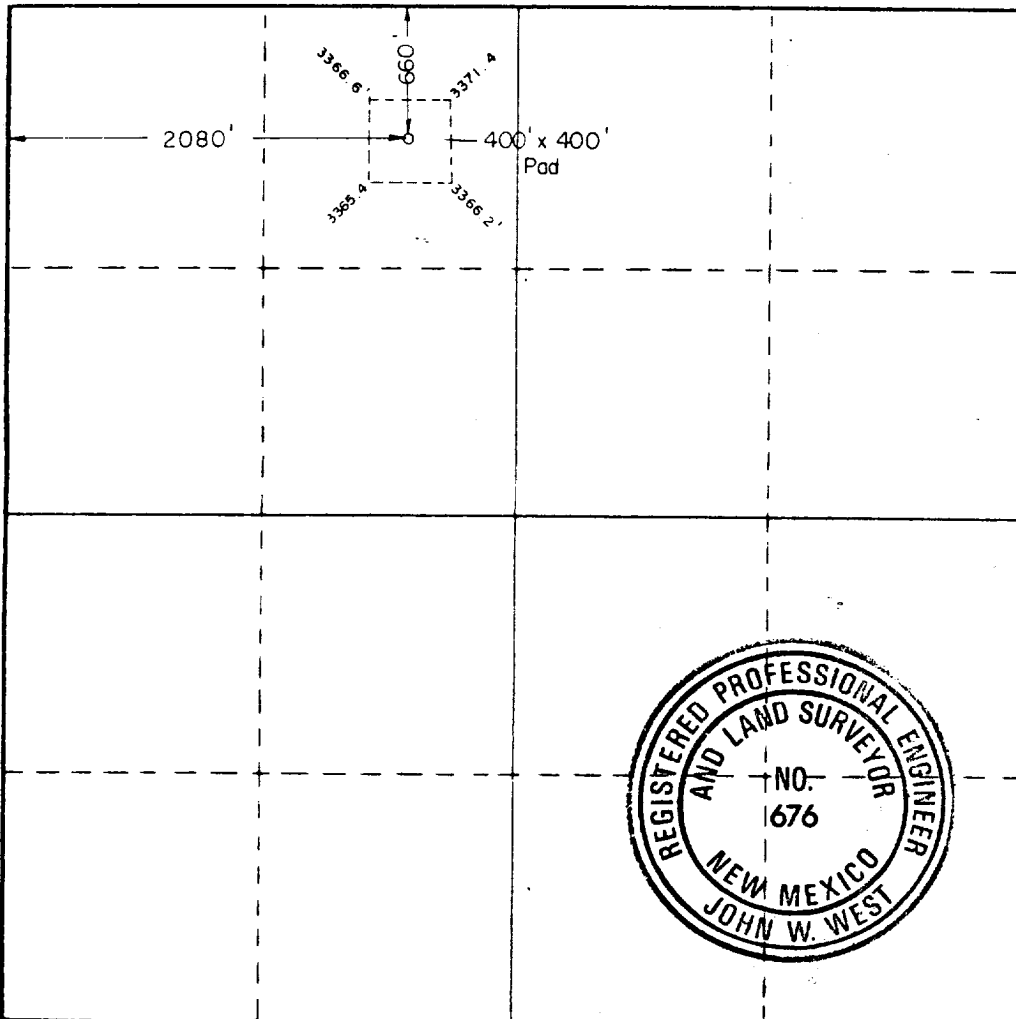

CERTIFICATION

I hereby certify that the information contained herein is true and complete to the best of my knowledge and belief.

Betty Gildon
Name

Betty Gildon

Position

Regulatory Analyst

Company

Enron Oil & Gas Company

Date

March 31, 1987

I hereby certify that the well location shown on this plat was plotted from field notes of actual surveys made by me or under my supervision, and that the same is true and correct to the best of my knowledge and belief.

Date Surveyed

MARCH 26, 1987

Registered Professional Engineer and/or Land Surveyor

John W. West

Certificate No. JOHN W. WEST, 676

RONALD J. EIDSON, 3239

RECEIVED
APR 2 1987
OCD
HOBBS OFFICE

Rec'd 7/28/87
173