

**NEW MEXICO OIL CONSERVATION COMMISSION
WELL LOCATION AND ACREAGE DEDICATION PLAT**

Form C-102
Supersedes C-128
Effective 1-1-65

All distances must be from the outer boundaries of the Section.

| | | | | |
|---|-------------------------------------|--|---------------------------------------|-----------------------|
| Operator SIRGO-COLLIER INC. | | Lease <u>West Dollarhide Queen</u> NDQSU-32 <u>Sand Unit</u> | | Well No. 82 |
| Unit Letter D | Section 32 | Township 24 South | Range 38 East | County Lea |
| Actual Footage Location of Well: <div style="display: flex; justify-content: space-between;"> 330 feet from the North line and 1150 feet from the West line </div> | | | | |
| Ground Level Elev. 3180. | Producing Formation Queen | Pool Dollarhide Queen | Dedicated Acreage: 40 Acres | |

1. Outline the acreage dedicated to the subject well by colored pencil or hachure marks on the plat below.
2. If more than one lease is dedicated to the well, outline each and identify the ownership thereof (both as to working interest and royalty).
3. If more than one lease of different ownership is dedicated to the well, have the interests of all owners been consolidated by communitization, unitization, force-pooling, etc?

☒ Yes ☐ No If answer is "yes," type of consolidation R2356 Unitization

If answer is "no," list the owners and tract descriptions which have actually been consolidated. (Use reverse side of this form if necessary.) _____

No allowable will be assigned to the well until all interests have been consolidated (by communitization, unitization, forced-pooling, or otherwise) or until a non-standard unit, eliminating such interests, has been approved by the Commission.

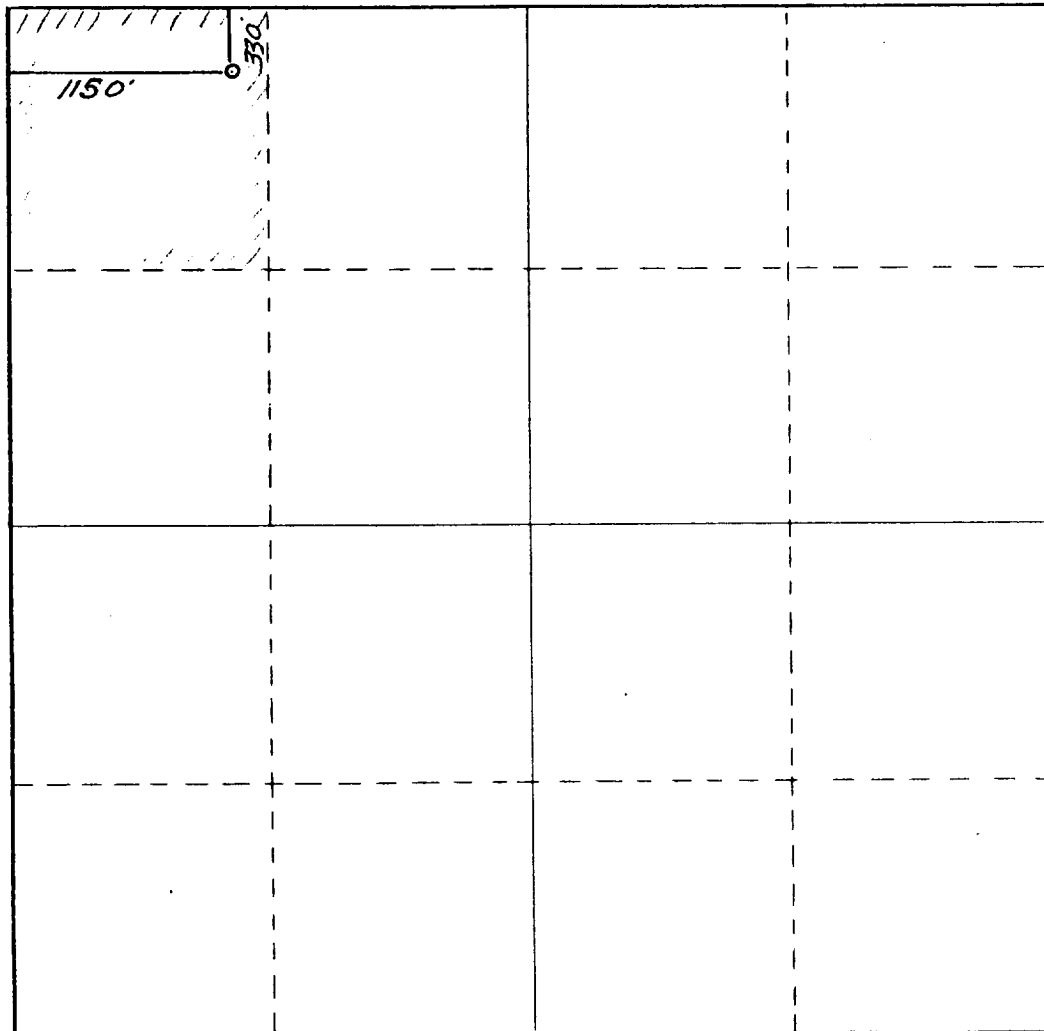

CERTIFICATION

I hereby certify that the information contained herein is true and complete to the best of my knowledge and belief.

Leah Atchley
Name

Leah Atchley

Position
Agent

Company
Sirgo-Collier

Date
August 3, 1987

I hereby certify the well location shown on this plat was plotted from field notes of actual surveys made by me or under my supervision, and that the same is true and correct to the best of my knowledge and belief.

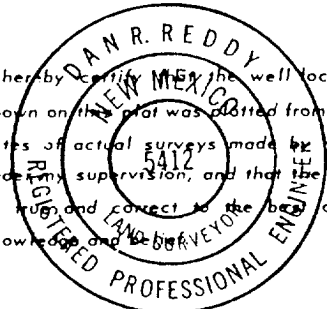

Date Surveyed
July 15, 1987

Registered Professional Engineer and/or Land Surveyor

Dan R. Reddy
Certificate No.
NM PE&LS NO. 5412

