

STATE OF NEW MEXICO
ENERGY AND MINERALS DEPARTMENT

OIL CONSERVATION DIVISION

P. O. BOX 2088
SANTA FE, NEW MEXICO 87501

Form C-101
Revised 10-1-78

NO. OF COPIES RECEIVED	
DISTRIBUTION	
SANTA FE	
FILE	
U.S.G.S.	
LAND OFFICE	
OPERATOR	

5A. Indicate Type of Lease
STATE ☒ FEDERAL ☐

5. State Oil & Gas Lease No.
B-9311

APPLICATION FOR PERMIT TO DRILL, DEEPEN, OR PLUG BACK

1a. Type of Work
DRILL ☒ DEEPEN ☐ PLUG BACK ☐

b. Type of Well
OIL WELL ☒ GAS WELL ☐ OTHER ☐ SINGLE ZONE ☒ MULTIPLE ZONE ☐

2. Name of Operator
Sirgo-Collier, Inc.

3. Address of Operator
P. O. Box 3531, Midland, Texas 79702

4. Location of Well
UNIT LETTER K LOCATED 1500 FEET FROM THE South LINE
AND 1700 FEET FROM THE West LINE OF SEC. 32 TWP. 24-S RGE. 38-E NMPM

7. Unit Agreement Name
West Dollarhide Queen Sand Unit

8. Farm or Lease Name

9. Well No.
89

10. Field and Pool, or Wildcat
Dollarhide Queen

12. County
Lea

19. Proposed Depth
3900

19A. Formation
Queen

20. Rotary or C.T.
Rotary

21. Elevations (Show whether DF, KT, etc.)
GL 3158' KB 3169.5'

21A. Kind & Status Plug. Bond
Cash Statewide

21B. Drilling Contractor
Peterson Drlg., Rig #2

22. Approx. Date Work will start
October 24, 1987

PROPOSED CASING AND CEMENT PROGRAM

SIZE OF HOLE	SIZE OF CASING	WEIGHT PER FOOT	SETTING DEPTH	SACKS OF CEMENT	EST. TOP
12-1/4"	8-5/8"	24#	420'	250	Surface
7-7/8"	5-1/2"	15.50#	3900'	1000	Surface

Queen zone will be selectively perforated and stimulated as needed for optimum production.

ABOVE SPACE DESCRIBE PROPOSED PROGRAM: IF PROPOSAL IS TO DEEPEN OR PLUG BACK, GIVE DATA ON PRESENT PRODUCTIVE ZONE AND PROPOSED NEW PRODUCTIVE ZONE. GIVE BLOWOUT PREVENTER PROGRAM, IF ANY.

I hereby certify that the information above is true and complete to the best of my knowledge and belief.

Signed Amy L. Whitley Title Agent Date September 17, 1987

(This space for State Use)

Orig. Signed by

Paul Kautz

Geologist

APPROVED BY _____ TITLE _____ DATE OCT 2 1987

CONDITIONS OF APPROVAL, IF ANY:

Permit Expires 6 Months From Approval
Date Unless Drilling Underway.

7822401

RECEIVED

SEP 18 1987

**OCD
HOBBS OFFICE**

**NEW MEXICO OIL CONSERVATION COMMISSION
WELL LOCATION AND ACREAGE DEDICATION PLAT**

Form C-102
Supersedes C-128
Effective 1-1-65

All distances must be from the outer boundaries of the Section.

Operator SIRGO-COLLIER, INC.			Lease WDQSU 32-89		Well No. 89
Unit Letter K	Section 32	Township 24 South	Range 38 East	County Lea County, N.M.	
Actual Footage Location of Well: <div style="display: flex; justify-content: space-between;"> 1500 feet from the South line and 1700 feet from the West line </div>					
Ground Level Elev. 3158.	Producing Formation Queen		Pool Dollarhide Queen		Dedicated Acreage: 40 Acres

1. Outline the acreage dedicated to the subject well by colored pencil or hachure marks on the plat below.
2. If more than one lease is dedicated to the well, outline each and identify the ownership thereof (both as to working interest and royalty).
3. If more than one lease of different ownership is dedicated to the well, have the interests of all owners been consolidated by communitization, unitization, force-pooling, etc?

☒ Yes ☐ No If answer is "yes," type of consolidation R-2356, Unitization

If answer is "no," list the owners and tract descriptions which have actually been consolidated. (Use reverse side of this form if necessary.) _____

No allowable will be assigned to the well until all interests have been consolidated (by communitization, unitization, forced-pooling, or otherwise) or until a non-standard unit, eliminating such interests, has been approved by the Commission.

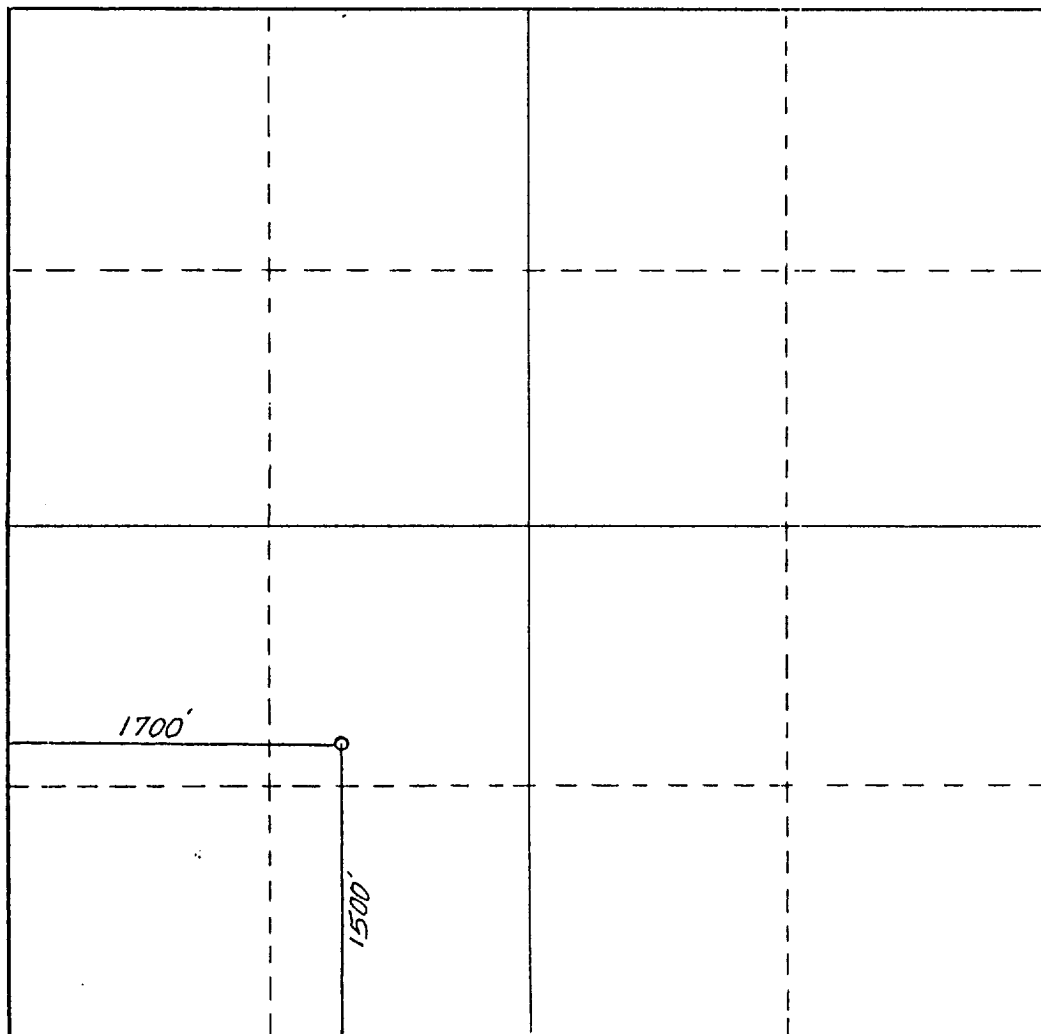

CERTIFICATION

I hereby certify that the information contained herein is true and complete to the best of my knowledge and belief.

Name
Amy L. Whitley
Position
Agent
Company
Sirgo-Collier, Inc.
Date
9-17-87

I hereby certify that the well location shown on this plat was plotted from field notes of actual surveys made by me or under my supervision, and that the same is true and correct to the best of my knowledge and belief.

Date Surveyed
September 11, 1987
Registered Professional Engineer
and/or Land Surveyor

Dan R. Reddy
Certificate No.
NM PE&LS NO. 5412

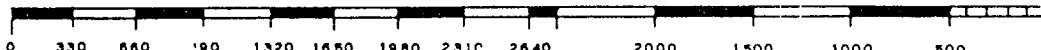

BOP Description

PETERSON DRILLING COMPANY

Rig #2

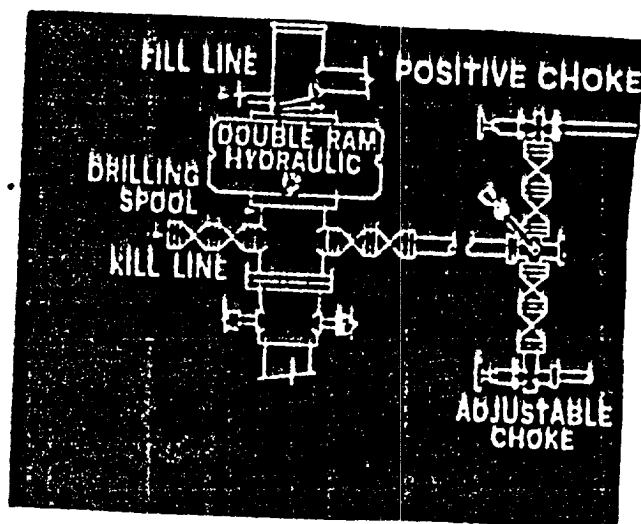

18-22-11 2021
ETB