

NO. OF COPIES RECEIVED	
DISTRIBUTION	
SANTA FE	
FILE	
U.S.G.L.	
LAND OFFICE	
OPERATOR	

APPLICATION FOR PERMIT TO DRILL, DEEPEN, OR PLUG BACK

Type of Work

Type of Well DRILL ☒ DEEPEN ☐ PLUG BACK ☐

Oil Well ☒ GAS WELL ☐ OTHER ☐

Single Zone ☒ Multiple Zone ☐

Name of Operator
Texaco Producing Inc.

Address of Operator
P. O. Box 728, Hobbs, New Mexico 88240

Location of Well
UNIT LETTER G LOCATED 1535 FEET FROM THE North LINE
2575 FEET FROM THE East LINE OF SEC. 32 TWP. 24-S REC. 38-E WPM

12. County
Lea

19. Proposed Depth
6960'

19A. Formation
Abo & Drinkard

20. Rotary or C.T.
Rotary

21A. Kind & Status Plug. Bond
Blanket

21B. Drilling Contractor

22. Approx. Date Work will start
March 14, 1988

PROPOSED CASING AND CEMENT PROGRAM

SIZE OF HOLE	SIZE OF CASING	WEIGHT PER FOOT	SETTING DEPTH	SACKS OF CEMENT	EST. TOP
17-1/2"	13-3/8"	54.5#	1200'	1000	Circulate
12-1/4"	8-5/8"	32.0#	3050'	1300	Circulate
7-7/8"	5-1/2"	15.5# & 17.0#	6960'	750	Circulate

CEMENTING PROGRAM

SURFACE CASING: 1000 sacks Class "H" w/2% CaCl (15.6 ppg, 1.18 cu. ft./sx.)

INTERMEDIATE CASING: 1100 sacks HLW w/16# Salt, 1/4# Flocele/sack (12.9 ppg, 2.07 cu. ft./sack)
followed by 200 sacks Class "H" w/2% CaCl (15.8 ppg, 1.12 cu. ft./sack).

PRODUCTION CASING: 1st Stage: 200 sacks HLW w/10# Salt, .6% Halad-9/sack followed by 200 sacks
50/50 Poz (H) w/5# Salt, .6% Halad-9/sack.

2nd Stage: 150 sacks HLW w/10# Salt/sack followed by 200 sacks 50/50 Poz (H)
w/10# Salt/sack. (DV Tool @ 4000').

Sirgo-Collier operates a well in this 1/4, 1/4 Section and has been furnished with a copy of this application. NSL-2244 Applies.

ABOVE SPACE DESCRIBE PROPOSED PROGRAM IF PROPOSAL IS TO DEEPEN OR PLUG BACK, GIVE DATA ON PRESENT PRODUCTIVE ZONE AND PROPOSED NEW PRO-
DUCE. GIVE BLOWOUT PREVENTER PROGRAM, IF ANY.

I hereby certify that the information above is true and complete to the best of my knowledge and belief.

W. B. Cade

Title District Operations Manager

Date 2/09/88

(This space for State Use)

ORIGINAL SIGNED BY JERRY SEXTON

APPROVED BY DISTRICT I SUPERVISOR

TITLE

DATE

CONDITIONS OF APPROVAL, IF ANY:

Permit Expires 6 Months From Approval
Date Unless Drilling Underway.

FEB 12 1988

Account Order
800-800-8000
800-800-8000
800-800-8000

Account Order
800-800-8000
800-800-8000
800-800-8000

All distances must be from the outer boundaries of the Section.

Operator TEXACO PRODUCING INC.			Lease West Dollarhide Drinkard Unit		Well No. 93
Unit Letter G	Section 32	Township 24-S	Range 38-E	County Lea	
Actual Footage Location of Well:					
1535 feet from the North line and		2575 feet from the East line			
Ground Level Elev. 3187'	Producing Formation (Abo) and Tubb Drinkard (Drinkard)		Pool Dollarhide Tubb Drinkard		Dedicated Acreage: 40 Acres

1. Outline the acreage dedicated to the subject well by colored pencil or hatchure marks on the plat below.
2. If more than one lease is dedicated to the well, outline each and identify the ownership thereof (both as to working interest and royalty).
3. If more than one lease of different ownership is dedicated to the well, have the interests of all owners been consolidated by communitization, unitization, force-pooling, etc?

☒ Yes ☐ No If answer is "yes," type of consolidation Unitization

If answer is "no," list the owners and tract descriptions which have actually been consolidated. (Use reverse side of this form if necessary.)

No allowable will be assigned to the well until all interests have been consolidated (by communitization, unitization, forced-pooling, or otherwise) or until a non-standard unit, eliminating such interests, has been approved by the Division.

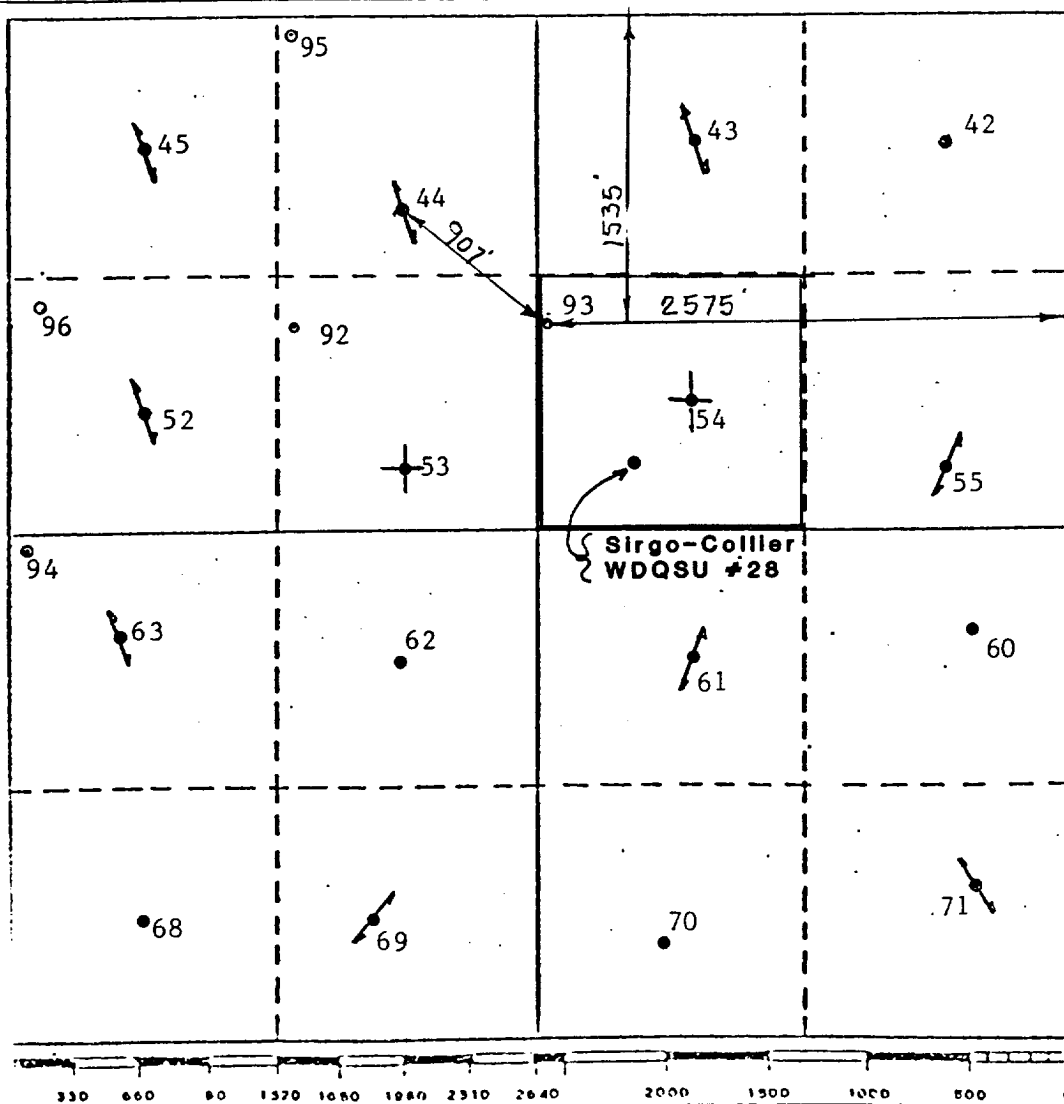

CERTIFICATION

I hereby certify that the information contained herein is true and complete to the best of my knowledge and belief.

B. L. Eiland

Name

B. L. Eiland

Position

Division Surveyor

Company

Texaco Producing Inc.

Date

March 28, 1986

I hereby certify that the well location shown on this plat was plotted from field notes of actual surveys made by me or under my supervision, and that the same is true and correct to the best of my knowledge and belief.

Date Surveyed

March 11, 1986

Registered Professional Engineer and Land Surveyor

B. L. Eiland

B. L. Eiland

Certificate No.

4386

RECEIVED
FEB 11 1988
OCCO
HOBBS OFFICE

DRILLING CONTROL
CONDITION II-B 3000 WP
FOR AIR DRILLING OR
WHERE YATES AIR BLOWS ARE EXPECTED

H₂S TRIM REQUIRED
 YES _____ NO _____

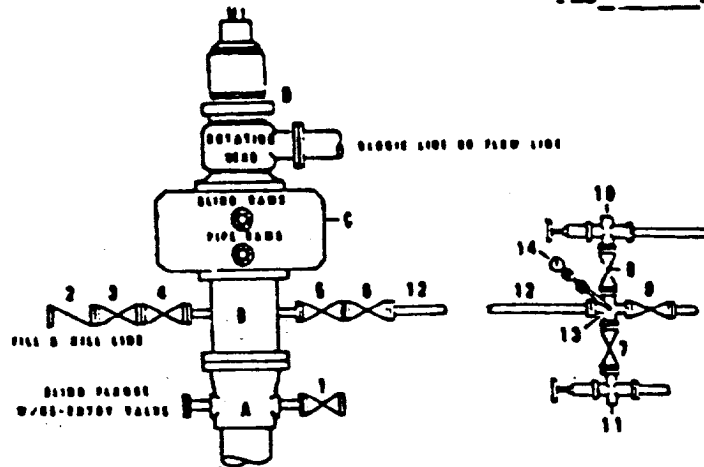

DRILLING CONTROL

MATERIAL LIST - CONDITION II - B
FOR A.A. DRILLING

- | | |
|-----------|---|
| A | Texaco Wellhead |
| B | 3000# W.P. drilling spool with a 2" minimum flanged outlet for kill-line and 3" minimum flanged outlet for choke line |
| C | 3000# W.P. Dual ram type preventer, hydraulic operated with 1" steel, 3000# W.P. control lines (where sub-structure height is adequate, 2-3000# W.P. single ram type preventers may be utilized.) |
| D | Rotating Head and extended Blosie Line. |
| 1,3,4,7,8 | 2" minimum 3000# W.P. flanged full opening steel gate valve, or Halliburton Lo Torc Plug valve. |
| 2 | 2" minimum 3000# W.P. back pressure valve |
| 5,6,9 | 3" minimum 3000# W.P. flanged full opening steel gate valve, or Halliburton Lo Torc Plug valve. |
| 12 | 3" minimum schedule 80, Grade "B", seamless line pipe |
| 13 | 2" minimum x 3" minimum 3000# W.P. flanged cross |
| 10, 11 | 2" minimum 3000# W.P. adjustable choke bodies |
| 14 | Cameron Mud Gauge or equivalent (location optional in choke line.) |



TEXACO, INC.
 MIDLAND DIVISION
 MIDLAND, TEXAS



SCALE	DATE	EST. NO.	DRG. NO.
DRAWN BY			
CHECKED BY			
APPROVED BY			

EXHIBIT C

68-21-6 8204
ELF