

UNITED STATES
DEPARTMENT OF THE INTERIOR
BUREAU OF LAND MANAGEMENT

APPLICATION FOR PERMIT TO DRILL, DEEPEN, OR PLUG BACK

1a. TYPE OF WORK

DRILL ☒

DEEPEN ☐

PLUG BACK ☐

b. TYPE OF WELL

OIL
WELL ☐

GAS
WELL ☐

OTHER Water Injection SINGLE
ZONE ☒

MULTIPLE
ZONE ☐

2. NAME OF OPERATOR

Sirgo Operating, Inc.

3. ADDRESS OF OPERATOR

P.O. Box 3531, Midland, Texas 79702

4. LOCATION OF WELL (Report location clearly and in accordance with any State requirements.)*

At surface

Unit H, 1930 FNL 745 FEL, Sec. 31, T24S, R38E

At proposed prod. zone
same

14. DISTANCE IN MILES AND DIRECTION FROM NEAREST TOWN OR POST OFFICE*

7 miles NE jal

10. DISTANCE FROM PROPOSED*

LOCATION TO NEAREST
PROPERTY OR LEASE LINE, FT.
(Also to nearest drlg. unit line, if any) 4620'
(745')

16. NO. OF ACRES IN LEASE

320

17. NO. OF ACRES ASSIGNED
TO THIS WELL

40

18. DISTANCE FROM PROPOSED LOCATION*

TO NEAREST WELL, DRILLING, COMPLETED,
OR APPLIED FOR, ON THIS LEASE, FT. 660'

19. PROPOSED DEPTH

3900'

20. ROTARY OR CABLE TOOLS

Rotary

21. ELEVATIONS (Show whether DF, RT, GR, etc.)

3134' GR

22. APPROX. DATE WORK WILL START*

June 1989

23. PROPOSED CASING AND CEMENTING PROGRAM

SIZE OF HOLE	SIZE OF CASING	WEIGHT PER FOOT	SETTING DEPTH	QUANTITY OF CEMENT
12-1/4"	8-5/8"	24#	420'	250 sx, circ. to surface
7-7/8"	5-1/2"	15.5 & 17#	3900'	1000 sx, circ. to surface

The Queen zone will be selectively perforated and acidized as needed for optimum water injectivity results.

Subject to
Federal approval
by BLM

APPROVAL SUBJECT TO
FEDERAL REQUIREMENTS AND
SPECIAL STIPULATIONS

ATTACHED

Texaco Producing, Inc. operates the West Dollarhide Drinkard Unit #51 and #91, also located on this quarter quarter section.

IN ABOVE SPACE DESCRIBE PROPOSED PROGRAM: If proposal is to deepen or plug back, give data on present productive zone and proposed new productive zone. If proposal is to drill or deepen directionally, give pertinent data on subsurface locations and measured and true vertical depths. Give blowout preventer program, if any.

24.

SIGNED

Bonnie Ottwater

TITLE

Production Technician

DATE

4-21-89

(This space for Federal or State office use)

PERMIT NO.

APPROVAL DATE

APPROVED BY

TITLE

DATE

5-22-89

CONDITIONS OF APPROVAL, IF ANY:

*See Instructions On Reverse Side

Submitted after cancellation

NEW MEXICO OIL CONSERVATION COMMISSION
WELL LOCATION AND ACREAGE DEDICATION PLAT

Form C-102
Supersedes C-128
Effective 1-1-65

All distances must be from the outer boundaries of the Section.

Operator SIRGO OPERATING, INC.			Lease WDQSU		Well No. 137
Unit Letter H	Section 31	Township 24 South	Range 38 East	County Lea County, N.M.	
Actual Footage Location of Well: 1930 feet from the North line and 745 feet from the East line					
Ground Level Elev. 3134.	Producing Formation Queen	Pool Dollarhide Queen		Dedicated Acreage: 40 Acres	

1. Outline the acreage dedicated to the subject well by colored pencil or hatchure marks on the plat below.
2. If more than one lease is dedicated to the well, outline each and identify the ownership thereof (both as to working interest and royalty).
3. If more than one lease of different ownership is dedicated to the well, have the interests of all owners been consolidated by communitization, unitization, force-pooling, etc?

☒ Yes ☐ No If answer is "yes," type of consolidation Unitization, R-2356

If answer is "no," list the owners and tract descriptions which have actually been consolidated. (Use reverse side of this form if necessary.) _____

No allowable will be assigned to the well until all interests have been consolidated (by communitization, unitization, forced-pooling, or otherwise) or until a non-standard unit, eliminating such interests, has been approved by the Commission.

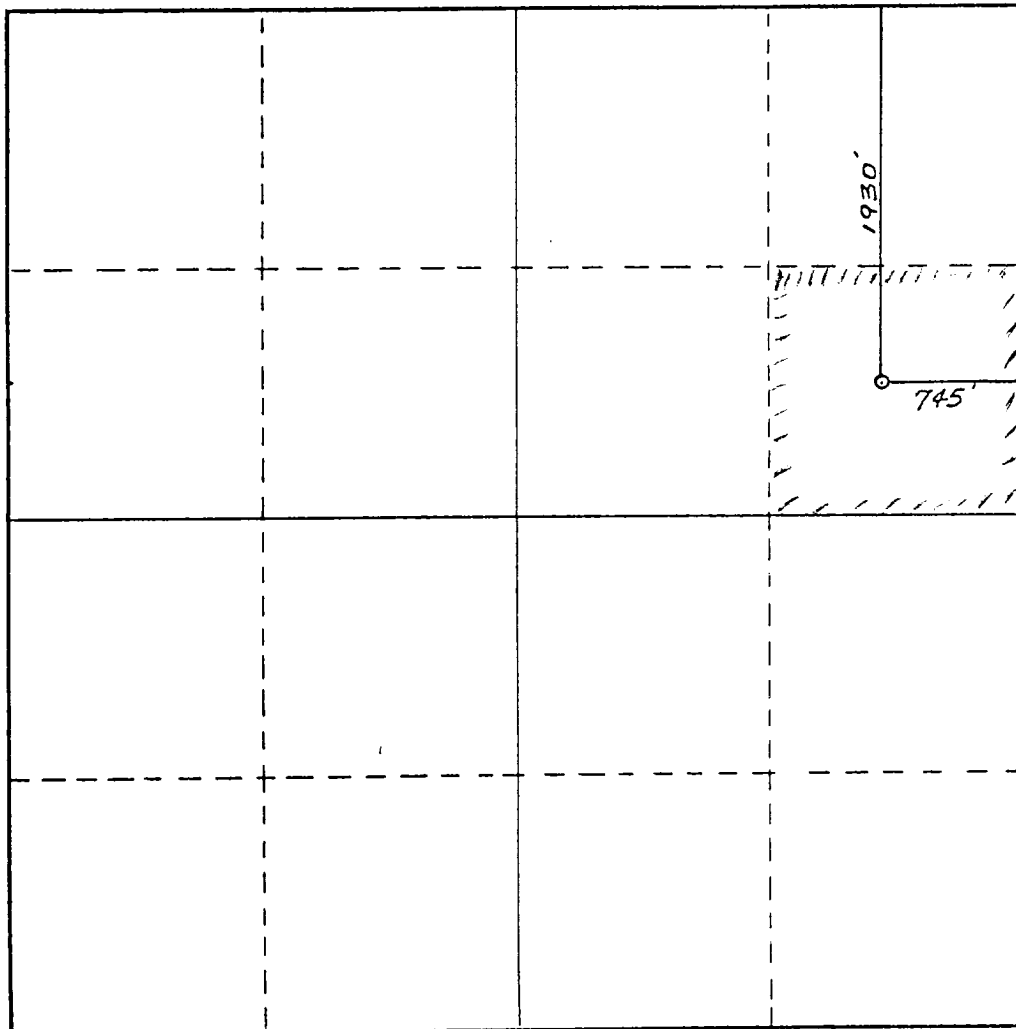

CERTIFICATION

I hereby certify that the information contained herein is true and complete to the best of my knowledge and belief.

Bonnie Atwater

Name

Bonnie Atwater

Position

Production Technician

Company

Sirgo Operating, Inc.

Date

April 20, 1989

I hereby certify that the well location shown on this plat was plotted from field notes of actual surveys made by me or under my supervision and that the same is true and correct to the best of my knowledge and belief.

Date Surveyed

February 23, 1988

Registered Professional Engineer and/or Land Surveyor

Dan R. Reddy

Certificate No.

NM PE&LS NO. 5412

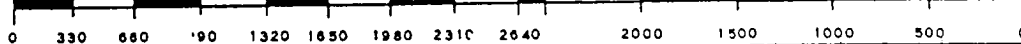

R-38-E

29

30

32

S-24-T

S-25-T

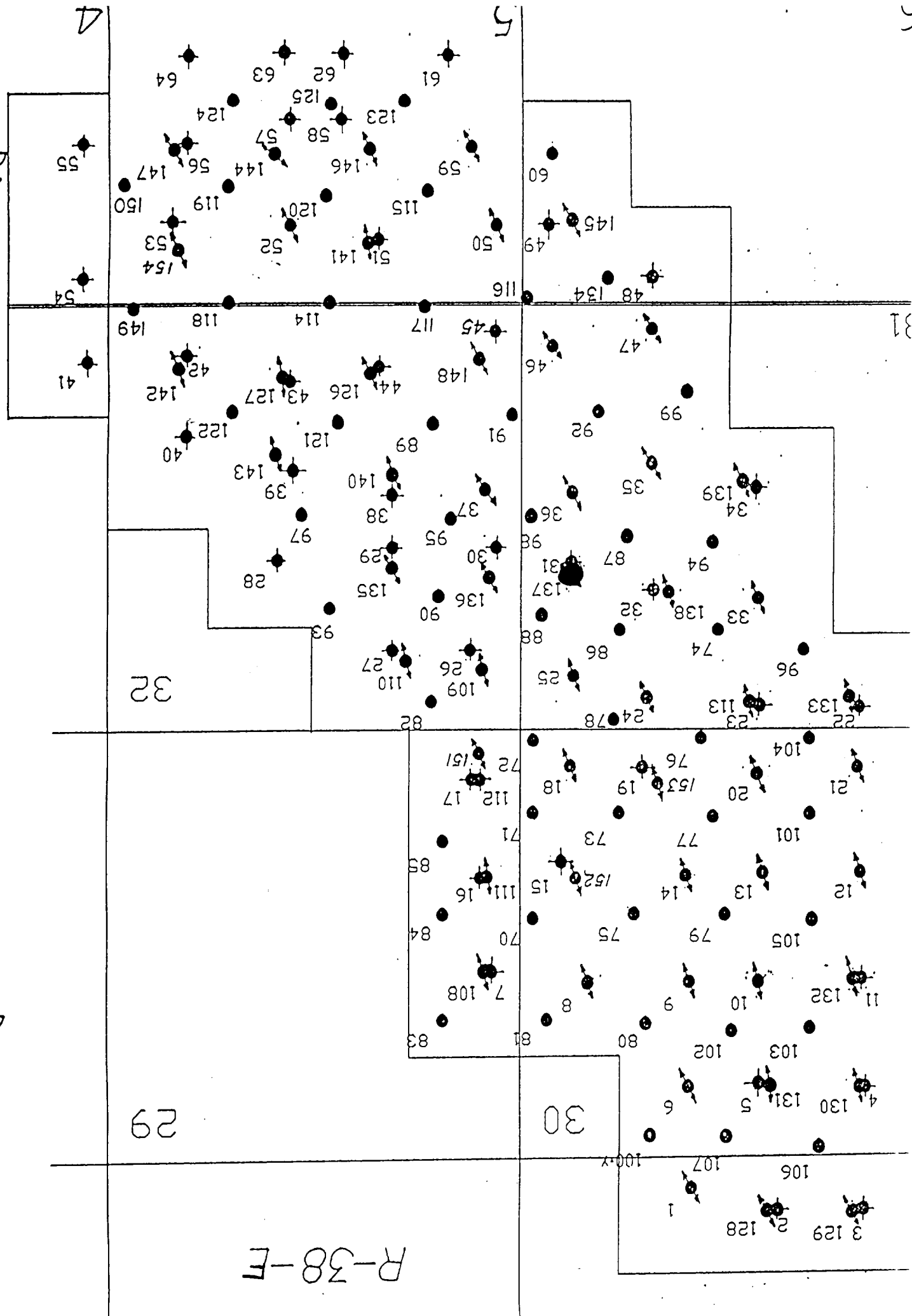

BOP

