

30-025-30299

STATE OF NEW MEXICO
ENERGY AND MINERALS DEPARTMENTOIL CONSERVATION DIVISION
P. O. BOX 2088
SANTA FE, NEW MEXICO 87501Form C-101
Revised 10-1-78

NO. OF COPIES RECEIVED	
DISTRIBUTION	
SANTA FE	
FILE	
U.S.G.S.	
LAND OFFICE	
OPERATOR	

5A. Indicate Type of Lease	
STATE <input checked="" type="checkbox"/>	FEED <input type="checkbox"/>
5. State Oil & Gas Lease No.	
B-9311	

APPLICATION FOR PERMIT TO DRILL, DEEPEN, OR PLUG BACK

1a. Type of Work		7. Unit Agreement Name	
b. Type of Well		West Dollarhide Queen Sand Unit	
DRILL <input checked="" type="checkbox"/> DEEPEN <input type="checkbox"/> PLUG BACK <input type="checkbox"/>		8. Farm or Lease Name	
OIL WELL <input type="checkbox"/> GAS WELL <input type="checkbox"/> OTHER Water injection well <input checked="" type="checkbox"/> SINGLE ZONE <input checked="" type="checkbox"/> MULTIPLE ZONE <input type="checkbox"/>		9. Well No.	
2. Name of Operator		142	
3. Address of Operator		10. Field and Pool, or Wildcat	
P. O. Box 3531, Midland, Texas 79702		Dollarhide Queen	
4. Location of Well		17. County	
UNIT LETTER <u>P</u> LOCATED <u>800</u> FEET FROM THE <u>South</u> LINE		Lea	
AND <u>900</u> FEET FROM THE <u>East</u> LINE OF SEC. <u>32</u> TWP. <u>24S</u> RGE. <u>38E</u> NMDM			
19. Proposed Depth		19A. Formation	
3900'		Queen	
20. Rotary or C.T.		Rotary	
21. Elevations (show whether Dr. RT, etc.)		22. Approx. Date Work will start	
3170' GR		July 1988	
21A. Kind & Status Plug. Bond		21B. Drilling Contractor	
Cash Statewide			

23.

PROPOSED CASING AND CEMENT PROGRAM

SIZE OF HOLE	SIZE OF CASING	WEIGHT PER FOOT	SETTING DEPTH	SACKS OF CEMENT	EST. TOP
12-1/4"	8-5/8"	24#	420'	250 sx	Surface
7-7/8"	5-1/2"	15.5 & 17#	3900'	1000 sx	Surface

The Queen zone will be selectively perforated and acidized as needed for optimum water injectivity rates.

Chevron U.S.A., Inc. operates the West Dollarhide Devonian Unit #109, and Texaco Producing, Inc. operates the West Dollarhide Drinkard Unit #71, also located in this quarter quarter section.

IN ABOVE SPACE DESCRIBE PROPOSED PROGRAM; IF PROPOSAL IS TO DEEPEN OR PLUG BACK, GIVE DATA ON PRESENT PRODUCTIVE ZONE AND PROPOSED NEW PRODUCTIVE ZONE. GIVE BLOWOUT PREVENTER PROGRAM, IF ANY.

hereby certify that the information above is true and complete to the best of my knowledge and belief.

Signed Amy L. Whitley Title Agent Date March 9, 1988

(This space for State Use)

ORIGINAL SIGNED BY JERRY SEXTON

APPROVED BY DISTRICT 1 SUPERVISOR TITLE DATE APR 13 1988

CONDITIONS OF APPROVAL, IF ANY:

WEX-570

Permit Expires 6 Months From Approval
Date Unless Drilling Underway.

NEW MEXICO OIL CONSERVATION COMMISSION
WELL LOCATION AND ACREAGE DEDICATION PLAT

Form C-102
Supersedes C-128
Effective 1-1-65

All distances must be from the outer boundaries of the Section.

Operator SIRGO-COLLIER, INC.			Lease WDQSU (West Dollarhide Queen Sand Unit)		Well No. 142
Unit Letter P	Section 32	Township 24 South	Range 38 East	County Lea County, N.M.	
Actual Footage Location of Well: 800 feet from the South line and 900 feet from the East line					
Ground Level Elev. 3170.	Producing Formation Queen		Pool Dollarhide Queen		Dedicated Acreage: 40 Acres

1. Outline the acreage dedicated to the subject well by colored pencil or hatchure marks on the plat below.
2. If more than one lease is dedicated to the well, outline each and identify the ownership thereof (both as to working interest and royalty).
3. If more than one lease of different ownership is dedicated to the well, have the interests of all owners been consolidated by communitization, unitization, force-pooling, etc?

☒ Yes ☐ No If answer is "yes," type of consolidation Unitization, R-2356

If answer is "no," list the owners and tract descriptions which have actually been consolidated. (Use reverse side of this form if necessary.) _____

No allowable will be assigned to the well until all interests have been consolidated (by communitization, unitization, forced-pooling, or otherwise) or until a non-standard unit, eliminating such interests, has been approved by the Commission.

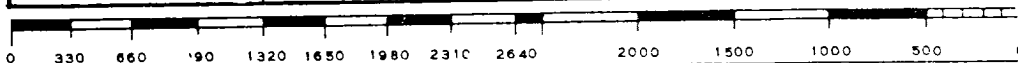
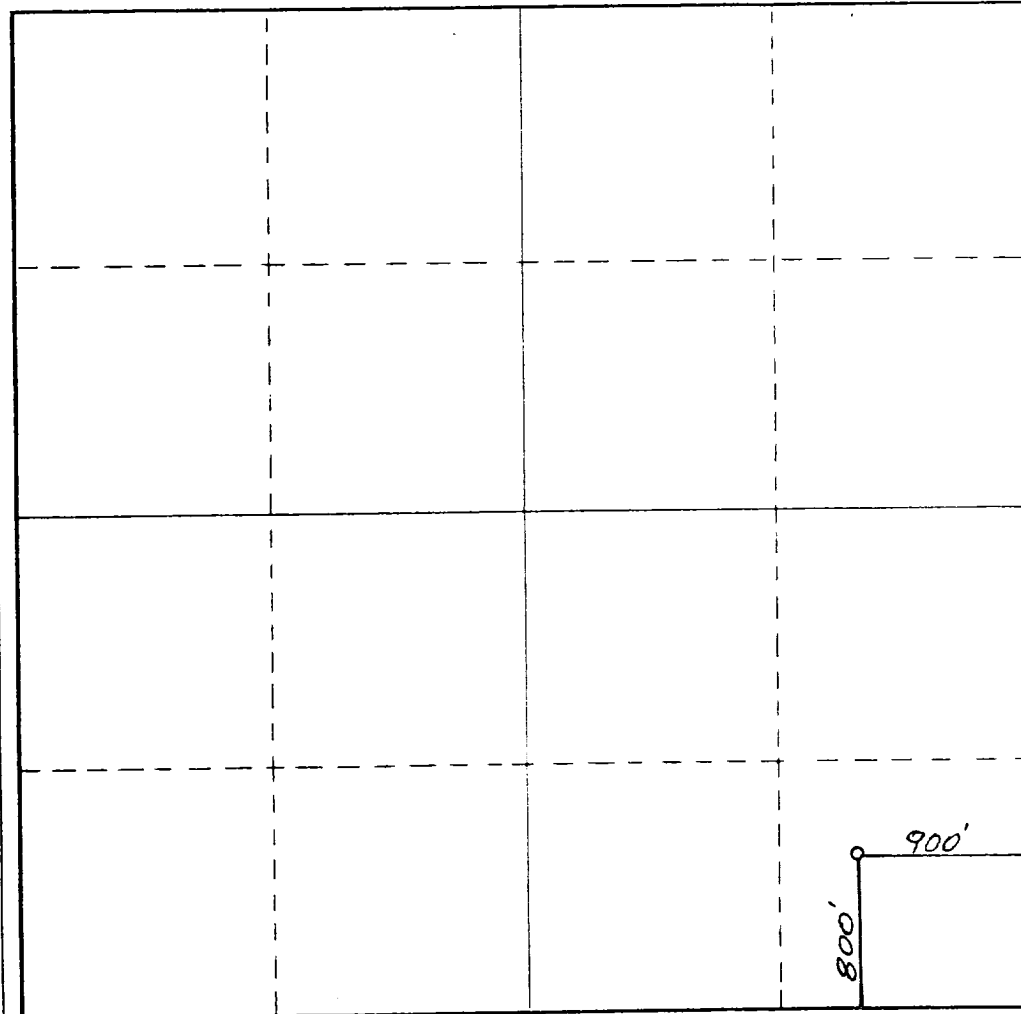

CERTIFICATION

I hereby certify that the information contained herein is true and complete to the best of my knowledge and belief.

Amy L. Whitley
Name

Amy L. Whitley
Position

Agent

Company
Sirgo-Collier, Inc.

Date
March 9, 1988

I hereby certify that the well location shown on this plat was plotted from field notes of actual surveys made by me or under my supervision, and that the same is true and correct to the best of my knowledge and belief.

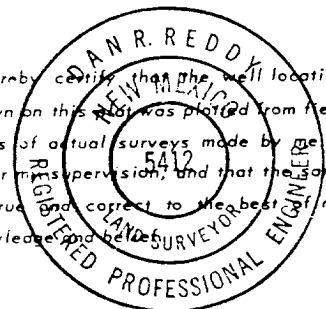

Date Surveyed
February 19, 1988

Registered Professional Engineer and/or Land Surveyor

Dan R. Reddy
Certificate No.

NM PE&LS NO. 5412

BOP

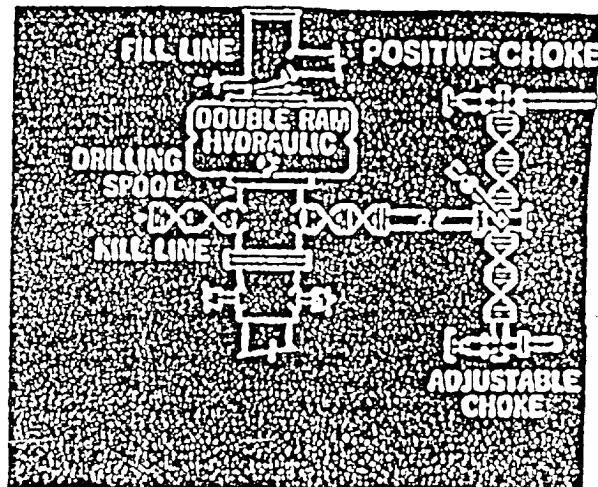

RECEIVED
MAR 10 1988
OCD
HOBBS OFFICE

REC-3-14-90
113