



STATE OF NEW MEXICO
ENERGY, MINERALS AND NATURAL RESOURCES DEPARTMENT

OIL CONSERVATION DIVISION
HOBBS DISTRICT OFFICE

3/11/98

POST OFFICE BOX 1980
HOBBS, NEW MEXICO 88241-1980
(505) 393-6161

GOVERNOR

OIL CONSERVATION DIVISION
P. O. BOX 2088
SANTA FE, NEW MEXICO 87501

DHC-1774

RE: Proposed:

MC	
DHC	X
NSL	
NSP	
SWD	
WFX	
PMX	

Gentlemen:

I have examined the application for the:

Burlington Res O&G Co Pitchfork 4 Fed #2-K-4-25s-34e
Operator Lease & Well No. Unit S-T-R

and my recommendations are as follows:

None

Yours very truly,

Chris Williams

Chris Williams
Supervisor, District 1

/ed

BURLINGTON RESOURCES

MID-CONTINENT DIVISION

January 14, 1998

Mr. Chris Williams, District Supervisor
State of New Mexico
Energy, Minerals and Natural Resources Dept.
Oil Conservation Division
P. O. Box 1980
Hobbs, New Mexico 88241

RE: Request approval of proposed 320 Acre Horizontal
Project Area with producing window for this proposed
sidetrack directional drainhole.

Burlington Resources Oil & Gas Company (OGRID ID# 26485)
Pitchfork "4" Federal #2, (API# 30-025-30331), NM16139 Gas Well
(Proposed Sidetrack/Directional from existing vertical well)
Undesignated Fairview Mills Wolfcamp Gas Field &
Wildcat Strawn Pool
K, 1830' FSL & 1980' FWL
Sec. 4, T25S, R34E
Lea Co., NM

Dear Mr. Williams:

Enclosed are corrected C-102 plats amending the field names on this proposed sidetrack directional well. At the request of Mr. Michael Stogner with the OCD in Santa Fe these fields are being corrected from the Pitchfork Ranch Wolfcamp and Pitchfork Ranch Strawn Fields to the Undesignated Fairview Mills Wolfcamp Gas Field and Wildcat Strawn Pool.

This letter will serve as the approval, if signed by you, that all the requirements of Rule 111 have been met as submitted on the attached C-102 plat for a 320 Acre Horizontal Project Area for the proposed sidetrack direction well. By signing below, you as the authorized officer of the Oil Conservation Division, Hobbs District, hereby approves this said horizontal project area.

Application for an unorthodox location was filed on 12-1-97 with the OCD/Santa Fe Office, Mr. Michael Stogner. Application to downhole commingle was filed 12-1-97 with the OCD/Santa Fe Office, Mr. David Catanach.

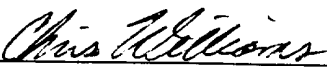
Chris Williams, District Supervisor
Oil Conservation Division, Hobbs Dist.

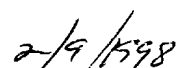
Date:

Sincerely,

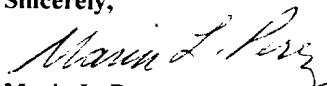
Maria L. Perez
Regulatory Representative/Drlg. Dept.
A/C 915-688-6906

(OCD COPY)

UNITED STATES
DEPARTMENT OF THE INTERIOR
BUREAU OF LAND MANAGEMENT
N.M. Oil Con
P.O. Box 1980
Hobbs, NM 88241

FORM APPROVED
Budget Bureau No. 1004-0135
Expires July 31, 1996

SUNDRY NOTICES AND REPORTS ON WELLS
Do not use this form for proposals to drill or to re-enter an abandoned well. Use Form 3160-3 (APD) for such proposals.

SUBMIT IN TRIPLICATE - Other Instructions on reverse side

1. Type of Well <input type="checkbox"/> Oil Well <input checked="" type="checkbox"/> Gas Well <input type="checkbox"/> Other		5. Lease Serial No. NM 16139
2. Name of Operator BURLINGTON RESOURCES OIL AND GAS COMPANY		6. If Indian, Allottee or Tribe Name
3a. Address P. O. Box 51810, Midland, TX 79710-1810	3b. Phone No. (include area code) 915-688-6906	7. If Unit or CA/Agreement, Name and/or No.
4. Location of Well (Footage, Sec., T., R., M., or Survey Description) K, 1830' FSL & 1980' FWL, SEC. 4, T25S, R34E		8. Well Name and No. Pitchfork "4" Federal #2
		9. API Well No. 30-025-30331
		10. Field and Pool, or Exploratory Area Undesignated Fairview Mills Wolfcamp Gas & Wildcat Strawn Gas
		11. County or Parish, State Lea Co., NM

12. CHECK APPROPRIATE BOX(ES) TO INDICATE NATURE OF NOTICE, REPORT, OR OTHER DATA

TYPE OF SUBMISSION	TYPE OF ACTION			
<input checked="" type="checkbox"/> Notice of Intent	<input type="checkbox"/> Acidize	<input type="checkbox"/> Deepen	<input type="checkbox"/> Production (Start/Resume)	<input type="checkbox"/> Water Shut-Off
<input type="checkbox"/> Subsequent Report	<input type="checkbox"/> Alter Casing	<input type="checkbox"/> Fracture Treat	<input type="checkbox"/> Reclamation	<input type="checkbox"/> Well Integrity
<input type="checkbox"/> Final Abandonment Notice	<input type="checkbox"/> Casing Repair	<input type="checkbox"/> New Construction	<input type="checkbox"/> Recomplete	<input checked="" type="checkbox"/> Other
	<input type="checkbox"/> Change Plans	<input type="checkbox"/> Plug and Abandon	<input type="checkbox"/> Temporarily Abandon	Sidetrack/Directional
	<input type="checkbox"/> Convert to Injection	<input type="checkbox"/> Plug Back	<input type="checkbox"/> Water Disposal	& Downhole Commingle
				amend field names

13. Described Proposed or Completed Operation (clearly state all pertinent details, including estimated starting date of any proposed work and approximate duration thereof. If the proposal is to deepen directionally or recompletes horizontally, give subsurface locations and measured and true vertical depths of all pertinent markers and zones. Attach the Bond under which the work will be performed or provide the Bond No. on file with BLM/BIA. Required subsequent reports shall be filed within 30 days following completion of the involved operations. If the operation results in a multiple completion or recompletion in a new interval, a Form 3160-4 shall be filed once testing has been completed. Final Abandonment Notices shall be filed only after all requirements, including reclamation, have been completed, and the operator has determined that the site is ready for final inspection.)

This sundry is to correct the field names on Notice of Intent Sundry previously submitted dated 1-5-98 to sidetrack a directional hole from the existing vertical well. As per Mike Stogner with the OCD in Santa Fe, the field names have been changed to the Undesignated Fairview Mills Wolfcamp Gas Field and a Wildcat Strawn Gas Pool. We will be setting a cmt retainer @12,850' & squeezing perfs 13,956'-13,964' and 4-1/2" Liner with 100 sxs H cmt on vertical section of hole prior to sidetracking.

Also correct field names on Notice of Intent Sundry previously submitted dated 12-11-97 to downhole commingle.

The fields previously submitted were the Pitchfork Ranch Wolfcamp and Pitchfork Ranch Strawn, which are incorrect.

All of the attachments previously submitted with these sundries remain the same.

**SUBJECT TO
LIKE APPROVAL
BY STATE**

14. I hereby certify that the foregoing is true and correct.

Name (Printed/Typed) Maria L. Perez	Title Regulatory Representative
Signature <i>Maria L. Perez</i>	Date 1-13-98
Approved by (ORIG. SGD.) LES BABYAK	Title PETROLEUM ENGINEER Date FEB 05 1998
Conditions of approval, if any, are attached. Approval of this notice does not warrant or certify that the applicant holds legal or equitable title to those rights in the subject lease which would entitle the applicant to conduct operations thereon.	Office

Title 18 U.S.C. Section 1001, makes it a crime for any person knowingly and willfully to make to any department or agency of the United States any false, fictitious or fraudulent statement or representations as to any matter within its jurisdiction.

(Instructions on reverse)

40, Hobbs, NM 88241-1980
District II
11 S. 1st Street, Artesia, NM 88210-2834
District III
1000 Rio Brazos Rd., Aztec, NM 87410
District IV
2040 South Pacheco, Santa Fe, NM 87505

OIL CONSERVATION DIVISION
2040 South Pacheco
Santa Fe, NM 87505

Instructions on back
Submit to Appropriate District Office
State Lease - 4 Copies
Fee Lease - 3 Copies

☐ AMENDED REPORT

WELL LOCATION AND ACREAGE DEDICATION PLAT

¹ API Number 30-025-03331	² Pool Code NEW	³ Pool Name WILDCAT STRAWN GAS
⁴ Property Code 014332	⁵ Property Name PITCHFORK "4" FEDERAL	⁶ Well Number 2
⁷ OGRID No. 26485	⁸ Operator Name BURLINGTON RESOURCES OIL & GAS COMPANY	⁹ Elevation 3361'

¹⁰ Surface Location									
UL or lot no. K	Section 4	Township 25S	Range 34E	Lot. Idn	Feet from the 1830'	North/South Line SOUTH	Feet from the 1980'	East/West line WEST	County Lea

¹¹ Bottom Hole Location If Different From Surface

UL or lot no. K	Section 4	Township 25S	Range 34E	Lot. Idn	Feet from the 2206'	North/South Line SOUTH	Feet from the 2052'	East/West line WEST	County Lea
¹² Dedicated Acres 320	¹³ Joint or Infill	¹⁴ Consolidation Code	¹⁵ Order No.						

NO ALLOWABLE WILL BE ASSIGNED TO THIS COMPLETION UNTIL ALL INTERESTS HAVE BEEN CONSOLIDATED
OR A NON-STANDARD UNIT HAS BEEN APPROVED BY THE DIVISION

Robert E. Landreth Oil & Gas Exploration

4

--- 320 ACRE
HORIZONTAL PROJECT AREA BOUNDARY
W/PRODUCING WINDOW

MINIMUM SETBACK DISTANCE BY FIELD RULES
(660' Side Boundary & 1650' End Boundary),
SWR 111

SL: SURFACE LOCATION
PKOP: PROPOSED KICKOFF POINT
PTL: PROPOSED TERMINUS LOCATION

¹⁷ OPERATOR CERTIFICATION

I hereby certify that the information contained herein is true and complete to the best of my knowledge and belief.

Signature

MARIA L. PEREZ

Printed Name

REGULATORY REPRESENTATIVE

Title

1/13/98

Date

¹⁸ SURVEYOR CERTIFICATION

I hereby certify that the well location shown on this plat was plotted from field notes of actual surveys made by me or under my supervision, and that the same is true and correct to the best of my belief.

Date of Survey

Signature and Seal of Professional Surveyor:

Certificate Number

Burlington Resources Oil & Gas Co.

2052'

1980'

2052'

1650'

Setback

PTL

#2

PKOP

PROPOSED
UNORTHODOX
BOTTOM HOLE
LOCATION

660'

Setback

489'

134'

1830'

1717'

2206'

660'

Setback

1650'

Setback

200, Hobbs, NM 88241-1980
District II
111 S. 1st Street, Artesia, NM 88210-2834
District III
1000 Rio Brazos Rd., Aztec, NM 87410
District IV
2040 South Pacheco, Santa Fe, NM 87505

OIL CONSERVATION DIVISION
2040 South Pacheco
Santa Fe, NM 87505

☐ AMENDED REPORT

WELL LOCATION AND ACREAGE DEDICATION PLAT

¹ API Number 30-025-03331		² Pool Code 76560	³ Pool Name UNDESIGNATED FAIRVIEW MILLS WOLFCAMP GAS
⁴ Property Code 014332	⁵ Property Name PITCHFORK "4" FEDERAL		⁶ Well Number 2
⁷ OGRID No. 26485	⁸ Operator Name BURLINGTON RESOURCES OIL & GAS COMPANY		⁹ Elevation 3361'

¹⁰ Surface Location									
UL or lot no.	Section	Township	Range	Lot. Idn	Feet from the	North/South Line	Feet from the	East/West line	County
K	4	25S	34E		1830'	SOUTH	1980'	WEST	Lea

¹¹ Bottom Hole Location If Different From Surface									
UL or lot no.	Section	Township	Range	Lot. Idn	Feet from the	North/South Line	Feet from the	East/West line	County
K	4	25S	34E		2206'	SOUTH	2052'	WEST	Lea

¹² Dedicated Acres 320	¹³ Joint or Infill	¹⁴ Consolidation Code	¹⁵ Order No.
--------------------------------------	-------------------------------	----------------------------------	-------------------------

NO ALLOWABLE WILL BE ASSIGNED TO THIS COMPLETION UNTIL ALL INTERESTS HAVE BEEN CONSOLIDATED
OR A NON-STANDARD UNIT HAS BEEN APPROVED BY THE DIVISION

Robert E. Landreth Oil & Gas Exploration

320 ACRE
HORIZONTAL PROJECT AREA BOUNDARY
W/PRODUCING WINDOW

MINIMUM SETBACK DISTANCE BY FIELD RULES
(660' Side Boundary & 1650' End Boundary),
SWR 111

SL: SURFACE LOCATION
PKOP: PROPOSED KICKOFF POINT
PTL: PROPOSED TERMINUS LOCATION

Burlington Resources Oil & Gas Co.

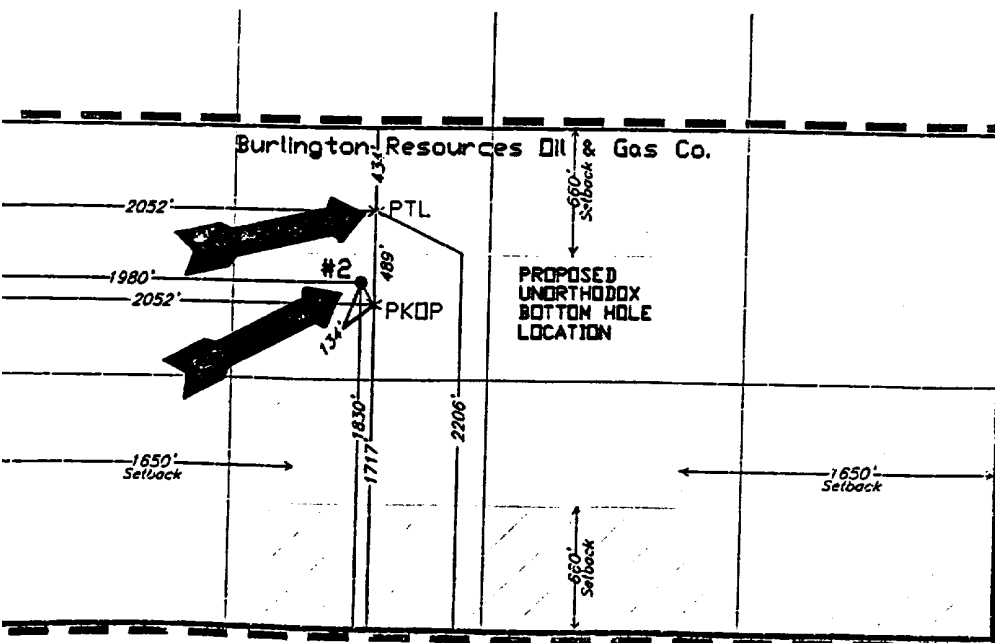

¹⁷ OPERATOR CERTIFICATION

I hereby certify that the information contained herein is true and complete to the best of my knowledge and belief.

Signature

MARIA L. PEREZ

Printed Name

REGULATORY REPRESENTATIVE

Title

1/13/98

Date

¹⁸ SURVEYOR CERTIFICATION

I hereby certify that the well location shown on this plat was plotted from field notes of actual surveys made by me or under my supervision, and that the same is true and correct to the best of my belief.

Date of Survey

Signature and Seal of Professional Surveyor:

Certificate Number

DISTRICT II

811 S. First St., Artesia, NM 88210-2835

DISTRICT III

1000 Rio Brazos Rd, Aztec, NM 87410-1693

OIL CONSERVATION DIVISION

2040 S Pacheco
Santa Fe, New Mexico 875054-6429

APPROVAL PROCESS:

☒ Administrative ☐ Hearing

EXISTING WELLBORE

☒ YES ☐ NO

APPLICATION FOR DOWNHOLE COMMINGLING

Operator **BURLINGTON RESOURCES OIL & GAS COMPANY**

P.O. BOX 51810 MIDLAND, TX 79710-1810

Lease **PITCHFORK "4" FEDERAL**

2

Well No.

K,

SEC. 4,

T25S,

R34E

LEA

Unit Ltr. - Sec - Twp - Rge

County

OGRID NO. **26485**

Property Code **014332**

API NO. **30-025-30331**

Spacing Unit Lease Types: (check 1 or more)
Federal ☒ State ☐ (and/or) Fee ☐

The following facts are submitted in support of downhole commingling:	Upper Zone	Intermediate Zone	Lower Zone
1. Pool Name and Pool Code	UNDESIGNATED FAIRVIEW MILLS WOLFCAMP GAS		WILDCAT STRAWN NEW
2. Top and Bottom of Pay Section (Perforations)	76560		13,675' - 13,806
3. Type of production (Oil or Gas)	13,470' - 13,525'		GAS
4. Method of Production (Flowing or Artificial Lift)	GAS		GAS
5. Bottomhole Pressure	FLOWING		FLOWING
Oil Zones - Artificial Lift: Estimated Current	a. (Current)	a.	a.
Gas & Oil - Flowing: Measured Current	b. (Original)	b.	b.
All Gas Zones: Estimated Or Measured Original	EST. 7035 PSI		EST. 9350 PSI
6. Oil Gravity (°API) or Gas BTU Content)	EST. 1083		EST. 1059
7. Producing or Shut-In?	TO BE COMPLETED		TO BE COMPLETED
Production Marginal? (yes or no)			
<ul style="list-style-type: none"> If Shut-In, give date and oil/gas/water rates of last production Note: For new zones with no production history, applicant shall be required to attach production estimates and supporting data If Producing, give date and oil/gas/water rates of recent test (within 60 days) 	Date: ATTACHMENTS Rates: PREVIOUSLY SUBMITTED	Date: ATTACHMENTS Rates: PREVIOUSLY SUBMITTED	
8. Fixed Percentage Allocation Formula - % for each zone	Oil: 0 % Gas: 65 %	Oil: % Gas: %	Oil: 0 % Gas: 35 %

9. If allocation formula is based upon something other than current or past production, or is based upon some other method, submit attachments with supporting data and/or explaining method and providing rate projections or other required data.

10. Are all working, overriding, and royalty interests identical in all commingled zones?
If not, have all working, overriding, and royalty interests been notified by certified mail?
Have all offset operators been given written notice of the proposed downhole commingling?

☒ Yes ☐ No
☒ Yes ☐ No
☒ Yes ☐ No

11. Will cross-flow occur? Yes ☒ No ☐ If yes, are fluids compatible, will the formations not be damaged, will any cross-flowed production be recovered, and will the allocation formula be reliable. ☐ Yes ☐ No (If No, attach explanation)

12. Are all produced fluids from all commingled zones compatible with each other? ☒ Yes ☐ No

13. Will the value of production be decreased by commingling? ☐ Yes ☒ No (If Yes, attach explanation)

14. If this well in on, or communitized with, state or federal lands, either the Commissioner of Public Lands or the United States Bureau of Land Management has been notified in writing of this application. ☒ Yes ☐ No

15. NMOCD Reference Cases for Rule 303(D) Exceptions:

ORDER NO(S) _____

16. ATTACHMENTS:

- * C-102 for each zone to be commingled showing its spacing unit and acreage dedication.
- * Production curve for each zone for at least one year. (If not available, attach explanation.)
- * For zones with no production history, estimated production rates and supporting data.
- * Data to support allocation method or formula.
- * Notification list of all offset operators.
- * Notification list of working, overriding, and royalty interests for uncommon interest cases.
- * Any additional statements, data, or documents required to support commingling.

I hereby certify that the information above is true and complete to the best of my knowledge and belief.

SIGNATURE Maria L. Perez

TITLE REGULATORY REP.

DATE 1-13-98

TYPE OR PRINT NAME MARIA L. PEREZ

TELEPHONE NO. (915) 688-6906