

UNITED STATES  
DEPARTMENT OF THE INTERIOR  
BUREAU OF LAND MANAGEMENT

APPLICATION FOR PERMIT TO DRILL, DEEPEN, OR PLUG BACK

1a. TYPE OF WORK

DRILL ☒

DEEPEN ☐

PLUG BACK ☐

b. TYPE OF WELL

OIL  
WELL ☐

GAS  
WELL ☐

OTHER Water Injection SINGLE ZONE ☒

MULTIPLE ZONE ☐

2. NAME OF OPERATOR

Sirgo Operating, Inc.

3. ADDRESS OF OPERATOR

P.O. Box 3531, Midland, Texas 79702

4. LOCATION OF WELL (Report location clearly and in accordance with any State requirements.)\*

At surface

Unit D, 400' FNL 1120' FWL

At proposed prod. zone

14. DISTANCE IN MILES AND DIRECTION FROM NEAREST TOWN OR POST OFFICE\*

7 miles NE Jal, New Mexico

10. DISTANCE FROM PROPOSED\*

LOCATION TO NEAREST  
PROPERTY OR LEASE LINE, FT.  
(Also to nearest drlg. unit line, if any)

900'

(200')

16. NO. OF ACRES IN LEASE

320

17. NO. OF ACRES ASSIGNED  
TO THIS WELL

40

18. DISTANCE FROM PROPOSED LOCATION\*  
TO NEAREST WELL, DRILLING, COMPLETED,  
OR APPLIED FOR, ON THIS LEASE, FT.

660'

19. PROPOSED DEPTH

3900'

20. ROTARY OR CABLE TOOLS

Rotary

21. ELEVATIONS (Show whether DF, RT, GR, etc.)

3128' GR

22. APPROX. DATE WORK WILL START\*

January 1990

23. PROPOSED CASING AND CEMENTING PROGRAM

SIZE OF HOLE	SIZE OF CASING	WEIGHT PER FOOT	SETTING DEPTH	QUANTITY OF CEMENT
12-1/4"	8-5/8"	24#	420'	250 sx, circ to surface
7-7/8"	5-1/2"	15.5 & 17#	3900'	1000 sx, circ to surface

The Queen zone will be selectively perforated and acidized for optimum water injectivity results.

APPROVAL SUBJECT TO  
GENERAL REQUIREMENTS AND  
SPECIAL STIPULATIONS  
ATTACHED

Estacado, Inc. operates the Elliott "31" Federal #6, also located on this quarter quarter section.

IN ABOVE SPACE DESCRIBE PROPOSED PROGRAM: If proposal is to deepen or plug back, give data on present productive zone and proposed new productive zone. If proposal is to drill or deepen directionally, give pertinent data on subsurface locations and measured and true vertical depths. Give blowout preventer program, if any.

24.

SIGNED

Bonnie Atwater

TITLE

Production Technician

DATE

1-8-90

(This space for Federal or State office use)

PERMIT NO.

APPROVAL DATE

AREA MANAGER

CARLSBAD RESOURCE

APPROVED BY

TITLE

DATE

2-2-90

CONDITIONS OF APPROVAL, IF ANY:

Resubmitted after cancellation

\*See Instructions On Reverse Side

RECEIVED

FEB 5 1990

OCD  
HOBBS OFFICE

NEW MEXICO OIL CONSERVATION COMMISSION  
WELL LOCATION AND ACREAGE DEDICATION PLAT

Form C-102  
Supersedes C-128  
Effective 1-1-65

All distances must be from the outer boundaries of the Section.

Operator <b>SIRGO OPERATING, INC.</b>			Lease <b>WEST DOLLARHIDE QUEEN SAND UNIT</b>		Well No. <b>133</b>
Unit Letter <b>D</b>	Section <b>31</b>	Township <b>24 South</b>	Range <b>38 East</b>	County <b>Lea County, N.M.</b>	
Actual Footage Location of Well: <b>1120</b> feet from the <b>West</b> line and <b>400</b> feet from the <b>North</b> line					
Ground Level Elev. <b>3125.</b>	Producing Formation <b>Queen</b>		Pool <b>Dollarhide Queen</b>		Dedicated Acreage: <b>40</b> Acres

1. Outline the acreage dedicated to the subject well by colored pencil or hatchure marks on the plat below.
2. If more than one lease is dedicated to the well, outline each and identify the ownership thereof (both as to working interest and royalty).
3. If more than one lease of different ownership is dedicated to the well, have the interests of all owners been consolidated by communitization, unitization, force-pooling, etc?

☒ Yes ☐ No If answer is "yes," type of consolidation Unitization, R-2356

If answer is "no," list the owners and tract descriptions which have actually been consolidated. (Use reverse side of this form if necessary.) \_\_\_\_\_

No allowable will be assigned to the well until all interests have been consolidated (by communitization, unitization, forced-pooling, or otherwise) or until a non-standard unit, eliminating such interests, has been approved by the Commission.

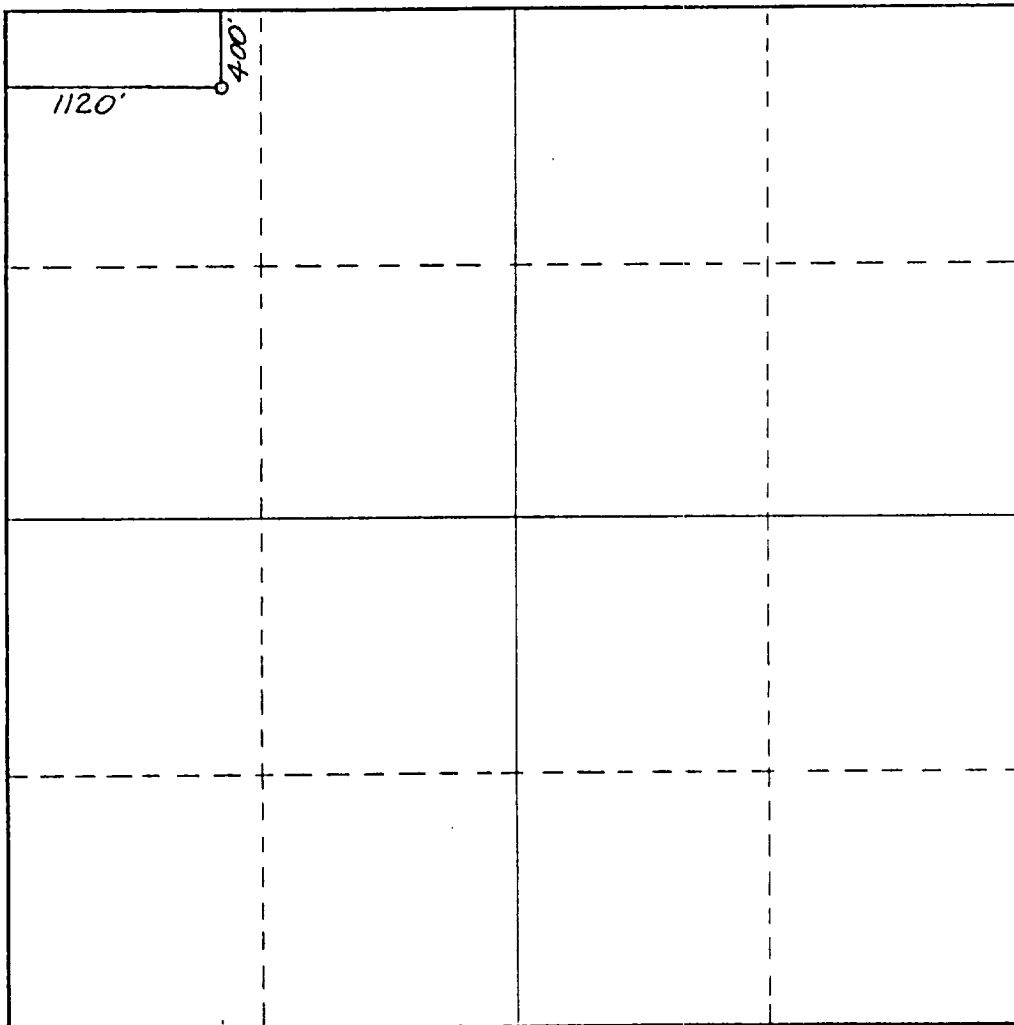

CERTIFICATION

I hereby certify that the information contained herein is true and complete to the best of my knowledge and belief.

*Bonnie Atwater*

Name  
Production Technician

Position  
Sirgo Operating, Inc.

Company  
1-8-90

Date

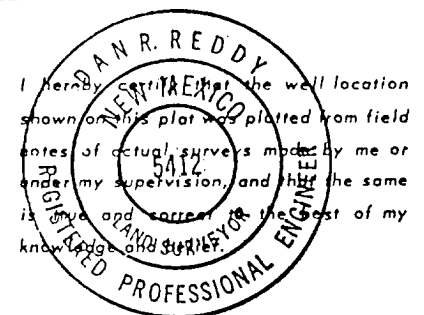

Date Surveyed  
January 13, 1988

Registered Professional Engineer  
and/or Land Surveyor

*Dan R. Reddy*  
Certificate No.

NM PE&LS NO. 5412

# BOP

