

OIL CONSERVATION DIVISION

P.O. Box 2088
Santa Fe, New Mexico 87504-2088

DISTRICT I
P.O. Box 1980, Hobbs, NM 88240

DISTRICT II
P.O. Drawer DD, Artesia, NM 88210

DISTRICT III
1000 Rio Brazos Rd., Artesia, NM 87410

WELL LOCATION AND ACREAGE DEDICATION PLAT

All distances must be from the outer boundaries of the Section.

Operator Exxon Corporation			Lease FLAGLER FEDERAL		Well No. 1
Unit Letter C	Section 8	Township 25S	Range 33E	NMPM	County LEA
Actual Footage Location of Well: 660 feet from the NORTH line and 1980 feet from the WEST line.					
Ground level Elev. 3454'	Producing Formation MORROW		Pool WILDCAT		Dedicated Acreage: 320 Acres

- Outline the acreage dedicated to the subject well by colored pencil or hatchure marks on the plat below.
- If more than one lease is dedicated to the well, outline each and identify the ownership thereof (both as to working interest and royalty).
- If more than one lease of different ownership is dedicated to the well, have the interest of all owners been consolidated by communitization, unitization, force-pooling, etc.?

☐ Yes

☒ No

If answer is "yes", type of consolidation

If answer is "no", list the owners and tract descriptions which have actually been consolidated. (Use reverse side of this form if necessary.) none

No allowable will be assigned to the well until all interests have been consolidated (by communitization, unitization, force-pooling, or otherwise) or until a non-standard unit, eliminating such interest, has been approved by the Division.

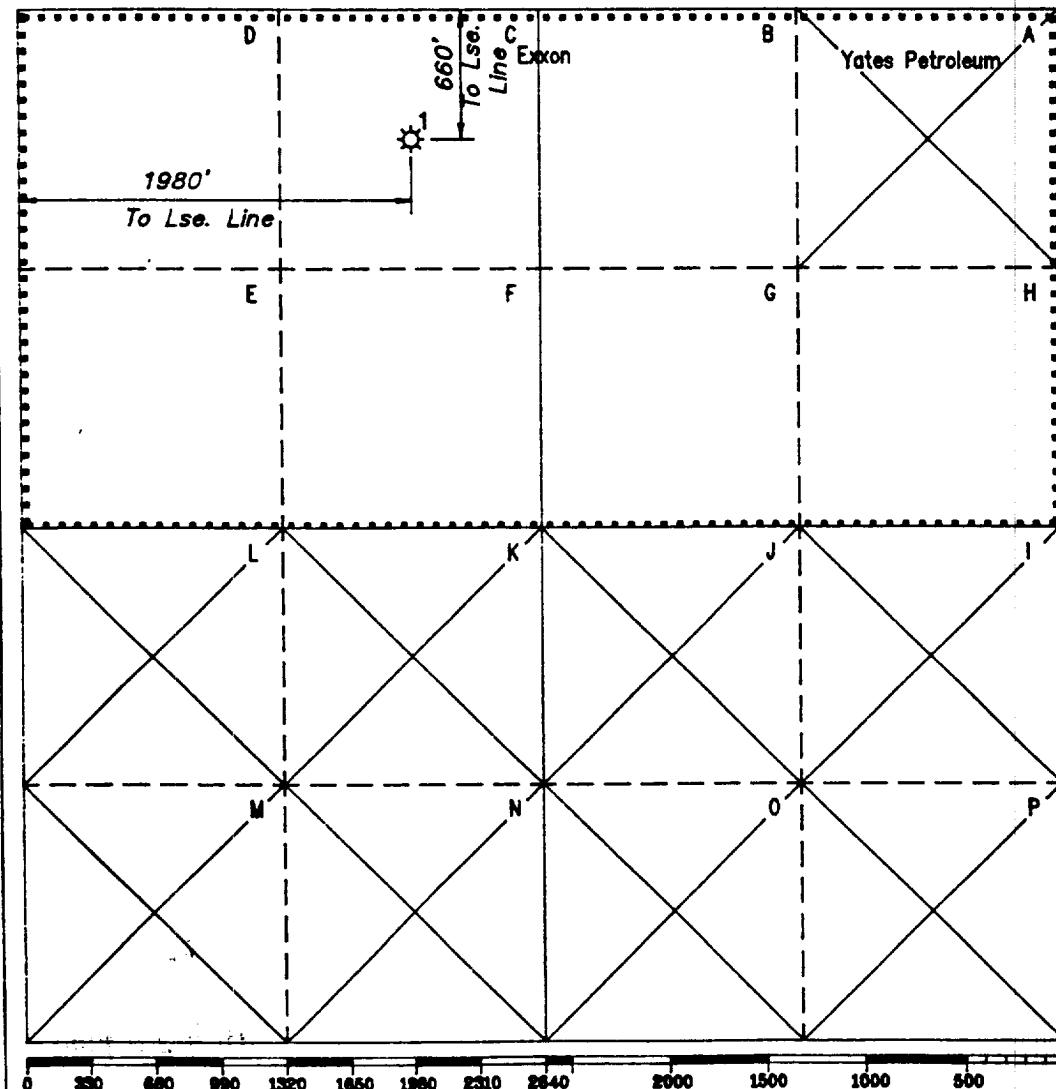

OPERATOR CERTIFICATION

I hereby certify that the information contained herein is true and complete to the best of my knowledge and belief.

Signature

Charlotte Harper

Printed Name

FOR
Charlotte Harper

Position

PERMITS SUPERVISOR

Company Exxon Corporation

P.O. Box 1600-Midland, Tx.-79702

Date

3-30-89

SURVEYOR CERTIFICATION

I hereby certify that the well location shown on this plat was plotted from field notes of actual surveys made by me or under my supervision, and that the same is true and correct to the best of my knowledge and belief.

Date Surveyed

3-13-89

Signature & Seal
Professional Surveyor

Michael L. Stanford

Certificate No.

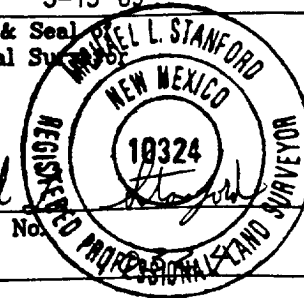

23.5 Miles WEST of JAL, New Mexico.

C.E. File No. WA-10252