

UNITED STATES
DEPARTMENT OF THE INTERIOR
BUREAU OF LAND MANAGEMENT

SUBMIT IN TRIPLICATE
(Other instruction
verse side)

Form approved
Budget Bureau No. 1004-0135
Expires August 31, 1985

SUNDRY NOTICES AND REPORTS ON WELLS	
(Do not use this form for proposals to drill or to deepen or plug back to a different reservoir. Use "APPLICATION FOR PERMIT—" for such proposals.)	
1. OIL WELL <input type="checkbox"/> GAS WELL <input checked="" type="checkbox"/> OTHER	5. LEASE DESIGNATION AND SERIAL NO. NM 14497
2. NAME OF OPERATOR Enron Oil & Gas Company	6. IF INDIAN, ALLOTTEE OR TRIBE NAME
3. ADDRESS OF OPERATOR P. O. Box 2267, Midland, Texas 79702	7. UNIT AGREEMENT NAME
4. LOCATION OF WELL (Report location clearly and in accordance with any State requirements.* See also space 17 below.) At surface 660' FNL & 2310' FEL	8. FARM OR LEASE NAME Diamond 8 Federal
	9. WELL NO. 1
	10. FIELD AND POOL, OR WILDCAT Pitchfork Ranch Morrow
	11. SEC., T., R., M., OR BLK. AND SURVEY OR AREA Sec. 8, T25S, R34E
14. PERMIT NO.	12. COUNTY OR PARISH Lea
15. ELEVATIONS (Show whether DF, RT, GR, etc.) 3364.0' GR	13. STATE NM

16. Check Appropriate Box To Indicate Nature of Notice, Report, or Other Data

NOTICE OF INTENTION TO:		SUBSEQUENT REPORT OF:	
TEST WATER SHUT-OFF <input type="checkbox"/>	PULL OR ALTER CASING <input type="checkbox"/>	WATER SHUT-OFF <input type="checkbox"/>	REPAIRING WELL <input type="checkbox"/>
FRACTURE TREAT <input type="checkbox"/>	MULTIPLE COMPLETE <input type="checkbox"/>	FRACTURE TREATMENT <input type="checkbox"/>	ALTERING CASING <input type="checkbox"/>
SHOOT OR ACIDIZE <input type="checkbox"/>	ABANDON* <input type="checkbox"/>	SHOOTING OR ACIDIZING <input type="checkbox"/>	ABANDONMENT* <input type="checkbox"/>
REPAIR WELL <input type="checkbox"/>	CHANGE PLANS <input type="checkbox"/>	(Other) <input type="checkbox"/>	
(Other) Amend Location <input checked="" type="checkbox"/>		(Note: Report results of multiple completion on Well Completion or Recompletion Report and Log form.)	

17. DESCRIBE PROPOSED OR COMPLETED OPERATIONS (Clearly state all pertinent details, and give pertinent dates, including estimated date of starting any proposed work. If well is directionally drilled, give subsurface locations and measured and true vertical depths for all markers and zones pertinent to this work.) *

To amend location from 1980' FEL to 660' FNL
New Location: 660' FNL & 2310' FEL.

18. I hereby certify that the foregoing is true and correct

SIGNED Betty Gilson

TITLE Regulatory Analyst

DATE 8/7/89

(This space for Federal or State office use)

APPROVED BY Shannon J. Shaw

For: CHIEF, MINERAL RESOURCES

DATE 8-15-89

*See Instructions on Reverse Side

Submit to Appropriate
District Office
State Lease - 4 copies
Fee Lease - 3 copies

State of New Mexico
Energy, Minerals and Natural Resources Department

Form C-102
Revised 1-1-89

OIL CONSERVATION DIVISION

P.O. Box 2088

Santa Fe, New Mexico 87504-2088

DISTRICT I

P.O. Box 1980, Hobbs, NM 88240

DISTRICT II

P.O. Drawer DD, Artesia, NM 88210

DISTRICT III

1000 Rio Brazos Rd., Aztec, NM 87410

WELL LOCATION AND ACREAGE DEDICATION PLAT

All Distances must be from the outer boundaries of the section

Operator Enron Oil & Gas Company			Lease Diamond 8 Federal		Well No. 1
Unit Letter B	Section 8	Township 25 South	Range 34 East	County NMPM	Lea
Actual Footage Location of Well: 660 feet from the North line and 2310 feet from the East line					
Ground level Elev. 3364.0	Producing Formation Morrow	Pool Pitchfork Ranch			Dedicated Acreage: N/2 320 Acres

- Outline the acreage dedicated to the subject well by colored pencil or hatchure marks on the plat below.
- If more than one lease is dedicated to the well, outline each and identify the ownership thereof (both as to working interest and royalty).
- If more than one lease of different ownership is dedicated to the well, have the interest of all owners been consolidated by communitization, unitization, force-pooling, etc?
☐ Yes ☐ No If answer is "yes" type of consolidation _____
If answer is "no" list the owners and tract descriptions which have actually been consolidated. (Use reverse side of this form if necessary).
No allowable will be assigned to the well until all interests have been consolidated (by communitization, unitization, force-pooling, or otherwise) or until a non-standard unit, eliminating such interest, has been approved by the Division.

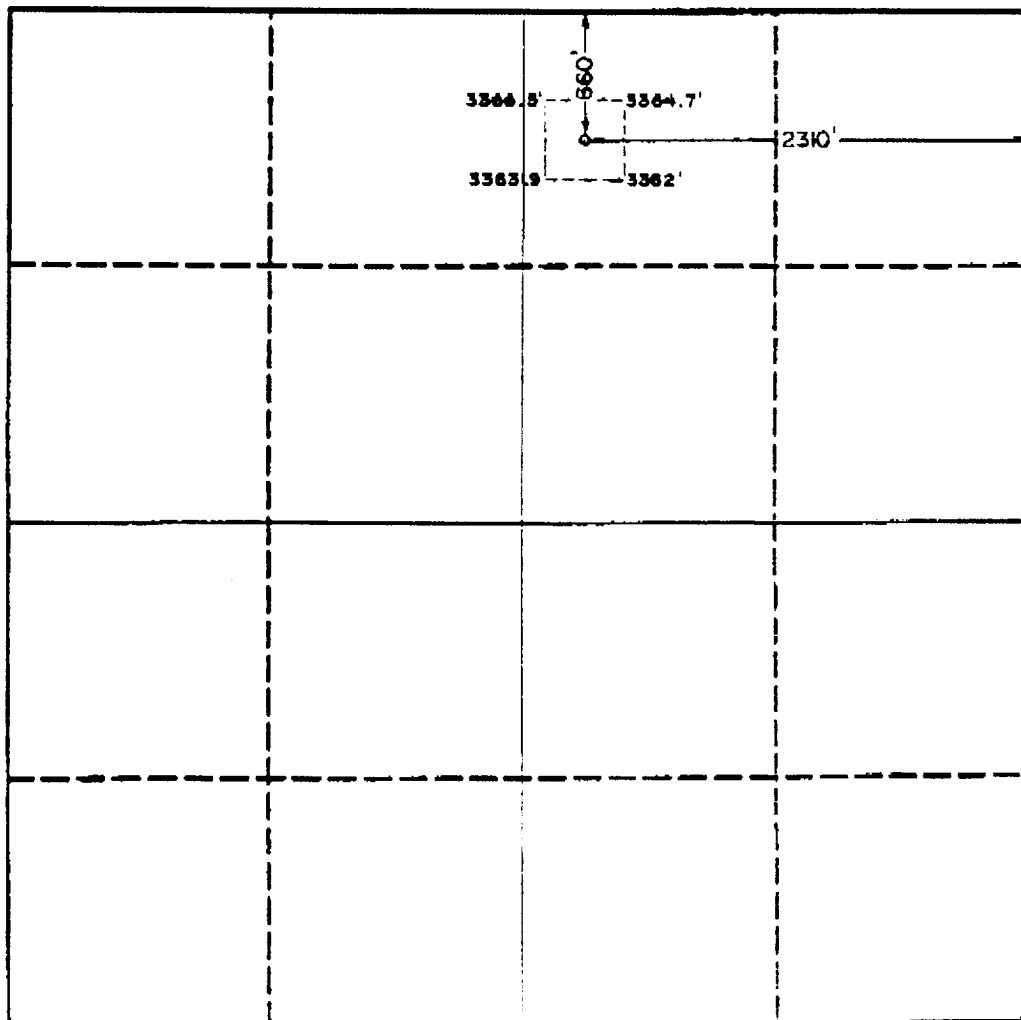

OPERATOR CERTIFICATION

I hereby certify that the information contained herein is true and complete to the best of my knowledge and belief.

Signature

Betty Gildon

Printed Name

Betty Gildon

Position

Regulatory Analyst

Company

Enron Oil & Gas Company

Date

8/7/89

SURVEYOR CERTIFICATION

I hereby certify that the well location shown on this plat was plotted from field notes of actual surveys made by me or under my supervision, and that the same is true and correct to the best of my knowledge and belief.

Date Surveyed

August 5, 1989

Signature & Seal
Professional Surveyor

