

All distances must be from the outer boundaries of the Section.

Operator Tahoe Energy, Inc.			Lease Junk Yard Dog			Well No. 1		
Unit Letter D	Section 19	Township 25 South	Range 37 East	County Lea				
Actual Footage Location of Well:								
660		feet from the North		Line and 360		feet from the West		Line
Ground Level Elev. 3109.5	Producing Formation Yates/Seven Rivers			Pool Jalmat Tansill Yates Seven Rivers			Dedicated Acreage: 39.21 40 Acres	

1. Outline the acreage dedicated to the subject well by colored pencil or hatchure marks on the plat below.
2. If more than one lease is dedicated to the well, outline each and identify the ownership thereof (both as to working interest and royalty).
3. If more than one lease of different ownership is dedicated to the well, have the interests of all owners been consolidated by communitization, unitization, force-pooling, etc?

☐ Yes ☐ No If answer is "yes," type of consolidation _____

If answer is "no," list the owners and tract descriptions which have actually been consolidated. (Use reverse side of this form if necessary.) _____

No allowable will be assigned to the well until all interests have been consolidated (by communitization, unitization, forced-pooling, or otherwise) or until a non-standard unit, eliminating such interests, has been approved by the Division

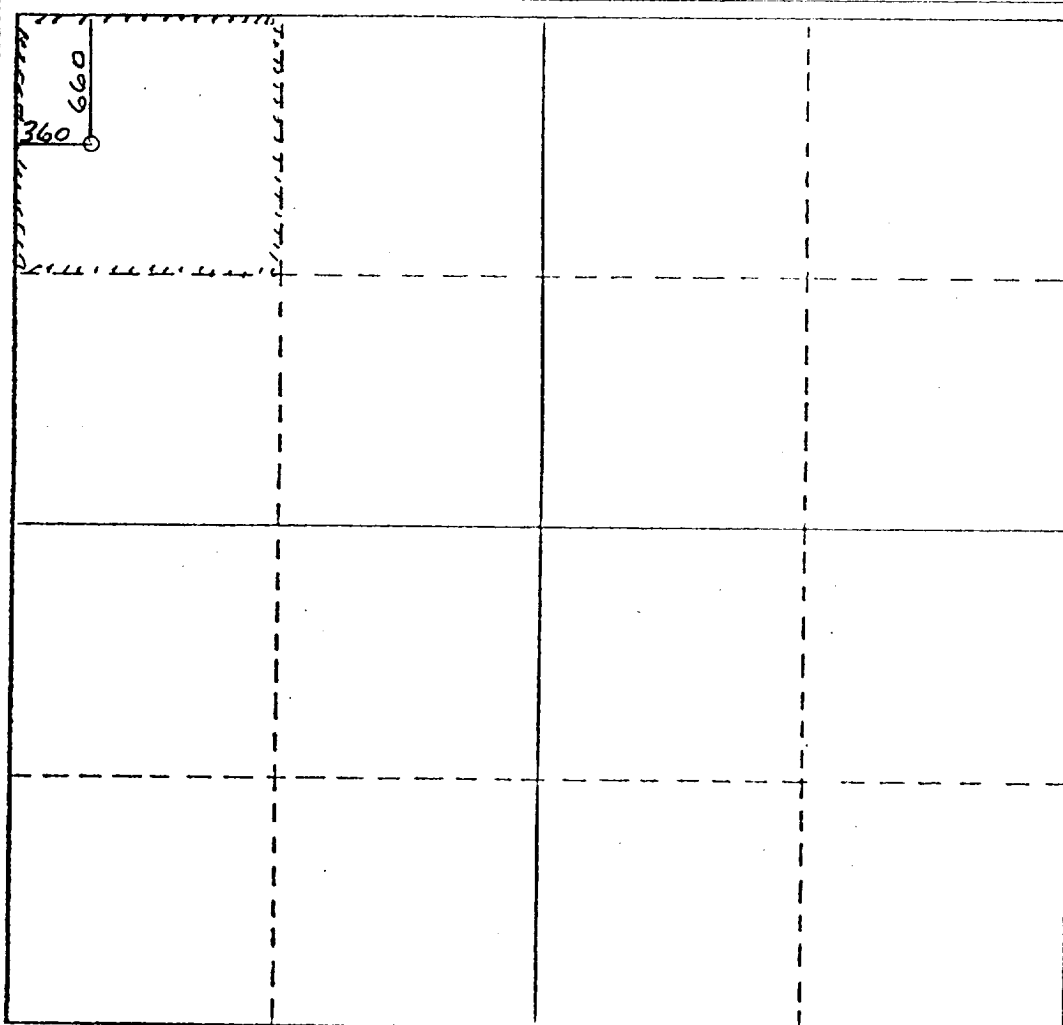

CERTIFICATION

I hereby certify that the information contained herein is true and complete to the best of my knowledge and belief.

Name
K.A. Freeman

Position
Petroleum Engineer

Company
Tahoe Energy, Inc.

Date

I hereby certify that the well location shown on this plat was plotted from field notes of actual surveys made by me or under my supervision, and that the same is true and correct to the best of my knowledge and belief.

Date Surveyed
22-10-91

Registered Professional Engineer and/or Land Surveyor
126

Truman Gaskin

Certificate No.
126

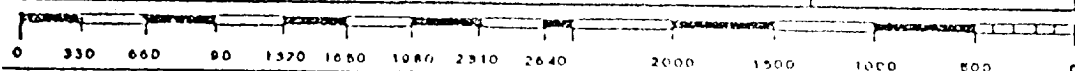
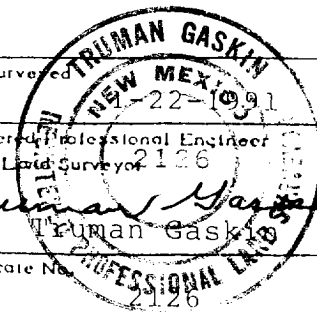

RECEIVED

MAR 12 11 13 AM '91

9/1 11 13 AM '91
ANALYST: [illegible]

MAR 1 8 1991

11 13 AM '91