

UNITED STATES
DEPARTMENT OF THE INTERIOR
BUREAU OF LAND MANAGEMENT

APPLICATION FOR PERMIT TO DRILL, DEEPEN, OR PLUG BACK

1a. TYPE OF WORK

DRILL ☒

DEEPEN ☐

PLUG BACK ☐

b. TYPE OF WELL

OIL
WELL ☐

GAS
WELL ☒

OTHER

SINGLE
ZONE ☒

MULTIPLE
ZONE ☐

2. NAME OF OPERATOR

Enron Oil & Gas Company

3. ADDRESS OF OPERATOR

P. O. Box 2267, Midland, Texas 79702

4. LOCATION OF WELL (Report location clearly and in accordance with any State requirements.)

At surface

660' FNL & 1980' FEL

unit B

At proposed prod. zone

660' FNL & 1980' FEL

14. DISTANCE IN MILES AND DIRECTION FROM NEAREST TOWN OR POST OFFICE*

25 miles west of Jal, NM

15. DISTANCE FROM PROPOSED*

LOCATION TO NEAREST

PROPERTY OR LEASE LINE, FT.

(Also to nearest drlg. unit line, if any)

660'

660'

18. DISTANCE FROM PROPOSED LOCATION*
TO NEAREST WELL, DRILLING, COMPLETED,
OR APPLIED FOR, ON THIS LEASE, FT.

None

16. NO. OF ACRES IN LEASE

320

17. NO. OF ACRES ASSIGNED
TO THIS WELL

320

19. PROPOSED DEPTH

15,450'

20. ROTARY OR CABLE TOOLS

Rotary

21. ELEVATIONS (Show whether DF, RT, GR, etc.)

3433.2' GR

22. APPROX. DATE WORK WILL START*

6/29/92

23.

PROPOSED CASING AND CEMENTING PROGRAM

SIZE OF HOLE	SIZE OF CASING	WEIGHT PER FOOT	SETTING DEPTH	QUANTITY OF CEMENT
20	16	65	650	800 sacks Circulated
14-3/4	10-3/4	40.5 & 45.5	5200	3000 sacks Circulated
9-1/2	7-5/8	33.7 & 29.7	13300	1210 sacks - SEE STIPS.
6-1/2	4-1/2	15.1	15450	300 sacks TOL: 13000

BOP - Install 3000 WP at 650'... At 5200' increase to 5,000 WP and at 13,300' increase to 10,000 WP.

Acreage is not dedicated.

IN ABOVE SPACE DESCRIBE PROPOSED PROGRAM: If proposal is to deepen or plug back, give data on present productive zone and proposed new productive zone. If proposal is to drill or deepen directionally, give pertinent data on subsurface locations and measured and true vertical depths. Give blowout preventer program, if any.

24.

SIGNER

Betty Gildon

Betty Gildon

TITLE

Regulatory Analyst

DATE

6/5/92

(This space for Federal or State office use)

PERMIT NO.

APPROVAL DATE

APPROVED BY

CONDITIONS OF APPROVAL, IF ANY:

APPROVAL SUBJECT TO

GENERAL REQUIREMENTS AND

SPECIAL STIPULATIONS

TITLE

DATE

7-2-92

*See Instructions On Reverse Side

ATTACHED
Title 18, U.S.C. Section 1001, makes it a crime for any person knowingly and willfully to make to any department or agency of the United States any false, fictitious or fraudulent statements or representations as to any matter within its jurisdiction.

RECEIVED

JUL 07 1992

OCD HOBBS OFFICE

PAGE.03

State of New Mexico
Energy, Minerals and Natural Resources Department

Form C-102
Revised 1-1-59

OIL CONSERVATION DIVISION

P.O. Box 2088

Santa Fe, New Mexico 87504-2088

DISTRICT I

P.O. Box 1980, Hobbs, NM 88240

DISTRICT II

P.O. Drawer DD, Artesia, NM 87010

DISTRICT III

1000 Rio Huerfano Rd., Artes, NM 87410

WELL LOCATION AND ACREAGE DEDICATION PLAT

All Distances must be from the outer boundaries of the section

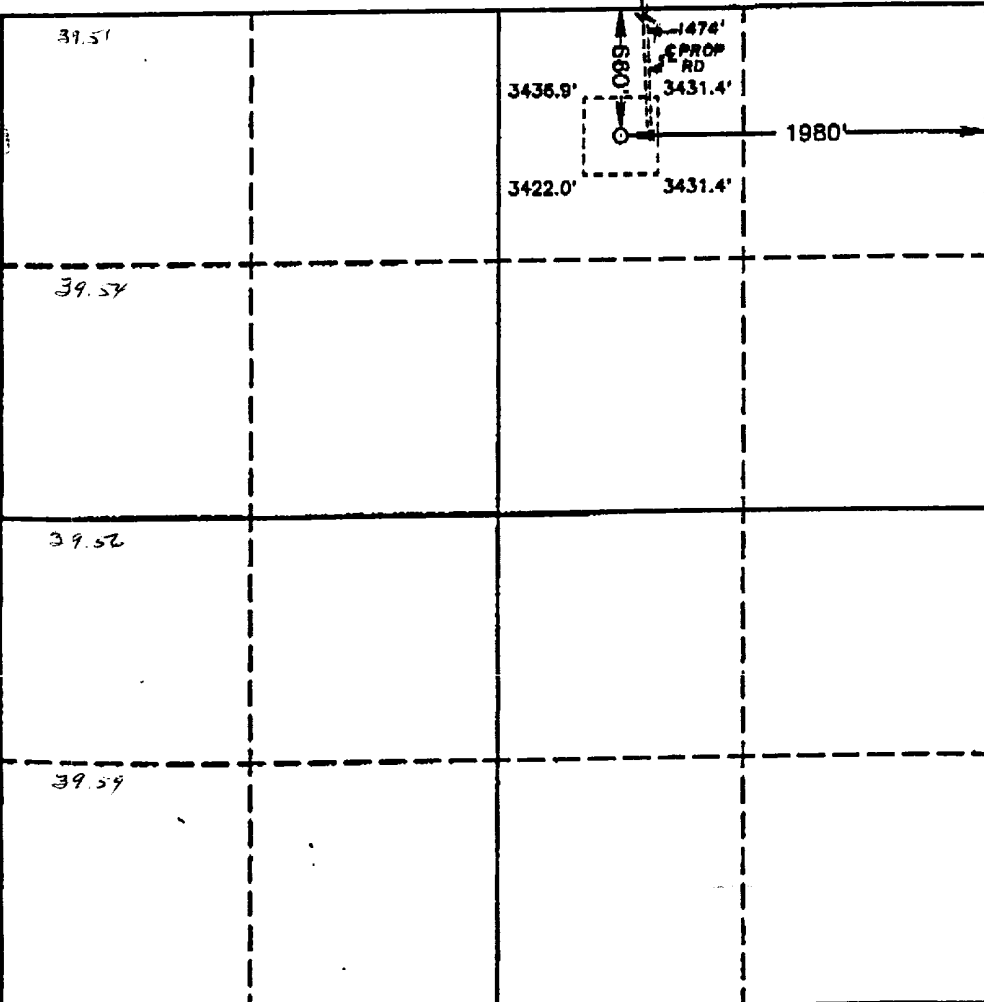
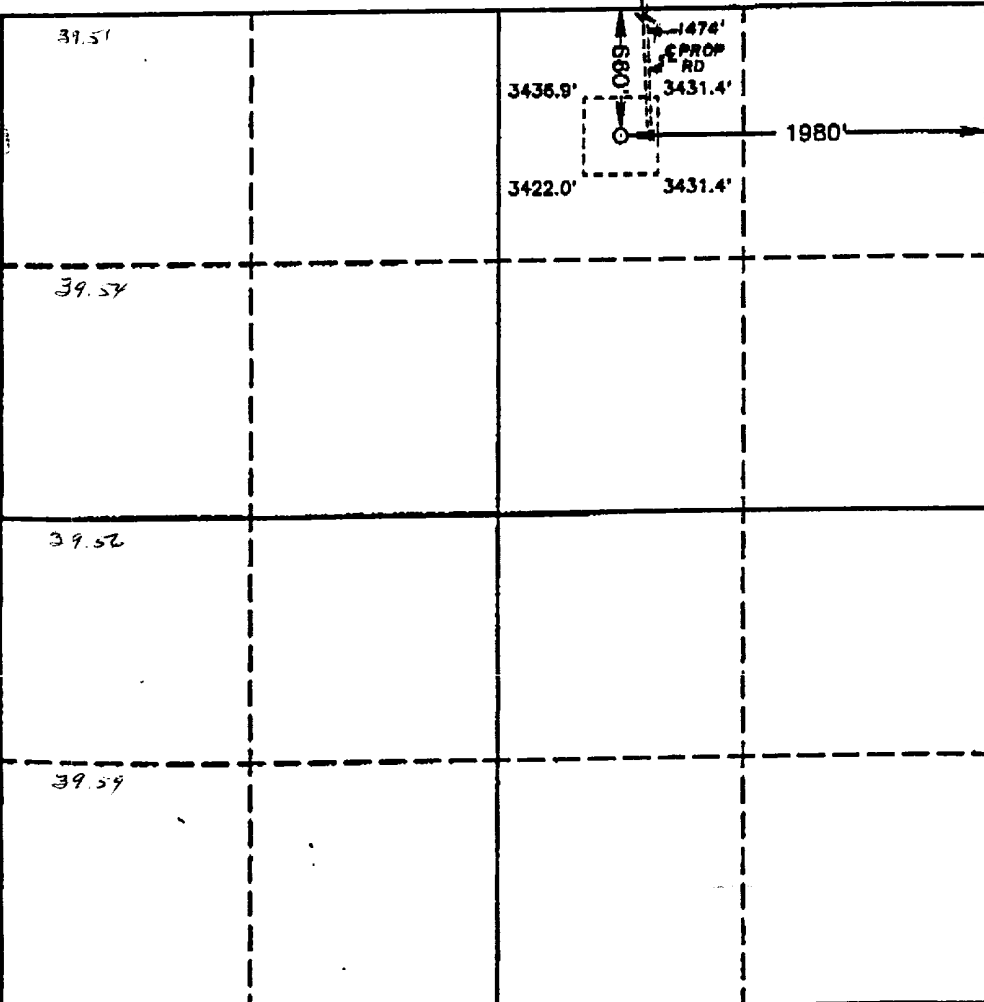
Operator ENRON OIL AND GAS CO.			Lease DIAMOND "7" FEDERAL COM.		Well No. 1	
Unit Letter B	Section 7	Township 25 SOUTH	Range 34 EAST		County NMPM	
Actual Footage Location of Well: 660 feet from the NORTH line and 1980 feet from the EAST line						
Ground Level Elev. 3433.2'		Producing Formation Morrow		Pool Pitchfork Ranch		
				Dedicated Acreage: 320 N/2 Acres		
<p>1. Outline the acreage dedicated to the subject well by colored pencil or hatchure marks on the plat below.</p> <p>2. If more than one lease is dedicated to the well, outline each and identify the ownership thereof (both as to working interest and royalty).</p> <p>3. If more than one lease of different ownership is dedicated to the well, have the interest of all owners been consolidated by communitization, unitization, force-pooling, etc.?</p> <p><input checked="" type="checkbox"/> Yes <input type="checkbox"/> No If answer is "yes" type of consolidation <u>Communitization</u></p> <p>If answer is "no" list of owners and tract descriptions which have actually been consolidated. (Use reverse side of this form necessary.)</p> <p>No allowable will be assigned to the well unit all interests have been consolidated (by communitization, unitization, forced-pooling, otherwise) or until a non-standard unit, eliminating such interest, has been approved by the Division.</p>						
				<p>OPERATOR CERTIFICATION</p> <p>I hereby certify that the information contained herein is true and complete to the best of my knowledge and belief.</p> <p>Signature: <u>Betty Gildon</u></p> <p>Printed Name: <u>Betty Gildon</u></p> <p>Position: <u>Regulatory Analyst</u></p> <p>Company: <u>Enron Oil & Gas Company</u></p> <p>Date: <u>5/19/92</u></p>		
				<p>SURVEYOR CERTIFICATION</p> <p>I hereby certify that the well location shown on this plat was plotted from field notes of actual surveys made by me or under my supervision, and that the same is true and correct to the best of my knowledge and belief.</p> <p>Date Surveyed: <u>MAY 15, 1992</u></p> <p>Signature & Seal of Professional Surveyor: <u>[Signature]</u></p> <p>Professional Surveyor Seal: <u>[Seal]</u></p>		

RECEIVED

JUL 07 1992

OCD HOBBS OFFICE

ENRON OIL & GAS COMPANY
 Diamond "7" FEDERAL COM. NO. 1
 660' ENL & 1,980' FEI Section 7-25S-34E

ATTACHMENT "C"

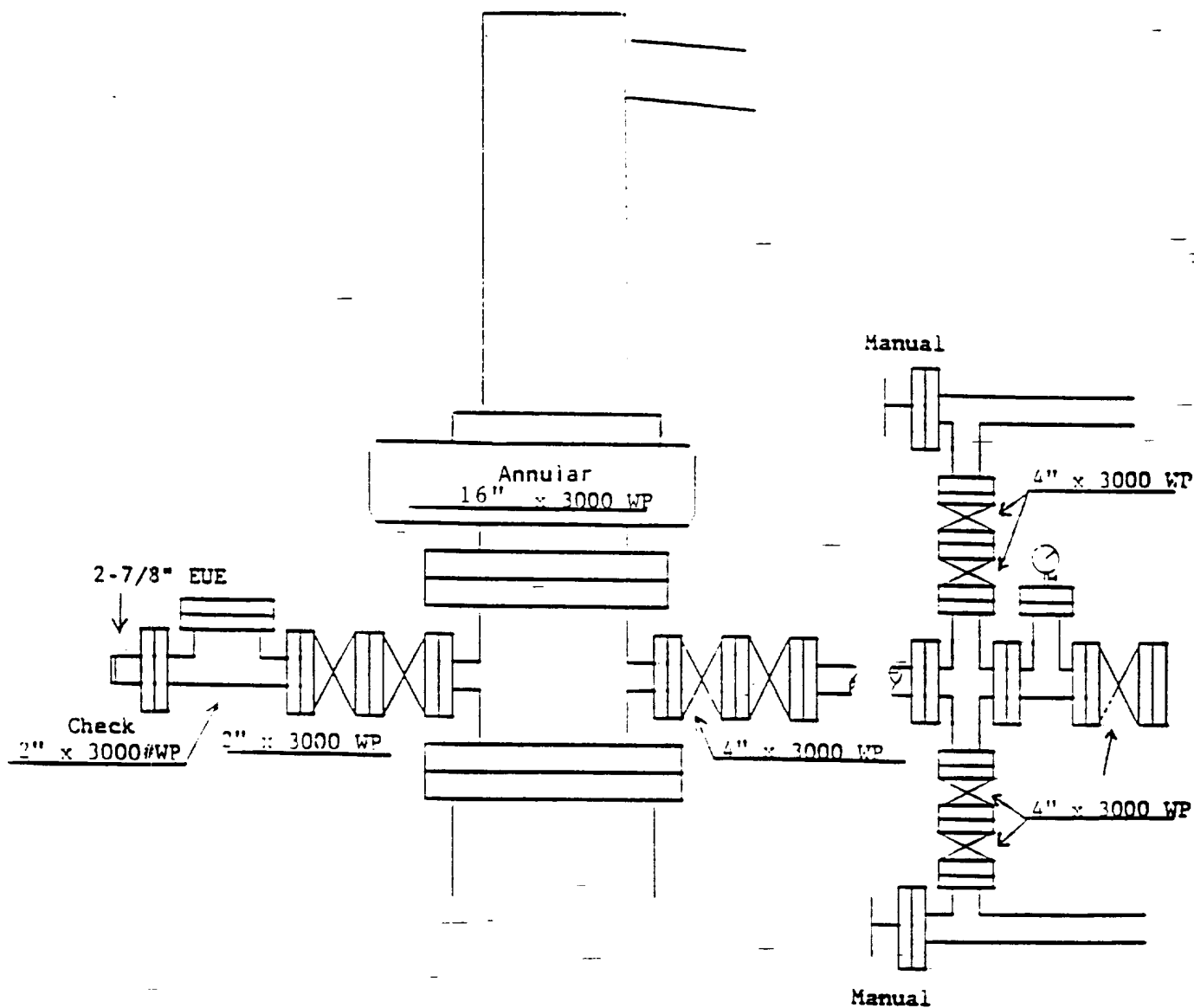

Rig up this equipment at 650' and use until 5,200'

RECEIVED

JUL 07 1992

OCD HOBBS OFFICE

ENRON OIL & GAS COMPANY
 DIAMOND 7 FEDERAL COM. NO. 1
 660' FNL & 1,980' FFL Section 7-25S-34E

ATTACHMENT "D"

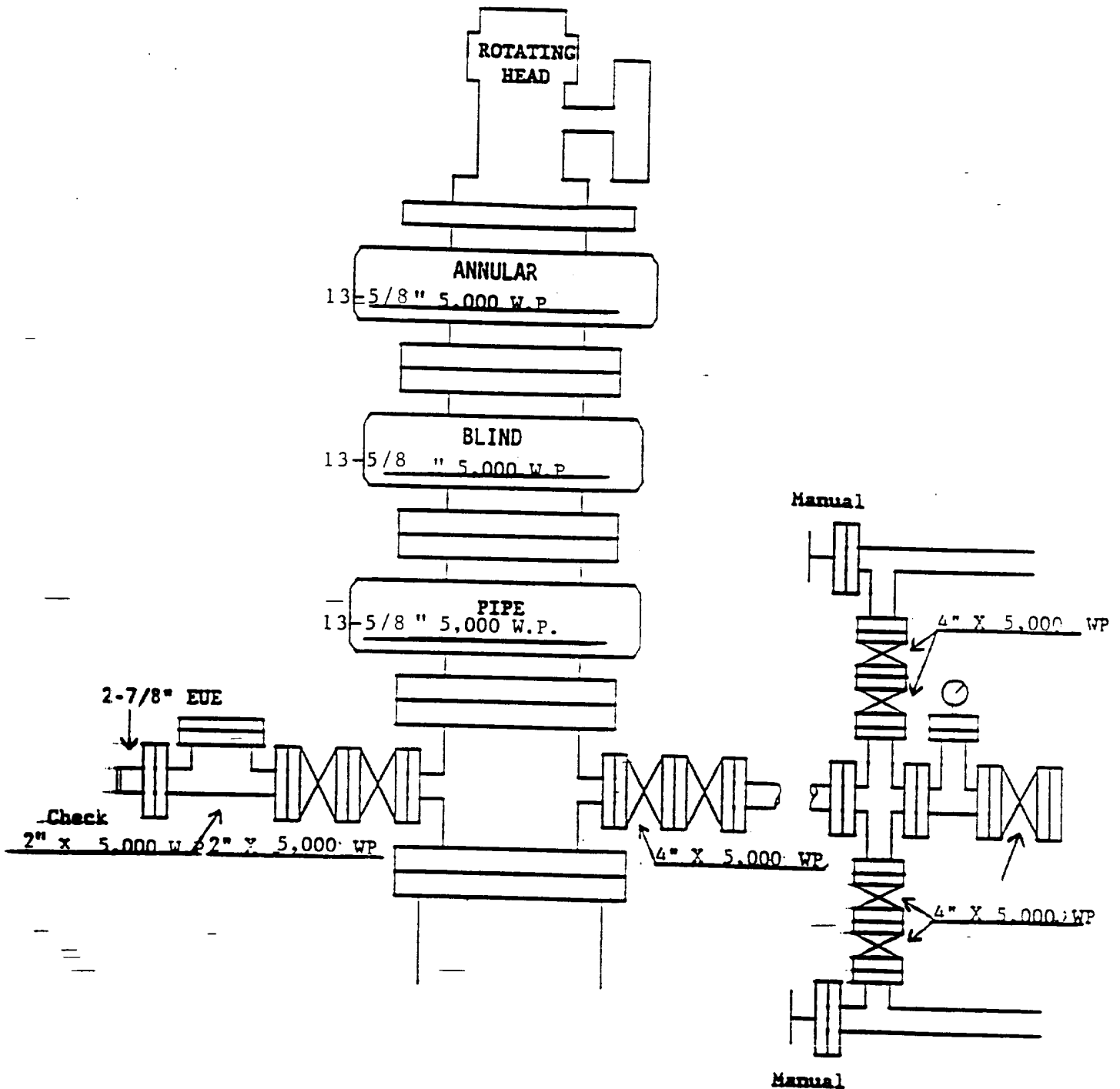

Rig up this equipment at 5,200 use until 13,300'

RECEIVED

JUL 07 1992

OCD HOBBS OFFICE

ENRON OIL & GAS COMPANY
 DIAMOND 7 FEDERAL COM. NO. 1
 660' FNL & 1,980' FEL Section 7-25S-34 E

ATTACHMENT "E"

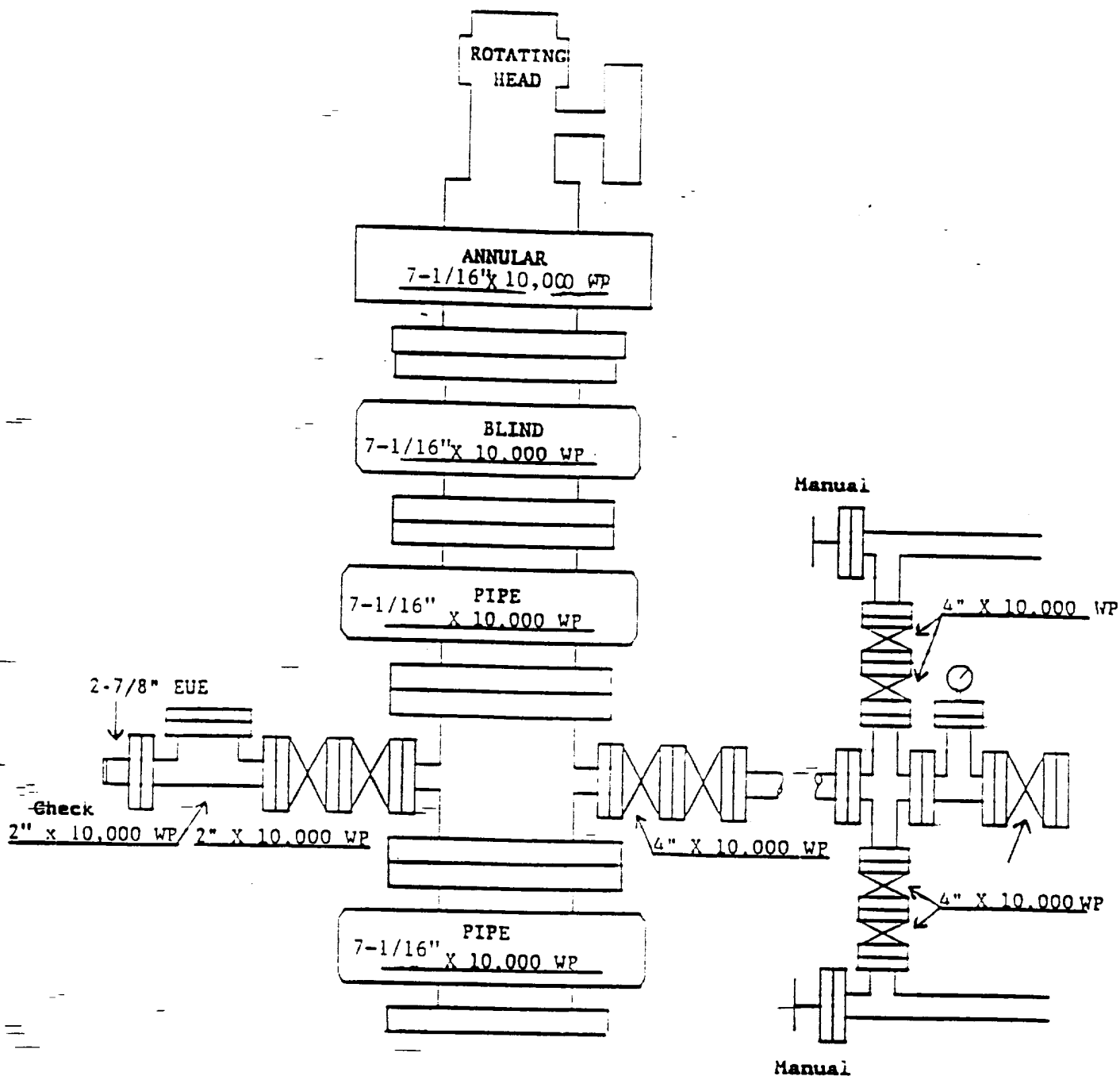

Rig up this equipment at 13,300' use until TD at 15,450'

26810-28-92
14/07/92
F.T.F.

RECEIVED
JUL 07 1992
OCD HOBBS OFFICE