

Form 3160-3
(July 1992)

N.M. OIL & GAS COMMISSION
P.O. BOX 1380
HOBBS, NEW MEXICO 88240
UNITED STATES
DEPARTMENT OF THE INTERIOR
BUREAU OF LAND MANAGEMENT

SUBMIT IN TRIPLICATE*
(Other instructions on
reverse side)

FORM APPROVED
OMB NO. 1004-0136
Expires: February 28, 1995

APPLICATION FOR PERMIT TO DRILL OR DEEPEN

1a. TYPE OF WORK

DRILL ☒

DEEPEN ☐

b. TYPE OF WELL

OIL
WELL ☒

GAS
WELL ☐

OTHER

SINGLE
ZONE ☒

MULTIPLE
ZONE ☐

2. NAME OF OPERATOR

Enron Oil & Gas Company

3. ADDRESS AND TELEPHONE NO.

P. O. Box 2267, Midland, Texas 79702

4. LOCATION OF WELL (Report location clearly and in accordance with any State requirements.)

At surface

1980' FNL & 660' FEL

At proposed prod. zone

1980' FNL & 660' FEL UNIT H

14. DISTANCE IN MILES AND DIRECTION FROM NEAREST TOWN OR POST OFFICE*

29 miles west from Jal

15. DISTANCE FROM PROPOSED*

LOCATION TO NEAREST
PROPERTY OR LEASE LINE, FT. 660
(Also to nearest drig. unit line, if any) 660

16. NO. OF ACRES IN LEASE

1399.89

17. NO. OF ACRES ASSIGNED
TO THIS WELL

40

18. DISTANCE FROM PROPOSED LOCATION*
TO NEAREST WELL, DRILLING, COMPLETED,
OR APPLIED FOR, ON THIS LEASE, FT.

1320' To #5

19. PROPOSED DEPTH

12600

20. ROTARY OR CABLE TOOLS

Rotary

21. ELEVATIONS (Show whether DF, RT, GR, etc.)

3411.7' GR

No Water Basin

22. APPROX. DATE WORK WILL START*

April 25, 1994

23. PROPOSED CASING AND CEMENTING PROGRAM

SIZE OF HOLE	GRADE, SIZE OF CASING	WEIGHT PER FOOT	SETTING DEPTH	QUANTITY OF CEMENT
14-3/4	11-3/4 H-40 A ST&C	42#	650	250 sx CIRCULATED
11	8-5/8 J-55 ST&C	24# & 32#	5200	1100 sx CIRCULATED
7-7/8	5-1/2 J-55 & N-80 ST&C	17#	12,600	1200 sx Est TOC 4500'

Approval Subject to
General Requirements and
Special Stipulations
Attached

OPER. OGRID NO. 7377

PROPERTY NO. 13209

POOL CODE 51020

EFF. DATE 5-22-94

API NO. 20-025-30527

Acreage is dedicated to a pipeline.

IN ABOVE SPACE DESCRIBE PROPOSED PROGRAM: If proposal is to deepen, give data on present productive zone and proposed new productive zone. If proposal is to drill or deepen directionally, give pertinent data on subsurface locations and measured and true vertical depths. Give blowout preventer program, if any.

24.

SIGNED Betty Gildon

TITLE Regulatory Analyst

DATE 3/23/94

(This space for Federal or State office use)

PERMIT NO.

APPROVAL DATE

Application approval does not warrant or certify that the applicant holds legal or equitable title to those rights in the subject lease which would entitle the applicant to conduct operations thereon.

CONDITIONS OF APPROVAL, IF ANY:

APPROVED BY

IS Ron Duntan

TITLE

(for)
AREA MANAGER

DATE

5-23-94

*See Instructions On Reverse Side

RECEIVED

MAY 21 1994

**JOE ROBB
OFFICE**

Submit to Appropriate
District Office
State Lease - 4 copies
Fee Lease - 3 copies

State of New Mexico
Energy, Minerals and Natural Resources Department

Form C-102
Revised 1-1-89

OIL CONSERVATION DIVISION

DISTRICT I
P.O. Box 1980, Hobbs, NM 88240

P.O. Box 2088
Santa Fe, New Mexico 87504-2088

DISTRICT II
P.O. Drawer DD, Artesia, NM 88210

DISTRICT III
1000 Rio Brazos Rd., Artec, NM 87410

WELL LOCATION AND ACREAGE DEDICATION PLAT

All Distances must be from the outer boundaries of the section

Operator ENRON OIL & GAS CO		Lease HALLWOOD "12" FEDERAL		Well No. 6
Unit Letter H	Section 12	Township 25 SOUTH	Range 33 EAST NMPM	County LEA
Actual Footage Location of Well: 1980 feet from the NORTH line and 660 feet from the EAST line				
Ground Level Elev. 3411.7	Producing Formation Bone Spring	Pool Red Hills	Dedicated Acreage: 40 Acres	
<p>1. Outline the acreage dedicated to the subject well by colored pencil or hachure marks on the plat below.</p> <p>2. If more than one lease is dedicated to the well, outline each and identify the ownership thereof (both as to working interest and royalty).</p> <p>3. If more than one lease of different ownership is dedicated to the well, have the interest of all owners been consolidated by communitization, unitization, force-pooling, etc.? <input type="checkbox"/> Yes <input type="checkbox"/> No If answer is "yes" type of consolidation _____</p> <p>If answer is "no" list of owners and tract descriptions which have actually been consolidated. (Use reverse side of this form necessary. _____)</p> <p>No allowable will be assigned to the well unit all interests have been consolidated (by communitization, unitization, forced-pooling, otherwise) or until a non-standard unit, eliminating such interest, has been approved by the Division.</p>				

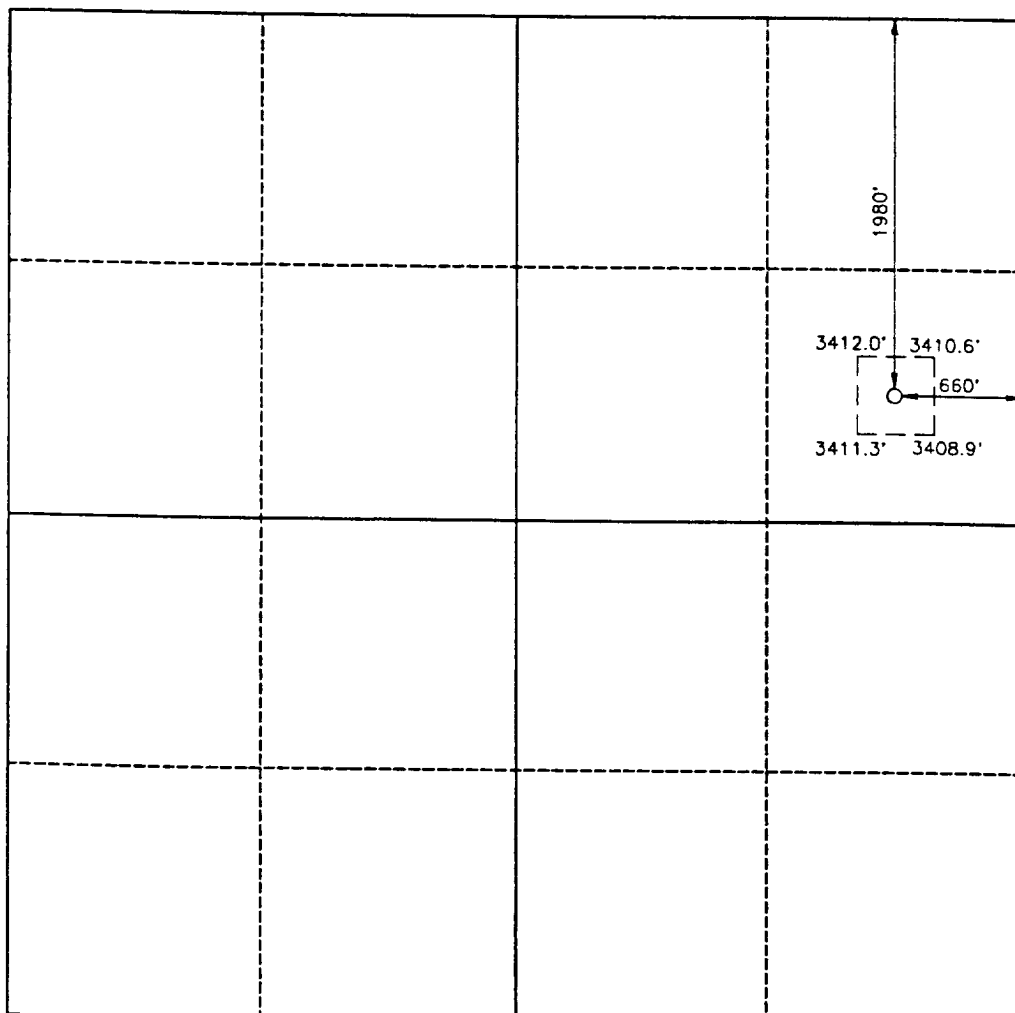

OPERATOR CERTIFICATION

I hereby certify the the information
contained herein is true and complete to the
best of my knowledge and belief.

Signature
Betty Gildon
Printed Name
Betty Gildon
Position
Regulatory Analyst
Company
Enron Oil & Gas Company
Date
3/4/94

SURVEYOR CERTIFICATION

I hereby certify that the well location shown
on this plat was plotted from field notes of
actual surveys made by me or under my
supervision, and that the same is true and
correct to the best of my knowledge and
belief.

Date Surveyed
NOVEMBER 25, 1993

Signature & Seal of
Professional Surveyor

Certification No. 7977
RONALD J. EDSON, 8228
GARY L. JONES, 7977

93-11-2346

RECEIVED

MAY 2 1991

**OLD FINE
OFFICE**

DRILLING PROGRAM

Enron Oil & Gas Company
Hallwood "12" Federal, Well No. 6
1980' FNL & 660' FEL
Sec. 12, T25S, R33E
Lea County, New Mexico

1. Geologic Name of Surface Formation:

Permian

2. Estimated Tops of Important Geologic Markers:

Rustler	850'
Delaware Mt. Group	5175'
Bone Spring Lime	9275'
Bone Spring Pay	12225'
TD	12600'

3. Estimated Depths of Anticipated Fresh Water, Oil or Gas:

Upper Permian Sands	100'	Fresh Water
3rd Bone Spring Sand	12225'	Oil

No other formations are expected to give up oil, gas or fresh water in measurable quantities. The surface fresh water sands will be protected by setting 11-3/4" casing at 650' and circulating cement back to surface, and 8-5/8" casing will be set at 5200' with cement circulated back to surface.

RECEIVED

MAY 2 1964

ODD
OFFICE

Enron Oil & Gas Company
Hallwood "12" Federal, Well No. 6
1980' FNL & 660' FEL
Sec. 12, T25S, R33E
Lea County, New Mexico

4. Casing Program:

<u>Hole Size</u>	<u>Interval</u>	<u>OD csg</u>	<u>Weight Grade Jt. Cond. Type</u>
14-3/4	0- 650'	11-3/4	42# H-40 A ST&C
11	0- 5200'	8-5/8	24# & 32# J-55 ST&C
7-7/8	0- 12600'	5-1/2	17# J-55 & N-80 ST&C

Cementing Program:

11-3/4" Surface casing: Cement to surface with 250 sx of Class C
+ 2% CaCl₂ + 1/4#/sx flocele.

8-5/8" Intermediate: Cement to surface with 800 sx of Premium Plus
lite + 15#/sx salt + 1/4#/sx Flocele and 300 sx
Cl C + 2% CaCl₂

5-1/2" Prod. Casing: Cement with 1200 sx 50/50 Cl H/Poz + 2% Gel + .4%
CF-14, .1% Diacel LWL. This cement slurry is
designed to bring TOC to 4500'.

5. Minimum Specifications for Pressure Control:

The blowout preventer equipment (BOP) shown in Exhibit #1 will consist of a double ram-type (5000 psi WP) preventer and an annular preventer (5000 psi WP). Units will be hydraulically operated and the ram-type will be equipped with blind rams on top and drill pipe rams on bottom. All will be installed on the 11-3/4" surface casing and used continuously until TD is reached. All BOP's and accessory equipment will be tested to 600 psi before drilling out of surface casing. Before drilling out of intermediate casing, the ram-type BOP and accessory equipment will be tested to 5000 psi and the annular to 70% of rated working pressure (3500 psi).

Pipe rams will be operationally checked each 24 hour period. Blind rams will be operationally checked on each trip out of the hole. These checks will be noted on the daily tour sheets. A 2" kill line and 4" choke line will be included in the drilling spool located below the ram-type BOP. Other accessories to the BOP equipment will include a kelly cock and floor safety valve (inside BOP) and choke lines and choke manifold with 3000 psi WP rating.

RECEIVED

1994

OFFICE

ENRON OIL & GAS COMPANY

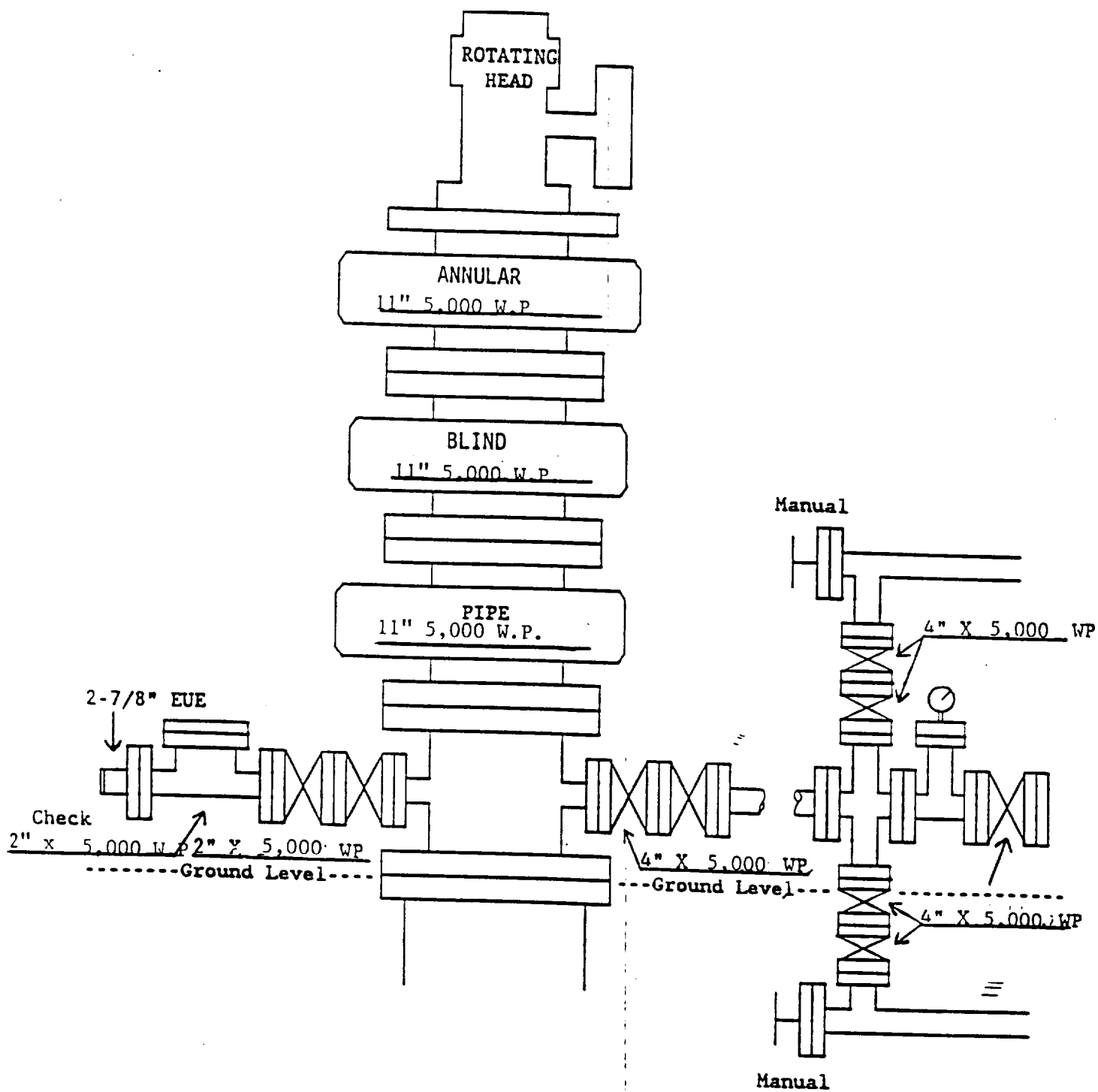

RECEIVED

MAY 21 1994

OFFICE

173