

DISTRICT I

P.O. Box 1980, Hobbs, NM 88241-1980

DISTRICT II

P.O. Box Drawer DD, Artesia, NM 88211-0719

DISTRICT III

1000 Rio Brazos Rd., Aztec, NM 87410

DISTRICT IV

P.O. Box 2088, Santa Fe, NM 87504-2088

State of New Mexico

Energy, Minerals and Natural Resources Department

Form C-101

Revised February 10, 1994

Instructions on back

Submit to Appropriate District Office

State Lease - 6 Copies

Fee Lease - 5 Copies

☐ AMENDED REPORT**OIL CONSERVATION DIVISION**

P.O. Box 2088

Santa Fe, New Mexico 87504-2088

APPLICATION FOR PERMIT TO DRILL, RE-ENTER, DEEPEN, PLUGBACK, OR ADD A ZONE

¹ Operator Name and Address TEXACO EXPLORATION & PRODUCTION INC. P.O. Box 3109, Midland Texas 79702		² OGRID Number 022351
		³ API Number 30-025-32769
⁴ Property Code 10926	⁵ Property Name WEST DOLLARHIDE DRINKARD UNIT	⁶ Well No. 112

⁷ Surface Location

Ul or lot no.	Section	Township	Range	Lot.Idn	Feet From The	North/South Line	Feet From The	East/West Line	County
L	32	24-S	38-E		1475	SOUTH	790	WEST	LEA

⁸ Proposed Bottom Hole Location If Different From Surface

Ul or lot no.	Section	Township	Range	Lot.Idn	Feet From The	North/South Line	Feet From The	East/West Line	County
⁹ Proposed Pool 1 DOLLARHIDE TUBB DRINKARD (18830)					¹⁰ Proposed Pool 2				

¹¹ Work Type Code N	¹² WellType Code O	¹³ Rotary or C.T. ROTARY	¹⁴ Lease Type Code S	¹⁵ Ground Level Elevation 3144'
¹⁶ Multiple No	¹⁷ Proposed Depth 7450'	¹⁸ Formation TUBB, DRINKARD, ABO	¹⁹ Contractor	²⁰ Spud Date 2/1/95

²¹ Proposed Casing and Cement Program

SIZE OF HOLE	SIZE OF CASING	WEIGHT PER FOOT	SETTING DEPTH	SACKS OF CEMENT	EST. TOP
12 1/4	8 5/8	24#	1170'	600 SACKS	SURFACE
7 7/8	5 1/2	15.5#, 17#	7450'	2000 SACKS	SURFACE

²² Describe the proposed program. If this application is to DEEPEN or PLUG BACK give the date on the present productive zone and proposed new productive zone. Describe the blowout prevention program, if any. Use additional sheets if necessary.

CEMENTING PROGRAM:

SURFACE CASING - 400 SACKS CLASS C w/4% GEL, 2% CACL2 (13.5 PPG, 1.74 CF/S, 9.1 GW/S). F/B 200 SACKS CLASS C w/ 2% CACL2 (14.8, 1.34 CF/S, 6.3 GW/S).

PRODUCTION CASING - 1500 SACKS 35/65 POZ CLASS H w/ 6% GEL, 5% SALT, 1/4# FLOCELE (12.8 PPG, 1.94 CF/S, 10.4 GW/S). F/B 500 SACKS CLASS H (15.6 PPG, 1.18 CF/S, 5.2 GW/S).

UNORTHODOX LOCATION: EXCEPTION HAS BEEN APPLIED FOR. (COPY ATTACHED)

OXY OPERATES A WELL IN THIS QUARTER QUARTER SECTION AND HAS BEEN FURNISHED A COPY OF THIS APPLICATION.

NSL-3441

²³ I hereby certify that the rules and regulations of the Oil Conservation Division have been complied with and that the information given above is true and complete to the best of my knowledge and belief.

Signature

C. Wade Howard

Printed Name

C. Wade Howard

Title

Eng. Assistant

Date

12/9/94

Telephone

688-4606

OIL CONSERVATION DIVISION

Approved By: **ORIGINAL SIGNED BY JERRY SEXTON**
DISTRICT I SUPERVISOR

Title:

Approval Date: **DEC 12 1994**

Expiration Date:

Conditions of Approval:

Attached ☐

Permit Expires 6 Months From Approval
Date Unless Drilling Underway.

RECEIVED

DEC 09 1994
OCD HOBBS
OFFICE

Submit to Appropriate
District Office
State Lease - 4 copies
Fee Lease - 3 copies

State of New Mexico
Energy, Minerals and Natural Resources Department

Form C-102
Revised 1-1-89

OIL CONSERVATION DIVISION

P.O. Box 2088

Santa Fe, New Mexico 87504-2088

DISTRICT I

P.O. Box 1980, Hobbs, NM 88240

DISTRICT II

P.O. Drawer DD, Artesia, NM 88210

DISTRICT III

1000 Rio Brazos Rd., Aztec, NM 87410

Operator TEXACO EXPLORATION & PRODUCTION INC. (022351)		Lease WEST DOLLARHIDE DRINKARD UNIT (10926)		Well No. 112
Unit Letter L	Section 32	Township 24-SOUTH	Range 38-EAST NMPM	County LEA

Actual Footage Location of Well:

1475.0 feet from the SOUTH line and		790.0 feet from the WEST line	
Ground Level Elev. 3144'	Producing Formation TUBB DRINKARD (DRINKARD) (ABO)	Pool DOLLARHIDE TUBB DRINKARD (18830)	Dedicated Acreage: 40 Acres

- Outline the acreage dedicated to the subject well by colored pencil or hatchure marks on the plat below.
- If more than one lease is dedicated to the well, outline each and identify the ownership thereof (both as to working interest and royalty).
- If more than one lease of different ownership is dedicated to the well, have the interest of all owners been consolidated by communitization, unitization, force-pooling, etc.?
☐ Yes ☐ No If answer is "yes" type of consolidation _____

If answer is "no" list of owners and tract descriptions which have actually been consolidated. (Use reverse side of this form necessary.)

No allowable will be assigned to the well unit all interests have been consolidated (by communitization, unitization, forced-pooling, otherwise) or until a non-standard unit, eliminating such interest, has been approved by the Division.

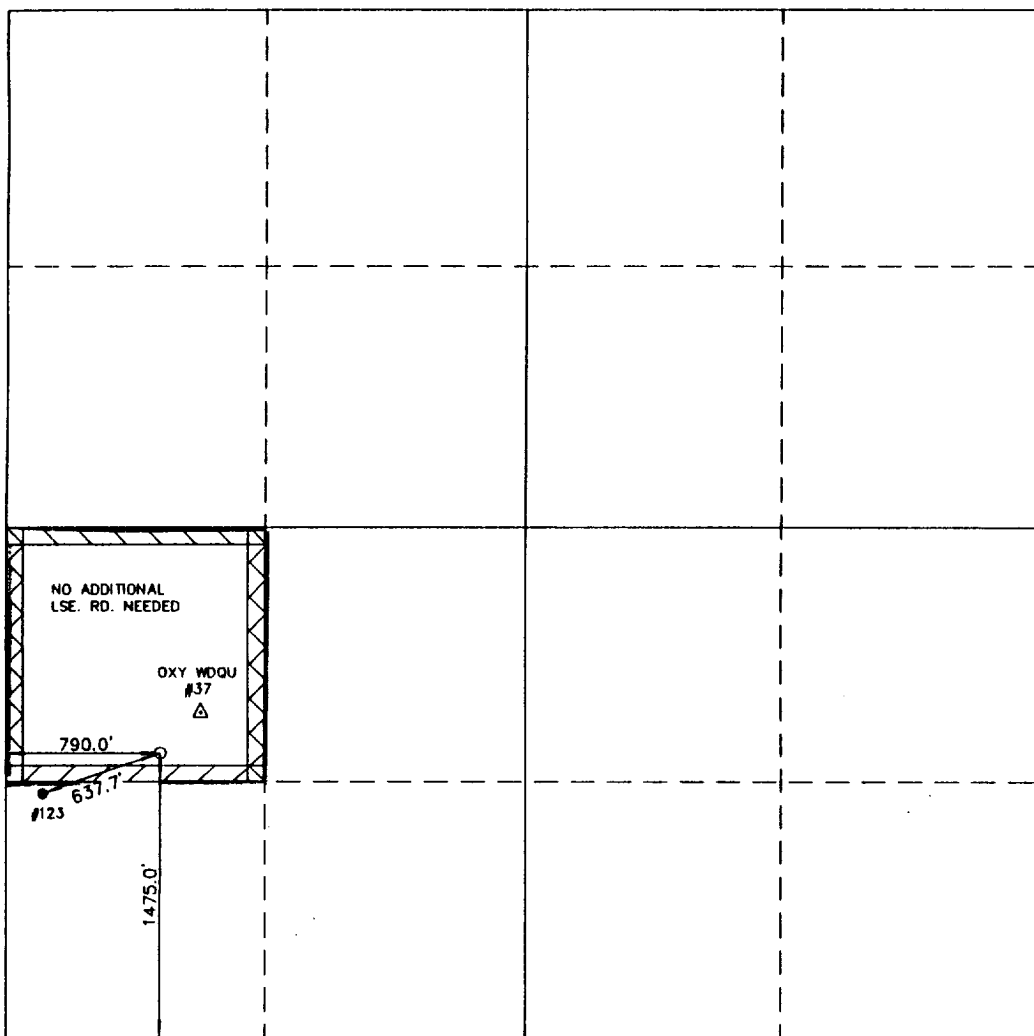

OPERATOR CERTIFICATION

I hereby certify the the information contained herein is true and complete to the best of my knowledge and belief.

Signature
C. Wade Howard
Printed Name
C. WADE HOWARD
Position
ENGR'S. ASSISTANT
Company
TEXACO Expl. + Prod. Inc.
Date
11-21-94

SURVEYOR CERTIFICATION

I hereby certify that the well location shown on this plat was plotted from field notes of actual surveys made by me or under my supervision, and that the same is true and correct to the best of my knowledge and belief.

Date Surveyed
11-15-94
Signature & Seal of Professional Surveyor
[Signature]
Certificate No.
4882

RECEIVED

1994

PROBBS
OFFICE

**DRILLING CONTROL
CONDITION II-B 3000 WP
FOR AIR DRILLING OR
WHERE NITROGEN OR AIR BLOWS ARE EXPECTED**

H₂S TRIM REQUIRED
YES X NO

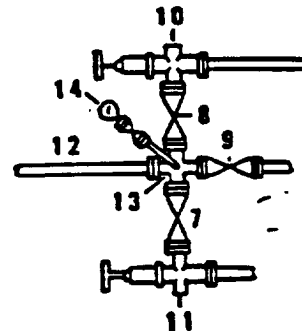
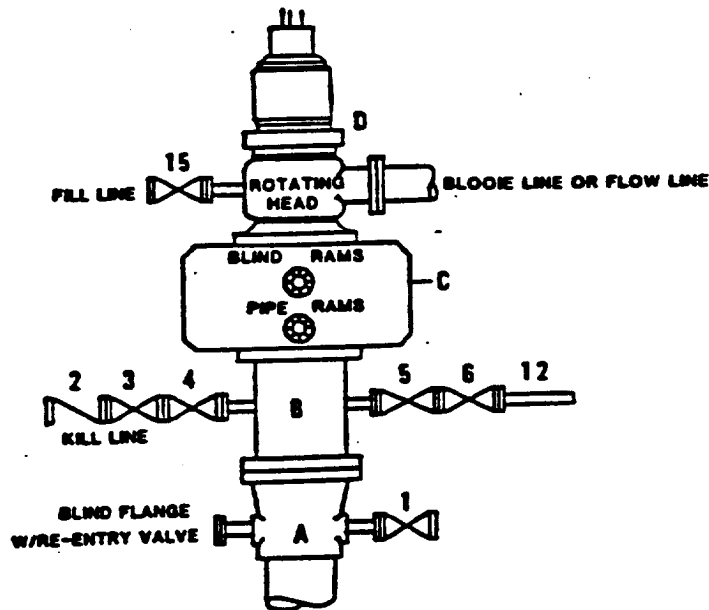

DRILLING CONTROL

MATERIAL LIST - CONDITION II - B

- A Texaco Wellhead
- B 3000# W.P. drilling spool with a 2" minimum flanged outlet for kill line and 3" minimum flanged outlet for choke line.
- C 3000# W.P. Dual ram type preventer, hydraulic operated with 1" steel, 3000# W.P. control lines (where sub-structure height is adequate, 2 - 3000# W.P. single ram type preventers may be utilized).
- D Rotating Head with fill up outlet and extended Blooe line.
- 1,3,4, 7,8. 2" minimum 3000# W.P. flanged full opening steel gate valve, or Halliburton Lo Torc Plug valve.
- 2 2" minimum 3000# W.P. back pressure valve.
- 5,6,9 3" minimum 3000# W.P. flanged full opening steel gate valve, or Halliburton Lo Torc Plug valve.
- 12 3" minimum schedule 80, Grade "B", seamless line pipe.
- 13 2" minimum x 3" minimum 3000# W.P. flanged cross.
- 10,11 2" minimum 3000# W.P. adjustable choke bodies.
- 14 Cameron Mud Gauge or equivalent (location optional in choke line).
- 15 2" minimum 3000# W.P. flanged or threaded full opening steel gate valve, or Halliburton Lo Torc Plug valve.



TEXACO, INC.
MIDLAND DIVISION
MIDLAND, TEXAS



SCALE	DATE	EST. NO.	DRG. NO.
DRAWN BY			
CHECKED BY			
APPROVED BY			

EXHIBIT C

RECEIVED

1994

O C D HOBBS
OFFICE



November 30, 1994

GOV - STATE AND LOCAL GOVERNMENTS

Unorthodox Locations

West Dollarhide Drinkard Unit
Well Nos. 109, 110, 111, 112, 148,
and 149
Lea County, New Mexico

State of New Mexico
Energy and Minerals Department
Oil Conservation Division
P. O. Box 2088
Santa Fe, New Mexico 87501-2088

Attention: Mr. Michael E. Stogner

Gentlemen:

An exception, by administrative approval, to Rule 104 F.I. is requested for Texaco Exploration and Production Inc.'s West Dollarhide Drinkard Unit Well Nos. 109, 110, 111, 112, 148, and 149. The wells are located as follows:

Well No. 109:	1500' FSL & 525' FEL,	Sec.32, T-24-S, R-38-E
Well No. 110:	2630' FSL & 1945' FEL,	Sec.32, T-24-S, R-38-E
Well No. 111:	1360' FSL & 2055' FWL,	Sec.32, T-24-S, R-38-E
Well No. 112:	1475' FSL & 790' FWL,	Sec.32, T-24-S, R-38-E
Well No. 148:	2530' FSL & 1150' FEL,	Sec.31, T-24-S, R-38-E
Well No. 149:	165' FSL & 165' FWL,	Sec.32, T-24-S, R-38-E

The wells must be drilled in these locations to ensure proper development on 10-acre spacing. Wells drilled previously on 10-acre spacing have proven to be viable wells. These wells will be producing wells completed in the Drinkard/Abo formation.

It should be noted that there are no affected offset operators to Well Nos. 109, 110, 111, 112, or 149. The affected offset operator to Well No. 148 is Texaco Exploration and Production Inc. and we grant ourselves a waiver to this request.

Attached are Forms C-102 for each well and a lease plat showing the existing wells, and locations of the subject wells.

Yours very truly,

J. A. Head
Asset Team Manager

CWH:cwh
cc: NMOCD, P. O. Box 1980, Hobbs, NM 88240

3560000.

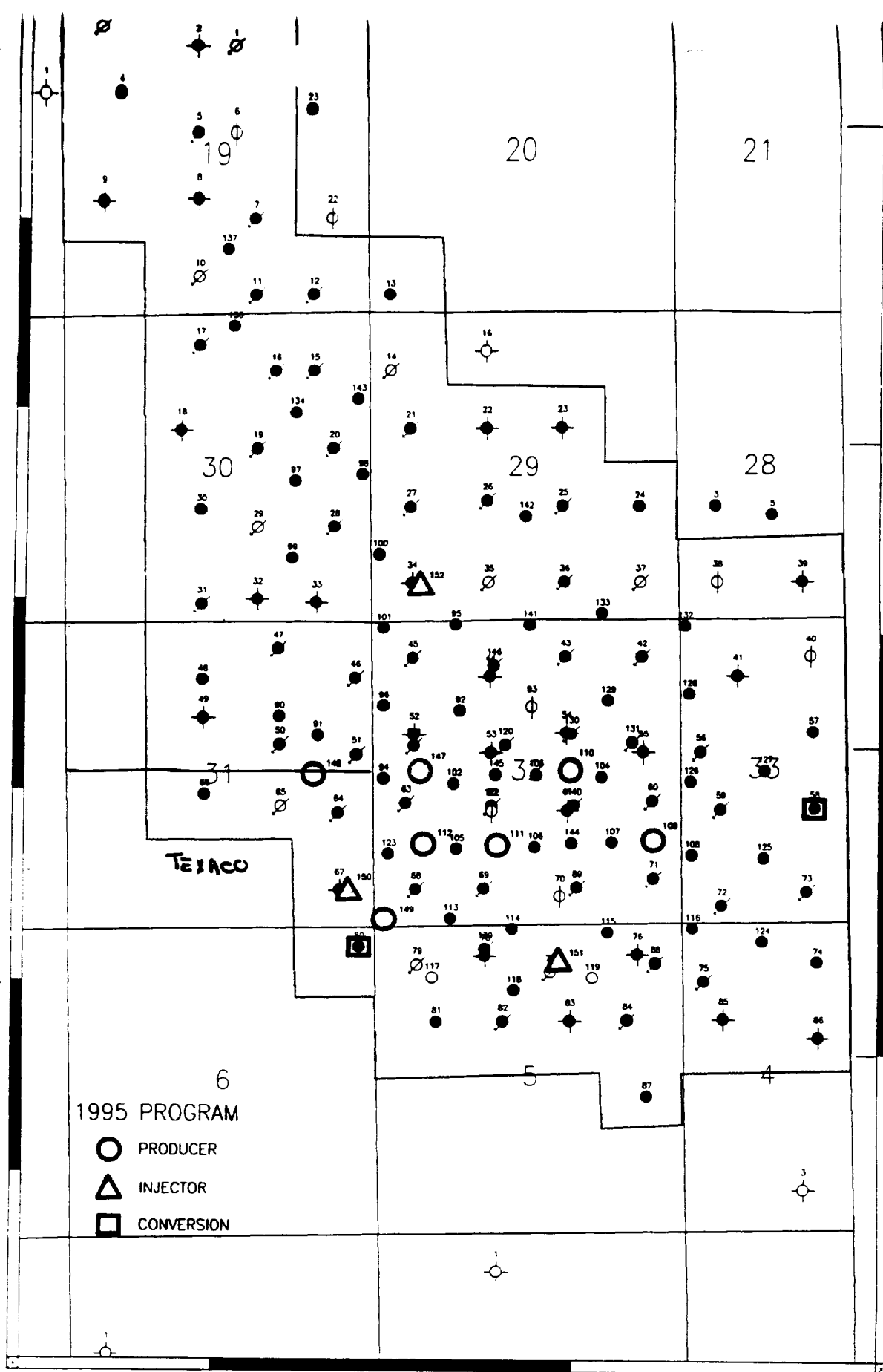

32.200

-103.100

6
1995 PROGRAM

- PRODUCER
- △ INJECTOR
- CONVERSION

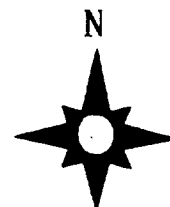

Scale 1:29713.32

LEGEND	
●	Oil Producer
▲	Water Injector
⊕	Shut-in Producer
□	Conversion

TEXACO E & P, INC.
WEST DOLARHIDE DRINKARD UNIT

0 1000 2000 3000 4000 5000 Feet

5/11/45

173

RECEIVED

SEP 10 1994

OCD HOBBS
OFFICE

STANDARD FORM NO. 64
MAY 1962 EDITION
GSA GEN. REG. NO. 27