

Form 3180-3

(December 1990)

SUBMIT IN TRIPLICATE

OPER. OGRID NO. 22351 MISSIONPROPERTY NO. 10942 CO 88240DEPAR
BUREAUPOOL CODE 35290EFF. DATE 4/16/96API NO. 30-025-33382 96

FORM APPROVED

Budget Bureau No. 1004-0138

Expires: December 31, 1991

5. Lease Designation and Serial No.

NM-10934

6. If Indian, Alottee or Tribe Name

7. If Unit or CA, Agreement Designation

8. Well Name and Number

C.C. FRISTOE "A" FEDERAL NCT-1

12

9. API Well No.

10. Field and Pool, Exploratory Area

JUSTIS BLINERY, JUSTIS TUBB DRINKAR

11. SEC., T., R., M., or BLK. and Survey or Area

Sec. 35, Township 24-S, Range 37-E

12. County or Parish

LEA

13. State

NM

17. No. of Acres Assigned To This Well

40

20. Rotary or Cable Tools

R

22. Approx. Date Work Will Start

4/1/96

APPLICATION FOR PERMIT TO DRILL OR DEEPEN

1a. Type of Work

DRILL ☒DEEPEN ☐

1b. Type of Well

OIL
WELL ☒GAS
WELL ☐

OTHER

SINGLE ZONE ☒MULTIPLE ZONE ☐

2. Name of Operator

TEXACO EXPLORATION & PRODUCTION INC.

3. Address and Telephone No.

P.O. Box 3109, Midland Texas 79702

688-4006

4. Location of Well (Report location clearly and in accordance with any State requirements.)

At Surface

Unit Letter D : 990 Feet From The NORTH Line and 990 Feet From The WEST Line

At proposed prod. zone

SAME

14. Distance in Miles and Direction from Nearest Town or Post Office*

5 miles NE of JAL, NM

15. Distance From Proposed* Location to Nearest Property or Lease Line, Ft. (also to nearest drg. unit line, if any)

330'

16. No. of Acres in Lease

400

18. Distance From Proposed Location* to Nearest Well, Drilling, Completed or Applied For, On This Lease, Ft.

466'

19. Proposed Depth

6500'

21. Elevations (Show whether DF, RT, GR, etc.)

GR-3186'

22. Approx. Date Work Will Start

4/1/96

23.

PROPOSED CASING AND CEMENT PROGRAM

SIZE OF HOLE	GRADE, SIZE OF CASING	WEIGHT PER FOOT	SETTING DEPTH	QUANTITY OF CEMENT
* 11	WC50, 8 5/8"	24 #	1000'	525 SACKS - CIRCULATE
7 7/8	WC50, WC70, 5 1/2"	15.5 + 17 #	6500'	1400 SACKS - CIRCULATE

CEMENT PROGRAM:

SURFACE CSG: 325 SACKS CLASS 'C' w/4% GEL, 270 CC (13.5 PPG, 1.74 CF/S, 9.1 GW/S) F/B 200 SACKS CLASS 'C' w/270 CC (14.8 PPG, 1.34 CF/S, 6.3 GW/S).

PRODUCTION CSG: 1st STG: 700 SACKS 50/50 Poz 'H' w/2% GEL, 5% SALT, 1/4 # FC (14.2 PPG, 1.35 CF/S, 6.3 GW/S).

DV TOOL @ 4000': 2nd STG: 600 SACKS 35/65 Poz 'H' w/6% GEL, 5% SALT, 1/4 # FC (12.8 PPG, 2.14 CF/S, 11.9 GW/S) F/B 100 SACKS CLASS H (15.6 PPG, 1.18 CF/S, 5.2 GW/S)

THERE ARE NO OTHER OPERATORS IN THIS 1/4 1/4 SECTION.

ESTIMATED DRILLING DAYS: 4 DAYS. ESTIMATED COMPLETION DAYS: 15 DAYS SUBJECT TO

GENERAL REQUIREMENTS AND SPECIAL STIPULATIONS

ATTACHED

In Above Space Describe Proposed Program: If proposal is to deepen, give data on present productive zone and proposed new productive zone. If proposal is to drill or deepen directionally, give pertinent data on subsurface locations and measured true verticle depths. Give blowout preventer program, if any.

24. I hereby certify that the foregoing is true and correct

SIGNATURE

C. Wade Howard

TITLE

Eng. Assistant

DATE

3/4/96

TYPE OR PRINT NAME

C. Wade Howard

(This space for Federal or State office use)

PERMIT NO.

APPROVAL DATE

Application approval does not warrant or certify that the applicant holds legal or equitable title to those rights in the subject lease which would entitle the applicant to conduct operations thereon.

APPROVED BY Timothy P. O'Brien

TITLE

Acting

AREA MANAGER

DATE APR 11 1996

CONDITIONS OF APPROVAL, IF ANY:

Title 18 U.S.C. Section 1001, makes it a crime for any person knowingly and willfully to make to any department or agency of the United States any false, fictitious or fraudulent statements or representations as to any matter within its jurisdiction.

DISTRICT I
P. O. Box 1980, Hobbs, NM 88240

DISTRICT II
P. O. Drawer DD, Artesia, NM 88210

DISTRICT III
1000 Rio Brazos Rd., Aztec, NM 87410

DISTRICT IV
P. O. Box 2088, Santa Fe, NM 87504-2088

State of New Mexico
Energy, Minerals and Natural Resources Department

OIL CONSERVATION DIVISION

PO Box 2088
Santa Fe, NM 87504-2088

Form C-102
Revised February 10, 1994

Instructions on back

Submit to Appropriate District Office

State Lease-4 copies

Fee Lease-3 copies

☐ AMENDED REPORT

WELL LOCATION AND ACREAGE DEDICATION PLAT

¹ API Number 30-020-3332		² Pool Code 30200 35220		³ Pool Name Justis Blinbery & Justis Tubb Drinkard					
⁴ Property Code 10942		⁵ Property Name C. C. Fristoe "A" Federal NCT-1				⁶ Well Number 12			
⁷ GRID No. 22351		⁸ Operator Name TEXACO EXPLORATION & PRODUCTION, INC.				⁹ Elevation 3186'			
¹⁰ Surface Location									
UL or lot no. D	Section 35	Township 24-S	Range 37-E	Lot Idn	Feet from the 990'	North/South line North	Feet from the 990'	East/West line West	County Lea
¹¹ Bottom Hole Location If Different From Surface									
UL or lot no.	Section	Township	Range	Lot Idn	Feet from the	North/South line	Feet from the	East/West line	County
¹² Dedicated Acres 40		¹³ Joint or Infill		¹⁴ Consolidation Code		¹⁵ Order No.			

NO ALLOWABLE WILL BE ASSIGNED TO THIS COMPLETION UNTIL ALL INTERESTS HAVE BEEN CONSOLIDATED
OR A NON-STANDARD UNIT HAS BEEN APPROVED BY THE DIVISION.

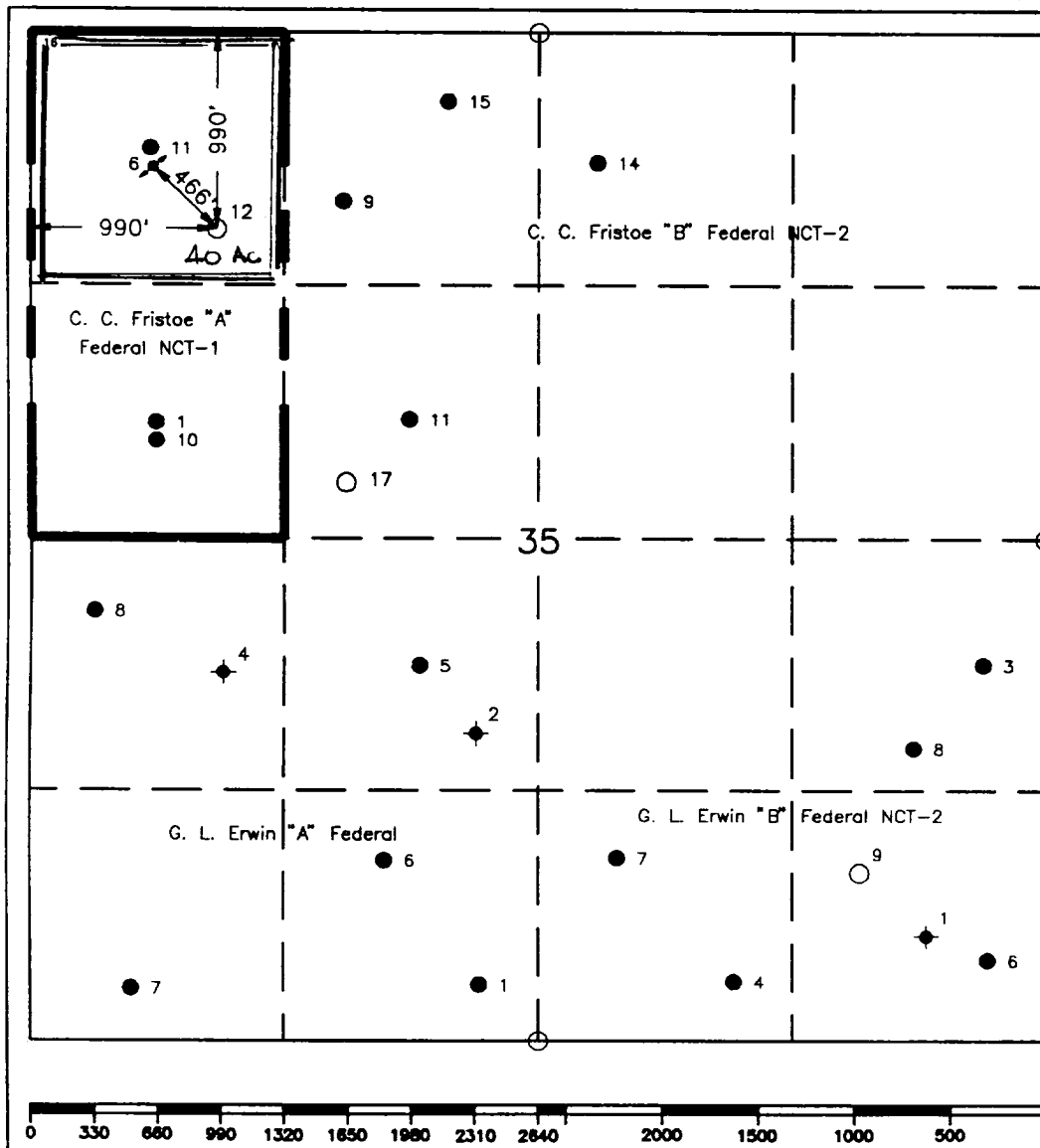

¹⁰ OPERATOR CERTIFICATION	
I hereby certify that the information contained herein is true and complete to the best of my knowledge and belief.	
Signature <i>C. Wade Howard</i>	
Printed Name C. Wade Howard	
Position Engineer's Assistant	
Company Texaco Expl. & Prod. Inc.	
Date March 4, 1996	
¹⁶ SURVEYOR CERTIFICATION	
I hereby certify that the well location shown on this plat was plotted from field notes of actual surveys made by me or under my supervision, and that the same is true and correct to the best of my knowledge and belief.	
Date Surveyed February 5, 1996	
Signature & Seal of Professional Surveyor <i>John S. Piper</i>	
Certificate No. 7254 John S. Piper	
Sheet 8 of 8	

OPERATOR - LANDOWNER AGREEMENT

COMPANY: TEXACO EXPLORATION AND PRODUCTION INC.

PROPOSED WELL: C.C. FRISTOE "A" FEDERAL NCT-1 No. 12

FEDERAL LEASE NUMBER: NM-10934

This is to advise that Texaco Exploration and Production Inc. has an agreement with:
EL PASO NATURAL GAS, P.O. BOX 1492, EL PASO, TX 79978,

the surface owner, concerning entry and surface restoration after completion of drilling operations at the above described well.

After abandonment of the well, all pits will be filled and levelled, and all equipment and trash will be removed from the well site. No other requirements were made concerning restoration of the well site.

3/4/96
Date

C. Wade Howard
C. W. Howard
Engineer's Assistant
Midland, Texas

DRILLING PROGRAM

C. C. FRISTOE 'A' FEDERAL NCT-1 WELL No. 12

SURFACE DESCRIPTION:

See Item 11 (other information) in the attached Surface Use and Operations Plan.

FORMATION TOPS: Estimated KB Elevation: 3186'

<u>Formation</u>	<u>Depth</u>	<u>Lithology</u>	<u>Fluid Content</u>
Rustler	940'	Anhy, Salt	----
Tansill	2270'	Anhy, Dolo	----
Yates	2470'	Sandstone, Anhy	----
Queen	3115'	Sandstone, Anhy	----
Blinebry	5100'	Dolomite, Anhy	Oil
Tubb	5830'	Sandstone	Oil
Drinkard	6020'	Dolomite, Anhy	Oil
Abo	6260'	Dolo, Limestone	Oil

The base of the salt section is the top of the Tansill at 2270'. No abnormal pressures or temperatures are anticipated to be encountered in this well. H2S is present in the Blinebry. H2S RADIUS OF EXPOSURE: 100ppm = 26', 500ppm = 12', based on 300ppm H2S and 380 MCF (see attached H2S Drilling Operations Plan. H2S equipment to be operational prior to drilling out Surface Casing Shoe.)

PRESSURE CONTROL EQUIPMENT:

A 3000 psi Dual Ram type preventer with rotating head will be used. (See Exhibit C). We do not plan to have an annular preventer. We will be able to achieve full closure of the well with the double ram preventer. It will be installed after surface casing is set. BOP will be tested each time it is installed on a casing string and at least every 29 days, and operated at least once each 24-hour period during drilling.

A PVT system will not be installed. We will be drilling thru the reserve pit and will circulate the steel pits one hour each tour to check for gains and losses and will be noted on the driller's log, which is Texaco's policy.

We do not plan to run an automatic remote-controlled choke. We will have installed and tested two manual, H2S trimmed, chokes.

CASING AND CEMENT PROGRAM:

The casing and cementing programs are detailed on Form 3160-3. All casing will be new.

Centralizer Program:

Surface Casing - Centralize the bottom 3 joints and every 4th to surface.

Production Casing - Centralize every 3rd joint on bottom 2000'.

MUD PROGRAM:

<u>Depth</u>	<u>Type</u>	<u>Weight</u>	<u>Viscosity</u>
0'-1000'	Fresh Water	8.4	28
1000'-4000'	Brine	10.0	29
4000'-6500'	Brine/Starch	10.0	32-36

Bottom Hole Pressure at T.D. estimated to be 6.7 PPG EMW (2265 psi).

LOGGING, TESTING:

GR-CNL-LDT, GR-DLL-MSFL, and GR-Sonic surveys will be run.

No Mud Logging Unit will be used.

No drill stem tests will be conducted.

No cores will be taken.

**DRILLING CONTROL
CONDITION II-B 3000 WP
FOR AIR DRILLING OR
WHERE NITROGEN OR AIR BLOWS ARE EXPECTED**

H₂S TRIM REQUIRED
YES ☒ NO ☐

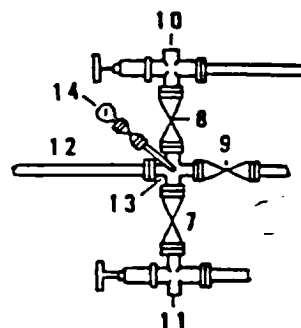
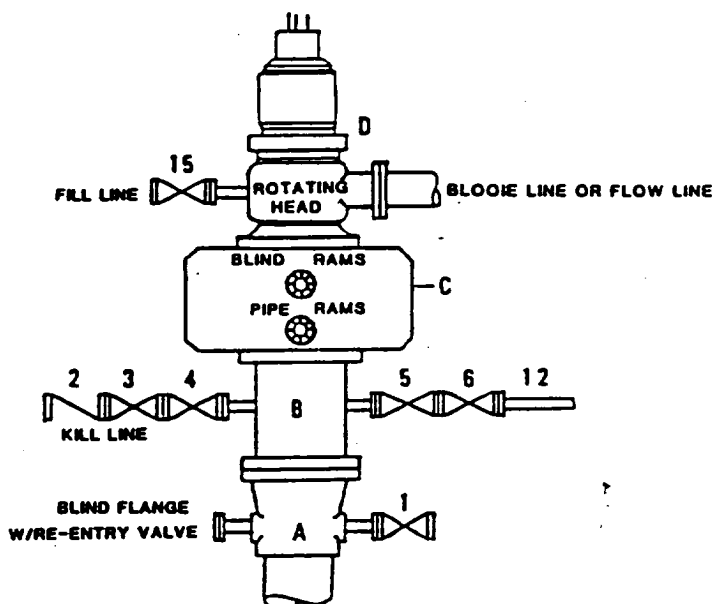

DRILLING CONTROL

MATERIAL LIST - CONDITION II - B

- | | |
|------------|--|
| A | Texaco Wellhead |
| B | 3000# W.P. drilling spool with a 2" minimum flanged outlet for kill line and 3" minimum flanged outlet for choke line. |
| C | 3000# W.P. Dual ram type preventer, hydraulic operated with 1" steel, 3000# W.P. control lines (where substructure height is adequate, 2 - 3000# W.P. single ram type preventers may be utilized). |
| D | Rotating Head with fill up outlet and extended Bleed Line. |
| 1,3,4,7,8, | 2" minimum 3000# W.P. flanged full opening steel gate valve, or Halliburton Lo Torc Plug valve. |
| 2 | 2" minimum 3000# W.P. back pressure valve. |
| 5,6,9 | 3" minimum 3000# W.P. flanged full opening steel gate valve, or Halliburton Lo Torc Plug valve. |
| 12 | 3" minimum schedule 80, Grade "B", seamless line pipe. |
| 13 | 2" minimum x 3" minimum 3000# W.P. flanged cross. |
| 10,11 | 2" minimum 3000# W.P. adjustable choke bodies. |
| 14 | Cameron Mud Gauge or equivalent (location optional in choke line). |
| 15 | 2" minimum 3000# W.P. flanged or threaded full opening steel gate valve, or Halliburton Lo Torc Plug valve. |



TEXACO, INC.
MIDLAND DIVISION
MIDLAND, TEXAS



SCALE	DATE	EST. NO.	DRG. NO.
DRAWN BY			
CHECKED BY			
APPROVED BY			

EXHIBIT C

66/5/6
173

Received
Hans
J. G.