

## DISTRICT I

P.O. Box 1980, Hobbs, NM 88241-1980

## DISTRICT II

P.O. Box Drawer DD, Artesia, NM 88211-0719

## DISTRICT III

1000 Rio Brazos Rd., Aztec, NM 87410

## DISTRICT IV

P.O. Box 2088, Santa Fe, NM 87504-2088

## State of New Mexico

Energy, Minerals and Natural Resources Department

Form C-101

Revised February 10, 1994

Instructions on back

Submit to Appropriate District Office

State Lease - 6 Copies

Fee Lease - 5 Copies

☐ AMENDED REPORT

## OIL CONSERVATION DIVISION

P.O. Box 2088

Santa Fe, New Mexico 87504-2088

## APPLICATION FOR PERMIT TO DRILL, RE-ENTER, DEEPEN, PLUGBACK, OR ADD A ZONE

<sup>1</sup> Operator Name and Address TEXACO EXPLORATION & PRODUCTION INC. 205 E. Bender, HOBBS, NM 88240		<sup>2</sup> OGRID Number 022351
<sup>4</sup> Property Code 11121	<sup>5</sup> Property Name UNITED ROYALTY 'A'	<sup>3</sup> API Number 30-025-33533
		<sup>6</sup> Well No. 5

<sup>7</sup> Surface Location

Ul or lot no.	Section	Township	Range	Lot.Idn	Feet From The	North/South Line	Feet From The	East/West Line	County
F	19	24-S	38-E		1980	NORTH	1980	WEST	LEA

<sup>8</sup> Proposed Bottom Hole Location If Different From Surface

Ul or lot no.	Section	Township	Range	Lot.Idn	Feet From The	North/South Line	Feet From The	East/West Line	County
<sup>9</sup> Proposed Pool 1 Dollarhide; Devonian					<sup>10</sup> Proposed Pool 2				

<sup>11</sup> Work Type Code N P	<sup>12</sup> Well Type Code O	<sup>13</sup> Rotary or C.T. ROTARY	<sup>14</sup> Lease Type Code P	<sup>15</sup> Ground Level Elevation 3183'
<sup>16</sup> Multiple No	<sup>17</sup> Proposed Depth 8836'	<sup>18</sup> Formation Dollahide; Devonian	<sup>19</sup> Contractor	<sup>20</sup> Spud Date 8/15/96

<sup>21</sup> Proposed Casing and Cement Program

SIZE OF HOLE	SIZE OF CASING	WEIGHT PER FOOT	SETTING DEPTH	SACKS OF CEMENT	EST. TOP
14 3/4	11 3/4	42#	1200'	700 SACKS	SURFACE
11	8 5/8	32#	4230'	1675 SACKS	SURFACE
7 7/8	5 1/2	17#	11322'	3215 SACKS	SURFACE

<sup>22</sup> Describe the proposed program. If this application is to DEEPEN or PLUG BACK give the data on the present productive zone and proposed new productive zone. Describe the blowout prevention program, if any. Use additional sheets if necessary.

- 1.) RUPU. Install BOP with 2-7/8" #4 round REDA rams. RIH with bit and scraper to +/-8920'. POH.
- 2.) TIH with 5-1/2" Cement retainer on 2-7/8" tubing. Set retainer at +/-8935'
- 3.) RU Dowell and establish circulation with 2% KCL. Pump 50 sks of high gel strength cement followed by 100 sks low fluid loss cement.
- 4.) Sting out of retainer and circulate clean. TOH with production string and WOC for 24 hrs.
- 5.) Rig Up perforators. Tag for fill. Perforate the following interval with 2 jsfpf, 120° phasing, with 4" carrier gun:  
Devonian: 8830' - 8836'
- 6.) RIH with 5-1/2" treating packer. Set at +/- 8815'.
- 7.) Open by-pass of packer and spot 2 bbls of 15% NEFE acid at the end of tubing.
- 8.) Once perforations are broke, open by-pass and spot 500 gallons of acid at the end of tubing with the minimum amount of tubing pressure.
- 9.) Close by-pass and matrix acidize the Devonian with the 500 gallons of acid not to exceed 1 bpm.
- 10.) TIH w/ tubing/ESP. Spot ~ 5 gals TH-3036 (corrosion inhibitor) Need a complete water analysis once we get the well back.

Permit Expires 1 Year From Approval  
Date Under a Drilling License

Plugback

<sup>23</sup> I hereby certify that the rules and regulations of the Oil Conservation Division have been complied with and that the information given above is true and complete to the best of my knowledge and belief.

Signature *M. Quintana*

Printed Name Mike Quintana

Title Engineering Assistant

Date 2/26/98

Telephone 397-0419

## OIL CONSERVATION DIVISION

ORIGINAL SIGNED BY

Approved By

Title:

Approval Date:

Expiration Date:

Conditions of Approval:

Attached ☐

## DISTRICT I

P.O. Box 1980, Hobbs, NM 88241-1980

## DISTRICT II

P.O. Box Drawer DD, Artesia, NM 88211-0719

## DISTRICT III

1000 Rio Brazos Rd., Aztec, NM 87410

## DISTRICT IV

P.O. Box 2088, Santa Fe, NM 87504-2088

## State of New Mexico

Energy, Minerals and Natural Resources Department

Form C-102

Revised February 10, 1994

Instructions on back

Submit to Appropriate District Office

State Lease - 4 Copies

Fee Lease - 3 Copies

## OIL CONSERVATION DIVISION

P.O. Box 2088

Santa Fe, New Mexico 87504-2088

☐ AMENDED REPORT

## WELL LOCATION AND ACREAGE DEDICATION PLAT

<sup>1</sup> API Number 30-025-33533	<sup>2</sup> Pool Code 18050	<sup>3</sup> Pool Name Dollardhide; Devonian
<sup>4</sup> Property Code 11121	<sup>5</sup> Property Name UNITED ROYALTY 'A'	<sup>6</sup> Well No. 5
<sup>7</sup> OGRID Number 022351	<sup>8</sup> Operator Name TEXACO EXPLORATION & PRODUCTION INC.	<sup>9</sup> Elevation 3183'

<sup>10</sup> Surface Location

UI or lot no.	Section	Township	Range	Lot.Idn	Feet From The	North/South Line	Feet From The	East/West Line	County
F	19	24-S	38-E		1980	NORTH	1980	WEST	LEA

<sup>11</sup> Bottom Hole Location If Different From Surface

UI or lot no.	Section	Township	Range	Lot.Idn	Feet From The	North/South Line	Feet From The	East/West Line	County

<sup>12</sup> Dedicated Acres 40	<sup>13</sup> Joint or Infill No	<sup>14</sup> Consolidation Code	<sup>15</sup> Order No.
-------------------------------------	-------------------------------------	----------------------------------	-------------------------

NO ALLOWABLE WILL BE ASSIGNED TO THIS COMPLETION UNTIL ALL INTERESTS HAVE BEEN CONSOLIDATED  
OR A NON-STANDARD UNIT HAS BEEN APPROVED BY THE DIVISION

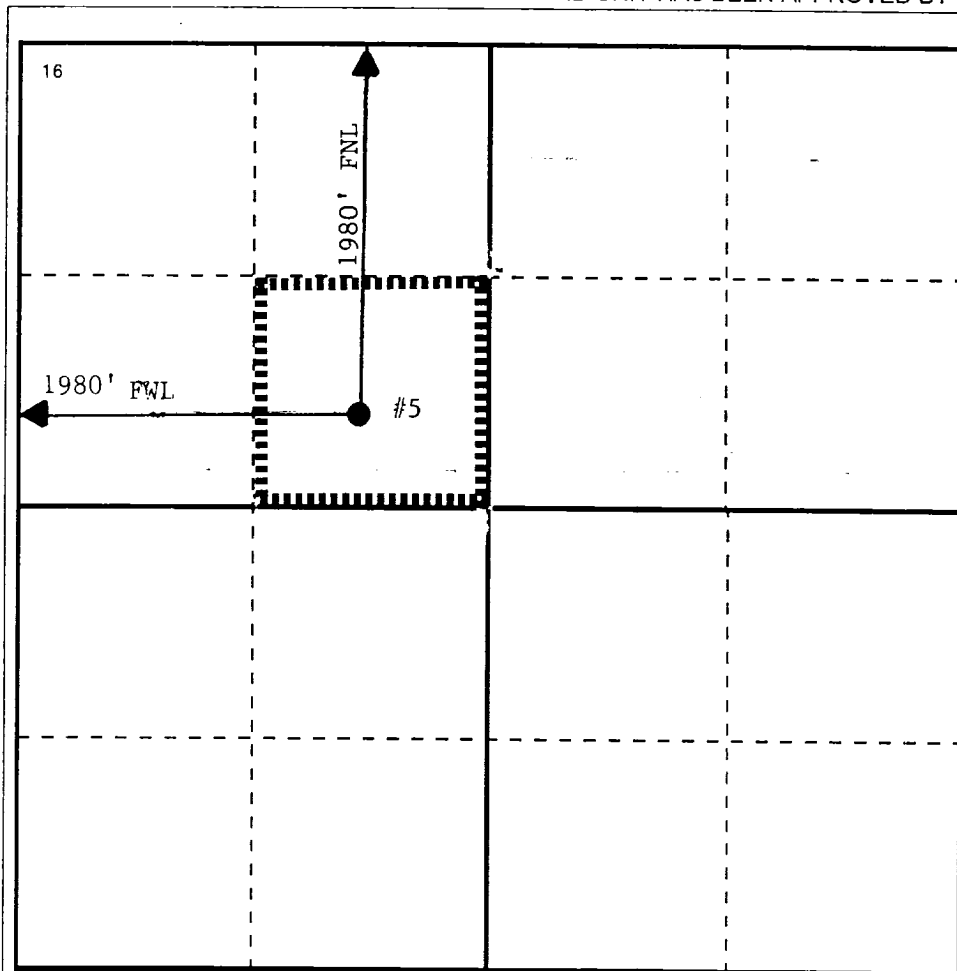

## 17 OPERATOR CERTIFICATION

I hereby certify that the information  
contained herein is true and complete to the  
best of my knowledge and belief

Signature

Printed Name

J. Denise Leake

Position

Engineering Assistant

Date

3/3/98

## 18 SURVEYOR CERTIFICATION

I hereby certify that the well location shown  
on this plat was plotted from field notes of  
actual surveys made by me or under my  
supervision, and that the same is true and  
correct to the best of my knowledge and  
belief.

Date Surveyed

Signature & Seal of  
Professional Surveyor

Certificate No.

