

DISTRICT I

P.O. Box 198C, Hobbs, NM 88241-1980

DISTRICT II

P.O. Box Drawer JD, Artesia, NM 88211-0719

DISTRICT III

1000 Rio Brazos Rd., Aztec, NM 87410

DISTRICT IV

P.O. Box 2088, Santa Fe, NM 87504-2088

State of New Mexico

Energy, Minerals and Natural Resources Department

Form C-101

Revised February 10, 199

Instructions on back

Submit to Appropriate District Office

State Lease - 6 Copies

Fee Lease - 5 Copies

☐ AMENDED REPORT

OIL CONSERVATION DIVISION

P.O. Box 2088

Santa Fe, New Mexico 87504-2088

APPLICATION FOR PERMIT TO DRILL, RE-ENTER, DEEPEN, PLUGBACK, OR ADD A ZONE

¹ Operator Name and Address		² OGRID Number
CHEVRON USA INC		4323
15 SMITH ROAD, MIDLAND, TX 79705		
⁴ Property Code	⁵ Property Name	³ API Number
11022	NEW MEXICO 'BZ' STATE NCT-10	30-025-33952
		⁶ Well No.
		7

⁷ Surface Location

UI or lot no.	Section	Township	Range	Lot.Idn	Feet From The	North/South Line	Feet From The	East/West Line	County
L	2	25-S	37-E		1700	SOUTH	330	WEST	LEA

⁸ Proposed Bottom Hole Location If Different From Surface

UI or lot no.	Section	Township	Range	Lot.Idn	Feet From The	North/South Line	Feet From The	East/West Line	County
⁹ Proposed Pool 1					¹⁰ Proposed Pool 2				
LANGLIE MATTIX SEVEN RIVERS QUEEN GRAYBURG									

¹¹ Work Type Code	¹² Well Type Code	¹³ Rotary or C.T.	¹⁴ Lease Type Code	¹⁵ Ground Level Elevation
P	O	ROTARY	S	3154'
¹⁶ Multiple	¹⁷ Proposed Depth	¹⁸ Formation	¹⁹ Contractor	²⁰ Spud Date
No	6650'	GRAYBURG		1/25/2003

²¹ Proposed Casing and Cement Program

SIZE OF HOLE	SIZE OF CASING	WEIGHT PER FOOT	SETTING DEPTH	SACKS OF CEMENT	EST. TOP
11	8 5/8	24#	944'	525 SACKS	SURFACE
7 7/8	4 1/2	11.6#	6650'	1400 SACKS	1600'

²² Describe the proposed program. If this application is to DEEPEN or PLUG BACK give the data on the present productive zone and proposed new productive zone. Describe the blowout prevention program, if any. Use additional sheets if necessary.

CHEVRON U.S.A. INC. INTENDS TO RECOMPLETE THE SUBJECT WELL IN THE GRAYBURG POOL. THE INTENDED PROCEDURE IS ATTACHED FOR YOUR APPROVAL.

²³ I hereby certify that the rules and regulations of the Oil Conservation Division have been complied with and that the information given above is true and complete to the best of my knowledge and belief.

Signature

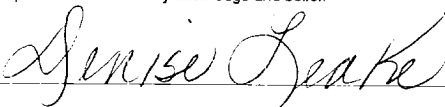

Printed Name

Denise Leake

Title

Regulatory Specialist

Date

1/16/2003

Telephone

915-687-7375

OIL CONSERVATION DIVISION

Approved By:

ORIGINAL SIGNED BY
PAUL E. KAUTZ
PETROLEUM ENGINEER

Title:

Approval Date:

Expiration Date:

Conditions of Approval:
Attached

JAN 22 2003

**New Mexico BZ State NCT-10 No. 7
Grayburg Completion Procedure
Lea County, New Mexico**

*Langley Mottix
7 Nov. 2000
Grayburg*

API NO: 30-025-33952

Well: New Mexico BZ State NCT-10 No. 7

WBS Number(s): UWPNM- \$
UWPNM- \$
UWPNM- \$

Well Location:

Section: 2 Township: 25S Range: 37E

Surface Location: 1700' FSL & 330' FWL

Lea County, New Mexico

Current Status:

Status: TA

Production:

Formation: Tubb-Drinkard

Objectives

1. Perforate Grayburg and break down with acid.
2. Swab test the Grayburg to determine fluid entry rate.
3. Fracture stimulate Grayburg and swab test.
4. Run production equipment and turn well over to operations.

Procedure

NOTE: Use 2% KCL water for all operations.

1. MIRU PU. NDWH. NU BOP and EPA. Pressure test BOP to 1,500 psi.
2. PU and RIH with 3-7/8" bit on a 2-3/8" tubing and CO to PBTD @ 5200'. Circulate hole clean using 2% KCL water. Pull up to 3575' and spot 500 gal 15% HCL. POOH with tubing.
3. MIRU Baker Atlas. Tie into Schlumberger CNL/GR/CCL dated 7/28/97. Perforate the following intervals using Baker's 3-1/8" Slick Guns loaded with 4 SPF, premium charge, at 120° phasing:

3,541' – 3,546'
3,551' – 3,574
4. PU and RIH with 4-1/2" Treating PKR, on/off tool, profile nipple on 2-3/8" tubing, while hydrotesting to 3,000 psi. Set PKR @ +/- 3,480'.
5. MIRU Schlumberger. Perform acid stimulation as follows:

New Mexico BZ State NCT-1 No. 7
Grayburg Completion Procedure
Lea County, New Mexico

API NO: 30-025-33952

Acid Treatment:

Acid stimulate with **2,000 gallons of 15% HCL** at **4-5 BPM** and **3,500 PSI** maximum treating pressure using **180 - 7/8", 1.3 SG. ball sealers** for diversion. See Fluid Specifications.

- Hold pre-job safety meeting. Pressure test lines to 5,000 psi. Pressure annulus to 500 psi. Monitor and record annulus pressure throughout the job.

Pump job as follows:

Stage 1: Pump 500 gallons of 15% HCL and then start dropping 7/8", 1.3 SG. ball sealers continuously throughout the remainder of the acid job. Overflush with 23 bbls of 2% KCL water. Surge off ball sealers.

Record ISIP, 5, 10 and 15 min. SIP. Wait 2 hrs (at least 1 hr and maximum 3 hrs).

6. RDMO Schlumberger. Send job data files to the following e-mail addresses:
wakefms@ChevronTexaco.com
7. Swab or Flow back acid load (+/- 95 bbls) into frac tank catching samples from the well for Schlumberger analysis. Record recovered volumes, pressures, and fluid levels. If well flows, set plug in profile, release on/off tool, displace annulus with packer fluid, sting back into on/off tool. ND BOP. NWH. RIH and swab FL in tubing until differential across plug is balanced. Retrieve plug & swab well to initiate flow (if needed). RDMO PU. Skip step 8.
8. If well does not flow, prepare well for fracture stimulation. Design to be determined from results of acid job.
9. Turn over to Operations. Report daily oil and water volume produced and fluid level until well stabilizes.

Mark S. Wakefield
January 14, 2003

**New Mexico BZ State NCT-1 No. 7
Grayburg Completion Procedure
Lea County, New Mexico**

API NO: 30-025-33952

Fluid Specifications

Acid Stimulation:

15% HCL Acid

1.00 gal/mgal	A264 (Corrosion Inhibitor)
8.00 gal/mgal	L63 (Iron Reducing Agent)
3.00 lbm/mgal	A179 (Corrosion Inhibitor Aid)
2.00 gal/mgal	W53 (Non-emulsifying Agent)
20.00 gal/mgal	U66 (Mutual Solvent)

New Mexico BZ State NCT-11 No. 7
Grayburg Completion Procedure
Lea County, New Mexico

API NO: 30-025-33952

Contact Names and Numbers

	Office	
	Home	
	Cellular	
Mark Wakefield	Production Engineer, Midland	
	Office	(915) 687-7287
	Home	(915) 520-0167
Cory Hoffman	Geologist, Midland	
	Office	(915) 687-7267
	Home	(915) 699-6544
	Cellular	(915) 559-3741
Nathan Mouser	Operations Supervisor, Eunice	
	Office	(505) 394-1247
	Cellular	(505) 390-7192
	Home	(505) 392-4188
Bobby McCurry	Artificial lift Specialist, Eunice	
	Office	(505) 394-1229
	Cellular	(505) 631-9127
Felix Trevino	Artificial lift Specialist, Eunice	
	Office	(505) 394-1245
	Cellular	(505) 390-7180
Larry Williams	MP2 Planner, Eunice	
	Office	(505) 394-1221
	Cellular	(505) 390-7165
Rick Massey	Safety Specialist, Eunice	
	Office	(505) 394-1237
	Cellular	(505) 390-7188

DISTRICT I

P.O. Box 1980, Hobbs, NM 88241-1980

DISTRICT II

P.O. Box Drawer DD, Artesia, NM 88211-0719

DISTRICT III

1000 Rio Brazos Rd., Aztec, NM 87410

DISTRICT IV

P.O. Box 2088, Santa Fe, NM 87504-2088

State of New Mexico
Energy, Minerals and Natural Resources Department

Form C-102

Revised February 10, 1999

Instructions on back

Submit to Appropriate District Office

State Lease - 4 Copies

Fee Lease - 3 Copies

☐ AMENDED REPORT

OIL CONSERVATION DIVISION

P.O. Box 2088

Santa Fe, New Mexico 87504-2088

WELL LOCATION AND ACREAGE DEDICATION PLAT

¹ API Number 30-025-33952	² Pool Code 37240	³ Pool Name LANGLIE MATTIX 7 RVR QUEEN GRAYB JRG
⁴ Property Code 29969	⁵ Property Name NEW MEXICO 'BZ' STATE NCT-10	⁶ Well No. 7
⁷ OGRID Number 4323	⁸ Operator Name CHEVRON USA INC	⁹ Elevation 3154'

¹⁰ Surface Location

Ul or lot no	Section	Township	Range	Lot.Idn	Feet From The	North/South Line	Feet From The	East/West Line	County
L	2	25-S	37-E		1700	SOUTH	330	WEST	LEA

¹¹ Bottom Hole Location If Different From Surface

Ul or lot no.	Section	Township	Range	Lot.Idn	Feet From The	North/South Line	Feet From The	East/West Line	County

¹² Dedicated Acre 40	¹³ Joint or Infill No	¹⁴ Consolidation Code	¹⁵ Order No.
------------------------------------	-------------------------------------	----------------------------------	-------------------------

NO ALLOWABLE WILL BE ASSIGNED TO THIS COMPLETION UNTIL ALL INTERESTS HAVE BEEN CONSOLIDATED
OR A NON-STANDARD UNIT HAS BEEN APPROVED BY THE DIVISION

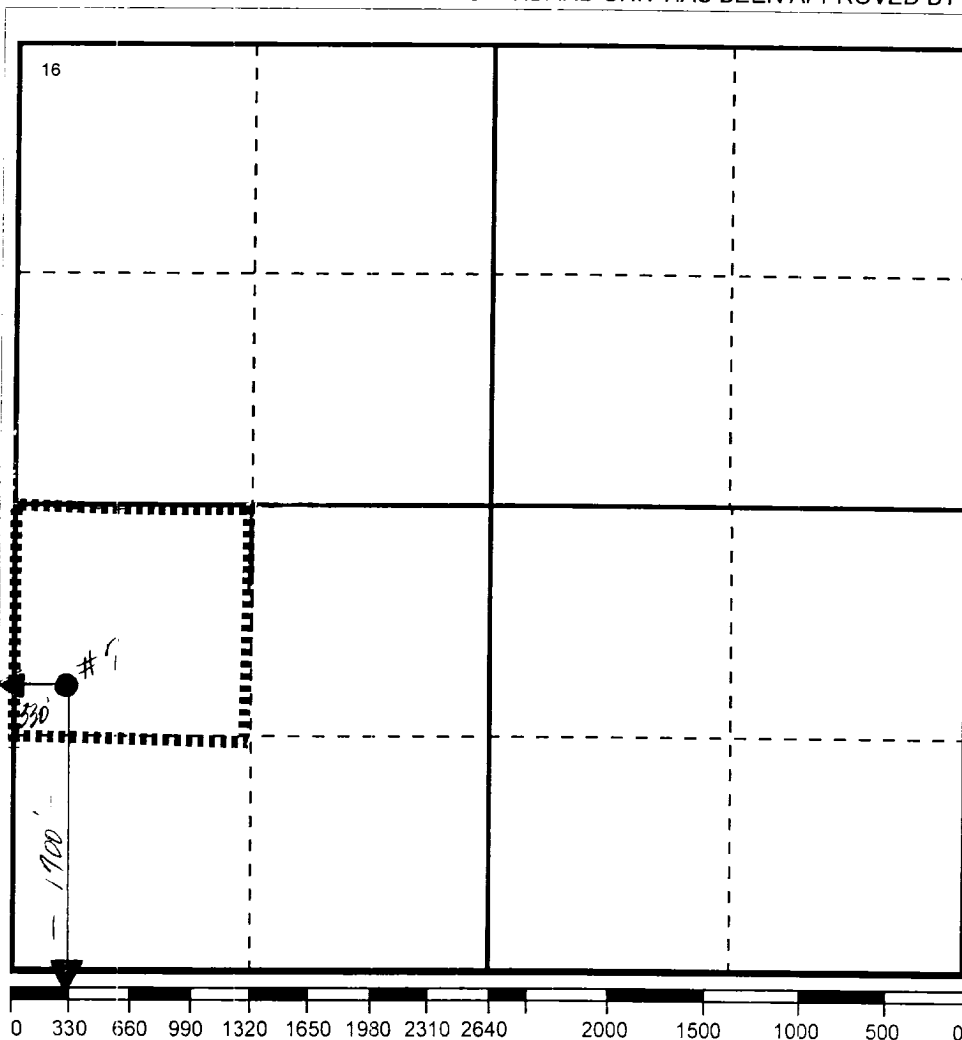
¹⁷ OPERATOR CERTIFICATION

I hereby certify that the information contained herein is true and complete to the best of my knowledge and belief.

Signature

Denise Leake

Printed Name

Denise Leake

Position

Regulatory Specialist

Date

1/16/2003

¹⁸ SURVEYOR CERTIFICATION

I hereby certify that the well location shown on this plat was plotted from field notes of actual surveys made by me or under my supervision, and that the same is true and correct to the best of my knowledge and belief.

Date Surveyed

Signature & Seal of

Professional Surveyor

Certificate No.