

DISTRICT I
P. O. Box 1980, Hobbs, NM 88240

DISTRICT II
P. O. Drawer DD, Artesia, NM 88210

DISTRICT III
1000 Rio Brazos Rd., Aztec, NM 87410

DISTRICT IV
P. O. Box 2088, Santa Fe, NM 87504-2088

State of New Mexico
Energy, Minerals and Natural Resources Department

Form C-102
Revised February 10, 1994

Instructions on back

OIL CONSERVATION DIVISION

PO Box 2088
Santa Fe, NM 87504-2088

Submit to Appropriate District Office

State Lease-4 copies
Fee Lease-3 copies

☐ AMENDED REPORT

WELL LOCATION AND ACREAGE DEDICATION PLAT

API Number 30-025-35991	Pool Code 37240	Well Name Langlie Mathis, TP-Q* Grayburg, San Andres
Property Code 29915	Property Name C. C. Fristoe "A" Federal NCT-1	Well Number 14
GRID No. 223514323	Operator Name Chevron USA Inc.	Elevation 3192'

10 Surface Location									
UL or lot no. D	Section 35	Township 24-S	Range 37-E	Lot Idn	Feet from the 660'	North/South line North	Feet from the 330'	East/West line West	County Lea

11 Bottom Hole Location If Different From Surface									
UL or lot no.	Section	Township	Range	Lot Idn	Feet from the	North/South line	Feet from the	East/West line	County
12 Dedicated Acres 40		13 Joint or Infill		14 Consolidation Code		15 Order No.			

NO ALLOWABLE WILL BE ASSIGNED TO THIS COMPLETION UNTIL ALL INTERESTS HAVE BEEN CONSOLIDATED
OR A NON-STANDARD UNIT HAS BEEN APPROVED BY THE DIVISION.

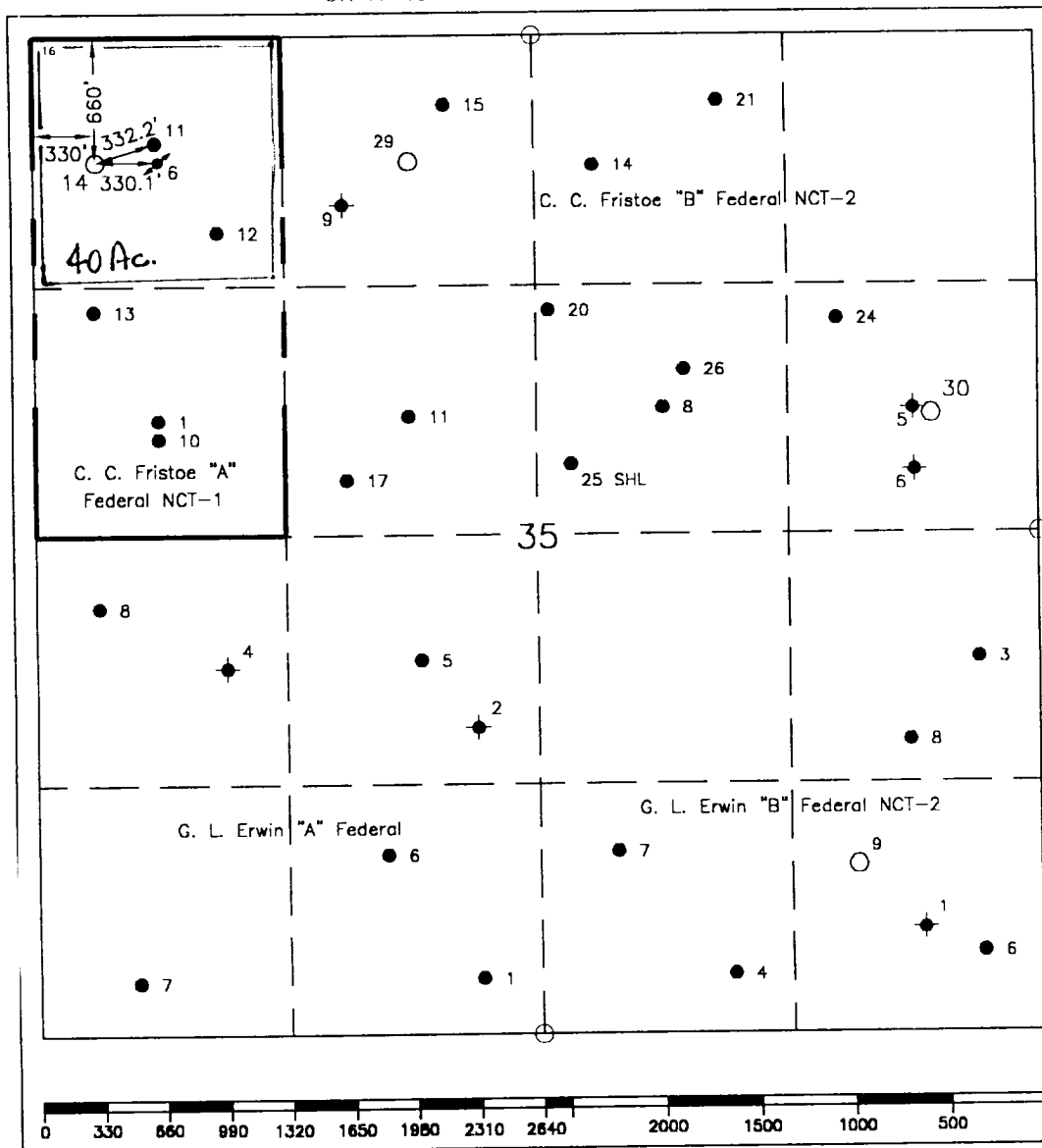

16 OPERATOR CERTIFICATION	
I hereby certify that the information contained herein is true and complete to the best of my knowledge and belief.	
Signature <i>Ted Tipton</i>	Printed Name Ted Tipton
Position Manager of Drilling Department	
Company Chevron USA Inc.	
Date June 7, 2002	
17 SURVEYOR CERTIFICATION	
I hereby certify that the well location shown on this plat was plotted from field notes of actual surveys made by me or under my supervision, and that the same is true and correct to the best of my knowledge and belief.	
Date Surveyed June 4, 2002	
Signature & Seal of Professional Surveyor <i>John S. Piper</i>	
Certificate No. 7254 John S. Piper	
Sheet 1 of 1	

○ = Staked Location • = Producing Well ✕ = Injection Well ✕ = Water Supply Well ✕ = Plugged & Abandon Well
⊙ = Found Section Corner, 2 or 3" Iron Pipe & GLO B.C. ○ = Found 1/4 Section Corner, 1" Iron Pipe & GLO B.C.

ADDITIONAL INFORMATION ON THE LOCATION

State Plane Coordinates	
Northing 431011.33 (1927=430953.94)	Easting 910187.36 (1927=868999.87)
Latitude 32°10'45.514" (1927=32°10'45.070")	
Longitude 103°08'28.179" (1927=103°08'26.531")	
Zone North American Datum	Combined Grid Factor
East 1983	0.99991402
Drawing File	Coordinate File
Fris A14.dwa	Erwin83.cr5
Field Book	
Lea Co. #20, Pg. 80	