

NEW MEXICO OIL CONSERVATION COMMISSION
WELL LOCATION AND ACREAGE DEDICATION PLAT

Form C-102
Supersedes C-128
Effective 1-1-65

All distances must be from the outer boundaries of the Section.

Operator Southwestern Natural Gas, Inc.		Lease Arco State		Well No. 2
Unit Letter J	Section 4	Township 8 South	Range 33 E	County Chaves
Actual Footage Location of Well: 2310 feet from the south line and 1980 feet from the east line				
Ground Level Elev. 4418'	Producing Formation San Andres	Pool Chaveroo	Dedicated Acreage: 40 Acres	

1. Outline the acreage dedicated to the subject well by colored pencil or hachure marks on the plat below.
2. If more than one lease is dedicated to the well, outline each and identify the ownership thereof (both as to working interest and royalty).
3. If more than one lease of different ownership is dedicated to the well, have the interests of all owners been consolidated by communitization, unitization, force-pooling, etc?

☒ Yes ☐ No If answer is "yes," type of consolidation Farmout of Leasehold

If answer is "no," list the owners and tract descriptions which have actually been consolidated. (Use reverse side of this form if necessary.) _____

No allowable will be assigned to the well until all interests have been consolidated (by communitization, unitization, forced-pooling, or otherwise) or until a non-standard unit, eliminating such interests, has been approved by the Commission.

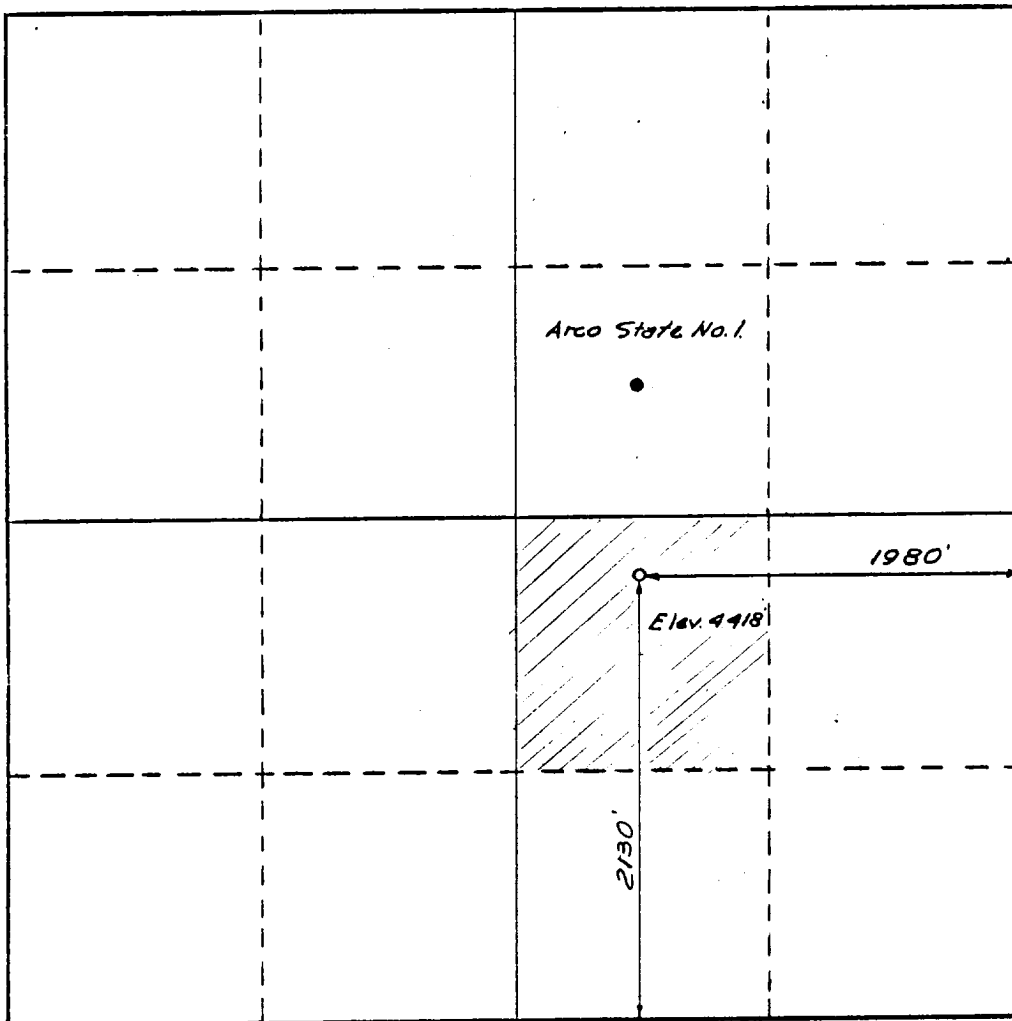

CERTIFICATION

I hereby certify that the information contained herein is true and complete to the best of my knowledge and belief.

Name J. E. Dunbar
Position
Geologist
Company
Southwestern Natural Gas, Inc.
Date
May 25, 1968

I hereby certify that the well location shown on this plat was plotted from field notes of actual surveys made by me or under my supervision, and that the same is true and correct to the best of my knowledge and belief.

April 18, 1968

Date Surveyed
Kenneth E. Somers
Registered Professional Engineer
and/or Land Surveyor

1411

Certificate No.