

NO. OF COPIES RECEIVED	
DISTRIBUTION	
SANTA FE	
FILE	
U.S.G.S.	
LAND OFFICE	
OPERATOR	

5A. Indicate Type of Lease STATE <input type="checkbox"/> FEE <input checked="" type="checkbox"/>
5. State Oil & Gas Lease No.
7. Unit Agreement Name
8. Farm or Lease Name Synergy
9. Well No. 1
10. Field and Pool, or Wildcat Cato
17. County Chaves

APPLICATION FOR PERMIT TO DRILL, DEEPEN, OR PLUG BACK

a. Type of Work
DRILL ☒ DEEPEN ☐ PLUG BACK ☐

b. Type of Well
OIL WELL ☒ GAS WELL ☐ OTHER ☐ SINGLE ZONE ☒ MULTIPLE ZONE ☐

c. Name of Operator
Casa Petroleum

d. Address of Operator
P.O. Box 1151 Artesia, New Mexico

e. Location of Well
UNIT LETTER **I** LOCATED **1980** FEET FROM THE **South** LINE
660 FEET FROM THE **East** LINE OF SEC. **12** TWP. **8** RGE. **30** NMPM

19. Proposed Depth 3700'	19A. Formation San Andres	20. Rotary or C.T. Rotary
21. Elevations (Show whether DF, RT, etc.) 4158 G.L.	21A. Kind & Status Plug. Bond Blanket	21B. Drilling Contractor Salazar Bros.
		22. Approx. Date Work will start April 4, 1982

PROPOSED CASING AND CEMENT PROGRAM					
SIZE OF HOLE	SIZE OF CASING	WEIGHT PER FOOT	SETTING DEPTH	SACKS OF CEMENT	EST. TOP
12 1/4	8 5/8	24	1350	550	Circ.
7 7/8	4 1/2	10.5	3700	1550	Circ.

Plan to drill 12 1/4" hole to 1350'. Set 8 5/8" surface casing with 550 sxs cmt. WOC 18 hrs. Pressure up to 1000# for 30 minutes. If okay, drill ahead to 3700'. Run SNP and DLL. If logs indicate oil potential, will run 4 1/2" casing to 3700' and cement with 1550 sxs cmt. Perforations and treatment to be based on log analysis.

BOP to be installed on 8 5/8" double 10" Ser 900.

APPROVAL VALID FOR 180 DAYS
PERMIT EXPIRES 10/2/82
UNLESS DRILLING UNDERWAY

ABOVE SPACE DESCRIBE PROPOSED PROGRAM; IF PROPOSAL IS TO DEEPEN OR PLUG BACK, GIVE DATA ON PRESENT PRODUCTIVE ZONE AND PROPOSED NEW PRODUCTION ZONE. GIVE BLOWOUT PREVENTER PROGRAM, IF ANY.

I hereby certify that the information above is true and complete to the best of my knowledge and belief.

Signed [Signature] Title President Date March 25, 1982
(This space for State Use)

ORIGINAL SIGNED BY
APPROVED BY JERRY SEXTON TITLE DISTRICT 1 SUPR. DATE APR 2 1982

All distances must be from the outer boundaries of the Section.

Lease			Well No.		
Casa Petroleum			#1		
Synergy					
Section	Township	Range	County		
I	12	8 South	Chaves		
Postage Location of Well:					
1980	feet from the	South	line and	660	feet from the East
Line Level Elev.	Producing Formation		Pool	Dedicated Acreage:	
4158	San Andres		Cato	40 Acres	

- Outline the acreage dedicated to the subject well by colored pencil or hatchure marks on the plat below.
- If more than one lease is dedicated to the well, outline each and identify the ownership thereof (both as to working interest and royalty).
- If more than one lease of different ownership is dedicated to the well, have the interests of all owners been consolidated by communitization, unitization, force-pooling, etc?

☐ Yes ☐ No If answer is "yes," type of consolidation _____

If answer is "no," list the owners and tract descriptions which have actually been consolidated. (Use reverse side of this form if necessary.) _____

No allowable will be assigned to the well until all interests have been consolidated (by communitization, unitization, forced-pooling, or otherwise) or until a non-standard unit, eliminating such interests, has been approved by the Division.

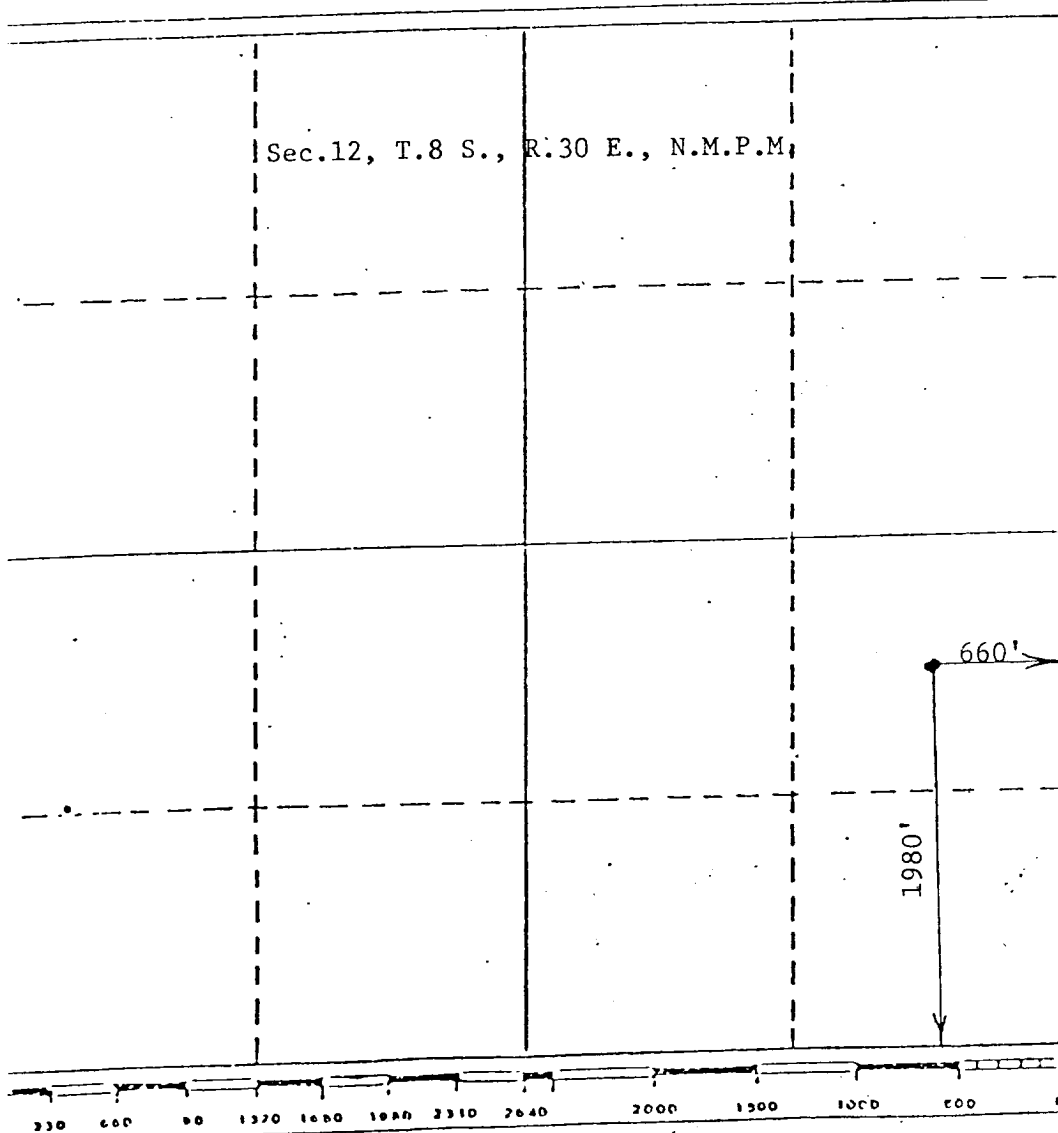

CERTIFICATION

I hereby certify that the information contained herein is true and complete to the best of my knowledge and belief.

Ranger Karr
Name

Ranger Karr

Position

President

Company

Casa Petroleum

Date

March 25, 1982

I hereby certify that the well location shown on this plat was plotted from field notes of actual surveys made by me or under my supervision, and that the same is true and correct to the best of my knowledge and belief.

JOHN D. JAQUES
NEW MEXICO
REGISTERED PROFESSIONAL ENGINEER
and/or LAND SURVEYOR
March 13, 1982
John D. Jaques, P.E. & L.S.
Certificate No. 6290