

STATE OF NEW MEXICO  
ENERGY AND MINERALS DEPARTMENT

L CONSERVATION DIVISION

P. O. BOX 2088  
SANTA FE, NEW MEXICO 87501

30-005-20928

Form C-101  
Revised 10-1-78

|                        |  |
|------------------------|--|
| NO. OF COPIES RECEIVED |  |
| DISTRIBUTION           |  |
| SANTA FE               |  |
| FILE                   |  |
| U.S.G.S.               |  |
| LAND OFFICE            |  |
| OPERATOR               |  |

|  |
|--|
| 5A. Indicate Type of Lease<br>STATE <input checked="" type="checkbox"/> FEE <input type="checkbox"/> |
| 5. State Oil & Gas Lease No.<br>LG-1520  |
| 7. Unit Agreement Name   |
| 8. Term or Lease Name<br>Cone State  |
| 9. Well No.<br>4   |
| 10. Field and Pool, or Wildcat<br>Undes. Tomahawk SA   |
| 11. County<br>Chaves   |

APPLICATION FOR PERMIT TO DRILL, DEEPEN, OR PLUG BACK

1a. Type of Work  
b. Type of Well  
OIL WELL ☒ GAS WELL ☐ OTHER ☐  
DEEPEN ☐ PLUG BACK ☐  
SINGLE ZONE ☐ MULTIPLE ZONE ☐

2. Name of Operator  
Yates Petroleum Corporation

3. Address of Operator  
207 S. 4th, Artesia, New Mexico 88210

4. Location of Well  
UNIT LETTER F LOCATED 1650 FEET FROM THE North LINE  
AND 1650 FEET FROM THE West LINE OF SEC. 2 TWP. 8S RST. 31E N41PM

|  |  |  |
|--|--|--|
| 19. Proposed Depth<br>appr. 4250'                        | 19A. Perforation<br>San Andres           | 20. Rotary or C.T.<br>Rotary                   |
| 21. Elevations (Show whether DE, RL, etc.)<br>4336.9' GL | 21A. Kind & Status Plug. Bond<br>Blanket | 21B. Drilling Contractor<br>LaRue Drilling Co. |
|  |  | 22. Approx. Date Work will start<br>ASAP       |

23. PROPOSED CASING AND CEMENT PROGRAM

| SIZE OF HOLE | SIZE OF CASING | WEIGHT PER FOOT | SETTING DEPTH | SACKS OF CEMENT | EST. TOP |
|--------------|----------------|-----------------|---------------|-----------------|----------|
| 12 1/2"      | 8 5/8"         | 24#             | appr. 1550'   | 500 SX          | circ     |
| 7 7/8"       | 4 1/2"         | 9.5#            | TD            | 300 SX          |          |

We propose to drill and test the San Andres formations. If commercial, 4 1/2" production casing will be run and cemented with an adequate cover, perforate and stimulate as needed for production.

MUD PROGRAM: Native mud to 1550'. FW to TD.

BOP PROGRAM: BOP's will be installed at 1550' and tested daily.

*void*

IN ABOVE SPACE DESCRIBE PROPOSED PROGRAM; IF PROPOSAL IS TO DEEPEN OR PLUG BACK, GIVE DATA ON PRESENT PRODUCTIVE ZONE AND PROPOSED NEW PRODUCTIVE ZONE. GIVE BLOWOUT PREVENTER PROGRAM, IF ANY.

I hereby certify that the information above is true and complete to the best of my knowledge and belief.

Signed Eddie Seay Title Regulatory Agent Date 11-16-83

(This space for State Use)

ORIGINAL SIGNED BY EDDIE SEAY

APPROVED BY OIL & GAS INSPECTOR DATE DEC 9 1983

CONDITIONS OF APPROVAL, IF ANY:

APPROVAL VALID FOR 180 DAYS  
PERMIT EXPIRES 6/9/84  
UNLESS DRILLING UNDERWAY

**NEW MEXICO OIL CONSERVATION COMMISSION  
WELL LOCATION AND ACREAGE DEDICATION PLAT**

Form O-102  
Supersedes O-128  
Effective 1-1-65

All distances must be from the outer boundaries of the Section

|  |  |   |                                       |                         |                       |
|--|--|---|---------------------------------------|-------------------------|-----------------------|
| Operator<br><b>YATES PETROLEUM CORPORATION</b>   |  |   | Lease<br><b>CONE STATE</b>            |                         | Well No.<br><b>#4</b> |
| Unit Letter<br><b>F</b>  | Section<br><b>2</b>                      | Township<br><b>8</b>                                | Range<br><b>31</b>                    | County<br><b>Chaves</b> |                       |
| Actual Footage Location of Well:<br><div style="display: flex; justify-content: space-between;"> <span><b>1650</b> feet from the <b>North</b> line and</span> <span><b>1650</b> feet from the <b>West</b> line</span> </div> |  |   |                                       |                         |                       |
| Ground Level Elev.<br><b>4336.9</b>  | Producing Formation<br><b>San Andres</b> | Pool<br><i>Tom Tom</i><br><b>Undes. Tomahawk SA</b> | Dedicated Acreage:<br><b>40</b> Acres |                         |                       |

1. Outline the acreage dedicated to the subject well by colored pencil or hachure marks on the plat below.
2. If more than one lease is dedicated to the well, outline each and identify the ownership thereof (both as to working interest and royalty).
3. If more than one lease of different ownership is dedicated to the well, have the interests of all owners been consolidated by communitization, unitization, force-pooling, etc?

☐ Yes   ☐ No   If answer is "yes," type of consolidation \_\_\_\_\_

If answer is "no," list the owners and tract descriptions which have actually been consolidated. (Use reverse side of this form if necessary.) \_\_\_\_\_

No allowable will be assigned to the well until all interests have been consolidated (by communitization, unitization, forced-pooling, or otherwise) or until a non-standard unit, eliminating such interests, has been approved by the Commission.

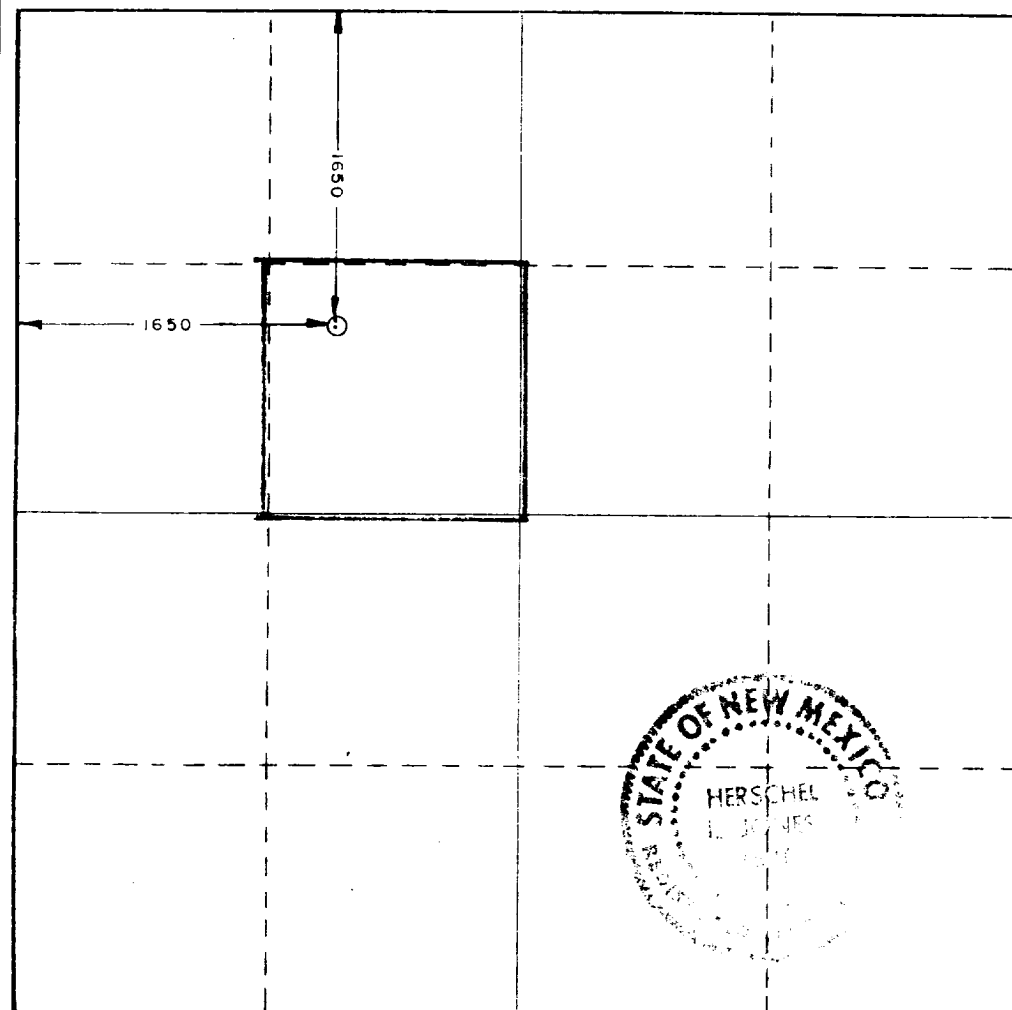

**CERTIFICATION**

*I hereby certify that the information contained herein is true and complete to the best of my knowledge and belief.*

Name  
**Gliserio Rodriguez**  
Position  
**Regulatory Agent**  
Company  
**Yates Petroleum Corp.**  
Date  
**12/7/83**

*I hereby certify that the well location shown on this plat was plotted from field notes of actual surveys made by me or under my supervision, and that the same is true and correct to the best of my knowledge and belief.*

Date Surveyed  
**11/23/83**  
Registered Professional Engineer  
and/or Land Surveyor

Certificate No.  
**3640**

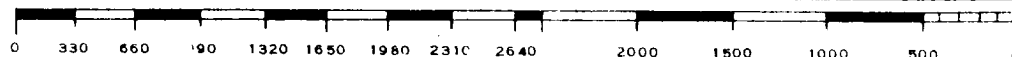

EXHIBIT B

BOP DIAGRAM

RATED 3000<sup>#</sup>

