

All distances must be from the outer boundaries of the Section.

Operator Getty Oil Company			Lease Cooper Jal Unit		Well No. 132
Unit Letter I	Section 24	Township 24-S	Range 36 37-E	County Lea	
Actual Footage Location of Well:					
2310		feet from the	South	line mid	990
				feet from the	East
Ground Level Elev. 3305		Producing Formation Yates-Seven Rivers		Pool Jalmat	Dedicated Acreage: 40 Acres

1. Outline the acreage dedicated to the subject well by colored pencil or hachure marks on the plat below.
2. If more than one lease is dedicated to the well, outline each and identify the ownership thereof (both as to working interest and royalty).
3. If more than one lease of different ownership is dedicated to the well, have the interests of all owners been consolidated by communitization, unitization, force-pooling, etc?

☐ Yes ☐ No If answer is "yes," type of consolidation \_\_\_\_\_

If answer is "no," list the owners and tract descriptions which have actually been consolidated. (Use reverse side of this form if necessary.) \_\_\_\_\_

No allowable will be assigned to the well until all interests have been consolidated (by communitization, unitization, forced-pooling, or otherwise) or until a non-standard unit, eliminating such interests, has been approved by the Commission.

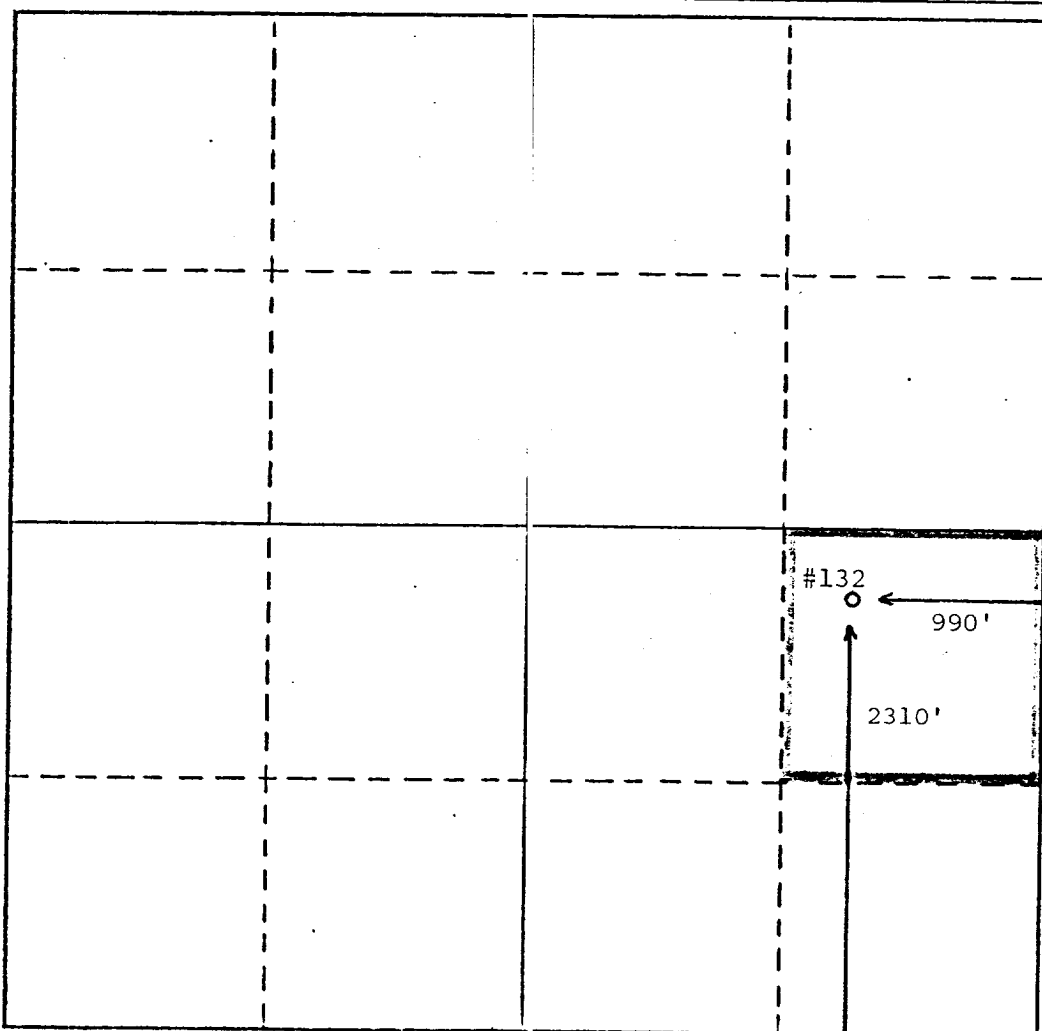

## CERTIFICATION

I hereby certify that the information contained herein is true and complete to the best of my knowledge and belief.

*Dale R. Crockett*  
Name Dale R. Crockett

Position  
Area Superintendent

Company  
Getty Oil Company

Date  
July 23, 1984

I hereby certify that the well location shown on this plat was plotted from field notes of actual surveys made by me or under my supervision, and that the same is true and correct to the best of my knowledge and belief.

Date Surveyed

Registered Professional Engineer  
and/or Land Surveyor

Certificate No.

0 330 660 990 1320 1650 1980 2310 2640 2000 1500 1000 500 0

RECEIVED

JUL 24 1984

CCC  
HOBBS OFFICE