

NEW MEXICO OIL CONSERVATION COMMISSION
WELL LOCATION AND ACREAGE DEDICATION PLAN

Form C-102
Supersedes C-128
Effective 1-1-65

All distances must be from the outer boundaries of the Section.

Operator SHELL OIL COMPANY			Lease STATE		Well No. 1-Y
Unit Letter D	Section 36	Township 24-S	Range 36-E	County LEA	
Actual Footage Location of Well: 380 feet from the NORTH line and 380 feet from the WEST line					
Ground Level Elev. 3281' DF	Producing Formation YATES		Pool JALMAT		Dedicated Acreage: 80 Acres

1. Outline the acreage dedicated to the subject well by colored pencil or hachure marks on the plat below.
2. If more than one lease is dedicated to the well, outline each and identify the ownership thereof (both as to working interest and royalty).
3. If more than one lease of different ownership is dedicated to the well, have the interests of all owners been consolidated by communitization, unitization, force-pooling, etc?

☐ Yes ☐ No If answer is "yes," type of consolidation _____

If answer is "no," list the owners and tract descriptions which have actually been consolidated. (Use reverse side of this form if necessary.) _____

No allowable will be assigned to the well until all interests have been consolidated (by communitization, unitization, forced-pooling, or otherwise) or until a non-standard unit, eliminating such interests, has been approved by the Commission.

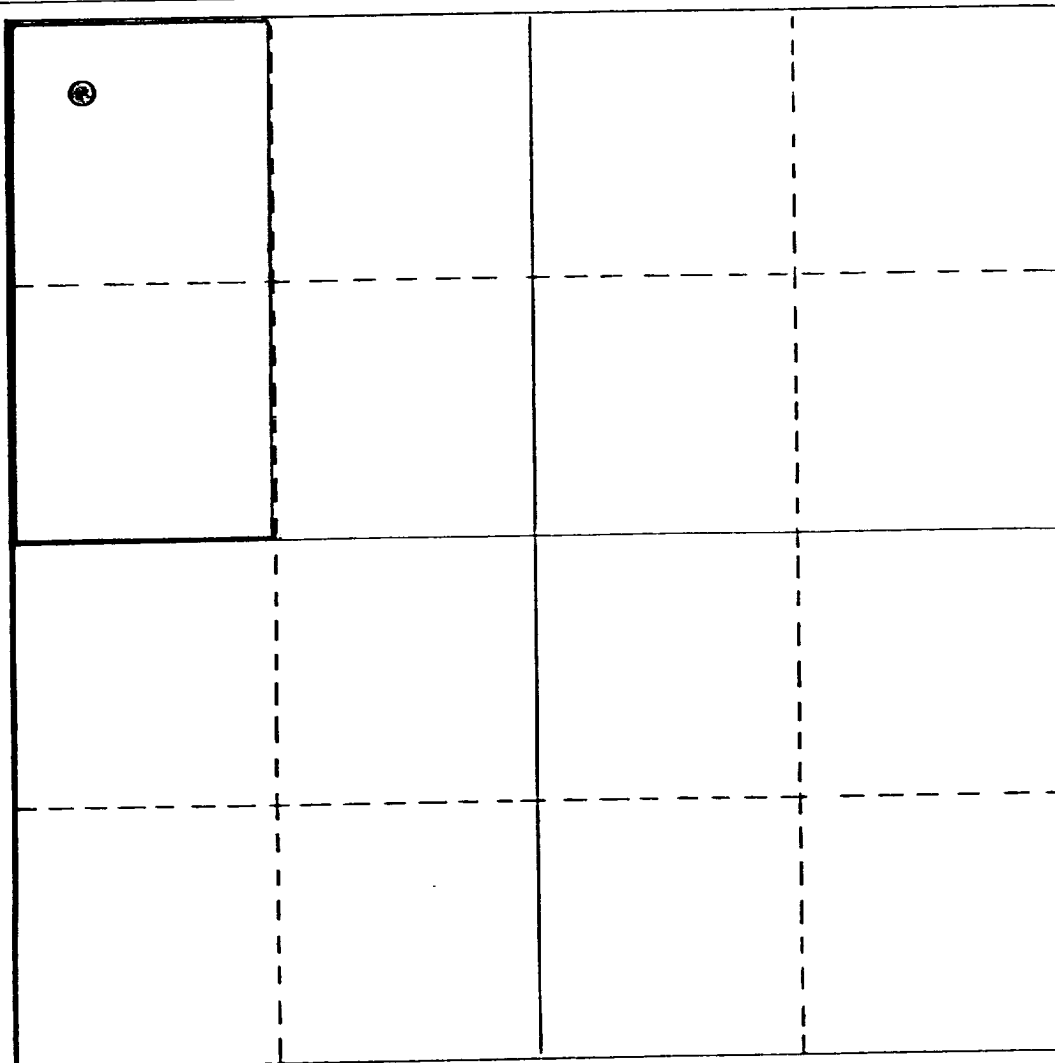

CERTIFICATION

I hereby certify that the information contained herein is true and complete to the best of my knowledge and belief.

Name

A. J. FORE

Position

**SUPERVISOR
REGULATORY & PERMITTING**

Company

SHELL OIL COMPANY

Date

AUGUST 23, 1982

I hereby certify that the well location shown on this plat was plotted from field notes of actual surveys made by me or under my supervision, and that the same is true and correct to the best of my knowledge and belief.

Date Surveyed

Registered Professional Engineer
and/or Land Surveyor

Certificate No.

0 330 660 990 1320 1650 1980 2310 2640 2970 3300 3630 3960 4290 4620 4950 5280 5610 5940 6270 6600

NUMBER OF COPIES RECEIVED	
DISTRIBUTION	
SANTA FE	
FILE	
U.S.G.S.	
LAND OFFICE	
TRANSPORTER	OIL GAS
LOCATION OFFICE	
OPERATOR	

NEW MEXICO OIL CONSERVATION COMMISSION
WELL LOCATION AND ACREAGE DEDICATION PL. T
 SEE INSTRUCTIONS FOR COMPLETING THIS FORM ON THE REVERSE SIDE

FORM C-128
 Revised 5/1/57

SECTION A

Operator Shell Oil Company		Lease		State NM		Well No. 1A	
Unit Letter D	Section 36	Township 24S	Range 36E	County Lee			
Actual Footage Location of Well: 380 feet from the north line and 380 feet from the west line							
Ground Level Elev. 3721'		Producing Formation Yadon		Pool Jalant		Dedicated Acreage: 40 Acres	

1. Is the Operator the only owner in the dedicated acreage outlined on the plat below? YES ☒ NO ____ . ("Owner" means the person who has the right to drill into and to produce from any pool and to appropriate the production either for himself or for himself and another. (65-3-29 (e) NMSA 1935 Comp.)
2. If the answer to question one is "no," have the interests of all the owners been consolidated by communitization agreement or otherwise? YES ____ NO ____ . If answer is "yes," Type of Consolidation _____
3. If the answer to question two is "no," list all the owners and their respective interests below:

Owner	Land Description

SECTION B

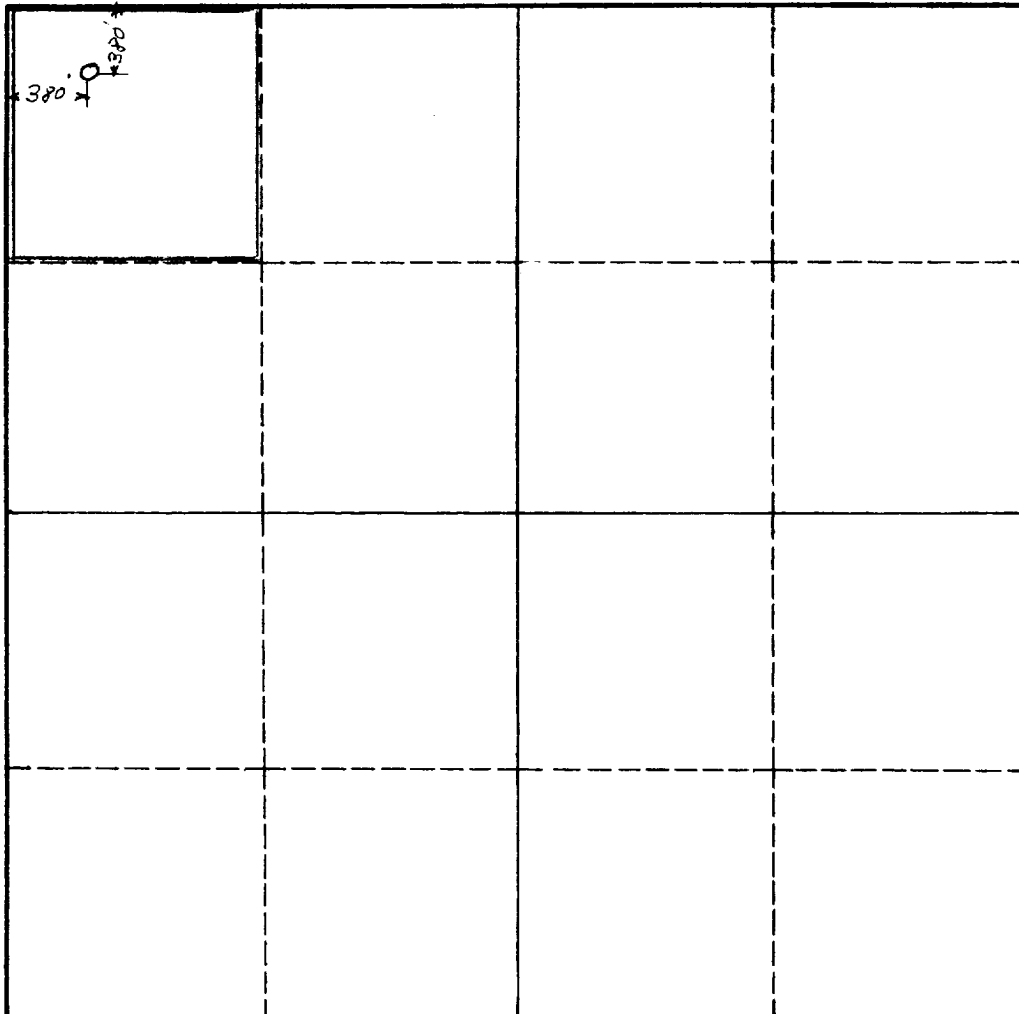

CERTIFICATION

I hereby certify that the information in SECTION A above is true and complete to the best of my knowledge and belief.

Original Signed By

Name	R. A. LOWERY
Position	District Exploitation Engineer
Company	Shell Oil Company
Date	March 21, 1963

Reclassified as an oil well as per NMCCC Order No. R-2191-A.

I hereby certify that the well location shown on the plat in SECTION B was plotted from field notes of actual surveys made by me or under my supervision, and that the same is true and correct to the best of my knowledge and belief.

Date Surveyed
Registered Professional Engineer and/or Land Surveyor

Certificate No.

0 330 660 990 1320 1650 1980 2310 2640 2000 1500 1000 500 0

INSTRUCTIONS FOR COMPLETION OF FORM C-128

1. Operator shall furnish and certify to the information called for in Section A.
2. Operator shall outline the dedicated acreage for *both* oil and gas wells on the plat in Section B.
3. A registered professional engineer or land surveyor registered in the State of New Mexico or approved by the Commission shall show on the plat the location of the well and certify this information in the space provided.
4. All distances shown on the plat must be from the outer boundaries of the Section.
5. If additional space is needed for listing owners and their respective interests as required in question 3 of Section A, please use space below.

NEW MEXICO OIL CONSERVATION COMMISSION
WELL LOCATION AND ACREAGE DEDICATION PLAT

FORM C-128
Revised 5/1/57

SEE INSTRUCTIONS FOR COMPLETING THIS FORM ON THE REVERSE SIDE

SECTION A

Operator Shell Oil Company		Lease State		Well No. 1A	
Unit Letter D	Section 36	Township 21S	Range 36E	County Lea	
Actual Footage Location of Well: 380 feet from the north line and 380 feet from the west line					
Ground Level Elev. 3721'	Producing Formation Yates		Pool Jalnet		Dedicated Acreage: 200 Acres

1. Is the Operator the only owner in the dedicated acreage outlined on the plat below? YES ☒ NO ____ . ("Owner" means the person who has the right to drill into and to produce from any pool and to appropriate the production either for himself or for himself and another. (65-3-29 (e) NMSA 1935 Comp.)
2. If the answer to question one is "no," have the interests of all the owners been consolidated by communitization agreement or otherwise? YES ____ NO ____ . If answer is "yes," Type of Consolidation ____
3. If the answer to question two is "no," list all the owners and their respective interests below:

Owner	Land Description

SECTION B

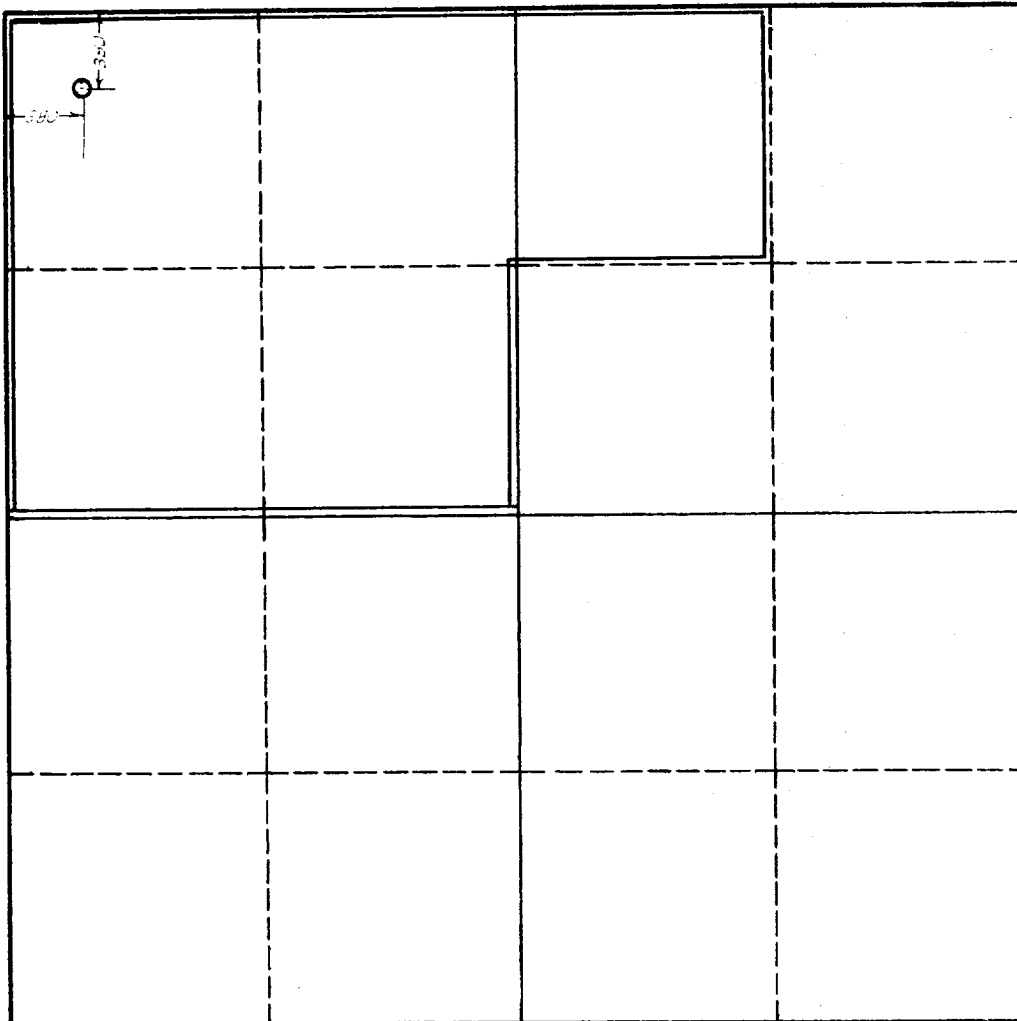

CERTIFICATION

I hereby certify that the information in SECTION A above is true and complete to the best of my knowledge and belief.

Original Signed By

Name **R. A. LOWERY**
Position **District Exploitation Engineer**
Company **Shell Oil Company**
Date **March 21, 1961**

I hereby certify that the well location shown on the plat in SECTION B was plotted from field notes of actual surveys made by me or under my supervision, and that the same is true and correct to the best of my knowledge and belief.

Date Surveyed
Registered Professional Engineer and/or Land Surveyor
Certificate No.

0 330 660 990 1320 1650 1980 2310 2640 2000 1500 1000 500 0

INSTRUCTIONS FOR COMPLETION OF FORM C-128

1. Operator shall furnish and certify to the information called for in Section A.
2. Operator shall outline the dedicated acreage for *both* oil and gas wells on the plat in Section B.
3. A registered professional engineer or land surveyor registered in the State of New Mexico or approved by the Commission shall show on the plat the location of the well and certify this information in the space provided.
4. All distances shown on the plat must be from the outer boundaries of the Section.
5. If additional space is needed for listing owners and their respective interests as required in question 3 of Section A, please use space below.

**NEW MEXICO
OIL CONSERVATION COMMISSION**

Gas Well Plat DEC 15 1953

OIL CONSERVATION COMMISSION

CORRECTED COPY

Date 12-8-53

HOBBS OFFICE

Shell Oil Company State 1-A
Operator Lease Well No.

Name of Producing Formation Tates Pool Jalos

No. Acres Dedicated to the Well 160

SECTION 36 TOWNSHIP 24-N RANGE 36-E

 Shell	Shell	R Olsen Oil Co.
State	State	McKinney
	Phillips	Shell
Western Nat. Gas	Shell	
	Vernon	State
State	State	Cities Service "W"

I hereby certify that the information given above is true and complete to the best of my knowledge.

Name B. Nevill *B. Nevill*
Position Division Exploitation Engineer
Representing Shell Oil Company
Address Box 1957, Hobbs, New Mexico

(over)

INSTRUCTIONS

1. Is this gas well a dual completion? Yes _____ No X
2. If the answer to Question 1 is Yes, are there any other dually completed wells within the dedicated acreage? Yes _____ No _____

A separate plat must be filed for each gas well, outlining the area dedicated to such well and showing the location of all other wells (oil and gas) within the outlined area.

Mail in duplicate to the district office for the district in which the well is located.

NEW MEXICO
OIL CONSERVATION COMMISSION

Gas Well Plat



Date 11-24-53

Shell Oil Company State 1-A
Operator Lease Well No.

Name of Producing Formation X Tates Pool Jalco

No. Acres Dedicated to the Well 80

SECTION 36 TOWNSHIP 24-S RANGE 36-S

 Shell 380'	Shell "B" (Under consideration for Unitization.)	Shell	R. Olsen Oil Co. McKinney
State		Phillips	Shell
Western Nat. Gas	State	Vernon	State
State	State	Cities Service "W"	State

I hereby certify that the information given above is true and complete to the best of my knowledge.

Name J. D. Savage ORIGINAL SIGNED BY
 J. D. SAVAGE
 Position Division Exploitation Engineer
 Representing Shell Oil Company
 Address Box 1957, Hobbs, New Mexico

(over)

INSTRUCTIONS

1. Is this gas well a dual completion? Yes _____ No X
2. If the answer to Question 1 is Yes, are there any other dually completed wells within the dedicated acreage? Yes _____ No _____

A separate plat must be filed for each gas well, outlining the area dedicated to such well and showing the location of all other wells (oil and gas) within the outlined area.

Mail in duplicate to the district office for the district in which the well is located.

