

NEW MEXICO OIL CONSERVATION COMMISSION
WELL LOCATION AND ACRES DEDICATION PLAT

FORM C-128
Revised 5/1/57

SEE INSTRUCTIONS FOR COMPLETING THIS FORM ON THE REVERSE SIDE

Operator TEXACO Inc.		Lease E. D. Fanning		Well No. 7
Unit Letter G	Section 5	Township 24S	Range 37E	County Lea
Actual Footage Location of Well: 1966 feet from the North line and 1980 feet from the East line Sec. 5				
Ground Level Elev. 3281'	Producing Formation Yates	Pool *Jalmat (Gas)	Dedicated Acreage: 160 Acres	

* To be Dually completed with Langlie Mattix (Oil)

1. Is the Operator the only owner in the dedicated acreage outlined on the plat below? YES X NO ____ . ("Owner" means the person who has the right to drill into and to produce from any pool and to appropriate the production either for himself or for himself and another. (65-3-29 (e) NMSA 1935 Comp.)
2. If the answer to question one is "no," have the interests of all the owners been consolidated by communitization agreement or otherwise? YES ____ NO ____ . If answer is "yes," Type of Consolidation ____
3. If the answer to question two is "no," list all the owners and their respective interests below:

Owner	Land Description

SECTION B

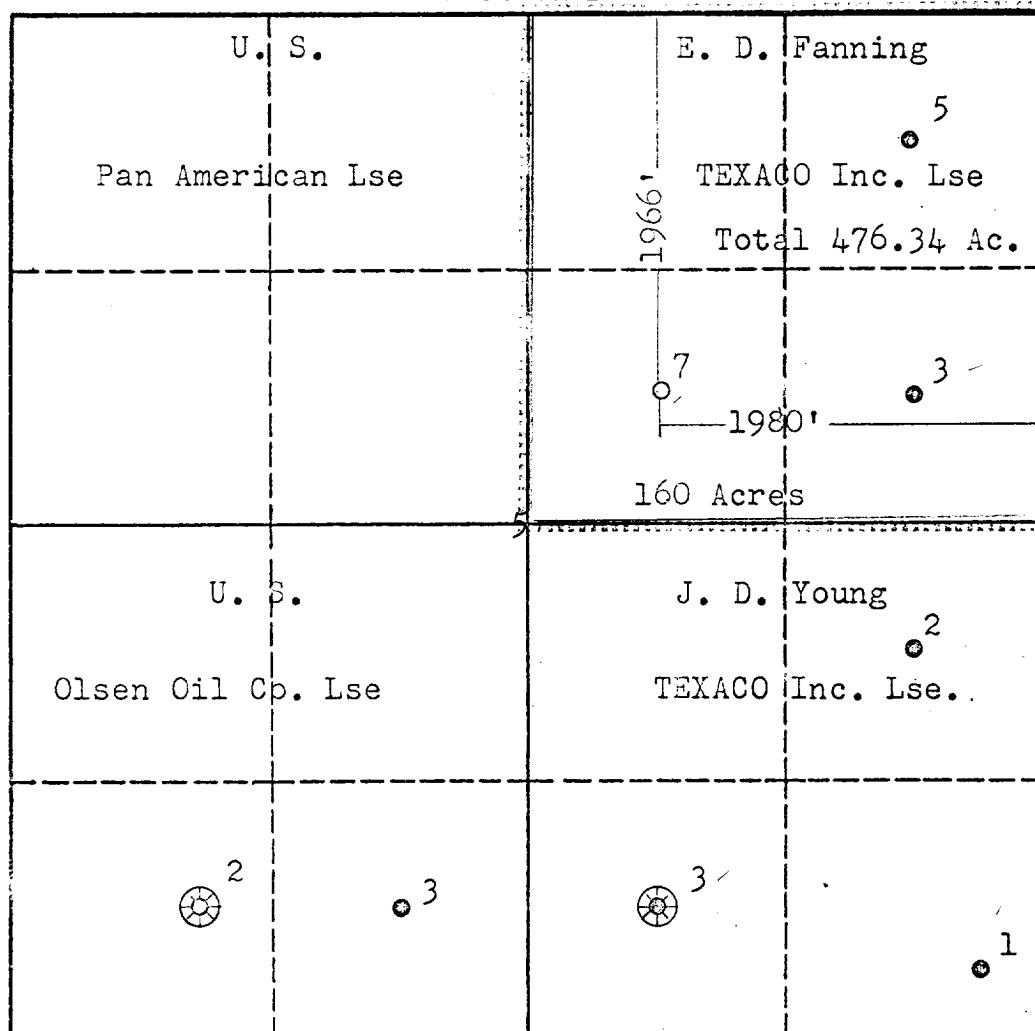

CERTIFICATION

I hereby certify that the information in SECTION A above is true and complete to the best of my knowledge and belief.

Name J. J. Velten
 Position Division Civil Engineer
 Company TEXACO Inc.
 Date 5/12/61

I hereby certify that the well location shown on the plat in SECTION B was plotted from field notes of actual surveys made by me or under my supervision, and that the same is true and correct to the best of my knowledge and belief.

Date Surveyed 5/12/61
 Registered Professional Engineer and/or Land Surveyor J. J. Velten
 Certificate No. 8174

0 330 660 990 1320 1650 1980 2310 2640 2000 1500 1000 500 0