

NEW MEXICO OIL CONSERVATION COMMISSION
WELL LOCATION AND ACREAGE DEDICATION PLAT

C-102
Revised C-128
Effective 1-1-65

All distances must be from the outer boundaries of the Section.

Operator Sinclair Oil & Gas Company			Lease Jim Camp VN		Well No. 2
Unit Letter E	Section 6	Township 24S	Range 37E	County Lea	
Actual Footage Location of Well: <div style="display: flex; justify-content: space-between;"> 660 feet from the West line and 1980 feet from the North line </div>					
Ground Level Elev. 3317	Producing Formation Yates	Pool Jalmat	Dedicated Acreage: 120 ^{7/16} ₂₂ Acres		

1. Outline the acreage dedicated to the subject well by colored pencil or hachure marks on the plat below.
2. If more than one lease is dedicated to the well, outline each and identify the ownership thereof (both as to working interest and royalty).
3. If more than one lease of different ownership is dedicated to the well, have the interests of all owners been consolidated by communitization, unitization, force-pooling, etc?

☐ Yes ☐ No If answer is "yes," type of consolidation _____

If answer is "no," list the owners and tract descriptions which have actually been consolidated. (Use reverse side of this form if necessary.) _____

No allowable will be assigned to the well until all interests have been consolidated (by communitization, unitization, forced-pooling, or otherwise) or until a non-standard unit, eliminating such interests, has been approved by the Commission.

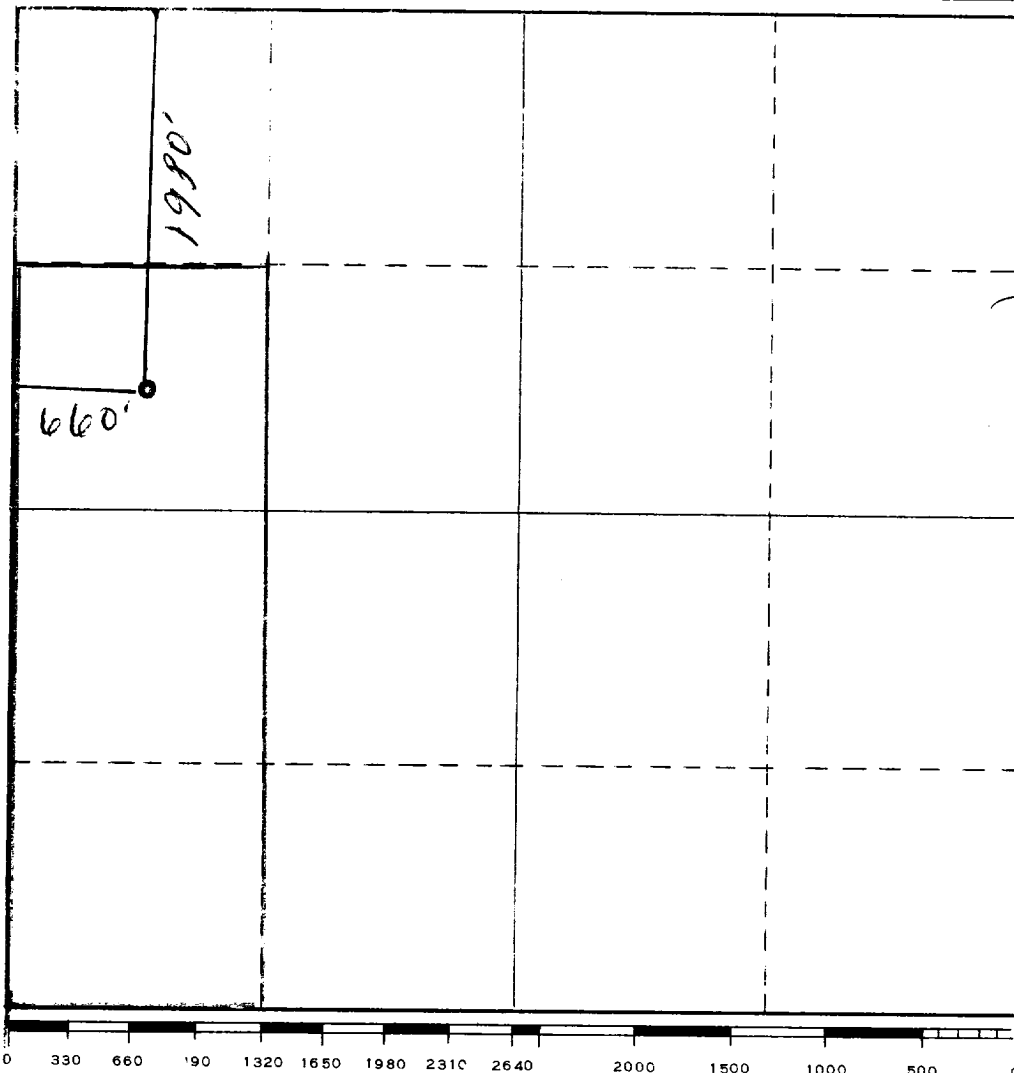

CERTIFICATION

I hereby certify that the information contained herein is true and complete to the best of my knowledge and belief.

Name *L. B. ...*
 Position **Superintendent**
 Company **Sinclair Oil & Gas Co.**
 Date **4-9-65**

I hereby certify that the well location shown on this plat was plotted from field notes of actual surveys made by me or under my supervision, and that the same is true and correct to the best of my knowledge and belief.

Date Surveyed _____

Registered Professional Engineer and/or Land Surveyor

Certificate No. _____

COUNTRY	USA	FIELD	Jalmat	STATE	NE	(OWN)
OPR	SINCLAIR OIL & GAS CO.					MAP
2 Camp, Jim WN						
Sec. 6, T-24-S, R-37-E						
1980' fr N Line & 660' fr W Line of Sec.						
Re-Spd 3-27-65						
Re-Cmp 4-11-65						
CLASS						
FORMATION DATUM FORMATION DATUM						
CSG & SX - TUBING						
12 3/4" 30' 25						
8 5/8" 1180' 400						
5 1/2" 3450' 300						
LOGS EL GR RA IND HC A						
TD 3575', PBD 3362'						

IP Yates Perfs 2944-3234' Flwd 1212 MCFGPD. Pot. Based on 24 hr test thru 20/64" chk., TP 250#.

Distribution limited and publication prohibited by subscribers' agreement.
Reproduction rights reserved by Williams & Lee Scouting Service, Inc.

CONT.	PROP DEPTH	TYPE
DATE		

F.R.C. 6-10-65; OWWO
Orig. Western Natural Gas Co., #2 Camp;
comp in Langlie-Mattix field from Queen OH
3450-3575', OTD 3575'.
6-7-65 TD 3575', PBD 3362', COMPLETED.
Set CIBP @ 3380' & PB to 3362' to shut
off OH 3450-3575'
Perf @ 2944', 2950', 2973', 2986', 2994',
3004', 3018', 3026', 3045', 3060', 3067',
3072', 3137', 3142', 3154', 3167', 3172',
3180', 3222', 3230', 3234' W/2 SPI
Ac. 1500 gals. (3137-3234')
Ac. 1500 gals. (2944-3072')
Frac 20,000 gals oil + 20,000# sd. 2944-3234'.