

NEW MEXICO
OIL CONSERVATION COMMISSION

Gas Well Plat

Date 11-29-55

Gulf Oil Corporation

Operator

J. R. Holt ~~SP~~ NCT-A Com

Lease

2

Well No.

Name of Producing Formation Yates-Seven Rivers Pool Jalmat Gas

No. Acres Dedicated to the Well 280

Application for 280-acre Non-Standard
Gas Proration Unit will be submitted

SECTION 16 TOWNSHIP -24-S RANGE -37-E

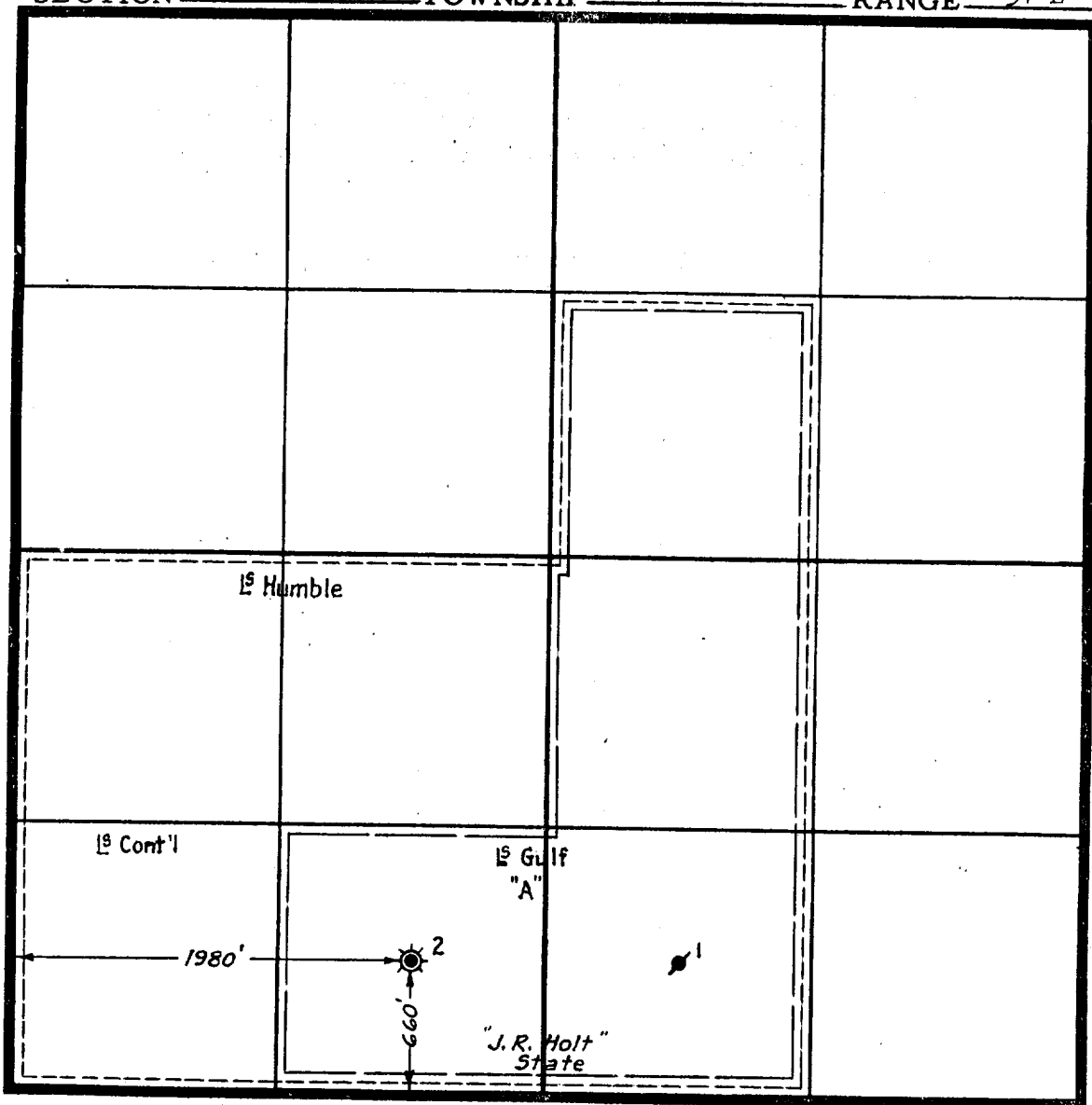

I hereby certify that the information given above is true and complete to the best of my knowledge.

☼ - Dual (Gas-Oil)

● - Oil Well

— — — — — Lease Line

- - - - - Acreage Dedicated

Name J. R. Sherman J. R. Sherman

Position Division Gas Engineer

Representing Gulf Oil Corporation

Address P. O. Box 1290, Fort Worth 1, Texas

(over)

INSTRUCTIONS

1. Is this gas well a dual completion? Yes x No
2. If the answer to Question 1 is Yes, are there any other dually completed wells within the dedicated acreage? Yes No x

A separate plat must be filed for each gas well, outlining the area dedicated to such well and showing the location of all other wells (oil and gas) within the outlined area.

Mail in duplicate to the district office for the district in which the well is located.