

NO. OF COPIES RECEIVED	
DISTRIBUTION	
SANTA FE	
FILE	
U.S.G.S.	
LAND OFFICE	
OPERATOR	

NEW MEXICO OIL CONSERVATION COMMISSION

Form C-101
Revised 1-1-65

This well was previously approved 6/23/67 & expired 9/21/67.

5A. Indicate Type of Lease
STATE <input checked="" type="checkbox"/> FEE <input type="checkbox"/>
6. State Oil & Gas Lease No.
E-8835

APPLICATION FOR PERMIT TO DRILL, DEEPEN, OR PLUG BACK

1a. Type of Work		7. Unit Agreement Name	
b. Type of Well OIL WELL <input checked="" type="checkbox"/> GAS WELL <input type="checkbox"/> OTHER <input type="checkbox"/>		8. Farm or Lease Name	
DEEPEN <input type="checkbox"/> PLUG BACK <input type="checkbox"/>		New Mexico "CQ" State	
2. Name of Operator		9. Well No.	
TEXACO INC.		3	
3. Address of Operator		10. Field and Pool, or Wildcat	
P. O. BOX 3109, MIDLAND, TEXAS 79701		Undesignated	
4. Location of Well		12. County	
UNIT LETTER <u>O</u> LOCATED <u>760</u> FEET FROM THE <u>South</u> LINE		Lea	
AND <u>2080</u> FEET FROM THE <u>East</u> LINE OF SEC. <u>35</u> TWP. <u>10S</u> RGE. <u>33E</u> N.M.P.M.			
21. Elevations (Show whether DE, RT, etc.)		19. Proposed Depth	
Not available		9900'	
21A. Kind & Status Plug. Bond		19A. Formation	
\$10,000 blanket		Bough "C"	
21B. Drilling Contractor		20. Rotary or C.R.	
Unknown		Rotary	
22. Approx. Date Work will start			
At once			

PROPOSED CASING AND CEMENT PROGRAM

SIZE OF HOLE	SIZE OF CASING	WEIGHT PER FOOT	SETTING DEPTH	SACKS OF CEMENT	EST. TOP
17 1/2"	13 3/8"	48#	200'	*250	250% to circ.
12 1/4"	10 3/4"	40.7#	2000'	**850	150% to circ.
9 7/8"	7 5/8"	26.4#	4000'	***900	150% to circ.
6 3/4"	4 1/2"	11.6#	9900'	****800	150% to tie back to 2nd intermediate

*250 sx Class "C" w/2% CaCl₂. Cement must circ (250% to circ.).
 **650 sx TLW, 12#/gal followed by 200 sx Class "C" neat, 14.8#/gal (150% to circ.).
 ***500 sx TLW, 12.4#/gal followed by 400 sx Class "C" neat, 14.8#/gal (150% to circ.).
 ****500 sx TLW, 12#/gal followed by 300 sx Class "C" w/10#/sk salt (150% to tie back to 2nd intermediate)

THE COMMISSION MUST BE NOTIFIED 24 HOURS PRIOR TO RUNNING.

COMPLETION PROGRAM

1. Perf. 4 jet shots in top of zone. 2. Treat w/500 gals 15% HCl acid.

FORMATION TOPS EXPECTED

Anhydrite	2160'	San Andres	3885'	Bough "C"	9800'
Base of Salt	2540'	Tubb	6850'	Total Depth	9900'
Yates	2620'	Wolfcamp (XX)	9020'		

IN ABOVE SPACE DESCRIBE PROPOSED PROGRAM: IF PROPOSAL IS TO DEEPEN OR PLUG BACK, GIVE DATA ON PRESENT PRODUCTIVE ZONE AND PROPOSED NEW PRODUCTIVE ZONE. GIVE BLOWOUT PREVENTER PROGRAM, IF ANY.

I hereby certify that the information above is true and complete to the best of my knowledge and belief.

Signed T. G. Landwermer Title Assistant Division Civil Engineer Date 9/22/67
 (This space for State Use)

APPROVED BY _____ TITLE _____ DATE _____
 CONDITIONS OF APPROVAL, IF ANY:

NEW MEXICO OIL CONSERVATION COMMISSION
WELL LOCATION AND ACREAGE DEDICATION PLAT

Form C-102
 Supersedes C-128
 Effective 1-1-65

All distances must be from the outer boundaries of the Section.

Operator TEXACO Inc.			Lease New Mexico "CQ" State		Well No. 3
Unit Letter 0	Section 35	Township 10 South	Range 33 East	County Lea	
Actual Footage Location of Well: 760 feet from the South line and 2080 feet from the East line Sec. 35					
Ground Level Elev. Not Available		Producing Formation Bough "C"		Pool Inbe-Pennsylvanian	
				Dedicated Acreage: 80 Acres	

1. Outline the acreage dedicated to the subject well by colored pencil or hachure marks on the plat below.
2. If more than one lease is dedicated to the well, outline each and identify the ownership thereof (both as to working interest and royalty).
3. If more than one lease of different ownership is dedicated to the well, have the interests of all owners been consolidated by communitization, unitization, force-pooling, etc?

☐ Yes ☐ No If answer is "yes," type of consolidation _____

If answer is "no," list the owners and tract descriptions which have actually been consolidated. (Use reverse side of this form if necessary.) _____

No allowable will be assigned to the well until all interests have been consolidated (by communitization, unitization, forced-pooling, or otherwise) or until a non-standard unit, eliminating such interests, has been approved by the Commission.

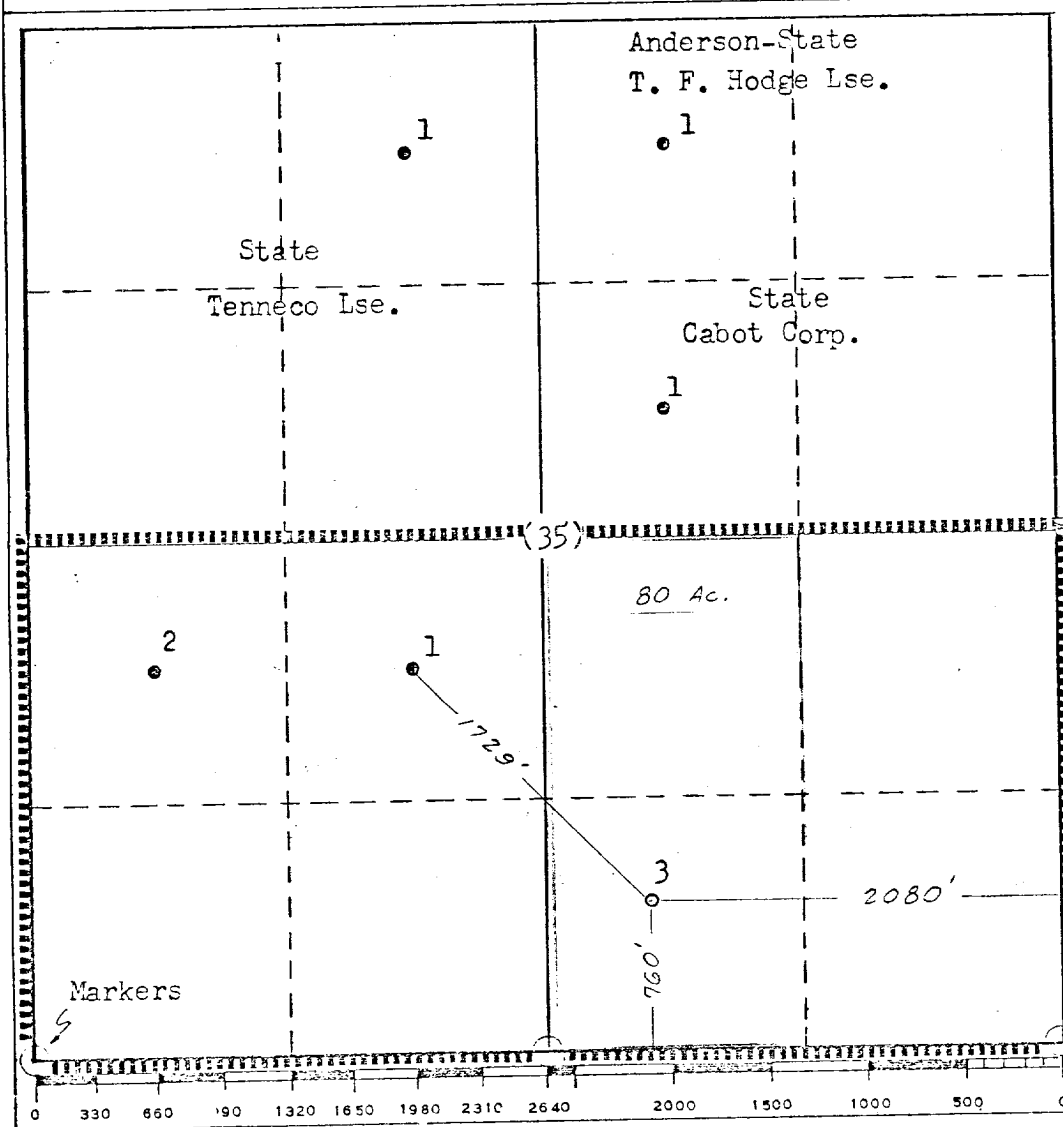

CERTIFICATION

I hereby certify that the information contained herein is true and complete to the best of my knowledge and belief.

T. G. Landwermyer
 Name

T. G. Landwermyer

Position
Civil Engineer

Company
TEXACO Inc.

Date
9/22/67

I hereby certify that the well location shown on this plat was plotted from field notes of actual surveys made by me or under my supervision, and that the same is true and correct to the best of my knowledge and belief.

Date Surveyed
6/20/67

Registered Professional Engineer and/or Land Surveyor

T. G. Landwermyer
T. G. Landwermyer

Certificate No. **17617**

LAND OFFICE
 OPERATOR

NEW MEXICO
HOBBS OFFICE O. C. C.

JUN 22 11 42 AM '67

Form 11-101
10-1-67

STATE OF NEW MEXICO
 E-8835

APPLICATION FOR PERMIT TO DRILL, DEEPEN, OR PLUG BACK

1. Type of Work
 5. Type of Well
 OIL WELL ☒ GAS WELL ☐ OTHER ☐
 2. Name of Operator
 TEXACO INC.
 3. Address of Operator
 P. O. BOX 3109, MIDLAND, TEXAS 79701
 4. Location of Well
 2080 FEET FROM THE East LINE OF SEC. 35 10S 33E
 7. Unit Agreement Name
 8. Term or Lease Name
 New Mexico "CO" State
 9. Well No.
 3
 10. Field and Pool Name
 UNDESIGNATED
 11. County
 Lea
 12. Formation
 9900'
 13. Rotary or C.T.
 Baugh "C"
 Rotary
 14. Approx. Date Work will start
 At once

PROPOSED CASING AND CEMENT PROGRAM

SIZE OF HOLE	SIZE OF CASING	WEIGHT PER FOOT	DEPTH	SACKS OF CEMENT	EST. TOP
17 1/2"	13 3/8"	48#	200'	*250	100% to circ.
12 1/4"	10 3/4"	40.5#	2000'	**850	150% to circ.
9 7/8"	7 5/8"	26.4#	4000'	***900	150% to circ.
6 3/4"	4 1/2"	11.6#	9900'	****800	150% to tie back to 2nd intermediate

*250 sx Class "C" w/2% CaCl₂. Cement must circ (250% to circ.).

**650 sx TLW, 12#/gal followed by 200 sx Class "C" neat, 14.8#/gal (150% to circ.).

***500 sx TLW, 12.4#/gal followed by 400 sx Class "C" neat, 14.8#/gal (150% to circ.).

****500 sx TLW, 12#/gal followed by 300 sx Class "C" w/10#/sk salt (150% to tie back to 2nd intermediate).

COMPLETION PROGRAM

1. Perf. 4 jet shots in top of zone. 2. Treat w/500 gals 15% N.E. DRILLING FLUID.

FORMATION TOPS EXPECTED

Anhydrite	2160'	San Andres	3885'	Bottoms "C"	9800'
Base of Salt	2540'	Tubb	6850'	Total Depth	9900'
Yates	2620'	Wolfcamp (XX)	9020'		

IN ABOVE SPACE DESCRIBE PROPOSED PROGRAM: IF PROPOSAL IS TO DEEPEN OR PLUG BACK, GIVE DATA ON PRESENT PRODUCTIVE ZONE AND PROPOSED NEW PRODUCTION.

I hereby certify that the information above is true and complete to the best of my knowledge and belief.

APPROVED BY: *[Signature]* DATE: 6/21/67
 CONDITIONS OF APPROVAL, IF ANY: